

SEADOG[®]LINE

QUALITY MARINE GEAR

WWW.SEA-DOG.COM

2012 SUPPLEMENT

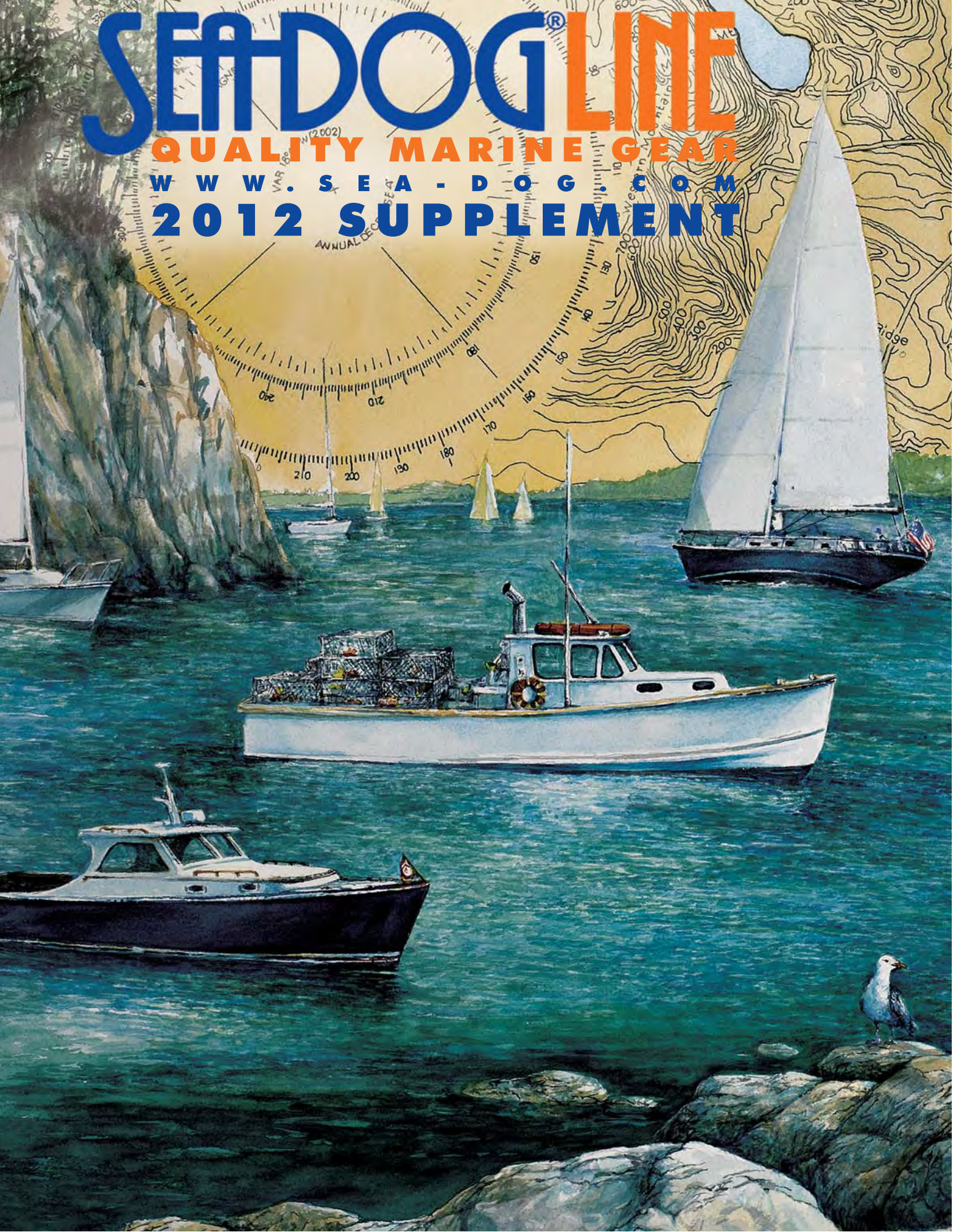

TABLE OF CONTENTS

CLAMCLEATS	1
CLEATS & CHOCKS	2
Lift Eye	
RIGGING HARDWARE	2
Closed Thimble	
CABINET HARDWARE	2,3
Gate Latch	
Steering Wheel	
Steering Wheel Cap	
RAIL FITTINGS	3
Stud Mount Grab Rail	
DECK HARDWARE	3,4
Chain Stopper - Euro Style	
Two Pole Side Mount Rod Holder	
Three Pole Side Mount Rod Holder	
Rail Mount Dual Fender Holder	
FlagPole Clips & Mounts	
Seat Swivel	
VENTS & FUEL FITTINGS	4
Clam Shell Vent	
Midget Vent - Heavy Duty	
LIGHTS AND SWITCHES	5,6,7
LED Masthead Light	
LED Fold Down All Around Pontoon Light	
LED Transom Light	
LED All Around Light	
LED Combination Bow Light	
LED Top Mount Side Lights	
LED Side Mount Side Lights	
LED Courtesy Light	
LED Finger Light	
LED Side Mount Docking Light	
LED Portable Underwater Light	
LED Underwater Light-Oblong	
Rocker Switch	
Kill Switch	
Kill Switch 7 Key Universal Lanyard	
ELECTRICAL	8
Precision Analog Meters	
Deluxe Power Socket	
Wire Stripper/Crimper Tool	
Deluxe Wire Stripper Crimper Tool	
Heat Shrink Terminal Crimper Tool	
MISCELLANEOUS	9
Oval Bowl Sink	
Bottle Opener	
Low Profile Vent/Snap-On Deck Plate	
Standard Vent/Snap-On Deck Plate	
Strap Guard	
EXTRAS	10,11
Planograms	
Crimpers & Connectors	
EXTRAS	12,13
Service Kits	
Strap Guards	
EXTRAS	BACK
Merchandising Guide	
New Website - SEA-DOG.COM	

GENERAL INFORMATION

To Order Call
(425) 252-2148

or Fax
(425) 339-1345

ORDER INFORMATION Our carrier picks up at approximately 3:00 PM PST. Please place Next, 2nd or 3rd Day Air orders by 1:00PM PST so we can process and ship your order the same day. We make every effort to ship all orders as soon as possible, shipping times vary depending on order size and availability of parts.

WHAT ARE -1s, -2s, and -3s? Each item available in retail display packaging is identified by a "-1", "-2", or "-3" following our usual six digit bulk part number and is listed in its own column next to the bulk part number. A part number followed by a -1 signifies it can be utilized in a hanging display and is packaged in a hanging card, see-thru bag with header card, or clamshell. -2 parts are in packs of 25 parts. In most cases, -3 parts are boxed.

MINIMUM ORDERS We do not require a minimum order quantity or dollar amount; however, if an order is less than \$100.00 a \$10.00 handling fee will be charged. For maximum cost effectiveness, we recommend that the standard packaging quantities listed with each item be maintained.

RETURNS A Return Goods Authorization (RGA) number must be obtained prior to any return. Credit will not be issued for goods returned without prior authorization. Please provide the following information with the returned item(s):

- 1) list of items being returned
- 2) date of purchase
- 3) invoice number
- 4) Sea-Dog order number
- 5) reason for return

All items returned must be in original packaging and ready for resale. Returned items are subject to a minimum 15% restocking charge. Customers are responsible for freight on returned items. SPECIAL ORDER ITEMS CANNOT BE RETURNED. Once authorized, please forward returns to:

Sea-Dog Line
3402 Smith Avenue
Everett, Washington 98201 USA

CONTACT

Sea-Dog Line
P.O. Box 479
Everett, Washington 98206 USA

www.sea-dog.com
General office (425) 259-0194
Orders (425) 252-2148
Fax (425) 339-1345

Hours: 8:00AM - 5:00PM PST

Copyright© 2012 by SEA-DOG CORPORATION. All rights reserved.

Michael J Smith - Art Director & Graphic Designer - graphics@sea-dog.com
Part #0005UP

Line-Lok[®] Line Tensioners

- Positive control of guy-lines for tents, tarps, bivis, marquees and radio masts.
- Locks lines securely to resist being shaken loose, even in extreme conditions. Suitable for use in harsh environments from the arctic cold to the desert heat.
- Four sizes available for ropes up to 5/16"

002710PH, 002710NG, 002710S, 002600S, 002600PH, 002760NG, 002760PH, 002660PH, 002660S, 002760S, 002600PH Glowing in the dark

Push up to tension and secure. Pull lines apart to release.

REALLY DOES GLOW IN THE DARK • REALLY DOES GLOW IN THE DARK

Cub Cleat

002320W white

- Designed for those conditions where the rope has to be controlled from a position remote from the cleat.
- Minimum lift is required to release the rope.
- This versatile cleat can be mounted either way up on vertical or horizontal surfaces or stacked, one on top of the other.

Q-Lok

005000

- Easy to rig.
- Stainless steel.
- Cost effective.

Knots allow a number of fixed positions to be quickly rigged or changed.

Truckers Hitch Cleat

007190

An aerial cleat that rigs like the trucker's hitch / wagoner's hitch.

- Easy to use, can be fastened and released with one hand and operated from a distance.
- Uses a single piece of rope.
- Uses include aiding installation of machinery and heavy duty cables.

CK Cleat Range

008300 Silver cleats, 008305 Hard Anodized cleats

- Patented Keeper allows rope to run free when uncleated
- Rear fairlead allows cleating at angles up to 70°.
- Fixing centers, 1 1/16" (27mm), easy to retro-fit.

XD Twin Training Cleat

008250, 008255

- Patented Keeper keeps the rope out of the teeth when you want the rope to run free.
- Rear fairlead allows cleating at angles up to 70°.

Fixings & Dimensions

Part #	Dimensions	Weight	Material	Thread	Thread	Thread
002710 PH, NG & S	5/32 - 5/16" 4mm - 8mm	0.95oz. 27gms	NA	NA	NA	NA
002760 PH, NG & S	1/8 - 1/4" 3mm - 6mm	0.33oz. 9.4gms	NA	NA	NA	NA
002600 PH & S	1/16 - 3/16" 2mm - 5mm	0.07oz. 2.0gms	NA	NA	NA	NA
002660 PH & S	3/64 - 1/8" 1mm - 3mm	0.03oz. 0.74gms	NA	NA	NA	NA
002320W	1/8 - 1/4" 3mm - 6mm	0.5oz. 13gms	N#8, 4.2mm	#8, 5/32", M4	NA	NA
005000	1/8 - 5/32" 3mm - 4mm	0.2oz. 5gms	NA	NA	NA	NA
007190	3/16 - 1/4" 5mm - 7mm	2.55oz. 73gms	NA	NA	NA	NA
008300 & 008305	1/8 - 1/4" 3mm - 6mm	2.0oz. 58gms	N#8, 4.2mm	#8, 5/32", M4	NA	NA
008250 & 008255	1/8 - 1/4" 3mm - 6mm	5.3oz. 150gms	N#10, 4.8mm	#10, 3/16", M5	NA	NA

LIFT EYE

Investment Cast 316 Stainless

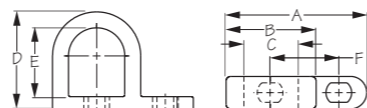

Bulk #	Display #	A	B	C	D	E	F	Fastener	Wt.(lb.)	Std. Pack
048330	048330-1	2-3/4"	1-3/4"	1-3/16"	2"	1-3/8"	1-3/8"	3/8" Bolt	.34	5 ea
048350	048350-1	3-9/16"	2-1/4"	1-7/16"	2-7/16"	1-3/4"	1-3/4"	1/2" Bolt	.64	5 ea

Lift Eye 048330 works with Bow Eyes 080031-080036. Lift Eye 048350 works with Bow Eye 080085.

HEAVY DUTY CLOSED THIMBLE

Cast 304 Stainless

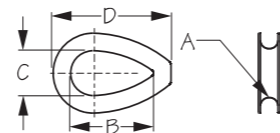

Bulk #	Display #	(Wire Dia.) A	B	C	D	Wt.(lb.)	Std. Pack
171402	171402-1	1/16"	9/16"	5/16"	13/16"	.01/.02	50 ea / 10 pr
171403	171403-1	1/8"	11/16"	7/16"	1"	.01/.02	50 ea / 10 pr
171404	171404-1	5/32"	13/16"	7/16"	1-1/4"	.02/.04	50 ea / 10 pr
171406	171406-1	1/4"	1-1/16"	5/8"	1-11/16"	.07/.14	50 ea / 10 pr
171408	171408-1	5/16"	1-11/16"	15/16"	2-1/4"	.10/.20	25 ea / 10 ea
171410	171410-1	3/8"	2"	1-1/16"	2-13/16"	.23/.46	20 ea / 10 ea

GATE LATCH

Investment Cast 316 Stainless

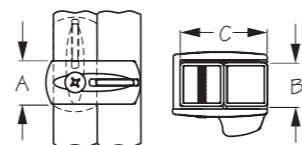

Bulk #	Display #	A	B	C	Fastener	Wt.(lb.)	Std. Pack
221880	221880-1	1-1/4"	1-1/4"	1-1/2"	1/4" Bolt	.40	5 ea

Gate Latch is designed for pontoon boat gates, to be used with 1.25" square tubing.



STEERING WHEEL

Formed 304 Stainless Steel With Black Foam Covering

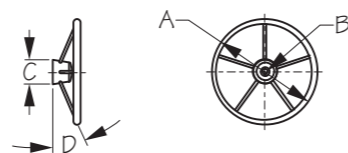

Bulk #	Display #	Dish Angle	# of Spokes	Cap	A	B	C	D	Wt.(lb.)	Std. Pack
230212	n/a	25°	5	Plastic	12"	3/4"	3-1/2"	25°	2.95	5 ea

STEERING WHEEL CAP

Cast 304 Stainless Steel

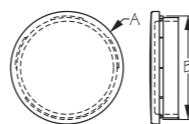

Bulk #	Display #	A	B	Wt.(lb.)	Std. Pack	
230303	n/a	Replacement Cap Stainless	2-3/8"	2-3/16"	.36	5 ea

Replacement cap fits part numbers: 230313, 230315, 230323, 230325, 230343, 230345.

STUD MOUNT HAND RAIL

Formed 304 Stainless/Powder Coat

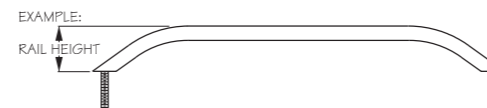

Bulk #	Display #	Description	Rail Height	Tube O.D.*	Fastener	Wt.(lb.)	Std. Pack
254124BK	n/a	Stud Mount Hand Rail - 24" (Black)	2"	3/4"	5/16" x 18	.80	5 ea

CHAIN STOPPER - EURO STYLE

Investment Cast 316 Stainless

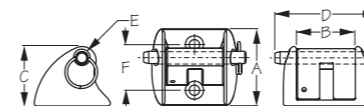

Bulk #	Display #	A	B	C	D	E	F	Fastener	Wt.(lb.)	Std. Pack
321822	321822-1	2-5/16"	1-13/16"	1-13/16"	3-1/8"	3/8"	1-3/8"	5/16" FH	.73	1 ea
321827	321827-1	3-1/8"	2-3/8"	2-3/8"	4-1/8"	7/16"	1-7/8"	3/8" FH	1.56	1 ea
321832	321832-1	3-7/8"	2-5/8"	3"	4-3/4"	5/8"	2-3/8"	1/2" FH	2.86	1 ea

Euro Style Chain Stoppers for Sea-Dog and comparable bow rollers. Mounts alone or inside most bow rollers. 321822 fits chain sizes 3/16" - 1/4", 321827 fits chain sizes 5/16" - 3/8", 321832 fits chain 7/16"-1/2". Chain stoppers help prevent damage to windlass.

TWO POLE SIDE MOUNT ROD HOLDER

Injection Molded Polypropylene

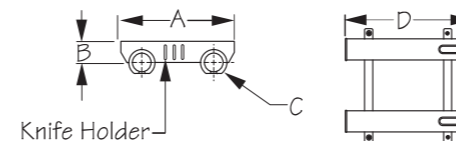

Bulk #	Display #	A	B	C	D	Color	Tool Holder	Wt.(lb.)	Std. Pack
325029	325029-1	10-5/8"	1-7/8"	1-3/4"	11-11/16"	Black	Yes	.73	4 ea

Two Pole Rod Holder is one piece, no assembly required. Holds knife & tackle. Also available in white-325028, 325028-1.

THREE POLE SIDE MOUNT ROD HOLDER

Injection Molded Polypropylene

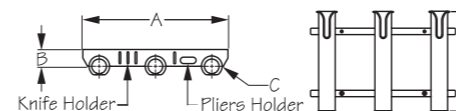

Bulk #	Display #	A	B	C	D	Color	Tool Holder	Wt.(lb.)	Std. Pack
325039	325039-1	17"	1-7/8"	1-3/4"	11-11/16"	Black	Yes	1.50	4 ea

Three Pole Rod Holder is one piece, no assembly required. Holds knife, pliers and tackle. Also available in white 325038, 325038-1.



RAIL MOUNT DUAL FENDER HOLDER

Formed 304 Stainless

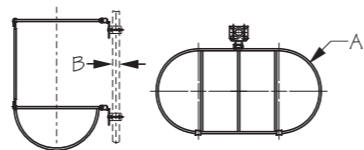

Bulk #	Display #	A	B	Wt.(lb.)	Std. Pack
n/a	327357-1	7-1/2"	7/8"-1"	1.82	1 ea
n/a	327359-1	9-1/2"	7/8"-1"	2.32	1 ea
n/a	327361-1	11-1/2"	7/8"-1"	2.82	1 ea

FLAGPOLE CLIPS & MOUNTS

Injected Molded Nylon/Stainless



Bulk #	Display #	Size	A	Wt.(lb.)	Std. Pack
n/a	328197-1	Flag Pole Nylon Clips & Stainless Mounts	1/2"	.08	10 sets

The flag is attached to the flagpole using nylon pennant mounts with stainless steel spring wire quick release clips which are designed to hold their shape after continued use. Both pennant mounts can move either direction on the flagpole allowing flexibility in mounting various sizes of flags where the eyelet's of the flag are less than the overall length of the flagpole.

SEAT SWIVEL

Stamped Steel Powder Coated

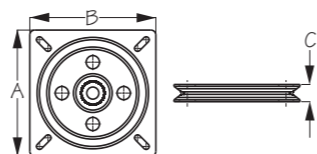

Bulk #	Display #	A	B	C	Fastener	Wt.(lb.)	Std. Pack
328570	n/a	7"	7"	7/8"	1/4" RH	2.50	1 ea

CLAM SHELL VENT

Stamped 304 Stainless

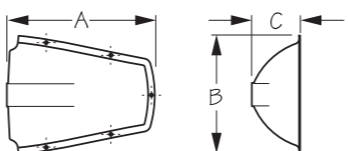

Bulk #	Display #	A	B	C	Vent Area	Fastener	Wt.(lb.)	Std. Pack
331335	331335-1	5"	4-1/2"	2"	4.51 in ²	#6 RH	.40	10 ea
331340	331340-1	7"	5-3/4"	2-1/4"	7.51 in ²	#6 RH	.58	10 ea
331350	331350-1	7-1/2"	6-3/4"	2-7/8"	12.02 in ²	#6 RH	.79	10 ea

MIDGET VENT - HEAVY DUTY

Stamped 304 Stainless

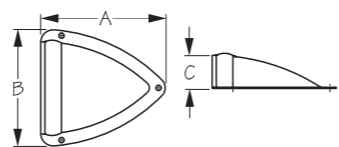

Bulk #	Display #	A	B	C	Vent Area	Fastener	Wt.(lb.)	Std. Pack
331375	331375-1	3-3/4"	3-1/2"	1/2"	.75 in ²	#6 RH	.12	10 ea

LED MASTHEAD LIGHT

Injection Molded Polycarbonate

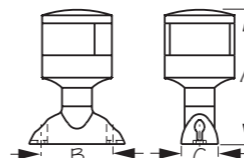

Bulk #	Display #	A	B	C	Fastener	Wt.(lb.)	Std. Pack
400022	400022-1	4-5/16"	1-1/8"	2-1/4"	#12 RH	.24	1 ea

LED Masthead Lights are approved for USCG 2 NM (Colreg 2 mile). 12 Volt DC.



LED FOLD DOWN ALL AROUND PONTOON LIGHT

Injection Molded Polycarbonate

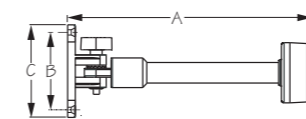

Bulk #	Display #	A	B	C	Fastener	Wt.(lb.)	Std. Pack
400025	400025-1	18"	2-7/8"	3-3/8"	#10 FH	.32	1 ea
400026	400026-1	24"	2-7/8"	3-3/8"	#10 FH	.42	1 ea
400027	400027-1	36"	2-7/8"	3-3/8"	#10 FH	.52	1 ea

LED Fold Down All Around Pontoon Lights are approved for USCG 2 NM (Colreg 2 mile). Mounts on 1-1/4" square tubing. 12 Volt DC.

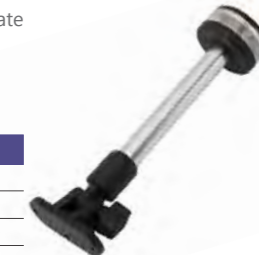

LED TRANSOM LIGHT

Stamped 304 Stainless

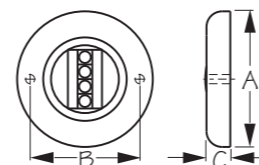

Bulk #	Display #	A	B	C	Fastener	Wt.(lb.)	Std. Pack
400033	400033-1	3-1/4"	2-1/2"	9/16"	#12 RH	.16	1 ea

LED Transom Lights are approved for USCG 2 NM (Colreg 2 mile). 12 Volt DC.



LED ALL AROUND LIGHT

Injection Molded Polycarbonate

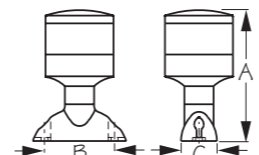

Bulk #	Display #	A	B	C	Fastener	Wt.(lb.)	Std. Pack
400042	400042-1	4-5/16"	1-1/8"	2-1/4"	#12 RH	.24	1 ea

LED Navigation Lights are approved for USCG 2 NM (Colreg 2 mile). 12 Volt DC.



LED COMBINATION BOW LIGHT

Injection Molded Nylon

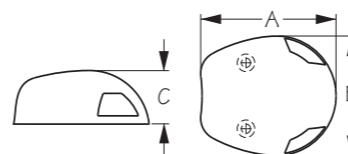

Bulk #	Display #	A	B	C	Finish	Fastener	Wt.(lb.)	Std. Pack
400058	400058-1	2-9/16"	2-1/4"	1"	Black	# 10 FH	.29	1 ea

LED Navigation Lights are approved for USCG 1 NM (Colreg 1 mile). 12 Volt DC.



LED TOP MOUNT SIDE LIGHTS

Injection Molded Nylon

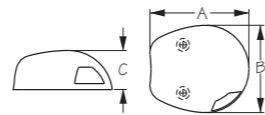

Bulk #	Display #	A	B	C	Finish	Fastener	Wt.(lb.)	Std. Pack
400068	400068-1	2-9/16"	2-1/4"	1"	Black	#10 FH	.58	1 pr

LED Navigation Lights are approved for USCG 1 NM (Colreg 1 mile). Includes Port and Starboard Lights. 12 Volt DC.

LED SIDE MOUNT SIDE LIGHTS

Stamped 304 Stainless/Injection Molded Nylon

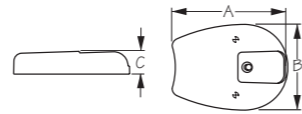

Bulk #	Display #	A	B	C	Finish	Fastener	Wt.(lb.)	Std. Pack
400078	400078-1	3-9/16"	2-5/8"	3/4"	Black	#10 FH	.40	1 pr
400079	400079-1	3-9/16"	2-5/8"	3/4"	Stainless	#10 FH	.40	1 pr

LED Side Mount Side Lights 400078 (black) are approved for USCG 1 NM (Colreg 1 mile). 400079 (Stainless) are approved for USCG 2 NM (Colreg 2 mile) 12 Volt DC.

LED COURTESY LIGHT

Plastic

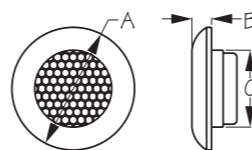
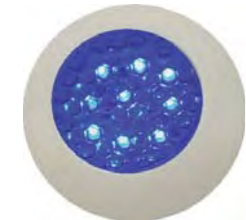

Bulk #	Display #	A	B	C	Ring Finish	LED Color	Fastener	Wt.(lb.)	Std. Pack
401647	401647-1	3-1/8"	1/2"	2"	White	Blue	#6 FH	.10	1 ea / 5 ea

LED Courtesy Lights have 9 LEDs in each light and are rated at 12 Volt DC. Low amp draw.

LED FINGER LIGHT

Plastic

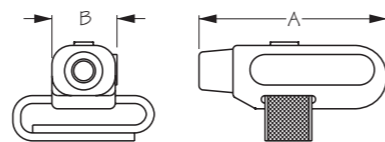

Bulk #	Display #	A	B	LED Color	Wt.(lb.)	Std. Pack
401955	401955-1	1-5/8"	1/2"	Red	.01 / .02	10 ea / 5 ea
n/a	401955-5	Display POP-25 Pieces		Red	.50	1 ea

LED Finger Light is great for tight places and can be easily attached to any tool with its Velcro strap. LED is red.

LED SIDE MOUNT DOCKING LIGHTS

Stamped 304 Stainless

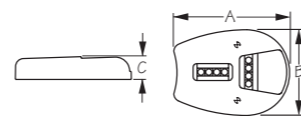

Bulk #	Display #	A	B	C	Fastener	Wt.(lb.)	Std. Pack
405950	405950-1	3-9/16"	2-5/8"	3/4"	#10 FH	.19	1 pr

LED Side Mount Docking Lights have a sleek design and are super bright for excellent vision when docking. Forward and side light sections are wired separately. 12 Volt DC.

LED PORTABLE UNDERWATER LIGHT

Injection Molded Polycarbonate

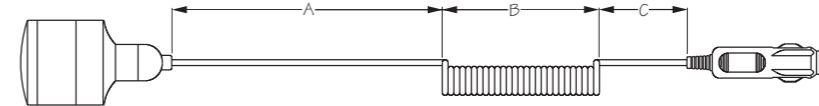

Bulk #	Display #	A	B	C	Wt.(lb.)	Std. Pack
406090	406090-1	108"	15"	6"	1.00	1 ea

LED Portable Underwater Light is a great way to light up the water without cutting a hole in your boat. Plug into any 12 volt receptacle and drop overboard. Also can be used to light up engine compartment, cabin, or cockpit. Total stretched length is approximately 12 feet.

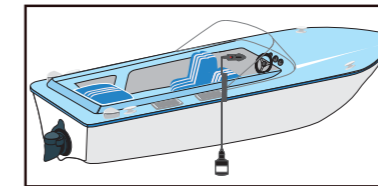

LED UNDERWATER LIGHT-OBLONG

Investment Cast 316 Stainless

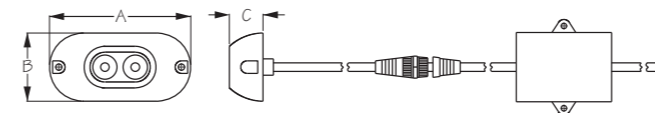

Bulk #	Display #	A	B	C	LED's	Finish	Light Color	Fastener	Wt.(lb.)	Std. Pack
406120	n/a	4-1/4"	1-15/16"	15/16"	2	Stainless	White	#8 RH	.75	1 ea
406166	n/a	7-3/4"	1-15/16"	15/16"	6	Stainless	White	#8 RH	2.18	1 ea

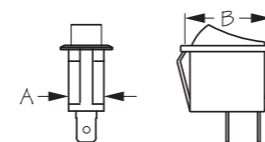

ROCKER SWITCH

Stamped Brass/Injection Molded Nylon/Polycarbonate



Bulk #	Display #	Amps	Volts	Circuit	Action	A	B	Color	Wt.(lb)	Std. Pack
420444	420444-1	15 A	12 V	SPST	On/Off	1/2"	1-1/8"	Black	.02	10 ea
420445	420445-1	15 A	12 V	SPST	On/Off	1/2"	1-1/8"	White	.02	10 ea

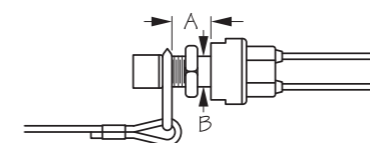

KILL SWITCH

Stamped Brass/Injection Molded Nylon & Delrin



Bulk #	Display #	A	B	Kill Style	Wt.(lb.)	Std. Pack
420486	420486-1	5/8"	5/8"	Magneto	.08	10 ea
420487	420487-1	5/8"	5/8"	Ignition	.08	10 ea
420489	420489-1	Coiled Lanyard Only			.06	10 ea

Both Kill Switches include coiled lanyard (420499).
WARNING: Test switch for proper function before each use. Replace lanyard if worn, cut or frayed.

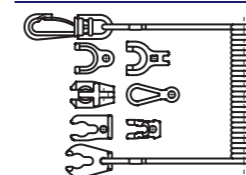

KILL SWITCH 7 KEY UNIVERSAL LANYARD

Injection Molded Nylon & Delrin



Bulk #	Display #	Length	Wt.(lb.)	Std. Pack
n/a	420495-1	50"	.08	10 ea

7 Key Lanyard fits Johnson, Evinrude, Mercury, Yamaha, Honda, Tohatsu, Suzuki and Nissan kill switches.

PRECISION ANALOG METER

Acrylic/Molded Bakelite

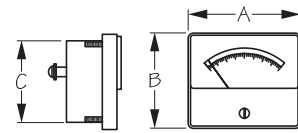

Bulk #	Display #	Description	A	B	C	Wt.(lb.)	Std. Pack
421528	n/a	0-200 DC	2-13/16"	2-3/8"	2"	.20	5 ea

Each precision Sea-Dog meter is mounted in a Bakelite case. A 2-1/8" round hole is required to accommodate the control unit for each panel prior to mounting. Each gauge comes complete with mounting screws on the back to provide a clean finished appearance.

DELUXE POWER SOCKET

Stamped Brass/Injection Molded Nylon & ABS

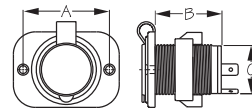

Bulk #	Display #	Description	A	B	C	Wt.(lb.)	Std. Pack
n/a	426120-1	Complete	1-15/16"	1-1/2"	1-1/16"	.07	10 ea
426125	n/a	Speed Nut & Cap (OEM)	1-15/16"	1-1/2"	1-1/16"	.05	10 ea

426120-1 includes socket, cap, mounting plate, screws, & terminals.

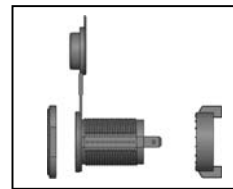

WIRE STRIPPER/CRIMPER TOOL

Powder Coated Steel

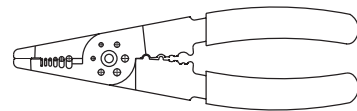

Bulk #	Display #	Wt.(lb.)	Std. Pack
n/a	429900-1	.40	1 ea

Crimps and strips 22-10 gauge wire. Great addition to any tool box.

DELUXE WIRE STRIPPER CRIMPER TOOL

Chrome Plated Steel

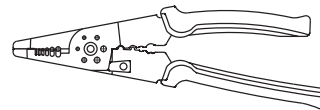

Bulk #	Display #	Wt.(lb.)	Std. Pack
n/a	429905-1	.50	1 ea

Spring loaded, strips & crimps 22-10 gauge wire. Great addition to any tool box.

HEAT SHRINK TERMINAL CRIMPER TOOL

Powder Coated/Stainless Steel

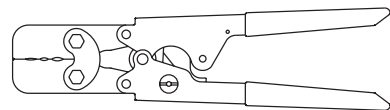

Bulk #	Display #	Wt.(lb.)	Std. Pack
n/a	429920-1	.77	1 ea

Heat Shrink Terminal Crimper Tool crimps 22-10 gauge Heat Shrink terminals. Great addition to any tool box.

OVAL BOWL SINK

300 Series 16 ga. Stainless Steel

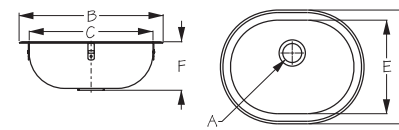

Bulk #	Display #	A	B	C	D	E	F	Wt.(lb.)	Std. Pack
517426	n/a	2"	14-1/4"	12-1/4"	11-1/2"	9-1/4"	4-7/8"	2.24	1 ea

Sea-Dog Oval Sink uses Sink Drain with Strainer part number 517525 and 517526.

BOTTLE OPENER

Investment Cast 316 Stainless



Bulk #	Display #	A	Fastener	Wt.(lb.)	Std. Pack
588450	588450-1	2-3/8"	#8 FH	.17	1 ea

LOW PROFILE COWL VENT/SNAP-ON DECK PLATE

Dip Molding PVC

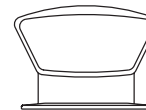

Bulk #	Display #	Diameter	Height	Int. Color	Wt.(lb.)	Std. Pack
n/a	727132-3	3"	5"	White	.96	1 ea
727133	n/a	Replacement Cowl Only		White	.83	1 ea
n/a	727142-3	4"	5-7/8"	White	1.43	1 ea
727143	n/a	Replacement Cowl Only		White	1.25	1 ea

Also available w/ red interior - see full line catalog or website for part numbers.

STANDARD COWL VENT/SNAP-ON DECK PLATE

Dip Molding PVC



Bulk #	Display #	Diameter	Height	Int. Color	Wt.(lb.)	Std. Pack
n/a	727137-3	3"	7-3/4"	White	1.34	1 ea
727138	n/a	Replacement Cowl Only		White	1.07	1 ea
n/a	727147-3	4"	9-1/4"	White	1.91	1 ea
727148	n/a	Replacement Cowl Only		White	1.75	1 ea

Also available w/ red interior - see full line catalog or website for part numbers.

STRAP GUARD

Injection Molded Nylon

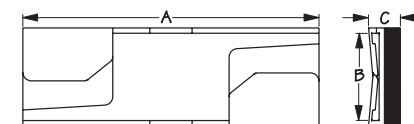

Bulk #	Display #	A	B	C	Wt.(lb.)	Std. Pack
n/a	756012-1	6-1/4"	1-1/4"	9/16"	.14	15 ea
n/a	756012-5	6-1/4"	1-1/4"	9/16"	.14	20 ea
n/a	756020-1	7"	2"	3/4"	.20	15 ea
n/a	756020-5	7"	2"	3/4"	.20	20 ea

Strap Guard 756012 fits 1-1/4" straps. Strap Guard 756020 fits 2" straps. Great for protecting your boat, motorcycle, or any valuable cargo from strap damage. (756012 will be available in late fall of 2011.)



PLANOGRAMS

Showcasing top-selling items that are too large to be displayed on a panel, Sea-Dog is introducing two new planograms featuring our best-selling rod holders and ventilation products. Planograms include the listed products, as well as peg hooks and back tags for each of the items. Easy to buy, easy to sell.

**Ventilation Planogram
916151P**



Description	Part No.	Qty.
SCREW OUT DECK PLATE (White) 4-7/16"	337140-1	2
SCREW OUT DECK PLATE (Black) 4-7/16"	337145-1	2
SCREW OUT DECK PLATE (White) 6-1/2"	337160-1	2
SCREW OUT DECK PLATE (White) 5-7/16"	337150-1	2
SCREW OUT DECK PLATE (Black) 5-7/16"	337155-1	2
SCREW OUT DECK PLATE (Black) 6-1/2"	337165-1	2
MIDGET VENT 1-5/8"	331360-1	2
MIDGET VENT 2-1/4"	331370-1	2
MIDGET VENT Large	331375-1	2
ROUND LOUVERED VENT 4-1/8"	331425-1	2
ROUND LOUVERED VENT 3-1/4"	331424-1	2
BUTTERFLY VENT - CENTER KNOB 5"	331450-1	2
BUTTERFLY VENT - CENTER KNOB 4"	331440-1	2
CLAM SHELL VENT MINI	331335-1	2
CLAM SHELL VENT SMALL	331340-1	2
LOCKER VENT	331620-1	2
LOUVERED VENT	331400-1	2

**Rod Holder Planogram
916150P**



Description	Part No.	Qty.
TWO POLE SIDE MOUNT ROD HOLDER (White)	325028-1	1
TWO POLE SIDE MOUNT ROD HOLDER (Black)	325029-1	1
THREE POLE SIDE MOUNT ROD HOLDER (White)	325038-1	1
THREE POLE SIDE MOUNT ROD HOLDER (Black)	325039-1	1
FLUSH MOUNT ROD HOLDER (White)	325161-1	2
FLUSH MOUNT ROD HOLDER (Black)	325160-1	2
ECONOMY 90° FLUSH MOUNT ROD HOLDER WITH CAP	325173-1	2
FLUSH MOUNT ROD HOLDER WITH CAP	325175-1	2
ROD STORAGE RACK	325615-1	2
ROD STORAGE RACK	325613-1	2
SIDE MOUNT ROD HOLDER (White)	325121-1	2
SIDE MOUNT ROD HOLDER (Black)	325120-1	2

CONNECTORS AND CRIMPERS

- Connectors are made in the USA
- Both nylon and adhesive lined heat shrink premium connectors
- Pure copper for maximum current flow, tinned for corrosion resistance
- Full assortment of ring, butt, spade and male/female disconnects
- UL/CSA listed
- Complies with ABYC standard E-11



Check out Sea-Dog's complete offering of tools including strippers/crimpers, single ratcheted crimper (heat shrink) and double ratcheted crimper (nylon).

Visit our new website..... www.sea-dog.com
Or call us (866)732-3641

SEADOG[®]LINE

QUALITY MARINE GEAR

SERVICE KITS



- Our new Service Kits provide the most needed installation items in one convenient place
- Quickly find your most important installation and repair parts including:

Electrical Connectors	Terminals
Fuses	Wire Ties
Light bulbs	
- Keeps all parts organized so they're where you want them when you need them
- Easy to store and easy to carry in a soft-sided carry bag that holds five complete trays with additional storage for your tools

WWW.SEA-DOG.COM

NEW SEA-DOG SERVICE KITS

NEW!

STRAP-GUARD[™]

BY CHOK-A-BLOK[™]

STRAP IT • PROTECT IT • SHIP IT



- Protects cargo from strap damage
- Use with 2" straps
- Easily clips onto the strap using one hand
- Glides along the strap to the needed point of contact
- Firmly grips the strap regardless of the tension being applied
- Use multiple Strap-Guards to protect large or long run areas



SEADOG[®]LINE

QUALITY MARINE GEAR

WWW.SEA-DOG.COM

STRAP-GUARD

NEW 2012 MERCHANDISING GUIDE



SEADOG LINE
QUALITY MARINE GEAR

CHECK OUT OUR NEW WEBSITE

SEADOG LINE
QUALITY MARINE GEAR
WHOLESALE ONLY PROVIDER OF MARINE HARDWARE

Product Search Enter Part # or Keyword

Project List (0)

NEW ITEMS | MERCHANDISERS | TECHNICAL INFO | CATALOGS & MEDIA | WHERE TO BUY

Anchoring, Docking & Boarding
 Antenna, Windshield & Trailer
 Cabinet & Hatch Hardware
 Chain & Rigging Hardware
 Chandlery & Misc
 Deck Hardware
 Electrical Panels, Connectors, Battery & Accessories
 Electrical Switches & Circuit Protection
 Fishing
 Hinges
 Lighting
 Plumbing - Ventilation, Fuel & Drain
 Rail, Binini & Canvas Fittings
 Snaps & Shackles
 Steaming & Engine

NEW 2011 CATALOG AVAILABLE!

NMDA 2010 SUPPLIER OF THE YEAR

Sea-Dog Spotlight

 FOLDING ANCHOR 318001	 S-STYLE STUD CLEAT 041676	 LED LIVEWELL LIGHT 401525-1

ABYC Certified
ABYC CERTIFIED MARINE TECHNICIAN
 MARINE ELECTRICIAN

Sea-Dog is proud to have an ABYC Certified Marine Technician Mark Bernhart on board to aid you with any technical & installation issues!

Affiliates
ABYC
CompuMarine

NEW SORT FEATURES

SIMPLIFIED CATEGORIES

EASIER NAVIGATION

FASTER SEARCHING

DOWNLOADABLE CATALOGS

TOP DOG DEALER LISTINGS

WHERE TO BUY PAGE

TRADE SHOW SCHEDULE

NEW MEDIA SECTION

WWW.SEA-DOG.COM