



Engineering Innovations for Outdoor Enthusiasts

PRODUCT CATALOG 2012





TABLE OF CONTENTS

FOOTBRACES	4, 5
TRUCOURSE™ RUDDER.....	6
HATCH COVERS	7
DECK PLATES	8, 9, 10
DRAIN PLUGS.....	11
HANDLES	12
CLAMCLEATS	12, 13
CLEATS & PAD EYES	14, 15
BOW EYES & EYE STRAPS	16
DECK LINE GUIDES & FITTINGS	17
FASTENERS & MOUNTING HARDWARE	18, 19, 20
SHOCK CORDS, HOOKS & CRIMPS	21
DECK LINE, BUNGEE CORD, CABLE & TUBING	22
BUNGEE CLIPS.....	23
SNAPS & HOOKS	24, 25
RIGGING HARDWARE.....	26, 27
ROD HOLDERS & KAYAK FISHING.....	28, 29
ANCHORS	30
POLE & PADDLE CLIPS.....	31
PADDLES & OARLOCKS.....	32, 33
ACCESSORIES.....	34
SAFTEY.....	35



Your Paddlesports Hardware & Repair Solution

If you've been around a paddlesports shop before you know the story ... kayak hardware and accessories are tucked away in a corner just taking up space - thrown in buckets with no packaging or barcode. At SEA-LECT Designs, our goal is simple; to bring all those hard to find hardware and repair accessories out of the back room, storage closet and tackle box behind the counter, and make them easy to find!

We've taken retail packaging for paddlesport hardware to a whole new level. Every item is individually packed in one of our attractive blister packs, clamshells and/or retail bag with header card, and it includes its' item number, UPC code and features a unique barcode to work with inventory management systems. When combined with our innovative merchandising options (noted below), every shop can now have all the tools it needs to solve the problem of providing hardware & repair accessories.



Innovative Merchandising Option

In 2012 SEA-LECT Designs is happy to build on the success of our spinner, which over the past year has begun to pop up in shops across the globe, with new panel programs, fishbowl display options and strip merchandisers. We now have an option for every paddlesports store, regardless of its size, shape, or space limitations!

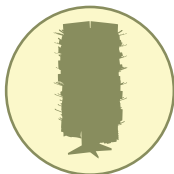

SPINNER



STRIPS

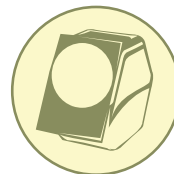

FISHBOWLS

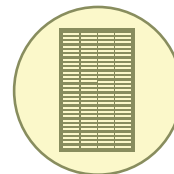

PANELS

To learn more about our retail displays, please check out our Merchandising Guide, or visit www.sealectdesigns.com.

About SEA-LECT Designs

A division of marine hardware manufacturer Sea-Dog Corporation, one of SEA-LECT Designs' focal points is producing high-performance hardware and repair accessories through partnerships between customers and our internal design team.

Made in Everett, WA! With our own in-house injection molding facility, most of SEA-LECT Designs' plastic products are made in the United States where we control all phases of manufacturing to ensure a consistent quality. This means no outsourcing, great pricing, and unmatched reliability in customer service. In addition, through the vast resources of Sea-Dog Corporation, SEA-LECT Designs is able to purchase in quantity and pass along a lower cost alternative for many of those items which need to be brought in from other sources.

As an independent manufacturer of components (we don't manufacture kayaks ourselves, just the parts and pieces that make them up), we're able to concentrate solely on the hardware every paddler needs. As a supplier for boat builders and manufacturers from coast-to-coast ... and throughout the world ... we guarantee you've seen our pad eyes, deck line guides, cleats, anchors, rod holders, foot braces and hatch covers on a boat in your neighborhood!

SEA-LECT Designs is committed to bringing more innovative hardware & repair solutions to the Outdoor Industry and your Paddlesports Community. For more information, contact us at (425) 252-2149, or e-mail info@sealectdesigns.com.

SEA-LECT Designs

PO BOX 67

Everett, WA 98206

P: (425) 252-2149

F: (425) 339-1345

info@sealectdesigns.com

www.sealectdesigns.com

SEA-LECT DESIGNS IS SOCIAL!



2012 CATALOG SEA-LECT DESIGNS

KAYAK ADJUSTABLE FOOTBRACE

Injection Molded Polypropylene Fiberglass/Nylon

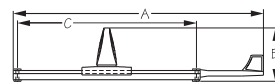

Bulk #	Display #	A	B	C	Rod Color	Wt.(lb.)	Std. Pack
K747100	K747100-1	20-1/4"	4-1/4"	14-1/2"	Red	1.50	1 pr
K747100B	K747100B-1	20-1/4"	4-1/4"	14-1/2"	Black	1.50	1 pr

The SEA-LECT Designs™ Kayak Adjustable Footbrace has 14" of adjustable travel with only the flip of the lever. The two mounting holes (measuring 14-1/2" apart) fit most existing footbrace patterns with 1/4"-20 screws, and the entire unit is designed to be maintenance free and self cleaning with tremendous strength. In addition, the ergonomically designed pedals are extremely comfortable ... even with bare feet. Thru-hole mounting for easy user installation. Patent #7,168,388.

KAYAK ADJUSTABLE FOOTBRACE (STUD MOUNT)

Injection Molded Polypropylene Fiberglass/Nylon

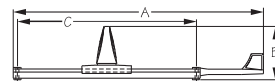

Bulk #	Display #	A	B	C	Rod Color	Wt.(lb.)	Std. Pack
K747110	K747110-1	20-1/4"	4-1/4"	14-1/2"	Red	1.50	1 pr
K747110B	K747110B-1	20-1/4"	4-1/4"	14-1/2"	Black	1.50	1 pr

Same adjustable footbrace, but w/ stud mounts for gluing/fiberglassing into place w/o thru hole drilling. Patent #7,168,388.

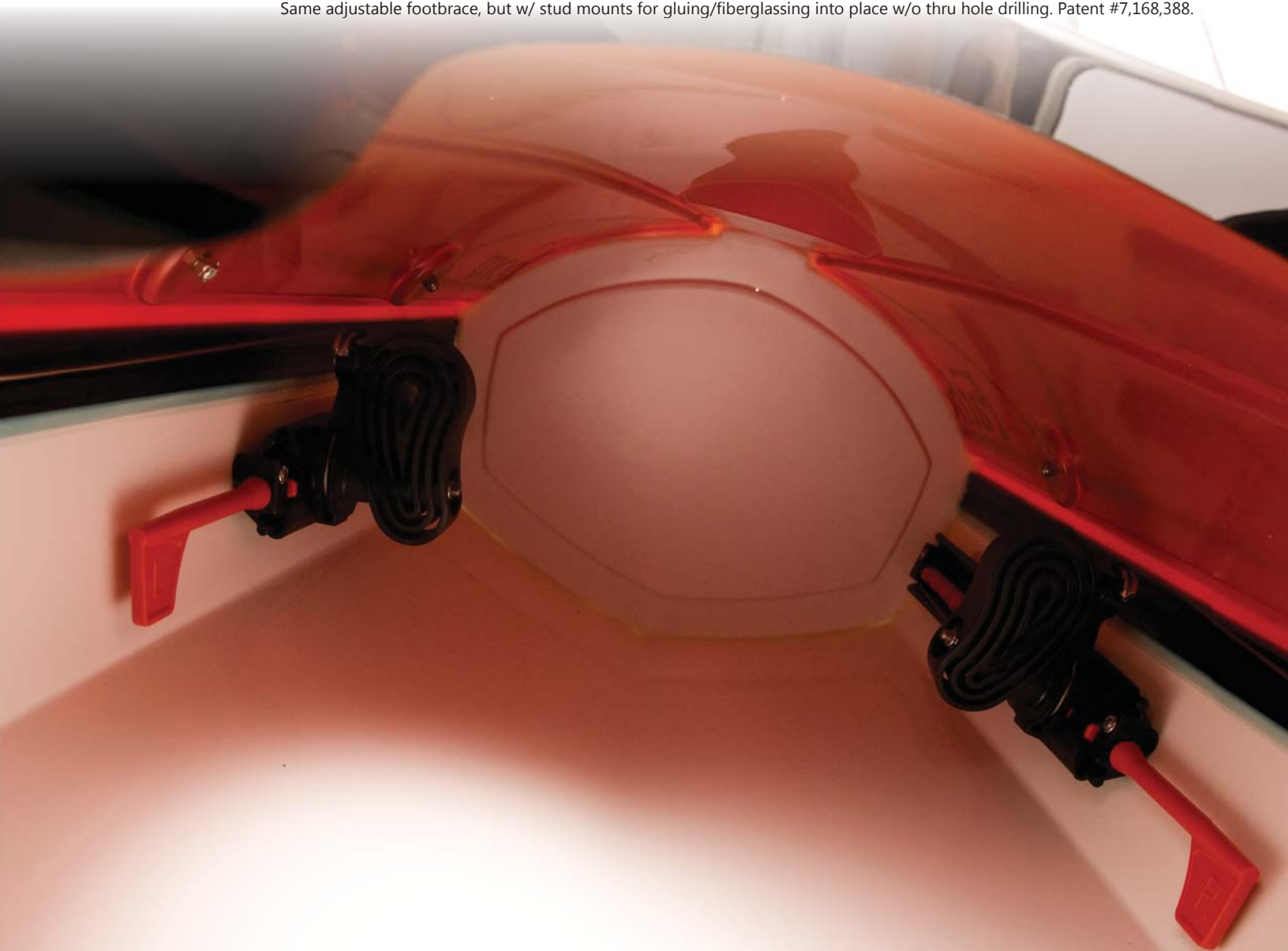

KAYAK ADJUSTABLE FOOTBRACE W/ RUDDER CONTROL

Injection Molding Polypropylene Fiberglass/Nylon

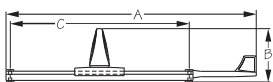

Bulk #	Display #	A	B	C	Rod Color	Wt.(lb.)	Std. Pack
K747200	K747200-1	20-1/4"	4-1/4"	14-1/2"	Red	1.50	1 pr
K747200B	K747200B-1	20-1/4"	4-1/4"	14-1/2"	Black	1.50	1 pr

Our Kayak Adjustable Footbrace w/ Rudder Control offers the same great benefits as its fixed counterpart ... but you guessed it, they have the added benefit of rudder control capabilities. With gas pedal operation for superior control while maintaining a solid brace, they're one of the easiest footbraces to adjust while on the water, and available with either a black or red rod. Purchase the Rudder Control Upgrade Kit (Item # K747250-1) and turn our fixed footbraces into a pair of rudder control footbrace by simply swapping out the pedals. Patent #7,168,388.

KAYAK ADJ. FOOTBRACE W/ RUDDER CONTROL (STUD MOUNT)

Injection Molding Polypropylene Fiberglass/Nylon

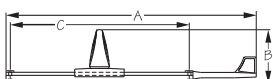

Bulk #	Display #	A	B	C	Rod Color	Wt.(lb.)	Std. Pack
K747210	K747210-1	20-1/4"	4-1/4"	14-1/2"	Red	1.50	1 pr
K747210B	K747210B-1	20-1/4"	4-1/4"	14-1/2"	Black	1.50	1 pr

Same adjustable footbrace w/ rudder control, but with stud mounts for gluing/fiberglassing into place w/o thru hole drilling. Patent #7,168,388.

RUDDER CONTROL UPGRADE KIT

Injection Molding Polypropylene Fiberglass/Nylon



Bulk #	Display #	Description	Wt.(lb.)	Std. Pack
n/a	K747250-1	Rudder Control Upgrade Kit	1.10	10 set

Kit includes left & right pedals needed to upgrade standard footbrace to rudder control.

KAYAK FOOTBRACE CABLE ADJUSTER KIT

Nylon/Aluminum

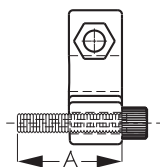

Bulk #	Display #	A	Mount Type	Color	Wt.(lb.)	Std. Pack
K747260	K747260-1	1-5/16"	Thru Hull	Black	.04	10 ea / 10 pr
K747265	K747265-1	1-5/16"	Stud	Black	.04	10 ea / 10 pr

Kayak footbrace cable adjuster kit fits all SEA-LECT Designs kayak footbraces. The adjuster is great for fine tuning cable. Available in thru hull mount or stud mount.

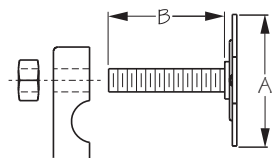

STUD MOUNT & STUD MOUNT KIT

304 Stainless/Nylon



Bulk #	Display #	A	B	Size/Thread	Wt.(lb.)	Std. Pack
K900110	n/a	1-7/8"	1-1/4"	1/4"-20	.05	1 ea
n/a	K747270-1	Kit includes four Stud Mounts			.25	10 set

Stud Mount Kit includes four Studs, four Clamps and four Nyloc Nuts. Great for gluing/fiberglassing into place without thru hole drilling.

TRUCOURSE™ RUDDER & FOOTBRACE KIT

Injection Molded Polypropylene Fiberglass/Nylon



Bulk #	Display #	A	B	C	D	E	Wt.(lb.)	Std. Pack
n/a	K748100-3	17"	3"	3/8"	6-1/4"	4-1/4"	3.00	1 set
n/a	K748151-1	Rudder Rigging Kit					.65	10 ea

Kit includes TruCourse™ Rudder (K758150), Kayak Adjustable Footbrace w/ Rudder Control (K748200) and Rudder Rigging Kit (K748151-1). Rudder Rigging Kit includes most materials needed to attach a rudder to a kayak, except gudgeons. Footbrace Patent #7,168,388, Rudder International Patent Pending.

TRUCOURSE™ RUDDER

Injection Molded Polypropylene Fiberglass/Nylon

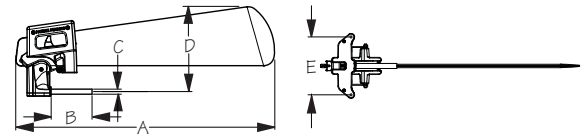

Bulk #	Display #	A	B	C	D	E	Wt.(lb.)	Std. Pack
K748150	K748150-3	17"	3"	3/8"	6-1/4"	4-1/4"	1.50	1 set
K748175	K748175-1	Replacement Blade					.05	1 ea

International Patent Pending.

RUDDER MOUNTING GUDGEON (FLAT STERN)

Stamped 304 Stainless



NEW ITEM

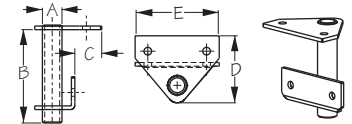

Bulk #	Display #	A	B	C	D	E	Wt.(lb.)	Std. Pack
K748200	K748200-1	3/8"	2-3/8"	11/16"	1-11/16"	2-1/8"	.06	5 ea

Gudgeons needed for mounting our TruCourse™ Rudder on most kayaks without existing brackets.

RUDDER MOUNTING GUDGEON (POINTED STERN)

Stamped 304 Stainless



NEW ITEM

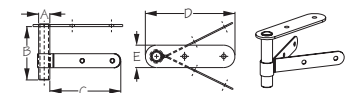

Bulk #	Display #	A	B	C	D	E	Wt.(lb.)	Std. Pack
K748250	K748250-1	3/8"	2-3/8"	3-1/4"	4"	1"	.06	5 ea



KAYAK HATCH COVERS - OVAL

Injection Molded Nylon

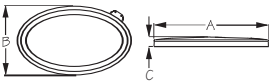

Bulk #	Display #	A	B	C	Style	Wt.(lb.)	Std. Pack
n/a	K745170-1	17-1/4" (Lid Only)	10"	1-3/4"	Oval	.84	1 ea
K745175	K745175-1	17-1/4" (Ring Only)	10"		Oval	.57	1 ea
K745179	K745179-1	17-1/4" (Lid & Ring)	10"		Oval	1.41	1 ea

KAYAK HATCH COVERS - OVAL

Injection Molded Nylon

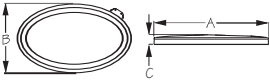

Bulk #	Display #	A	B	C	Style	Wt.(lb.)	Std. Pack
n/a	K745160-1	17-5/8" (Lid Only)	12-3/4"	1-3/4"	Oval	.84	1 ea
K745165	K745165-1	17-5/8" (Ring Only)	12-3/4"		Oval	.57	1 ea
K745169	K745169-1	17-5/8" (Lid & Ring)	12-3/4"		Oval	1.41	1 ea

KAYAK HATCH COVERS - ROUND

Injection Molded Nylon

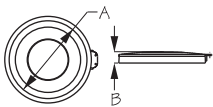

Bulk #	Display #	A	B	Style	Wt.(lb.)	Std. Pack
n/a	K746080-1	8" (Lid Only)	1-1/8"	Round	.54	1 ea
K746085	K746085-1	8" (Ring)		Round	.37	1 ea
K746089	K746089-1	8" (Lid & Ring)		Round	.91	1 ea

KAYAK HATCH COVERS - ROUND

Injection Molded Nylon

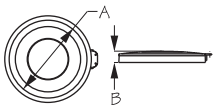

Bulk #	Display #	A	B	Style	Wt.(lb.)	Std. Pack
n/a	K746100-1	10" (Lid Only)	1-1/4"	Round	.74	1 ea
K746105	K746105-1	10" (Ring)		Round	.47	1 ea
K746109	K746109-1	10" (Lid & Ring)		Round	1.21	1 ea



QUARTER-TURN DECK PLATE

Injection Molded ABS

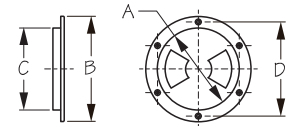

Bulk #	Display #	A	B	C	D	Color	Lid Texture	Fastener	Wt.(lb.)	Std. Pack
K336140	K336140-1	4-1/2"	6-1/8"	4-1/2"	5-3/8"	White	Smooth	#8 OH	.28	10 ea
K336145	K336145-1	4-1/2"	6-1/8"	4-1/2"	5-3/8"	Black	Smooth	#8 OH	.28	10 ea
K336160	K336160-1	6-1/2"	8-1/8"	6-1/2"	7-3/8"	White	Smooth	#8 OH	.41	10 ea
K336162	K336162-1	6-1/2"	8-1/8"	6-1/2"	7-3/8"	White	Textured	#8 OH	.41	10 ea
K336165	K336165-1	6-1/2"	8-1/8"	6-1/2"	7-3/8"	Black	Smooth	#8 OH	.41	10 ea
K336167	K336167-1	6-1/2"	8-1/8"	6-1/2"	7-3/8"	Black	Textured	#8 OH	.41	10 ea
K336180	K336180-1	8-3/8"	10"	8-3/8"	9"	White	Smooth	#8 OH	.55	10 ea
K336182	K336182-1	8-3/8"	10"	8-3/8"	9"	White	Textured	#8 OH	.55	10 ea
K336185	K336185-1	8-3/8"	10"	8-3/8"	9"	Black	Smooth	#8 OH	.55	10 ea
K336187	K336187-1	8-3/8"	10"	8-3/8"	9"	Black	Textured	#8 OH	.55	10 ea

SEA-LECT Designs Quarter-Turn Deck Plates are UV stabilized and feature a new locking system that prevents over tightening, jamming and cross threading. A specially engineered lubricated gasket is used in conjunction with a knife edge for a leak tested seal. Custom colors available.

POP-OUT DECK PLATE

Injection Molded ABS/Polycarbonate

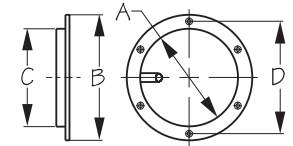

Bulk #	Display #	A	B	C	D	Color	Lid Texture	Fastener	Wt.(lb.)	Std. Pack
K336260	K336260-1	6-1/2"	8-1/8"	6-1/2"	7-3/8"	White	Smooth	#8 OH	.58	10 ea
K336261	K336261-1	6-1/2"	8-1/8"	6-1/2"	7-3/8"	White	Clear	#8 OH	.58	10 ea
K336262	K336262-1	6-1/2"	8-1/8"	6-1/2"	7-3/8"	White	Textured	#8 OH	.58	10 ea
K336265	K336265-1	6-1/2"	8-1/8"	6-1/2"	7-3/8"	Black	Smooth	#8 OH	.58	10 ea
K336266	K336266-1	6-1/2"	8-1/8"	6-1/2"	7-3/8"	Black	Clear	#8 OH	.58	10 ea
K336267	K336267-1	6-1/2"	8-1/8"	6-1/2"	7-3/8"	Black	Textured	#8 OH	.58	10 ea
K336267G	K336267G-1	6-1/2"	8-1/8"	6-1/2"	7-3/8"	Gray	Textured	#8 OH	.58	10 ea
K336280	K336280-1	8-1/2"	10"	8-3/8"	9"	White	Smooth	#8 OH	.83	10 ea
K336281	K336281-1	8-1/2"	10"	8-3/8"	9"	White	Clear	#8 OH	.83	10 ea
K336282	K336282-1	8-1/2"	10"	8-3/8"	9"	White	Textured	#8 OH	.83	10 ea
K336285	K336285-1	8-1/2"	10"	8-3/8"	9"	Black	Smooth	#8 OH	.83	10 ea
K336286	K336286-1	8-1/2"	10"	8-3/8"	9"	Black	Clear	#8 OH	.83	10 ea
K336287	K336287-1	8-1/2"	10"	8-3/8"	9"	Black	Textured	#8 OH	.83	10 ea
K336287G	K336287G-1	8-1/2"	10"	8-3/8"	9"	Gray	Textured	#8 OH	.83	10 ea

SEA-LECT Designs Pop-Out Deck Plates are UV stabilized and feature an integrated pop-up lever which makes opening and closing a snap; no tools required. Engineered rubber O-ring for a watertight fit. Available with either a smooth or textured non-skid lid. Custom colors available.

INSPECTION COVER

Injection Molded ABS

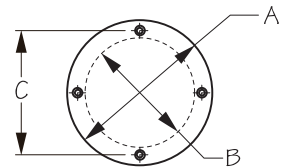

Bulk #	Display #	Color	A	B	C	Fastener	Wt.(lb.)	Std. Pack
K337050	K337050-1	Black	5-5/8"	4-1/4"	4-13/16"	#10 OH	.11	10 ea
K337051	K337051-1	White	5-5/8"	4-1/4"	4-13/16"	#10 OH	.11	10 ea

SCREW OUT DECK PLATE

Injection Molded ABS

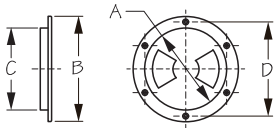

Bulk #	Display #	A	B	C	D	Color	Fastener	Wt.(lb.)	Std. Pack
K337140	K337140-1	4-7/16"	5-3/4"	4-1/2"	5-1/8"	White	#8 OH	.19	10 ea
K337145	K337145-1	4-7/16"	5-3/4"	4-1/2"	5-1/8"	Black	#8 OH	.19	10 ea
K337150	K337150-1	5-7/16"	6-3/4"	5-1/2"	6-1/8"	White	#8 OH	.25	10 ea
K337155	K337155-1	5-7/16"	6-3/4"	5-1/2"	6-1/8"	Black	#8 OH	.25	10 ea
K337160	K337160-1	6-1/2"	8-1/8"	6-1/2"	7-1/4"	White	#8 OH	.44	10 ea
K337165	K337165-1	6-1/2"	8-1/8"	6-1/2"	7-1/4"	Black	#8 OH	.44	10 ea



SEA-LECT Designs Screw Out Deck Plates are molded to the highest standards using top quality UV stabilizers and antioxidants. Use silicone sealant on hull or deck surface when installing the deck plate. Keep threads clean with hot soapy water. Lubricate with Vaseline or Teflon grease.

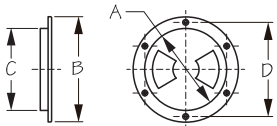

SCREW OUT DECK PLATE W/ CLEAR COVER

Injection Molded ABS/Polycarbonate

Bulk #	Display #	A	B	C	D	Color	Fastener	Wt.(lb.)	Std. Pack
K337146	K337146-1	4-7/16"	5-3/4"	4-1/2"	5-1/8"	Black	#8 OH	.22	10 ea
K337151	K337151-1	5-7/16"	6-3/4"	5-1/2"	6-1/8"	White	#8 OH	.29	10 ea
K337156	K337156-1	5-7/16"	6-3/4"	5-1/2"	6-1/8"	Black	#8 OH	.29	10 ea
K337161	K337161-1	6-1/2"	8-1/8"	6-1/2"	7-1/4"	White	#8 OH	.44	10 ea
K337166	K337166-1	6-1/2"	8-1/8"	6-1/2"	7-1/4"	Black	#8 OH	.44	10 ea



The SEA-LECT Designs Screw Out Deck Plate with clear polycarbonate lid allows visual inspection of watertight compartments without removing the lid.



SCREW OUT DECK PLATE W/ INTERNAL COLLAR

Injection Molded ABS

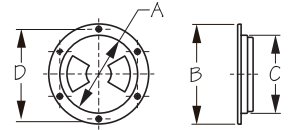

Bulk #	Display #	A	B	C	D	Color	Fastener	Wt.(lb.)	Std. Pack	
K337142	K337142-1	4-7/16"	5-3/4"	4-1/2"	5-1/8"	White	#8 OH	.18	10 ea	
K337147	K337147-1	4-7/16"	5-3/4"	4-1/2"	5-1/8"	Black	#8 OH	.18	10 ea	
K337152	K337152-1	5-7/16"	6-3/4"	5-1/2"	6-1/8"	White	#8 OH	.31	10 ea	
K337157	K337157-1	5-7/16"	6-3/4"	5-1/2"	6-1/8"	Black	#8 OH	.31	10 ea	
K337162	K337162-1	6-1/2"	8-1/8"	6-1/2"	7-1/4"	White	#8 OH	.46	10 ea	
K337167	K337167-1	6-1/2"	8-1/8"	6-1/2"	7-1/4"	Black	#8 OH	.46	10 ea	
K337199	K337199-1	Lid retaining strap - 8"							.01	10 ea
KOP33794	KOP33794-1	4" Polyethylene Ring							.02	10 ea
KOP33795	KOP33795-1	5" Polyethylene Ring							.03	10 ea

These SEA-LECT Designs Screw Out Deck Plates are molded with a collar on the bottom to hold deck plate bags or other round containers. Use silicone sealant on hull or deck surface when installing the deck plate. Lubricate with Teflon grease or Vaseline and clean with hot, soapy water. Also available are 4" and 5" Polyethylene rings (listed above) which can be used in making your own deck plate bags.

DECK PLATE BAG W/ DRAW STRING CLOSURE

Nylon/Stainless Steel



NEW ITEM

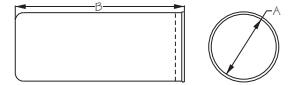

Bulk #	Display #	A	B	Wt.(lb.)	Std. Pack
K337149R	K337149R-1	4"	10"	.06	10 ea
K337169R	K337169R-1	6"	10"	.08	10 ea

Designed for use with Screw Out Deck Plate w/ Internal Collar; 4" fits item #'s K337142 and K337147, 6" fits item #'s K337162 and K337167.

DECK PLATE BAG (WATER RESISTANT)

PVC Coated Polyester/Stainless Steel



NEW ITEM

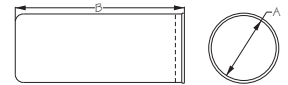

Bulk #	Display #	A	B	Wt.(lb.)	Std. Pack
K337149WR	K337149WR-1	4"	5-1/2"	.15	10 ea

Designed for use with Screw Out Deck Plate w/ Internal Collar; 4" fits item #'s K337142 and K337147.

DRAIN TUBE

Injection Molded HDPE

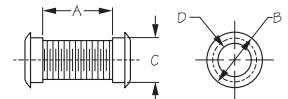

Bulk #	Display #	A	B	C	D	Color	Wt.(lb.)	Std. Pack
K520320	K520320-1	3/4" - 2-1/2"	1-1/4"	1"	3/4"	White	.02	10 ea
K520323	K520323-1	3/4" - 2-1/2"	1-1/4"	1"	3/4"	Black	.02	10 ea

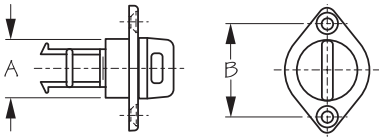

DRAIN PLUG

Injection Molded Nylon



Bulk #	Display #	A	B	Fastener	Wt.(lb.)	Std. Pack
K520010	K520010-1	1"	1-1/2"	#10 OH	.03	10 ea
K520021	K520021-1	Replacement Plug			.01	10 ea / 10 pr

This Drain Plug is designed with a molded-in recess in the base, thus trapping the sealant in place and providing a more watertight seal. Coarse thread design.

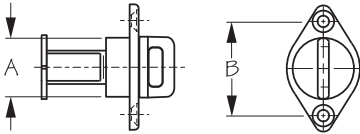

DRAIN PLUG

Injection Molded Nylon



Bulk #	Display #	A	B	Fastener	Wt.(lb.)	Std. Pack
K520015	K520015-1	1"	1-1/2"	#10 PH	.03	10 ea
K520016	K520016-1	Replacement Plug			.01	10 ea / 10 pr

This Drain Plug is designed with a molded-in recess in the base, thus trapping the sealant in place and providing a more watertight seal. Fine thread design.

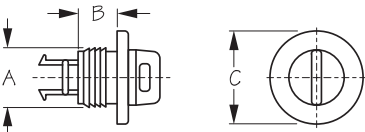

DRAIN PLUG

Injection Molded Nylon



Bulk #	Display #	A	B	C	Fastener	Wt.(lb.)	Std. Pack
K520030	K520030-1	1"	11/16"	1-11/16"	None	.04	10 ea
K520021	K520021-1	Replacement Plug				.01	10 ea / 10 pr

Designed to fit securely in a 1" hole without the use of fasteners. The ridges on the body of the Drain Plug are designed to keep the plug in place. Sealant should be applied prior to installation to make a watertight seal.

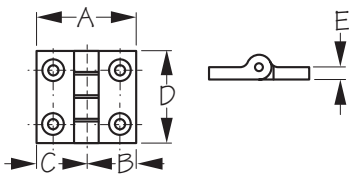

BUTT HINGE

Injection Molded Fiberglass Nylon/Stainless Steel Pin



Bulk #	Display #	A	B	C	D	E	Color	Fastener	Wt.(lb.)	Std. Pack
K202580	K202580-1	1-1/2"	3/4"	3/4"	1-3/8"	3/16"	Black	#8 OH	.03	10 ea / 10 pr
K202581	K202581-1	1-1/2"	3/4"	3/4"	1-3/8"	3/16"	White	#8 OH	.03	10 ea / 10 pr

Available in custom colors for large volume orders.

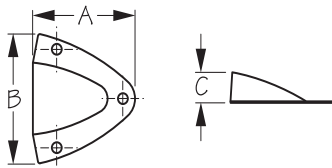

MIDGET VENT

Stamped 304 Stainless



Bulk #	Display #	A	B	C	Vent Area	Fastener	Wt.(lb.)	Std. Pack
K331360	K331360-1	1-5/8"	1-3/4"	1/2"	.29 in ²	#6 PH	.01	10 ea

KAYAK CARRYING HANDLE SET

Injection Molded Nylon/Polypropylene

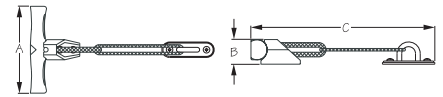

Bulk #	Display #	A	B	C	Wt.(lb.)	Std. Pack
n/a	K736400-1	4-1/4"	1-3/16"	8-15/16"	.20	10 ea
K736410	n/a	Handle Base Only			.03	10 ea

KAYAK CARRYING HANDLE & INSERT

Injection Molded Polypropylene

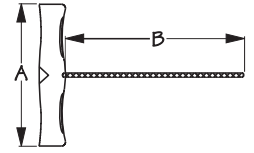

Bulk #	Display #	A	B	Wt.(lb.)	Std. Pack
K736451	K736451-1	4-1/4"	7"	.05	10 ea / 10 set

Display pack includes 18" cord. Cap has insert to accommodate custom logos.

WEBBING HANDLE W/ CAPS

Injection Molded Nylon/Webbing

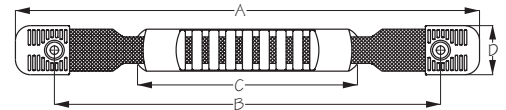

NEW ITEM

Bulk #	Display #	A	B	C	D	Grip Range	Fastener	Wt.(lb.)	Std. Pack
K736462	K736462-1	11-1/2"	10"	5"	1"	4"-10"	#10 PH	.09	10 ea

CLAMCLEAT® JR.

Injection Molded Nylon

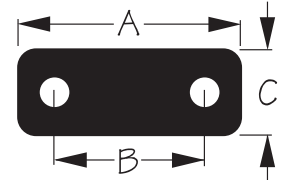

Bulk #	Display #	A	B	C	Line Size	Color	Fastener	Wt.(lb.)	Std. Pack
K002030	K002030-1	3-1/4"	2-5/8"	11/16"	1/8"-1/4"	Black	#8 OH	.04	10 ea

CLAMCLEAT® MINI

Injection Molded Nylon

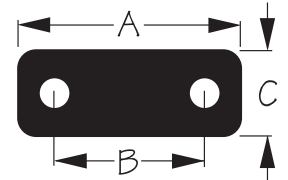

Bulk #	Display #	A	B	C	Line Size	Color	Fastener	Wt.(lb.)	Std. Pack
K002040	K002040-1	2-1/16"	1-7/16"	5/8"	1/8"-1/4"	Black	#8 OH	.02	10 ea

CLAMCLEAT® MIDI

Injection Molded Nylon

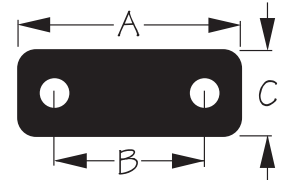

Bulk #	Display #	A	B	C	Line Size	Color	Fastener	Wt.(lb.)	Std. Pack
K002090	K002090-1	2-7/8"	2-1/8"	3/4"	5/32"-5/16"	Black	#10 OH	.04	10 ea

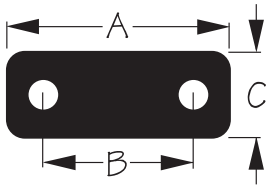

CLAMCLEAT® LEECH LINE

Injection Molded Nylon



Bulk #	Display #	A	B	C	Line Size	Color	Fastener	Wt.(lb.)	Std. Pack
K002120	K002120-1	2-3/4"	1-15/16"	13/16"	1/16"-3/16"	White	#8 OH	.03	10 ea

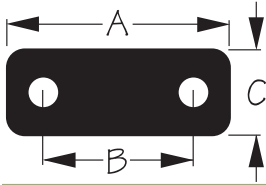

CLAMCLEAT® FINE LINE STARBOARD

Injection Molded Nylon



Bulk #	Display #	A	B	C	Line Size	Color	Fastener	Wt.(lb.)	Std. Pack
K002130	K002130-1	2-3/4"	1-15/16"	13/16"	1/16"-3/16"	Black	#8 OH	.02	10 ea

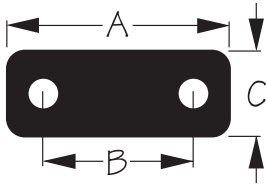

CLAMCLEAT® FINE LINE PORT

Injection Molded Nylon



Bulk #	Display #	A	B	C	Line Size	Color	Fastener	Wt.(lb.)	Std. Pack
K002140	K002140-1	2-3/4"	1-15/16"	13/16"	1/16"-3/16"	Black	#8 OH	.02	10 ea

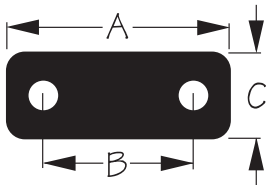

CLAMCLEAT® RACING ROLLER JR.

Injection Molded Nylon



Bulk #	Display #	A	B	C	Line Size	Color	Fastener	Wt.(lb.)	Std. Pack
K002300	K002300-1	3-1/4"	2-5/8"	11/16"	1/8"-1/4"	Silver	#10 OH	.08	10 ea

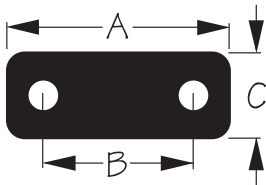

CLAMCLEAT® LINE LOCK

Injection Molded Nylon



Bulk #	Display #	A	B	C	Line Size	Color	Fastener	Wt.(lb.)	Std. Pack
K002600	K002600-1	3-1/4"	2-5/8"	11/16"	1/16"-3/16"	Black	None	.01	10 ea / 10 pr
K002660	K002660-1	13/16"	5/16"	1/4"	3/64"-1/8"	Black	None	.01	10 ea / 10 pr
K002663	K002663-1	13/16"	5/16"	1/4"	3/64"-1/8"	White	None	.01	10 ea / 10 pr

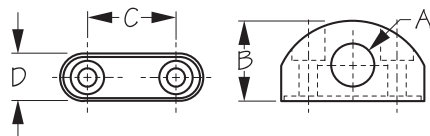

FAIRLEAD

Injection Molded Nylon



Bulk #	Display #	Color	A	B	C	D	Fastener	Wt.(lb.)	Std. Pack
K082010	K082010-1	Black	3/8"	3/4"	7/8"	7/16"	#8 PH	.01	10 ea / 10 pr
K082051	K082051-1	Black	9/16"	1-1/8"	1"	11/16"	#8 PH	.03	10 ea / 10 pr
K082016	K082016-1	Black	5/8"	1-1/4"	1-3/8"	13/16"	#10 PH	.06	10 ea / 10 pr

OPEN BASE CLEAT

Injection Molded Nylon

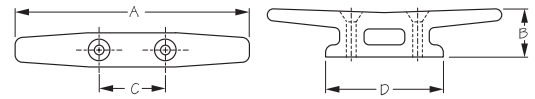

Bulk #	Display #	Color	A	B	C	D	Fastener	Wt.(lb.)	Std. Pack
K043030	K043030-1	Black	3"	11/16"	1"	1-5/8"	#6 OH	.03	10 ea / 10 pr
K043040	K043040-1	Black	4"	7/8"	1-1/8"	2"	#8 OH	.03	10 ea / 10 pr
K043050	K043050-1	Black	5"	1-1/16"	1-7/16"	2-1/2"	#10 OH	.06	10 ea / 10 pr

All SEA-LECT Designs Open Base Nylon Cleats are designed with a molded-in recess in the base which traps sealant in place increasing watertightness. Available in custom colors on large volume orders.

HEAVY DUTY CLEAT

Injection Molded Nylon

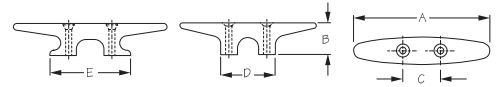

Bulk #	Display #	Color	A	B	C	D	E	Fastener	Wt.(lb.)	Std. Pack
K043340	K043340-1	Black	4-1/4"	1"	1-1/4"	1-3/4"	n/a	#10 OH	.06	10 ea / 10 pr

Available in custom colors on large volume orders.

ZIG ZAG CLEAT

Injection Molded Nylon

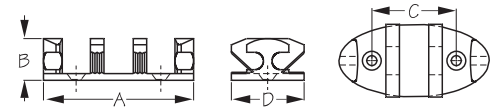

Bulk #	Display #	A	B	C	D	Fastener	Wt.(lb.)	Std. Pack
K043540	K043540-1	3-1/2"	15/16"	1-15/16"	1-3/4"	#10 OH	.08	10 ea

PAD EYE

Injection Molded Nylon

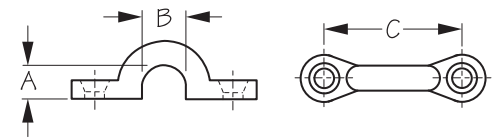

Bulk #	Display #	Color	A	B	C	Fastener	Wt.(lb.)	Std. Pack
K081310	K081310-1	Black	3/8"	1/2"	1-3/8"	#8 OH	.01	100 ea / 10 set
K081311	K081311-1	White	3/8"	1/2"	1-3/8"	#8 OH	.01	100 ea / 10 set
K081314	K081314-1	Duck Brown	3/8"	1/2"	1-3/8"	#8 OH	.01	100 ea / 10 set

Available in custom colors on large volume orders. Our standard, best-selling pad eye!

POP RIVET MOUNT PAD EYE

Injection Molded Nylon

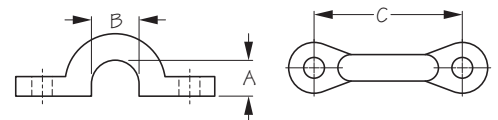

Bulk #	Display #	A	B	C	Color	Fastener	Wt.(lb.)	Std. Pack
K081350	K081350-1	3/8"	1/2"	1-3/8"	Black	3/16" Pop Rivet	.01	100 ea / 10 set

The fastener pads are flat topped to accept 3/16" pop rivets (K799555BK) or pan head screws. The same pad eye with a recess to accept an oval head screw is item # K081310.

PAD EYE

Forged 304 Stainless

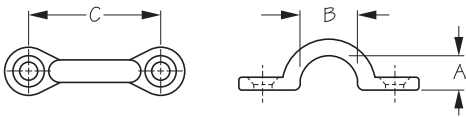

Bulk #	Display #	A	B	C	Fastener	Wt.(lb.)	Std. Pack
K081200	K081200-1	5/16"	3/8"	1-3/8"	#8 OH	.03	10 ea / 10 pr
K081205	K081205-1	3/8"	1/2"	1-5/8"	#10 OH	.05	10 ea / 10 pr

PAD EYE

Die Cast Zinc Chrome Plated

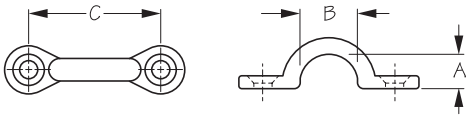

Bulk #	Display #	A	B	C	Fastener	Wt.(lb.)	Std. Pack
K081242	K081242-1	3/8"	1/2"	1-3/8"	#8 OH	.02	20 ea / 10 set

PAD EYE

Forged Bronze Wire

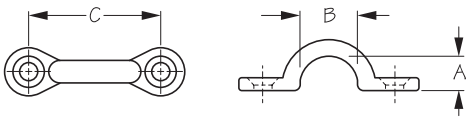

Bulk #	Display #	Finish	A	B	C	Fastener	Wt.(lb.)	Std. Pack
K081270	K081270-1	Bronze	5/16"	3/8"	1-3/8"	#8 OH	.08	10 ea / 10 pr
K081271	K081271-1	Bronze	3/8"	1/2"	1-9/16"	#10 OH	.08	10 ea / 10 pr
K081275	K081275-1	Chrome	5/16"	3/8"	1-3/8"	#8 OH	.08	10 ea / 10 pr
K081276	K081276-1	Chrome	3/8"	1/2"	1-9/16"	#10 OH	.12	10 ea / 10 pr

POP RIVET MOUNT PAD EYE

Investment Cast 316 Stainless

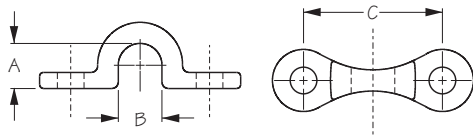

Bulk #	Display #	A	B	C	Fastener	Wt.(lb.)	Std. Pack
K081850	K081850-1	11/32"	11/32"	1-1/16"	3/16" Pop Rivet	.01	10 ea / 10 pr

The fastener pads are flat topped to accept 3/16" pop rivets (K799555BK) or pan head screws.

PAD EYE

Stamped 304 Stainless



NEW ITEM

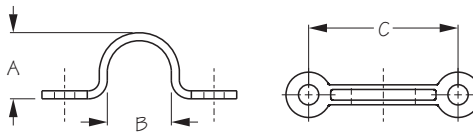

Bulk #	Display #	A	B	C	Fastener	Wt.(lb.)	Std. Pack
K081101	K081101-1	1/2"	7/16"	1-1/8"	#6 PH	.04	10 ea / 10 pr
K081102	K081102-1	5/8"	9/16"	1-3/8"	#8 PH	.04	10 ea / 10 pr
K081103	K081103-1	3/4"	3/4"	1-3/4"	#10 PH	.06	10 ea / 10 pr
K081104	K081104-1	1"	1-1/8"	2-1/2"	#10 PH	.03	10 ea / 10 pr

BOW EYE

Machined 304 Stainless

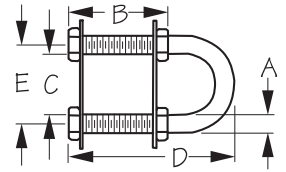

Bulk #	Display #	Thread	A	B	C	D	E	Breaking Strength	Wt.(lb.)	Std. Pack
K080031	K080031-1	3/8" NC	3/8"	1-1/2"	1-1/16"	2-7/8"	1-7/16"	16,000 lb.	.22	10 ea

SEA-LECT Designs Bow Eyes come with adjustable finished nuts as compared to the crimped ring used on most other bow eyes. The 3/8" shafts have rolled threads. Plate Size: 2-1/4" x 3/4".

OBLONG EYE PLATE

Stamped 304 Stainless

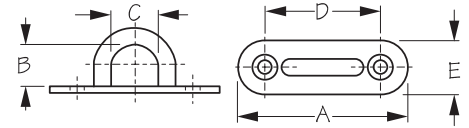

Bulk #	Display #	A	B	C	D	E	Fastener	Wt.(lb.)	Std. Pack
K089701	K089701-1	2-1/8"	1/2"	5/8"	1-1/2"	5/8"	#10 OH	.03	10 ea
K089702	K089702-1	2-9/16"	5/8"	3/4"	1-13/16"	3/4"	#10 OH	.07	10 ea
K089703	K089703-1	3-3/16"	13/16"	7/8"	2-3/16"	15/16"	#10 OH	.14	10 ea

TIE DOWN EYE STRAP

Forged Bronze Wire Chrome Plated

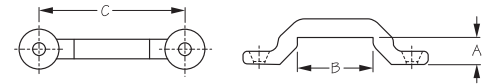

Bulk #	Display #	A	B	C	Fastener	Wt.(lb.)	Std. Pack
K081251	K081251-1	3/8"		1-1/16"	#10 OH	.06	10 ea / 10 pr
K081252	K081252-1	3/8"		2"	#10 OH	.07	10 ea / 10 pr

Tie Down Eye Straps can be used for a multiple of hold down applications. Available in two sizes, fitting 1" and 2" webbing, they are commonly used to hold down batteries, fuel tanks, ice chests, life rafts, dinghies, etc.

TIE DOWN EYE STRAP

Forged 304 Stainless



Bulk #	Display #	A	B	C	D	Fastener	Wt.(lb.)	Std. Pack
K081261	K081261-1	3/8"	1-1/16"	2-1/8"	1/4"	#10 OH	.06	10 ea / 10 pr
K081262	K081262-1	3/8"	2"	3-1/8"	1/4"	#10 OH	.07	10 ea / 10 pr

FOOTMANS LOOP

Injection Molded Nylon

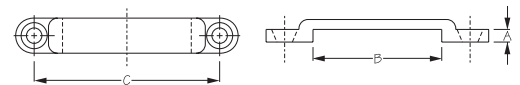

Bulk #	Display #	Color	A	B	C	Fastener	Wt.(lb.)	Std. Pack
K081370	K081370-1	Black	3/16"	1-5/8"	2-15/16"	#10 OH	.01	20 ea / 10 set
K081380	K081380-1	Black	3/16"	1"	2"	#10 OH	.01	20 ea / 10 set

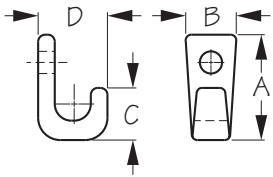

LASHING HOOKS

Injection Molded Nylon



Bulk #	Display #	A	B	C	D	Color	Fastener	Wt.(lb.)	Std. Pack
K671425	K671425-1	15/16"	7/16"	7/16"	5/8"	Black	#8 PH	.01	100 ea / 10 set
K671426	K671426-1	15/16"	7/16"	7/16"	5/8"	White	#8 PH	.01	100 ea / 10 set

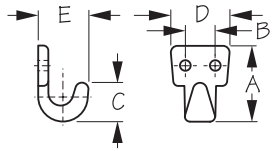

LASHING HOOKS - SMALL

Injection Molded Nylon



Bulk #	Display #	A	B	C	D	E	Color	Fastener	Wt.(lb.)	Std. Pack
K671420	K671420-1	7/8"	3/8"	1/2"	3/4"	5/8"	Black	#6 PH	.01	100 ea / 10 set
K671421	K671421-1	7/8"	3/8"	1/2"	3/4"	5/8"	White	#6 PH	.01	100 ea / 10 set

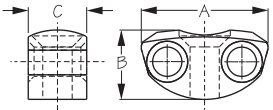

KAYAK DECK LINE GUIDE - SMALL

Injection Molded Nylon



Bulk #	Display #	A	B	C	Fastener	Wt.(lb.)	Std. Pack
K736510	K736510-1	1-1/16"		9/16"	#10 OH	.05	100 ea / 10 set

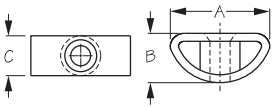

KAYAK DECK LINE GUIDE - LARGE

Injection Molded Nylon



Bulk #	Display #	A	B	C	Fastener	Wt.(lb.)	Std. Pack
K736520	K736520-1	1-1/2"		5/8"	#10 OH	.05	100 ea / 10 set

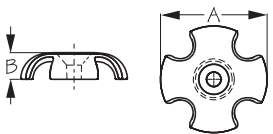

KAYAK DECK LINE GUIDE - ROUND

Injection Molded Fiberglass/Nylon



Bulk #	Display #	A	B	Fastener	Wt.(lb.)	Std. Pack
K736530	K736530-1	1-1/2"	3/8"	#10 OH	.05	100 ea / 10 set

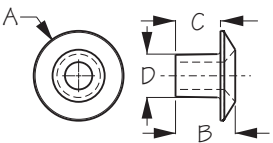

KAYAK DECK FITTING - OPEN ROUND

Injection Molded Nylon



Bulk #	Display #	A	B	C	D	Fastener	Wt.(lb.)	Std. Pack
K736537	K736537-1	3/4"	1/2"	3/8"	7/16"	#10 OH	.05	100 ea / 10 set

FASTENER PACKS

Stainless Steel



NEW ITEM

Bulk #	Display #	Size/Thread	Head	Length	Wt.(lb.)	Std. Pack
n/a	K931103-1	#8-32	Oval (OH)	1/2"	.01	10 set
n/a	K931104-1	#8-32	Oval (OH)	3/4"	.01	10 set
n/a	K931105-1	#8-32	Oval (OH)	1"	.01	10 set
n/a	K931106-1	#8-32	Oval (OH)	1-1/4"	.01	10 set
n/a	K931203-1	#10-32	Oval (OH)	1/2"	.01	10 set
n/a	K931204-1	#10-32	Oval (OH)	3/4"	.01	10 set
n/a	K931205-1	#10-32	Oval (OH)	1"	.01	10 set
n/a	K931206-1	#10-32	Oval (OH)	1-1/4"	.01	10 set
n/a	K932103-1	#8-32	Pan (PH)	1/2"	.01	10 set
n/a	K932104-1	#8-32	Pan (PH)	3/4"	.01	10 set
n/a	K932105-1	#8-32	Pan (PH)	1"	.01	10 set
n/a	K932106-1	#8-32	Pan (PH)	1-1/4"	.01	10 set
n/a	K932203-1	#10-32	Pan (PH)	1/2"	.01	10 set
n/a	K932204-1	#10-32	Pan (PH)	3/4"	.01	10 set
n/a	K932205-1	#10-32	Pan (PH)	1"	.01	10 set
n/a	K932206-1	#10-32	Pan (PH)	1-1/4"	.01	10 set

Pack Includes: (6) Machine Screws, (6) Nyloc Nuts & (6) Flat Washers.

TAPPING SCREW PACKS

Stainless Steel



NEW ITEM

Bulk #	Display #	Size/Thread	Head	Length	Wt.(lb.)	Std. Pack
n/a	K936104-1	#8-32	Oval (OH)	3/4"	.01	10 set
n/a	K936105-1	#8-32	Oval (OH)	1"	.01	10 set
n/a	K936204-1	#10-32	Oval (OH)	3/4"	.01	10 set
n/a	K936205-1	#10-32	Oval (OH)	1"	.01	10 set

Pack Includes: (6) Tapping Screws.

FOOT BRACE REPLACEMENT HARDWARE PACKS

Stainless Steel



NEW ITEM

Bulk #	Display #	Size/Thread	Head	Length	Wt.(lb.)	Std. Pack
n/a	K747280-1	1/4"-20	Truss (TH)	1-1/4"	.15	10 set

Pack Includes: (4) Machine Screws, (4) Nyloc Nuts & (4) Bonded Washers.

FENDER WASHER PACKS

Stainless Steel



NEW ITEM

Bulk #	Display #	Size/Thread	Wt.(lb.)	Std. Pack
n/a	K939501-1	#8	.05	10 set
n/a	K939502-1	#10	.05	10 set

Pack Includes: (6) Fender Washers.

WELL NUTS

Rubber

NEW ITEM



Bulk #	Display #	Size/Thread	Grip Range	Wt.(lb.)	Std. Pack
KOP938501	n/a	#8-32	1/32"-5/32"	.85	1 bag
n/a	K938501-1	#8-32	1/32"-5/32"	.05	10 set
KOP938502	n/a	#10-32	1/32"-1/4"	.85	1 bag
n/a	K938502-1	#10-32	1/32"-1/4"	.05	10 set

Bulk Pack Includes: (100) Well Nuts each. Display Pack Includes: (6) Well Nuts.

DOME HEAD TRI-FOLD RIVETS, 3/16" BLACK

Aluminum



Bulk #	Display #	Hole Size	Grip Range	Wt.(lb.)	Std. Pack
K799555BK	K799555BK-1	13/16"	1/32"-1/2"	.01	1 bag / 10 set

Bulk Pack Includes: (100) Rivets. Display Pack Includes: (10) Rivets.

SPLIT RING

Formed 316 Stainless

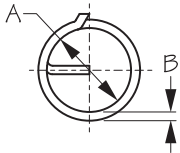

Bulk #	Display #	A	B	Pcs. Per Set	Wt.(lb.)	Std. Pack
K193561	K193561-1	11/32"	1/32"	4	.01	20 ea / 10 set
K193562	K193562-1	15/32"	1/16"	4	.01	20 ea / 10 set
K193563	K193563-1	5/8"	1/16"	4	.01	20 ea / 10 set
K193564	K193564-1	3/4"	3/32"	3	.01	20 ea / 10 set

Note: Display #'s are packed in sets of 4 each.

RELEASE PIN

Formed 304 Stainless

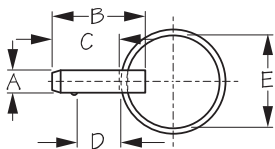

Bulk #	Display #	A	B	C	D	E	Wt.(lb.)	Std. Pack
K193425	K193425-1	1/4"	2-1/2"	2-3/16"	1-15/16"	1"	.04	10 ea

CLEVIS PIN

Formed 316 Stainless

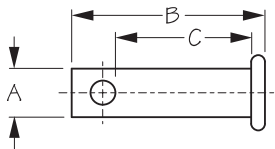

Bulk #	Display #	A	B	C	Wt.(lb.)	Std. Pack
K193605	K193605-1	3/16" - 5 mm	3/4"	9/16"	.01	10 ea

WEBBING BUCKLE

Injection Molded Nylon



NEW ITEM

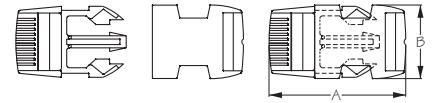

Bulk #	Display #	A	B	Webbing	Wt.(lb.)	Std. Pack
K199141	K199141-1	2-1/2"	1-1/4"	1"	.03	10 ea

WEBBING LADDER LOCK

Injection Molded Nylon



NEW ITEM

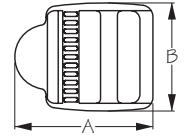

Bulk #	Display #	A	B	Webbing	Wt.(lb.)	Std. Pack
K199131	K199131-1	1-1/2"	1-1/8"	1"	.02	10 ea / 10 pr

THIMBLE W/ SWEDGE

Stamped 304 Stainless

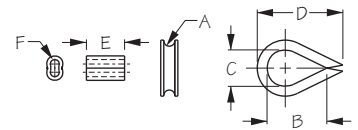

Bulk #	Display #	A (Wire Dia.)	B	C	D	E	F	Wt.(lb.)	Std. Pack
n/a	K171103-1	1/16"	11/16"	3/8"	7/8"	3/8"	1/16"	.03	10 pr
K171103	n/a	Thimble Only						.02	100 ea
K0P74802	n/a	Swedge Only						.01	100 ea

Item # K171103-1 includes 2 Thimbles & 2 Swedges each. Items #'s K171103 (Thimbles) and K0P74802 (Swedges) are packed 100 per bag.

UL CABLE CLAMP

Injection Molded Nylon

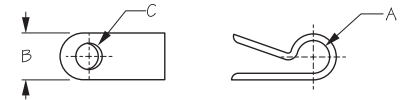

Bulk #	Display #	Color	A	B	C	Qty Per Bag	Wt.(lb.)	Std. Pack
K428031	K428031-2	White	1/8"	3/8"	3/16"	25	.03	100 ea / 10 set
K428231	K428231-2	Black	1/8"	3/8"	3/16"	25	.03	100 ea / 10 set
K428232	K428232-2	Black	3/16"	3/8"	3/16"	25	.03	100 ea / 10 set
K428233	K428233-2	Black	1/4"	3/8"	3/16"	25	.03	100 ea / 10 set

DECK BUNGEE KIT

Injection Molded Nylon/Polypro



NEW ITEM

Bulk #	Display #	Bungee/Length	Fasteners Included	Wt.(lb.)	Std. Pack
n/a	K749530-1	1/4"/11'	Yes	.50	5 ea

Kit Includes: (1) 11' Deck Bungee, (6) Nylon Pad Eyes, (1) Mounting Fastener Pack & Easy Install Instructions.

ELASTIC SHOCK CORD

Formed Stainless Hook/Natural Rubber with Nylon Cover

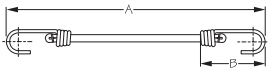

Bulk #	Display #	A	B	Diameter	Wt.(lb.)	Std. Pack
n/a	K651180-1	18"	2-1/2"	3/8"	.17	10 ea
n/a	K651240-1	24"	2-1/2"	3/8"	.19	10 ea
n/a	K651300-1	30"	2-1/2"	3/8"	.22	10 ea
n/a	K651360-1	36"	2-1/2"	3/8"	.24	10 ea
n/a	K651400-1	40"	2-1/2"	3/8"	.26	10 ea

SHOCK CORD HOOKS & CRIMPS

Formed 304 Stainless

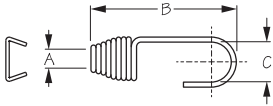

Bulk #	Display #	# of Hooks	# of Crimps	A	B	C	Wt.(lb.)	Std. Pack
K657060	n/a	1	n/a	1/4"	2"	5/8"	.01	10 ea
n/a	K657060-1	2	2	1/4"	2"	5/8"	.03	10 pr
K657065	n/a	n/a	1	1/4"			.02	100 ea
n/a	K657065-1	n/a	10	1/4"			.04	10 set
K657080	n/a	1	n/a	5/16"	2-1/2"	7/8"	.04	10 ea
n/a	K657080-1	2	2	5/16"	2-1/2"	7/8"	.08	10 pr
K657085	n/a	n/a	1	5/16"			.01	100 ea
n/a	K657085-1	n/a	10	5/16"			.03	10 set
K657100	n/a	1	n/a	3/8"	2-5/8"	15/16"	.06	10 ea
n/a	K657100-1	2	2	3/8"	2-5/8"	15/16"	.12	10 pr
K657105	n/a	n/a	1	3/8"			.01	100 ea
n/a	K657105-1	n/a	10	3/8"			.03	10 set

Items #'s K657065, K657085 and K657105 contain crimps only. K657065-1, K657085-1 and K657105-1 contain crimps only and are packed 10 each per set.





DECK UTILITY LINE (SPOOL)

Polyester



Bulk #	Display #	Line Size	Spool Feet	Color	Wt.(lb.)	Std. Pack
K615567BK	n/a	3/16"	1000'	Black	8.50	1 spool



POLYPRO BUNGEE CORD (SPOOL)

Natural Rubber with Polyethylene Cover



Bulk #	Display #	Line Size	Spool Feet	Color	Wt.(lb.)	Std. Pack
K655046BK	n/a	1/8"	500'	Black	4.20	1 spool
K655066BK	n/a	3/16"	500'	Black	5.40	1 spool
K655067BK	n/a	3/16"	1000'	Black	9.00	1 spool
K655075BKF	n/a	7/32"	250'	Black w/ Reflective Tracer	3.10	1 spool
K655086BK	n/a	1/4"	500'	Black	9.30	1 spool
K655087BK	n/a	1/4"	1000'	Black	16.80	1 spool



RUDDER CABLE (SPOOL)

Stainless Steel



Bulk #	Display #	Cable Size	Spool Feet	Wt.(lb.)	Std. Pack
K748010	n/a	1/16"	2000'	13.90	1 spool



RUDDER CABLE TUBING (SPOOL)

Nylon



Bulk #	Display #	Tubing Size	Spool Feet	Color	Wt.(lb.)	Std. Pack
K748020	n/a	3/16"	2000'	Black	12.80	1 spool



CABLE TIE - MIXED BAG

Injection Molded Nylon



Bulk #	Display #	Wt.(lb.)	Std. Pack
n/a	K427290-1	.24	10 ea

Black UV stabilized nylon. Package contains 25 each in sizes 4", 5-5/8", 8-1/2" and 10-1/2" (100 total).

BUNGEE TERMINAL END W/ SLEEVE

Injection Molded Acetal

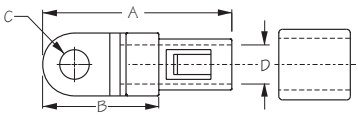

Bulk #	Display #	A	B	C	D (Bungee Size)	Wt.(lb.)	Std. Pack
K653161	K653161-1	1-1/4"	1/2"	3/16" (#10 PH)	1/4"	.03	10 ea / 10 pr

OPEN BUNGEE HOOK W/ SLEEVE

Injection Molded Acetal

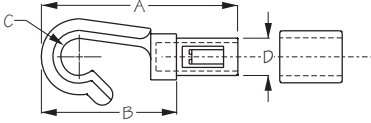

Bulk #	Display #	A	B	C	D (Bungee Size)	Wt.(lb.)	Std. Pack
K653261	K653261-1	2"	1"	3/16"	1/4"	.04	10 ea / 10 pr

LOCKING BUNGEE HOOK W/ SLEEVE

Injection Molded Acetal

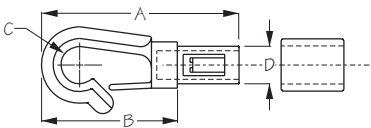

Bulk #	Display #	A	B	C	D (Bungee Size)	Wt.(lb.)	Std. Pack
K653361	K653361-1	2"	1"	3/8"	1/4"	.05	10 ea / 10 pr

BUNGEE CLIP

Injection Molded Nylon

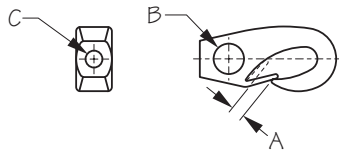

Bulk #	Display #	A	B	C (Bungee Size)	Color	Wt.(lb.)	Std. Pack
K652060	K652060-1	1/4"	7/16"	1/4"	White	.01	10 ea / 10 pr
K652080	K652080-1	5/16"	9/16"	5/16"	White	.01	10 ea / 10 pr
K652061	K652061-1	1/4"	7/16"	1/4"	Black	.01	10 ea / 10 pr
K652081	K652081-1	5/16"	9/16"	5/16"	Black	.01	10 ea / 10 pr

KAYAK DECK FITTING - BUNGEE BLOCK

Injection Molded Nylon

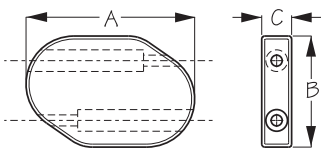

Bulk #	Display #	A	B	C	Wt.(lb.)	Std. Pack
K736540	K736540-1	1-7/16"	15/16"	1/4"	.05	100 ea / 10 set

RIGGING KNIFE

304 Stainless

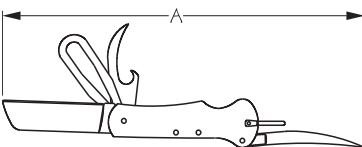

Bulk #	Display #	A	Blade Length	Marlin Spike Length	Wt.(lb.)	Std. Pack
K565050	K565050-1	8-7/16"	2-1/2"	2-1/2"	.25	10 ea

SWIVEL EYE BOLT SNAP

Die Cast Manganese Bronze

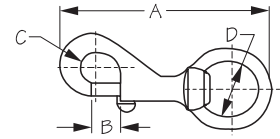

Bulk #	Display #	A	B	C	D	Finish	Wt.(lb.)	Std. Pack
K136012	K136012-1	2-11/16"	5/16"	5/16"	1/2"	Bronze	.06	10 ea

SWIVEL EYE BOLT SNAP

Sand Cast Brass

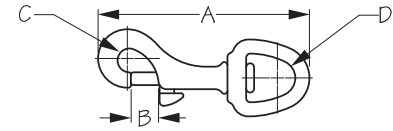

Bulk #	Display #	A	B	C	D	Wt.(lb.)	Std. Pack
K139010	K139010-1	3-5/16"	7/16"	3/8"	11/16"	.12	10 ea
K139016	K139016-1	3-5/16"	7/16"	3/8"	5/8"	.12	10 ea
K139025	K139025-1	3-9/16"	7/16"	7/16"	1"	.15	10 ea
K139032	K139032-1	4-11/16"	9/16"	5/8"	1-5/16"	.29	10 ea

FAST EYE BOAT SNAP

Sand Cast Brass

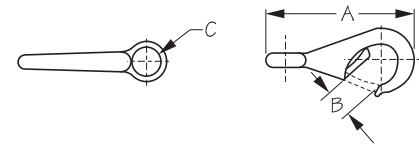

Bulk #	Display #	Size	A	B	C	Finish	Wt.(lb.)	Std. Pack
K139120	K139120-1	0	2-1/8"	1/4"	7/16"	Brass	.06	10 ea
K139121	K139121-1	1	2-7/8"	5/16"	5/8"	Brass	.11	10 ea
K139122	K139122-1	2	3-3/16"	1/2"	3/4"	Brass	.11	10 ea

SWIVEL EYE BOAT SNAP

Sand Cast Brass

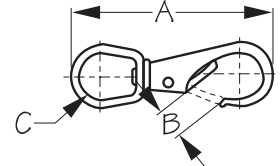

Bulk #	Display #	Size	A	B	C	Finish	Wt.(lb.)	Std. Pack
K139131	K139131-1	1	3-3/16"	3/8"	5/8"	Brass	.14	10 ea
K139132	K139132-1	2	3-5/8"	1/2"	3/4"	Brass	.18	10 ea
K139133	K139133-1	3	4-1/2"	9/16"	3/4"	Brass	.27	10 ea

SWIVEL EYE BOLT SNAP

Investment Cast 316 Stainless

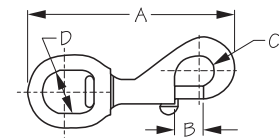

Bulk #	Display #	A	B	C	D	Wt.(lb.)	Std. Pack
K146590	K146590-1	3-9/16"	5/16"	5/16"	3/4"	.13	10 ea

SPRING GATE SNAP HOOK

Investment Cast 316 Stainless

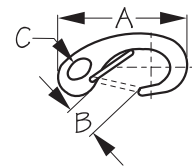

Bulk #	Display #	A	B	C	Wt.(lb.)	Std. Pack
K154250	K154250-1	2"	7/16"	1/4"	.04	10 ea
K154270	K154270-1	2-3/4"	7/16"	3/8"	.11	10 ea
K154300	K154300-1	3-15/16"	15/16"	9/16"	.31	10 ea

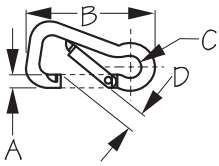

ASYMMETRICAL SNAP HOOK

Formed 316 Stainless



Bulk #	Display #	A	B	C	D	Breaking Strength (lb.)	Std. Pack
K150060	K150060-1	1/4"	2-3/8"	5/16"	7/16"	1,160 lb.	10 ea

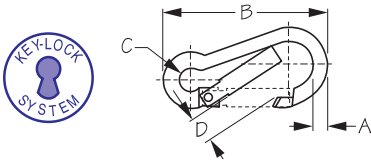

SNAP HOOK

Formed 316 Stainless



Bulk #	Display #	A	B	C	D	Breaking Strength (lb.)	Wt.(lb.)	Std. Pack
K151060	K151060-1	1/4"	2-3/8"	3/8"	3/8"	660 lb.	.06	10 ea
K151080	K151080-1	5/16"	3-1/8"	7/16"	7/16"	1,700 lb.	.15	10 ea
K151100	K151100-1	3/8"	4"	9/16"	5/8"	2,600 lb.	.29	10 ea
K151120	K151120-1	7/16"	4-3/4"	3/4"	11/16"	4,400 lb.	.42	10 ea

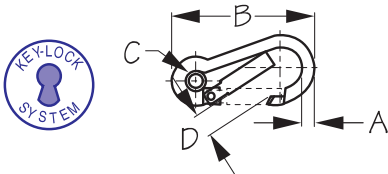

SNAP HOOK W/ EYE INSERT

Formed 316 Stainless



Bulk #	Display #	A	B	C	D	Breaking Strength (lb.)	Wt.(lb.)	Std. Pack
K151065	K151065-1	1/4"	2-3/8"	1/4"	3/8"	660 lb.	.06	10 ea
K151085	K151085-1	5/16"	3-1/8"	3/8"	7/16"	1,700 lb.	.06	10 ea

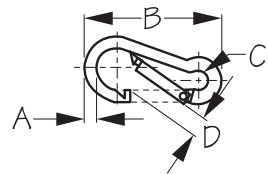

SNAP HOOK

Formed 316 Stainless



Bulk #	Display #	A	B	C	D	Breaking Strength (lb.)	Wt.(lb.)	Std. Pack
K151560	K151560-1	1/4"	2-3/8"	5/16"	5/16"	700 lb.	.06	10 ea
K151580	K151580-1	5/16"	3-1/8"	7/16"	3/8"	1,400 lb.	.14	10 ea

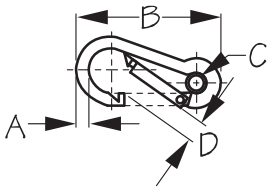

SNAP HOOK W/ EYE INSERT

Formed 316 Stainless



Bulk #	Display #	A	B	C	D	Breaking Strength (lb.)	Wt.(lb.)	Std. Pack
K151565	K151565-1	1/4"	2-3/8"	1/4"	5/16"	700 lb.	.06	10 ea
K151585	K151585-1	5/16"	3-1/8"	3/8"	3/8"	1,400 lb.	.15	10 ea

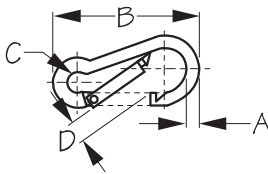

SNAP HOOK

Formed Mild Steel Electro-galvanized



Bulk #	Display #	A	B	C	D	Breaking Strength (lb.)	Wt.(lb.)	Std. Pack
K156060	K156060-1	1/4"	2-3/8"	5/16"	5/16"	560 lb.	.06	10 ea
K156080	K156080-1	5/16"	3-3/16"	7/16"	7/16"	1,140 lb.	.14	10 ea
K156100	K156100-1	3/8"	3-15/16"	9/16"	1/2"	1,600 lb.	.29	10 ea
K156120	K156120-1	7/16"	4-3/4"	3/4"	5/8"	2,000 lb.	.42	10 ea

SKI ROPE SNAP

Injection Molded Nylon

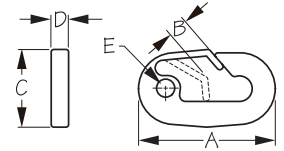

Bulk #	Display #	A	B	C	D	E	Wt.(lb.)	Std. Pack
K157110	K157110-1	3-1/4"	5/8"	1-13/16"	7/16"	7/16"	.05	10 ea

PULLEY

Stainless Steel w/ Plastic Sheave

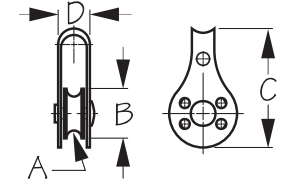

Bulk #	Display #	A (Wire Dia.)	B	C	D	Sheave	Wt.(lb.)	Std. Pack
K092100	K092100-1	1/4"	1"	1-13/16"	1/2"	Plastic	.04	10 ea



CAPTIVE PIN D-SHACKLE

Forged 316 Stainless

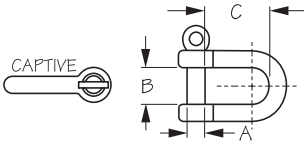

NEW ITEM



Bulk #	Display #	A	B	C	Breaking Strength	Wt.(lb.)	Std. Pack
K147123	K147123-1	5/32"	3/8"	11/16"	1,540 lb.	.02	10 ea
K147124	K147124-1	3/16"	7/16"	11/16"	2,200 lb.	.03	10 ea
K147126	K147126-1	1/4"	1/2"	3/4"	3,300 lb.	.06	10 ea

When opening a SEA-LECT Designs Captive Pin D-Shackle, the pin completely clears the opening of the shackle and is recessed into a secured flush position. The pin remains captive and will not fall out. With other shackles, the pin is not flush until you partially unscrew it.

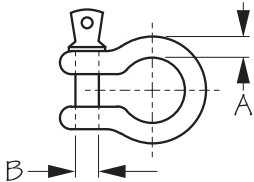

SCREW PIN ANCHOR BOW SHACKLE

Drop Forged Steel Hot Dipped Galvanized

NEW ITEM



Bulk #	Display #	A	B	Wt.(lb.)	Std. Pack
K147804	K147804-1	3/16"	1/4"	.04	10 ea
K147806	K147806-1	1/4"	5/16"	.07	10 ea

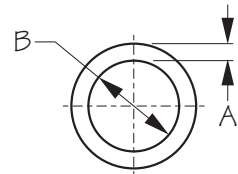

ROUND RING

Injection Molded Nylon



Bulk #	Display #	A	B	Color	Wt.(lb.)	Std. Pack
K190580	K190580-1	3/8"	2"	Black	.03	20 ea / 10 ea

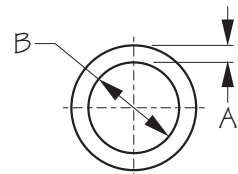

ROUND RING

Formed 304 Stainless



Bulk #	Display #	A	B	Breaking Strength(lb.)	WLL(lb.)	Wt.(lb.)	Std. Pack
K191415	K191415-1	1/4"	1-1/2"	2,700 lb.	675	.08	10 ea
K191520	K191520-1	5/16"	2"	5,000 lb.	1,250	.16	10 ea
K191625	K191625-1	3/8"	2-1/2"	6,200 lb.	1,550	.24	10 ea



TRIANGLE RING

Injection Molded Acetal

NEW ITEM

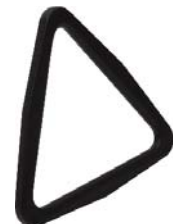

Bulk #	Display #	A	Wt.(lb.)	Std. Pack
K190935	K190935-1	2-1/2"	.02	10 ea

90° FLUSH MOUNT ROD HOLDER W/ CLOSED END

Injection Molded ABS

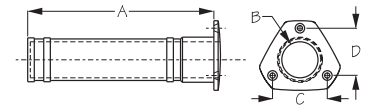

Bulk #	Display #	A	B	C	D	Color	Fastener	Wt.(lb.)	Std. Pack
K325112	K325112-1	8-1/2"	1-5/8"	2-1/2"	2-5/8"	Black	#10 OH	.42	8 ea
K325113	K325113-1	8-1/2"	1-5/8"	2-1/2"	2-5/8"	White	#10 OH	.42	8 ea

Closed end is great for use in kayaks!

FLUSH MOUNT ROD HOLDER W/ CLOSED END

Injection Molded ABS

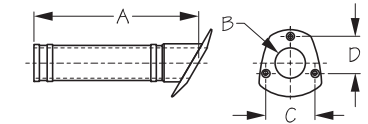

Bulk #	Display #	A	B	C	D	Color	Fastener	Wt.(lb.)	Std. Pack
K325162	K325162-1	9-1/2"	1-5/8"	2-1/2"	2-5/8"	Black	#10 OH	.42	8 ea
K325163	K325163-1	9-1/2"	1-5/8"	2-1/2"	2-5/8"	White	#10 OH	.42	8 ea

Closed end is great for use in kayaks! Item # K325162 is our most popular rod holder.

FLUSH MOUNT ROD HOLDER W/ DRAIN

Injection Molded ABS

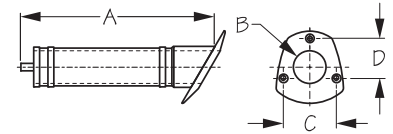

Bulk #	Display #	A	B	C	D	Color	Fastener	Wt.(lb.)	Std. Pack
K325166	K325166-1	10"	1-5/8"	2-1/2"	2-5/8"	Black	#10 OH	.42	8 ea
K325167	K325167-1	10"	1-5/8"	2-1/2"	2-5/8"	White	#10 OH	.42	8 ea

Drain routes unwanted water through hose to bilge compartment. Hose not included.

ROD HOLDER CAP & GASKET

Injection Molded Elastomer



Bulk #	Display #	Description	Wt.(lb.)	Std. Pack
K325160CAP	K325160CAP-1	Rod Holder Cap	.10	10 ea

Cap & Gasket designed for use with item #'s K325162, K325163, K325166 & K325167; will not fit item's #K325112 & K325113.

ROD HOLDER GASKET

Injection Molded Elastomer



Bulk #	Display #	Description	Wt.(lb.)	Std. Pack
K325160G	K325160G-1	Rod Holder Gasket	.01	10 ea

Gasket designed for use with item #'s K325162, K325163, K325166 & K325167; will not fit item's #K325112 & K325113.

TWO POLE DECK MOUNT ROD HOLDER

Injection Molding Polypropylene

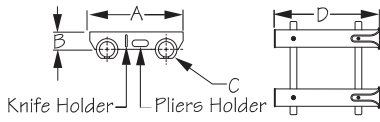

Bulk #	Display #	A	B	C	D	Color	Tool Holder	Wt.(lb.)	Std. Pack
K325020	K325020-1	10-5/8"	1-7/8"	1-3/4"	11-11/16"	Black	No	.73	4 ea
K325025	K325025-1	10-5/8"	1-7/8"	1-3/4"	11-11/16"	Black	Yes	.73	4 ea

Part number K325025 includes a knife and plier holder. Part number K325020 has the same features, but does not include the tool holder insert.

THREE POLE DECK MOUNT ROD HOLDER

Injection Molding Polypropylene

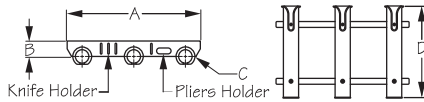

Bulk #	Display #	A	B	C	D	Color	Tool Holder	Wt.(lb.)	Std. Pack
K325030	K325030-1	17"	1-7/8"	1-3/4"	11-11/16"	Black	No	1.10	4 ea
K325035	K325035-1	17"	1-7/8"	1-3/4"	11-11/16"	Black	Yes	1.10	4 ea

Part number K325035 includes a knife and plier holder. Part number K325030 has the same features, but does not include the tool holder insert.

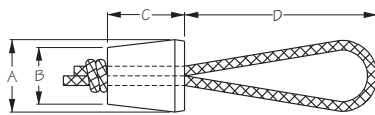

SCUPPER PLUG

Rubber

NEW ITEM



Bulk #	Display #	A	B	C	D	Wt.(lb.)	Std. Pack
K520113	K520113-1	15/16"	3/4"	1"	2-1/2"	.07	10 ea / 10 pr

FISHING RULER STICKER

Vinyl

NEW ITEM



Bulk #	Display #	Length	Wt.(lb.)	Std. Pack
n/a	K325900-1	24"	.01	10 ea



FOLDING ANCHOR KIT - DELUXE

Painted Hot Dipped Galvanized Iron/Forged Flukes

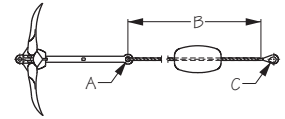

Bulk #	Display #	A	B	C	Boat Length	Line/Length	Wt.(lb.)	Std. Pack
K318003K	K318003K-1	1/2"	25'	1"	5' - 12'	1/4"/25'	3.5	1 ea / 10 ea

The SEA-LECT Designs Folding Anchor Kit (Deluxe) includes a painted hot dipped galvanized 3.5 lb. folding anchor with 25' of 1/4" line, adjustable float, stainless fast eye boat snap and a padded bag to protect your boat.

FOLDING ANCHOR KIT - ECONOMY

Hot Dipped Galvanized Iron/Forged Flukes



NEW ITEM

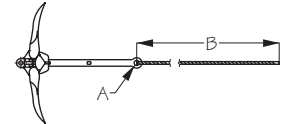

Bulk #	Display #	A	B	Boat Length	Line/Length	Wt.(lb.)	Std. Pack
K318003K1	K318003K1-1	1/2"	20'	5' - 12'	3/16" / 20'	3.5	1 ea / 10 ea

The SEA-LECT Designs Folding Anchor Kit (Economy) includes our famous 3.5 lb. Folding Anchor (K318003) with 20' of 3/16" line and a handy mesh bag.

FOLDING ANCHOR

Hot Dipped Galvanized Iron/Forged Flukes

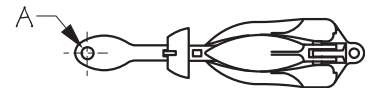

Bulk #	Display #	A	Boat Length	Recomm. Line/Length	Recomm. Chain/Length	Wt.(lb.)	Std. Pack
K318001	K318001-1	1/2"	5' - 10'	1/4"/35'	3/16"/7'-10'	1.5	1 ea / 10 ea
K318003	K318003-1	1/2"	5' - 12'	1/4"/35'	3/16"/7'-10'	3.5	1 ea / 10 ea
K318005	K318005-1	1/2"	5' - 14'	5/16"/50'	3/16"/7'-10'	5.5	1 ea / 5 ea

Inexpensive and easy to store, the Sea-Lect Folding Anchor makes an ideal backup anchor on larger boats, or can be used as a primary anchor on smaller boats, sailboats and inflatable boats.

THE SEA-HOOK CLAW ANCHOR

Hot Dipped Galvanized Investment Cast Steel

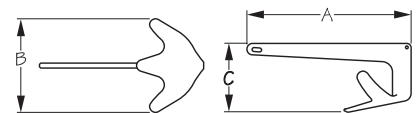

Bulk #	Display #	A	B	C	Recomm. Boat Length	Wt.(lb.)	Std. Pack
K318501	K318501-1	11-3/16"	7-3/8"	5-1/4"	up to 12'	2.2	1 ea / 5 ea



POLE STORAGE CLIP

Injection Molded Elastomer

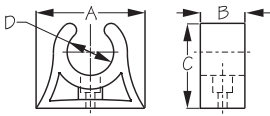

Bulk #	Display #	A	B	C	D	Fastener	Wt.(lb.)	Std. Pack
K491341	K491341-1	1-1/4"	7/16"	15/16"	1/2"	#8 PH	.01	10 ea / 10 pr
K491343	K491343-1	1-1/2"	7/16"	1-1/16"	5/8"	#8 PH	.01	10 ea / 10 pr
K491345	K491345-1	1-3/4"	3/4"	1-1/4"	3/4"	#8 PH	.02	10 ea / 10 pr
K491347	K491347-1	1-15/16"	13/16"	1-1/2"	7/8"	#8 PH	.03	10 ea / 10 pr
K491349	K491349-1	2-1/4"	3/4"	1-5/8"	1"	#8 PH	.03	10 ea / 10 pr
K491351	K491351-1	2-15/16"	3/4"	2-1/8"	1-1/4"	#8 PH	.08	10 ea / 10 pr
K491353	K491353-1	3-5/16"	3/4"	3-5/16"	1-1/2"	#8 PH	.09	10 ea / 10 pr



KAYAK FOLDING PADDLE CLIP

Injection Molded Nylon

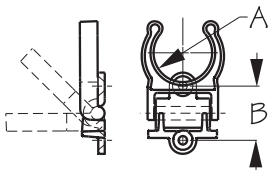

Bulk #	Display #	A	B	Fastener	Wt.(lb.)	Std. Pack
K737345	K737345-1	3/4"	1"	#8 OH	.02	10 ea / 10 pr
K737349	K737349-1	1"	1"	#8 OH	.02	10 ea / 10 pr
K737350	K737350-1	1-1/8"	1"	#8 OH	.03	10 ea / 10 pr
K737351	K737351-1	1-1/4"	1"	#8 OH	.03	10 ea / 10 pr
K737353	K737353-1	1-1/2"	1"	#8 OH	.04	10 ea / 10 pr
K737355	K737355-1	1-3/4"	1"	#8 OH	.04	10 ea / 10 pr
K737357	K737357-1	2"	1"	#8 OH	.04	10 ea / 10 pr
K737399	n/a	n/a	1"	#8 OH	.02	10 ea / 10 pr

Kayak Folding Paddle Clips are available in sizes from 3/4" to 2". Item # K737350 fits most kayak paddle shafts.



ANCHOR TROLLEY KIT

Injection Molded Nylon/Stainless Steel/Polyester

NEW ITEM

Bulk #	Display #	Line/Length	Fasteners Included	Wt.(lb.)	Std. Pack
n/a	K318100-1	3/16"/30'	Yes	.80	5 ea

Kit Includes: (1) 30' Trolley Line, (1) Round Rigging Ring, (1) Zig Zag Cleat, (2) Nylon Pad Eyes, (2) Snap Hooks, (2) Pulleys, (1) Mounting Fastener Pack & Easy Install Instructions.



KAYAK PADDLE DRIP RINGS

Injection Molded Elastomer

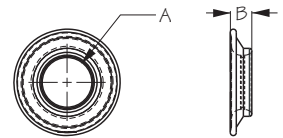

Bulk #	Display #	A	B	Wt.(lb.)	Std. Pack
K737290	K737290-1	1"	7/16"	1.00	10 ea / 10 pr

KAYAK PADDLE

Injection Molded Nylon/Aluminum

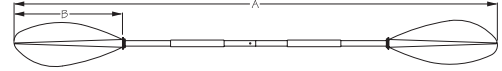

Bulk #	Display #	A	B	Wt.(lb.)	Std. Pack
n/a	K737100-1	84"	18"	2.44	1 ea

Economically priced Kayak Paddle with quick adjustable paddle rotation. Comfort grips on aluminum shaft and a quick release button separates paddle for easy storage.

T-HANDLE PADDLE

Injection Molded Nylon/Aluminum

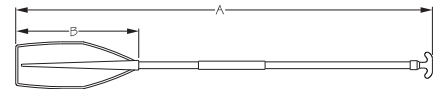

Bulk #	Display #	A	B	Wt.(lb.)	Std. Pack
n/a	K490100-1	48"	18"	1.22	2 ea
n/a	K490150-1	60"	18"	1.43	2 ea

Economically priced fixed length paddles with T-handle. Comfort grip on aluminum shaft.

TELESCOPIC PADDLE

Injection Molded Nylon/Aluminum

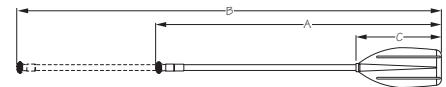

Bulk #	Display #	A	B	C	Wt.(lb.)	Std. Pack
n/a	K490200-1	30"	42"	14-3/4"	.89	2 ea
n/a	K490250-1	39-1/2"	60"	14-3/4"	1.06	2 ea

Economically priced adjustable length paddle allows ease of storage. Round handle allows length adjustment without blade to handle misalignment.

BOAT HOOK PADDLE

Injection Molded Nylon/Aluminum

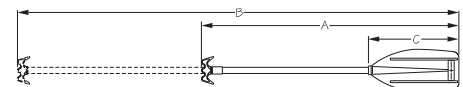

Bulk #	Display #	A	B	C	Wt.(lb.)	Std. Pack
n/a	K490300-1	44-1/2"	72"	14-3/4"	1.16	2 ea

Boat Hook Paddle has grab hole in paddle for hand and handle has double hook. Boat Hook Paddle telescopes to six feet.

ANGLED OARLOCK SOCKET

Injection Molded Nylon

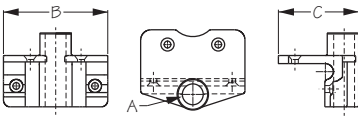

Bulk #	Display #	Type	A	B	C	Wt.(lb.)	Std. Pack
K580143	K580143-1	Angled	1/2"	3-1/16"	2-3/8"	.13	10 ea / 10 pr

OARLOCK & SOCKET

Injection Molded Nylon

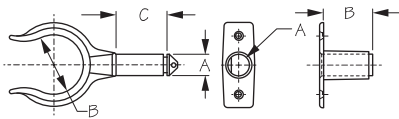

Bulk #	Display #	A	B	C	Mount	Fastener	Wt.(lb.)	Std. Pack
K580150	K580150-1	3/4"	1-5/8"		Top	#8 FH	.01	10 ea / 10 pr
K580152	K580152-1	3/4"	1-11/16"		Side	#8 FH	.02	10 ea / 10 pr
K580157	K580157-1	3/4"	2"	1-9/16"			.09	10 ea / 10 pr
K580158	K580158-1	3/4"	2-1/4"	1-9/16"			.11	10 ea / 10 pr

Oarlock Sockets (K580150 and K580152) for use with Oarlocks (K580157 and K580158). They feature turn key locking action.

CLAMP-ON OARLOCK & SOCKET

Zinc Plated Steel

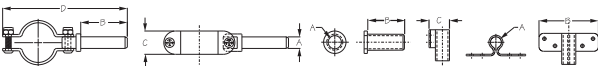

Bulk #	Display #	A	B	C	D	Wt.(lb.)	Std. Pack
K582060	K582060-1	1/2"	2"	1"	5-3/8"	.82	10 pr
K582030	K582030-1	5/8"	3-15/16"	1-3/4"	n/a	.72	10 pr
K582059	K582059-1	1/2"	1-9/16"	n/a	n/a	.02	10 pr

Oarlock Bushing (K582059) needed to increase diameter size of Oarlocks (K582060) to fit Socket (K582030).

OARLOCK

Sand Cast Bronze

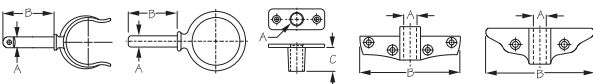

NEW ITEM



Bulk #	Display #	Type	A	B	C	Wt.(lb.)	Std. Pack
K580770	K580770-1	Ribbed 2"	1/2"	2-1/8"		.88	10 pr
K580790	K580790-1	Round Horn 2"	1/2"	2-1/8"		.61	10 pr
K580791	K580791-1	Round Horn 2-1/4"	1/2"	2"		1.29	10 pr
K580800	K580800-1	Top Mount	1/2"		1-1/16"	.27	10 pr
K580810	K580810-1	Side Mount	1/2"	3-3/4"		.47	10 pr
K580820	K580820-1	Angle Mount	1/2"	4"		.59	10 pr

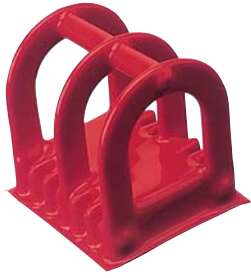

RETRIEVAL MAGNET

Rubber Coated Steel

NEW ITEM

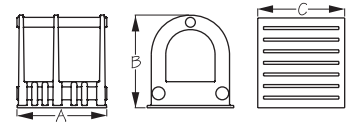

Bulk #	Display #	A	B	C	Wt.(lb.)	Std. Pack
n/a	K584050-1	3-7/8"	4"	3-3/4"	2.02	1 ea

Handy for retrieving metal objects lost to the deep.



SOLAR SHOWER

PVC

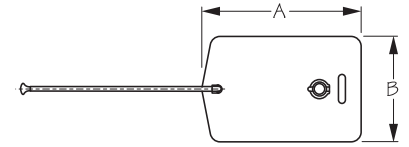

Bulk #	Display #	Size (Gal)	A	B	Wt.(lb.)	Std. Pack
n/a	K582100-1	2-1/2	20-1/4"	13-1/4"	.76	1 ea
n/a	K582200-1	5	21-1/2"	16-1/4"	.98	1 ea



SUCTION CUP DRINK HOLDER

Injection Molded Elastomer

NEW ITEM

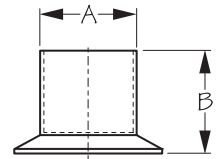

Bulk #	Display #	Color	A	B	Wt.(lb.)	Std. Pack
K588110	K588110-1	White	2-15/16"	3-1/16"	.21	10 ea



GEAR HAMMOCK

Nylon

NEW ITEM

Bulk #	Display #	Length	Wt.(lb.)	Std. Pack
n/a	K671100-1	60"	.21	10 ea



HAMMOCK HOOK

Stamped 304 Stainless

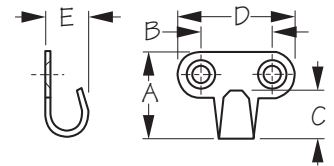

Bulk #	Display #	A	B	C	D	E	Fastener	Wt.(lb.)	Std. Pack
K671460	K671460-1	15/16"	3/4"	1/2"	1-1/4"	1/2"	#8 OH	.02	10 ea / 10 pr



STEP HANDLE

Injection Molded Nylon

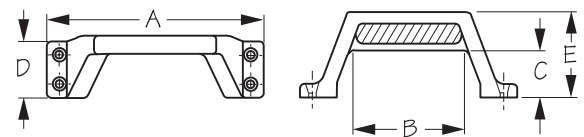

Bulk #	Display #	A	B	C	D	E	Color	Fastener	Wt.(lb.)	Std. Pack
K227260	K227260-1	6-3/8"	3-1/4"	1-3/8"	1-5/8"	2-1/2"	Black	1/4" RH	.22	10 ea
K227261	K227261-1	6-3/8"	3-1/4"	1-3/8"	1-5/8"	2-1/2"	White	1/4" RH	.22	10 ea

POLICE WHISTLE

Injection Molded Polystyrene

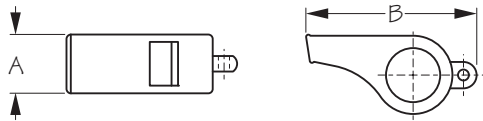

NEW ITEM



Bulk #	Display #	Color	Lanyard Included	A	B	Wt.(lb.)	Std. Pack
K571252	n/a	Orange	No	13/16"	2-5/16"	.02	10 ea
n/a	K571252-1	Orange	Yes	13/16"	2-5/16"	.03	10 ea
K571286	n/a	Orange	No	11/16"	2"	.01	10 ea
n/a	K571286-1	Orange	Yes	11/16"	2"	.02	10 ea

A 36" lanyard is included with display packaging only.

LIFE JACKET WHISTLE

Injection Molded Polypropylene

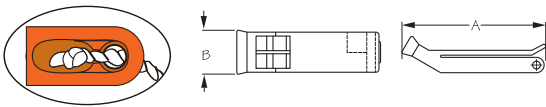

Bulk #	Display #	Color	Lanyard Included	A	B	Wt.(lb.)	Std. Pack
K571260	n/a	Orange	No	2-3/4"	7/8"	.02	10 ea
n/a	K571260-1	Orange	Yes	2-3/4"	7/8"	.02	10 ea

A 36" lanyard is included with display packaging only. Duotone whistle has no moving parts or balls that jam or corrode. Handy clip secures whistle till needed.

MANUAL BILGE PUMP

Injection Molded Nylon

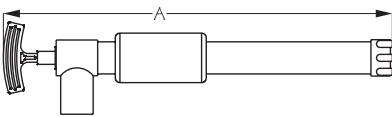

Bulk #	Display #	A	SPG	GPM	Wt.(lb.)	Std. Pack
K737500	K737500-1	21"	10	6	1.03	1 ea / 5 ea

BOAT SPONGE

Synthetic Sponge

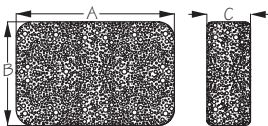

NEW ITEM



Bulk #	Display #	A	B	C	Wt.(lb.)	Std. Pack
K737550	K737550-1	7"	4-1/2"	2"	.25	10 ea

Notes:





Engineering Innovations for Outdoor Enthusiasts
PO Box 67 Everett, WA 98206
Phone (425) 252-2149 Fax (425) 339-1345

info@seallectdesigns.com
www.seallectdesigns.com