

2020 NEW ITEMS

SEADOG[®] LINE
QUALITY MARINE GEAR

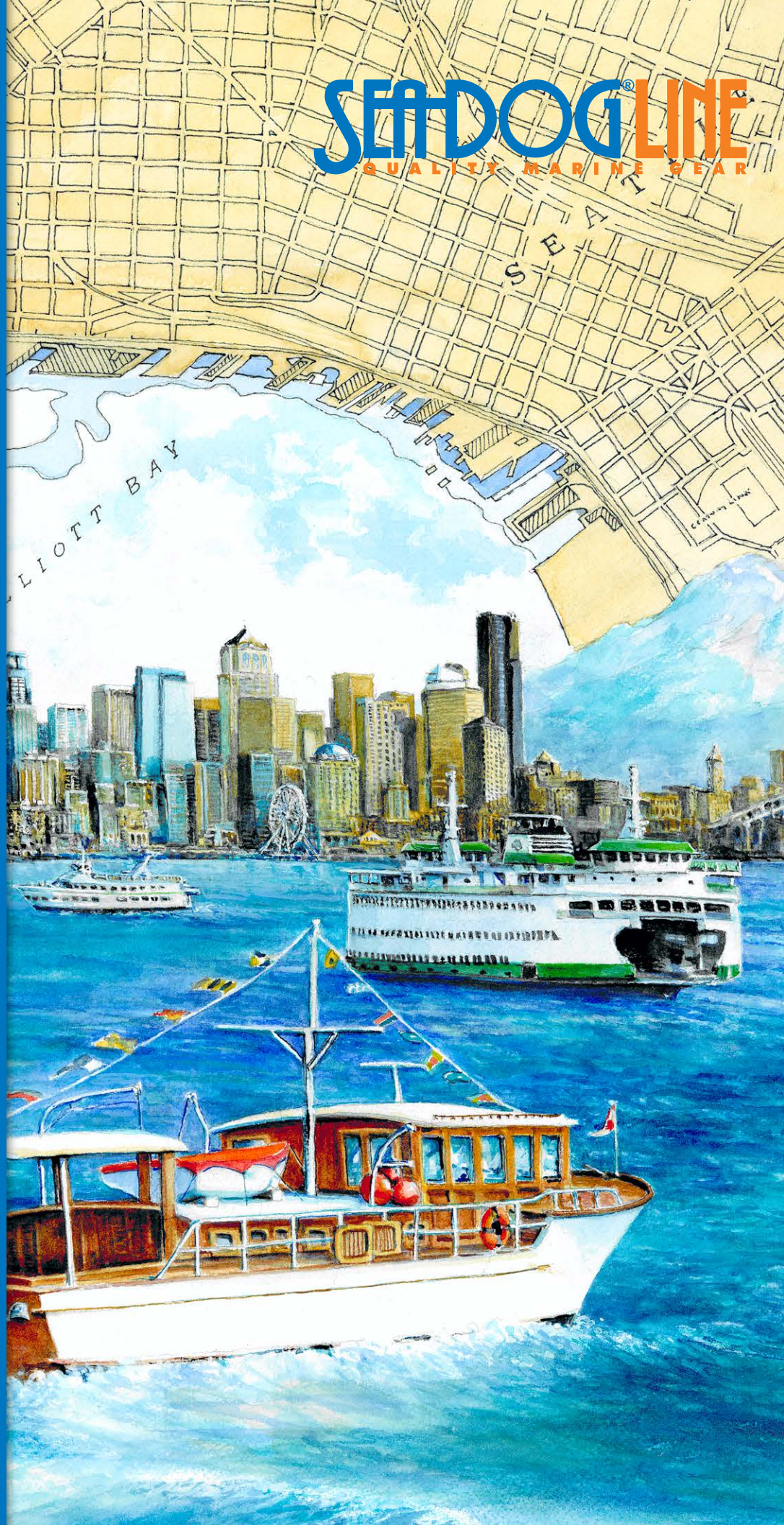



SMART CLEAT

Investment Cast 316 Stainless Steel

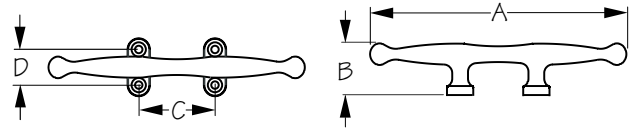

Bulk	Display	A	B	C	D	Fastener	Wt.(lb.)	Std. Pack
041636	041636-1	6-1/4"	1-5/8"	2"	1-1/4"	1/4" FH	.65	10 ea

The Smart Cleat provides easy line tie-off in a classic style. Knob ends prevent lines from easily slipping off and minimizes potential collision injuries. Constructed of corrosion resistant investment cast 316 stainless steel. Open base mount cleats install with four 1/4" FH fasteners (not included).



SMART CLEAT - STUD MOUNT

Investment Cast 316 Stainless Steel

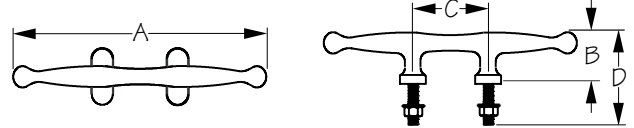

Bulk	Display	A	B	C	D	Wt.(lb.)	Std. Pack
041666	041666-1	6-1/4"	1-9/16"	2"	3"	.62	10 ea

The Stud Mount Smart Cleat features knob ends to prevent lines from easily slipping off. Fasteners are hidden, leaving nothing exposed to collect water or debris. Studs are 1/4"-20 x 1-1/2". Installs with two standard drill bit size holes (no cutouts or hole saws required). Includes washers and nuts. Constructed of corrosion resistant cast 316 stainless steel.



STERN EYE - HEAVY DUTY

Machined 304 Stainless Steel

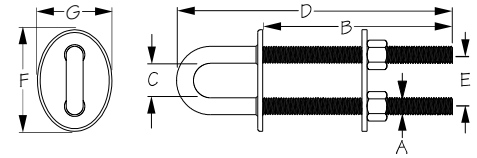

Bulk	Display	A (Thread)	B	C	D	E	F	G	Wt.(lb.)	Std. Pack
080098	n/a	5/8"-13	7"	1-1/4"	10-3/16"	1-15/16"	3-3/4"	2-3/4"	2.30	1 ea

This Heavy-Duty Stern Eye is for use as a tie-down point on your boat's stern. Robust backing plates for added rigidity in water-ski tow applications. Constructed of corrosion resistant machined 304 stainless steel. Includes adjustable finish nuts, which provide superior performance over crimp ring style stern eyes. Maximum hull thickness 5".



T-HINGE

Investment Cast 316 Stainless Steel

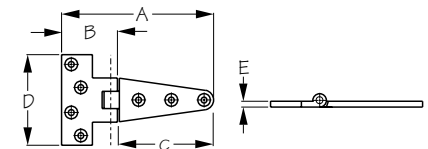

Bulk	Display	A	B	C	D	E	Fastener	Wt.(lb.)	Std. Pack
205705	205705-1	4"	1-1/2"	2-1/2"	2-3/8"	1/8"	#8 FH	.17 / .34	10 ea / 10 pr
205710	205710-1	6"	1-3/4"	4-1/4"	3-1/8"	1/8"	#10 FH	.37 / .74	10 ea / 10 pr

A T-Hinge is a hybrid combination between a butt and strap hinge. The horizontal part of the T goes on the frame, while the vertical part is fastened to the door or cabinet and is visible when closed. This highly decorative and functional hinge is flush mounted (not recessed) and can be used on doors, cabinets, dock boxes, ice chests, etc. Constructed of corrosion resistant investment cast 316 stainless steel. Installs with seven FH fasteners (not included).



DOOR HANDLE LATCH - LOCKING

Investment Cast 316 Stainless Steel

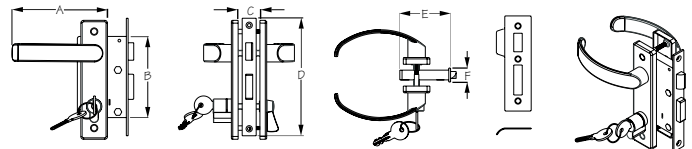

Bulk	Display	A	B	C	D	E	F	Fastener	Wt.(lb.)	Std. Pack
n/a	221615-1	4-1/8"	3-9/16"	3/4"-1-1/2"	3-9/16"	1-1/4"	7/16"	#8 FH	.98	1 ea

This Locking Door Handle Latch is highly polished for a modern, sleek look. Features open from outside deadbolt with cylinder lock mechanism. Includes strike plate, mounting template and two keys. For doors 3/4" - 1-1/2" thick. Constructed of corrosion resistant investment cast 316 stainless steel. Latch and strike plate install with four #8 FH fasteners (not included).

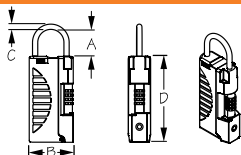
**COMBINATION KEY BOX LOCK**

Powder Coated Steel



Bulk	Display	A	B	C	D	Wt.(lb.)	Std. Pack
n/a	222009-1	1-3/4"	2-1/2"	5/16"	5-3/16"	1.34	1 ea



Combination Key Box Lock is great for dock boxes and entry doors. Large capacity lock box fits multiple keys. Interior dimensions: 4-1/2" L X 1-1/2" D X 7/8" W. Programmable combination is preset to open on 0-0-0-0. Thousands of personalized combination code options. Combination reset instructions included. Hinged side opening door is permanently attached to prevent loss. Hang the lock box on a door, fence, railing or anywhere it can securely lock. Constructed of powder coated steel with a hardened steel shackle for extra security.

⚠ **WARNING:** Cancer and Reproductive Harm - www.P65Warnings.ca.gov

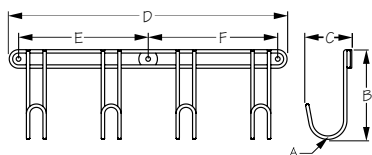
**ROPE & ACCESSORY HANGER**

304 Stainless Steel

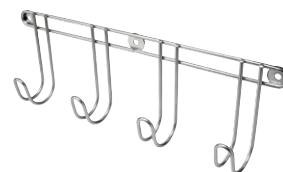

Bulk	Display	A	B	C	D	E	F	Wt.(lb.)	Std. Pack
n/a	300085-1	1-3/4"	5-1/4"	2-1/2"	16"	7-3/8"	7-3/8"	.88	1 ea

This wall mounted Rope Hanger is a great storage management solution. Ideal for the organization of ropes, water hoses, extension cords, etc. Deep hooks keep line in place even when heeling over. Constructed of corrosion resistant 304 stainless steel. Installs with three RH fasteners (not included).

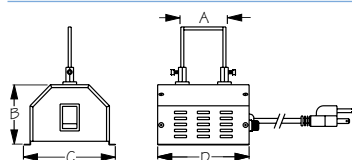
**QUICK CUT BENCH TOP ROPE CUTTER**

Powder Coated Steel



Bulk	Display	A	B	C	D	Volts	Wt.(lb.)	Std. Pack
n/a	300092-3	2-1/4"	3-1/8"	4-13/16"	4-13/16"	120	3.15	1 ea

This Quick Cut Bench Top Rope Cutter easily cuts and heat seals nylon, polyester, polypropylene, and Dacron cordage and webbing. The replaceable blade heats up to 1000° Fahrenheit (500° Celsius) in 10 seconds. Includes brass bristle cleaning brush and T-handle Allen wrench for installing the replaceable blade. Features a 39" heavy duty grounded cord and a lighted on/off rocker switch. Base is pre-drilled for permanent mounting on a bench or table. 120VAC @ 30W. ETL certified #5002516.

⚠ **WARNING:** Cancer and Reproductive Harm - www.P65Warnings.ca.gov

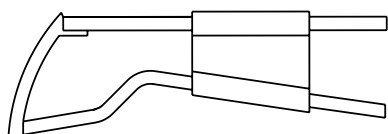
**ROPE CUTTER REPLACEMENT BLADE FOR 300095-3**

Steel/Plastic



Bulk	Display	Description	Wt.(lb.)	Std. Pack
n/a	300096-1	Replacement Blade for 300095-3	.05	1 ea

⚠ **WARNING:** Cancer and Reproductive Harm - www.P65Warnings.ca.gov



TRIPLE LATCH RECTANGULAR MARINE HATCH

Injection Molded Polypropylene

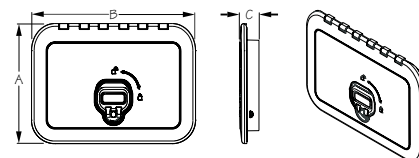

Bulk	Display	A	B	C	Color	Fastener	Wt.(lb.)	Std. Pack
336520	336520-3	10-1/4"	14"	1-11/16"	White	#10 FH	2.00	1 ea
336525	336525-3	10-1/4"	14"	1-11/16"	Black	#10 FH	2.00	1 ea

This Triple Latch Marine Deck Hatch features 3 locking points which when engaged cause the camming surface to pull the lid into the gasket creating a water tight seal. Constructed of injection molded polypropylene with a structural honeycomb lid for superior rigidity and strength. Non-slip textured surface. Can be mounted horizontally or vertically. Full length piano hinge for added strength and security. Installs with ten #10 FH fasteners (not included). Available in black or white.

⚠WARNING: Cancer and Reproductive Harm - www.P65Warnings.ca.gov



DECK PLATE LANYARD

304 Stainless Steel

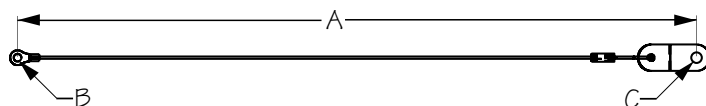

Bulk	Display	A	B	C	Wt.(lb.)	Std. Pack
337198	337198-1	12"	#6 RH	#10 RH	.01	10 ea / 5 ea

This Deck Plate Lanyard is designed to retain deck plate lids. Fits all Sea-Dog® Deck Plates. Constructed of corrosion resistant 304 stainless steel. Attaches to lid with #6 RH fastener (included) and to the interior hull with a #10 RH fastener (not included).

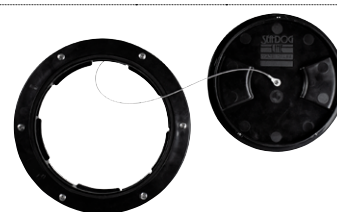

EMERGENCY DECK FILL PLUG

Nitrile-Buna Rubber

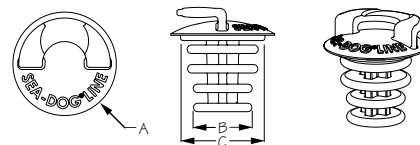

Bulk	Display	A	B	C	Wt.(lb.)	Std. Pack
357390	357390-1	2-3/8"	1-5/16"	1-7/8"	.05	10 ea
n/a	357390-5	Display POP-Emergency Deck Fill Plug-10 pcs.			.50	1 ea

This Emergency Deck Fill Plug is a must for any vessel. Fits most 1-1/2" hose deck fills in the event you lose your cap. For temporary use only until you can replace your OEM cap. Constructed of fuel resistant Nitrile-Buna rubber.



⚠WARNING: Cancer and Reproductive Harm - www.P65Warnings.ca.gov



LED MINI DOME LIGHT

Stamped 304 Stainless Steel

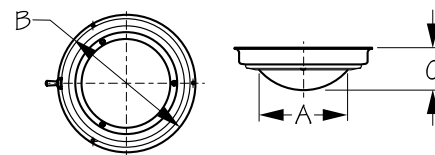

Bulk	Display	A	B	C	Fastener	Wt.(lb.)	Std. Pack
n/a	400213-1	3"	4-3/8"	1-3/8"	#4 RH	.36	5 ea

LED Mini Dome Lights are prewired with integral on/off toggle switch. With the low current consumption of 0.068A @ 12V, they give off very little heat and have extremely long service life. These vibration resistant LED Dome Lights feature 12 white LEDs per light. Constructed of corrosion resistant stamped 304 stainless steel. Installs with three RH fasteners (not included).

⚠WARNING: Cancer and Reproductive Harm - www.P65Warnings.ca.gov

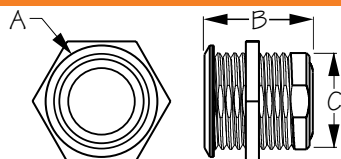

LED CONTINUOUS ADJUSTMENT DIMMER W/O ON/OFF FUNCTION

304 Stainless Steel



Bulk	Display	A	B	C	Max Amps	Volts	Wt.(lb.)	Std. Pack
403061	403061-1	7/8"	7/8"	3/4"	1.5	12/24	.25	10 ea / 1 ea

This LED Continuous Adjustment Dimmer Without On/Off Function is designed to work with lights that are internally switched. Ideal for Aurora Pop-Up Light (404610-3). A center touch sensor activates the color-coded dimming levels. When powered, the LED ring is dark blue; when adjusting towards maximum brightness, the ring becomes lighter blue; when adjusting towards minimum brightness, the ring becomes darker blue. Memory function turns the light back on at the same brightness level as when it was turned off. Constructed of corrosion resistant 304 stainless steel. 1.5A max. 12/24VDC. IP67 waterproof rating.

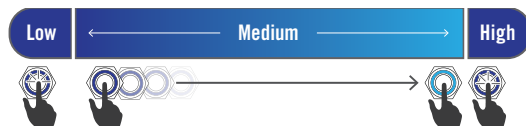

⚠️ **WARNING:** Cancer and Reproductive Harm - www.P65Warnings.ca.gov

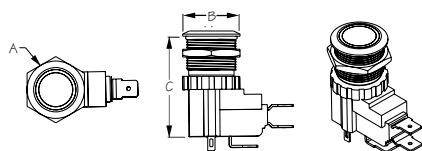

LED PUSH BUTTON ON/OFF SWITCH/HIGH AMP

Formed 304 Stainless Steel



Bulk	Display	A	B	C	Max Amps	Volts	Wt.(lb.)	Std. Pack
403064	403064-1	7/8"	3/4"	1-9/16"	25	10-24	.05	5 ea / 4 ea



This High Amp LED Push Button On/Off Switch lights up blue when pushing the center button, energizing the circuit. Installs easily. Wired with three spade terminals. Constructed of corrosion resistant formed 304 stainless steel. 25A max. 10-24VDC. IP65 rating.

⚠️ **WARNING:** Cancer and Reproductive Harm - www.P65Warnings.ca.gov

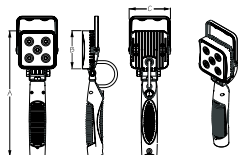

LED RECHARGEABLE HANDHELD FLOOD LIGHT

Powder Coated Aluminum/Stamped 304 Stainless Steel Bracket/ABS



Bulk	Display	A	B	C	LEDs	Lumens	Wt.(lb.)	Std. Pack
n/a	405300-3	11"	3-1/4"	3-1/2"	5	1200	.67	1 ea



This marine grade LED Rechargeable Handheld Flood Light features five 3W high intensity Bridgelux LEDs which produce 1200 lumens. Fully adjustable, the handle allows the light to be hung or propped at many different angles to illuminate the task at hand. Includes both a 12VDC and 120VAC charge adapter. Constructed of a black powder coated aluminum housing with a stamped 304 stainless steel bracket and polycarbonate lens. 7.4V 2200MAH rechargeable Li-battery. Run time 3-4 hours. Charging time 3-4 hours. IP65 rating. CE, RoHS compliant.

⚠️ **WARNING:** Cancer and Reproductive Harm - www.P65Warnings.ca.gov

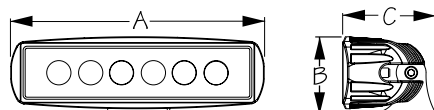

LED COCKPIT SPREADER LIGHT

Powder Coated Aluminum/Stamped 304 Stainless Steel Bracket



Bulk	Display	A	B	C	LEDs	Amps	Volts	Color	Wt.(lb.)	Std. Pack
n/a	405320-3	6-1/4"	1-7/8"	2-1/4"	6	1	12/24	Black	.67	1 ea
n/a	405321-3	6-1/4"	1-7/8"	2-1/4"	6	1	12/24	White	.67	1 ea

These marine grade LED Cockpit Spreader Lights feature six 3W high intensity Epistar LEDs that produce 1440 lumens. The wide beam polycarbonate lens provides ample illumination for sail trim or deck work. Constructed of a powder coated die cast aluminum housing with a stamped 304 stainless steel mounting bracket. Available in black or white. Low amp draw. 10/30VDC. IP68 waterproof rating. CE, RoHS compliant.

⚠️ **WARNING:** Cancer and Reproductive Harm - www.P65Warnings.ca.gov



OLED VOLTMETER

Injection Molded Nylon

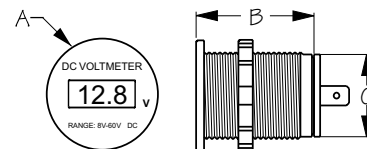

Bulk	Display	A	B	C	Volts	Wt.(lb.)	Std. Pack
n/a	421600-1	1-7/16"	3/4"	1-1/8"	8-60	.02	5 ea

The OLED (Organic LED) Voltmeter is designed to withstand constant vibration and the rigors of a marine environment. Monitors voltage on a bright, waterproof, daylight readable OLED screen. High contrast and resolution make this screen visible from a wide viewing angle, even with polarized sunglasses. Reverse polarity protected. Constructed of injection molded nylon with terminal spade contacts. Installation is as easy as drilling a 1-1/8" hole, inserting the socket body, tightening the locking nut, and connecting the wires. Also fits Sea-Dog® Power Socket Shell (426100) and Mounting Bracket (426105). Input 8-60VDC. IP66 rating.

⚠WARNING: Cancer and Reproductive Harm - www.P65Warnings.ca.gov



SMART DUAL BATTERY ISOLATOR

Machined Brass/Injection Molded Nylon

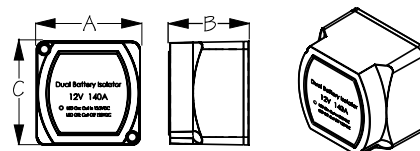

Bulk	Display	A	B	C	Volts	Amps	Fastener	Wt.(lb.)	Std. Pack
n/a	422790-1	2-5/8"	2-5/8"	2"	12	140	#8 RH	.45	1 ea

This Smart Dual Battery Isolator is ideal for dual battery applications. Allows two batteries to automatically charge at the same time and then isolates the batteries, ensuring the starting battery is always charged and ready for use. Automatically engages or disengages the circuit at pre-set voltages by sensing the input voltage generated, eliminating the possibility of discharging the primary starting battery. Cut-in voltage: 13.3V. Cut-out voltage: 12.9V. Surge protected. Features an LED indicator to alert the user when the unit is engaged. Constructed of machined brass with a weatherproof injection molded nylon housing and durable silver tipped contacts. Installs with two #8 RH fasteners (included). 12VDC. 140A. IP65 rating.

⚠WARNING: Cancer and Reproductive Harm - www.P65Warnings.ca.gov



INSTRUMENT HOLE ADAPTER FOR SOCKETS & METERS

Injection Molded Nylon

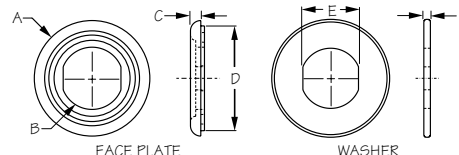

Bulk	Display	A	B	C	D	E	F	Wt.(lb.)	Std. Pack
n/a	426101-1	2-3/16"	1-3/16"	3/16"	1-15/16"	1-1/16"	1/8"	.04	5 ea

This Instrument Hole Adapter is designed to install standard 1-1/8" gauges and meters into 2" instrument dash panel holes. The socket adapter installs by placing the face plate in front of the dashboard, inserting the socket/meter in the hole with the washer behind. The assembly is held in place by the socket/meter nut for a clean finished look. Constructed of UV resistant injection molded nylon.



DOUBLE USB POWER SOCKET W/O LIGHT

Stamped Stainless Steel/Injection Molded Nylon

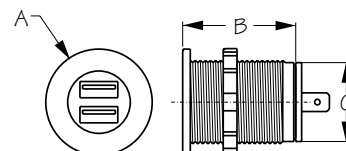

Bulk	Display	A	B	C	Volts	Total Output	Wt.(lb.)	Std. Pack
426503	n/a	1-7/16"	1-1/2"	1-1/16"	12-24	5V/4.2A	.08	10 ea

This Double USB Power Socket has no LED indicator light so it will not drain the battery when not in use. Capable of charging two devices simultaneously. The total output 4.8A load is split 2.4A per side as needed. Enough power to charge phones, pads, and tablets quickly and efficiently. Protective dust cap extends the life of the charger. Constructed of injection molded nylon with terminal spade contacts. Installation is as easy as drilling a 1-1/8" hole, inserting the socket body, tightening the locking nut, and connecting the wires. Also fits Sea-Dog® Power Socket Shell (426100) and Mounting Bracket (426105). Output DC 5V/4.8A. Input 12-24VDC.

⚠WARNING: Cancer and Reproductive Harm - www.P65Warnings.ca.gov

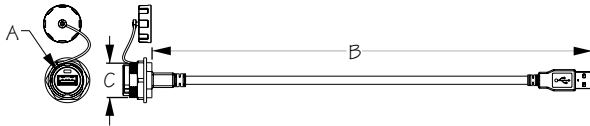
**USB MALE TO FEMALE EXTENSION CORD**

Stamped Stainless Steel/Injection Molded Nylon



Bulk	Display	A	B	C	Volts	Total Output	Wt.(lb.)	Std. Pack
426509	426509-1	7/8"	108"	1"	12-24	5V/4.2A	.15	10 ea / 1 ea

The nine foot 2.4A Male to Female USB Extension Cord extends your USB connection for use charging and accessing printers, keyboards, mice, cameras, and other USB computer peripherals. Perfect for applications where a USB device with a fixed output needs to be connected to the USB port of a computer. Attached cap protects the USB port from water and debris when not in use. Not illuminated. IP67 waterproof rating. RoHS compliant.

⚠ WARNING: Cancer and Reproductive Harm - www.P65Warnings.ca.gov

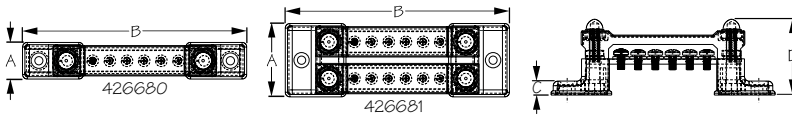
**BUSS BAR WITH COVER**

Tin Plated Brass/ABS



Bulk	Display	Terminals	A	B	C	D	Max. Amps	Fastener	Wt.(lb.)	Std. Pack
n/a	426680-1	6	13/16"	4-7/8"	3/16"	1-11/16"	100	#8 FH	.15	1 ea
n/a	426681-1	12	1-9/16"	4-7/8"	3/16"	1-11/16"	100	#8 FH	.29	1 ea

These Buss Bars are designed for use with tinned copper marine wire which shares the same expansion rate. This prevents loosening wires and reduces electrolytic corrosion caused by pairing two disparate metals. Includes protective covers. 426681-1 has two buss strips that allow both negative and positive connections on the same block. Constructed of tin-plated brass and ABS with a polycarbonate cover. Installs with two #8 FH fasteners (not included). Maximum: 48VDC, 100A. #8-32 terminals. CE, RoHS compliant.

⚠ WARNING: Cancer and Reproductive Harm - www.P65Warnings.ca.gov

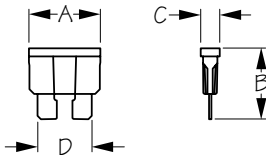
**ATC STYLE MIXED FUSE KITS**

Tin Plated Zinc Alloy/Injection Molded Nylon



Bulk	Display	Kit Quantity	A	B	C	D	Wt.(lb.)	Std. Pack
n/a	445156-1	30 Piece	3/4"	3/4"	3/16"	9/16"	.62	5 ea
n/a	445157-1	80 Piece	3/4"	3/4"	3/16"	9/16"	.92	5 ea

ATC Style Mixed Fuse Kits contain fast acting ATC (closed) fuses to provide better protection for electronic devices. 30 piece includes five 3A, five 5A, five 10A, five 15A, five 20A, and five 30A. The 80 piece includes fifteen 3A, fifteen 5A, fifteen 10A, fifteen 15A, ten 20A, and ten 30A. Constructed of injection molded nylon with tin plated connector blades for superior conductivity and improved corrosion resistance.

⚠ WARNING: Cancer and Reproductive Harm - www.P65Warnings.ca.gov

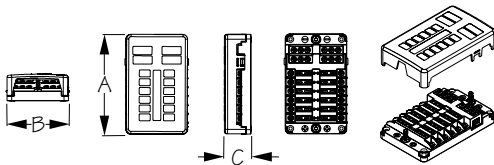
**LED INDICATOR FUSE BLOCK**

Nickel Plated Copper/Stainless Steel/Injection Molded ABS



Bulk	Display	Terminals	A	B	C	Fastener	Wt.(lb.)	Std. Pack
445185	445185-1	6	3-7/16"	3-3/8"	1-7/16"	#8 FH	.33	4 ea
445188	445188-1	12	5-1/2"	3-3/8"	1-7/16"	#8 FH	.53	4 ea

These LED Indicator Fuse Blocks are used to provide over-current protection to help protect wiring in electrical circuits. Features a LED indicator which lights up when the fuse is blown. For use with Sea-Dog® ATO/ATC (445101-445130, 445190, 445156, and 445157; sold separately) and ATM Mini Style Fuses (445002-445030, 445090; sold separately). Main line terminal rating is 100A 32VDC max, with M5 metric threaded studs. Single line terminal rating is 30A 32VDC max, with M4 metric threaded studs. Includes semi-transparent cover and 71 labels. Constructed of injection molded ABS with nickel plated copper terminals and stainless steel screws. Installs with four #8 FH fasteners (not included).

⚠ WARNING: Cancer and Reproductive Harm - www.P65Warnings.ca.gov



SUCTION CUP HANDLE

Injection Molded Nylon/Nitrile-Buna Rubber

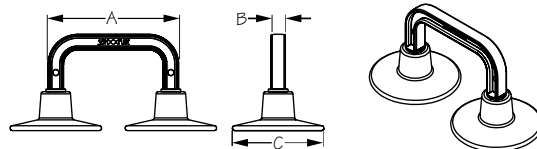

Bulk	Display	A	B	C	Wt.(lb.)	Std. Pack
n/a	490050-1	5-7/8"	5/8"	4"	.42	1 ea

Portable dual Suction Cup Handle installs instantly. Mounts in any direction on any non-porous surface. No holes, screws, or tools required. Easily mount and re-mount with no marks or damage to hull. Ideal for cleaning waterlines or boat bottoms while swimming or from a dinghy. Attach to your paddleboard or kayak for an extra handle during transport. For use above or below the waterline. Constructed of non-corrosive injection molded nylon and Nitrile-Buna rubber. Designed to assist grip, not to leverage full body weight.

⚠ WARNING: Cancer and Reproductive Harm - www.P65Warnings.ca.gov



PREMIUM ELECTRIC OIL PUMP

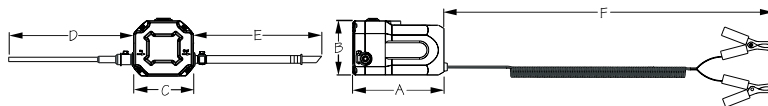

Bulk	Display	A	B	C	D	E	F	Inlet Tube Dia.	Wt.(lb.)	Std. Pack
n/a	501072-3	5-1/8"	3-1/8"	3-1/8"	48"	80"	70"	1/4"	1.88	1 ea

This portable, lightweight Premium Electric Oil Pump is easy to use and transport. The self-priming 12V pump attaches to battery terminals with alligator clips and drains oil through the dipstick tube on outboards and sterndrives. Convenient DIY operation saves money on expensive oil changes. Its compact size makes it easy to store. Includes 48" inlet and 80" outlet hoses. 12VDC. 60W. Maximum run time: 30 minutes. NOT intended for commercial use. NOT suitable for pumping out transmission oil, water, or flammable liquids.

- Oil flow rate: 0.84 quarts/min @ 140°F (0.8 liters/min @ 60°C)
- Diesel flow rate: 1.9 quarts/min @ 75°F (1.8 liters/min @ 23°C)

⚠ WARNING: Cancer and Reproductive Harm - www.P65Warnings.ca.gov



EMERGENCY GARBOARD DRAIN PLUG

Injection Molded Nylon

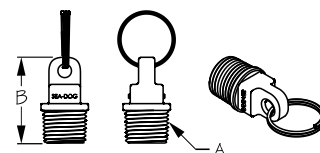

Bulk	Display	A	B	Wt.(lb.)	Std. Pack
520059	520059-1	1/2" NPT	1-9/16"	.01	10 ea
n/a	520059-5	Display POP-Emergency Garboard Drain Plug-30 pcs.			.30 1 pr

The Emergency Garboard Drain Plug features an attached key ring, ensuring you always have a back-up if you lose your garboard plug. Fits most 1/2" NPT threaded drains. For temporary use only. Constructed of injection molded nylon.



MUSHROOM VENT

Formed 304 Stainless Steel/Injected Molded Nylon

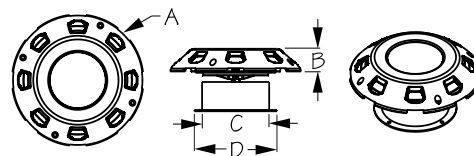

Bulk	Display	A	B	C	D	Finish	Wt.(lb.)	Std. Pack
n/a	727520-3	8"	1-3/4"	4"	5"	Stainless	.83	1 ea
n/a	727525-3	8"	1-3/4"	4"	5"	Dark Gray	.83	1 ea

These Mushroom Vents provide passive ventilation for your cabin by reducing stagnant air, mold, and mildew without opening a hatch. Fully adjustable with a manual knob. Translucent center provides additional light down below. O-ring and gasket prevent water ingress. Trim piece provided for thru deck installations. 4" hole required. Constructed of injection molded nylon with a nylon or formed 304 stainless steel cover.

⚠ WARNING: Cancer and Reproductive Harm - www.P65Warnings.ca.gov