



9

Fuses &
Accessories

Circuit Breakers

Mini Thermal
Breakers

Electrical Panels

Power Sockets

Battery Clips

Terminal Blocks

Buss Bars

Cable Ties

Cable Clamps

Horns

Bilge Blowers

Light Bulbs

12V Fans

Wire Strippers/
Crimpers

2015

Electrical



AGC INLINE FUSE HOLDER

Injection Molded Nylon

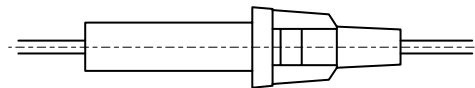

Bulk	Display	Includes	Wire/Length	Fuse Size	Wt.(lb.)	Std. Pack
420500	420500-1	20 Amp AGC Fuse	14 ga/11-1/2"	1/4" x 1-1/4"	.04	10 ea

AGC Inline Fuse Holder provides over-current protection in a convenient push together inline holder. Install by cutting the 11-1/2" wire lead and stripping both ends. Constructed of injection molded nylon with a 14 gauge wire lead. Accepts standard 1/4" x 1-1/4" AGC Style Fuses (444101-444120, and 444190; sold separately). Maximum 20A @ 12VDC. Includes a 20A AGC fuse.

⚠ WARNING: Cancer and Reproductive Harm - www.P65Warnings.ca.gov



AGC FUSE HOLDER WITH PUSH-IN CAP

Stamped Brass/Molded Bakelite

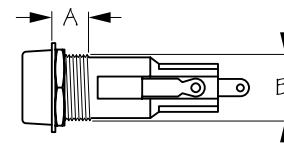

Bulk	Display	A	B	Release Location	Volts	Max. Amps	Wt.(lb.)	Std. Pack
420501	420501-1	1/4"	9/16"	Side	12	10	.02	10 ea
n/a	422199-1	Replacement Red Insert for Fuse Holder					.01	10 pr

The panel mounted AGC Fuse Holder provides over-current protection in electrical circuits. Side release solder terminal. Accepts standard 1/4" x 1-1/4" AGC Style Fuses (444101-444110) sold separately. Maximum 10A @ 12VDC. Constructed of molded Bakelite with stamped brass contacts and push-in cap.

⚠ WARNING: Cancer and Reproductive Harm - www.P65Warnings.ca.gov



REPLACEMENT RED INSERT FOR FUSE HOLDER

Stamped Brass/Molded Bakelite

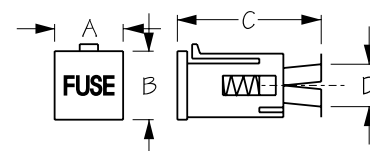

Bulk	Display	A	B	C	D	Release Location	Wt.(lb.)	Std. Pack
n/a	422199-1	7/16"	7/16"	1"	1/4"	Side	.01	10 pr

Replacement Red Insert for Fuse Holder (420501) and Switch Panels (422010, 422110, and 422310).

⚠ WARNING: Cancer and Reproductive Harm - www.P65Warnings.ca.gov



AGC FUSE HOLDER WITH SCREW-ON CAP

Stamped Brass/Molded Bakelite

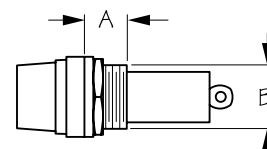

Bulk	Display	A	B	Volts	Max. Amps	Wt.(lb.)	Std. Pack
420502	420502-1	7/16"	9/16"	12	15	.03	10 ea

The panel mounted AGC Fuse Holder provides over-current protection in electrical circuits. Solder terminal. Accepts standard 1/4" x 1-1/4" AGC Style Fuses (444101-444115, and 444190; sold separately). Maximum 15A @ 12VDC. Constructed of molded Bakelite with stamped brass contacts and a screw-on cap.

⚠ WARNING: Cancer and Reproductive Harm - www.P65Warnings.ca.gov



AGC ROUND FUSE HOLDER - SPADE TERMINAL

Stamped Brass/Molded Bakelite

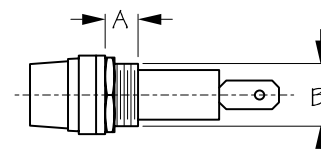

Bulk	Display	A	B	Volts	Max. Amps	Wt.(lb.)	Std. Pack
420503	420503-1	3/8"	9/16"	12	15	.03	10 ea

The panel mounted AGC Round Fuse Holder provides over-current protection in electrical circuits. Spade terminal. Accepts standard 1/4" x 1-1/4" AGC Style Fuses (444101-444115, and 444190; sold separately). Maximum 15A @ 12VDC. Constructed of molded Bakelite with stamped brass contacts and a screw-on cap.

⚠ WARNING: Cancer and Reproductive Harm - www.P65Warnings.ca.gov

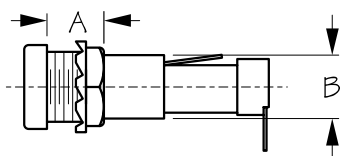

AGC ROUND FUSE HOLDER W/ FLUSH CAP - SPADE TERMINAL

Stamped Brass/Molded Bakelite



Bulk	Display	A	B	Volts	Max. Amps	Wt.(lb.)	Std. Pack
420504	420504-1	3/8"	1/2"	12	15	.01	10 ea

The panel mounted AGC Round Fuse Holder provides over-current protection in electrical circuits. Spade terminal. Accepts standard 1/4" x 1-1/4" AGC Style Fuses (444101-444115, and 444190; sold separately). Maximum 15A @ 12VDC. Constructed of molded Bakelite with stamped brass contacts and a flush cap.

⚠ WARNING: Cancer and Reproductive Harm - www.P65Warnings.ca.gov

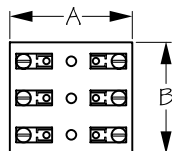

AGC FUSE BLOCK

Stamped Brass/Molded Bakelite



Bulk	Display	Terminals	A	B	Fastener	Wt.(lb.)	Std. Pack
420513	420513-1	3	2-7/16"	2-1/4"	#8 RH	.09	10 ea
420516	420516-1	6	2-7/16"	4-1/2"	#8 RH	.18	10 ea

Multiple gang AGC Fuse Blocks are used to provide over-current protection in electrical circuits. Accepts standard 1/4" x 1-1/4" AGC Style Fuses (444101-444120, and 444190; sold separately). 20A @ 12VDC. Constructed of molded Bakelite with brass fuse clips and screws. Installs with #8 RH fasteners (not included).

⚠ WARNING: Cancer and Reproductive Harm - www.P65Warnings.ca.gov

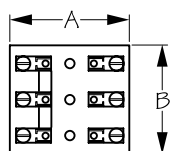

AGC FUSE BLOCK WITH BUSS BAR

Stamped Brass/Molded Bakelite



Bulk	Display	Terminals	A	B	Fastener	Wt.(lb.)	Std. Pack
420523	420523-1	3	2-7/16"	2-1/4"	#8 RH	.09	10 ea
420526	420526-1	6	2-7/16"	4-1/2"	#8 RH	.19	10 ea
420529	420529-1	9	2-7/16"	6-3/4"	#8 RH	.28	10 ea

The multiple gang AGC Fuse Block includes a built-in buss bar to conveniently connect electrical wires. Used to provide over-current protection in electrical circuits. Accepts standard 1/4" x 1-1/4" AGC Style Fuses (444101-444120, and 444190; sold separately). 20A @ 12VDC. Constructed of molded Bakelite with brass fuse clips and screws. Installs with #8 RH fasteners (not included).

⚠ WARNING: Cancer and Reproductive Harm - www.P65Warnings.ca.gov

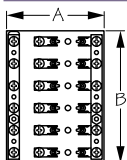

AGC FUSE/TERMINAL BLOCK

Stamped Brass/Molded Bakelite

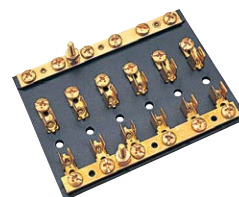

Bulk	Display	Terminals	A	B	Wt.(lb.)	Std. Pack
420544	420544-1	4	3-5/16"	3"	.20	10 ea
420546	420546-1	6	3-5/16"	4-1/2"	.30	10 ea

The combination multiple gang AGC Fuse Blocks feature a separate grounding terminal bar for circuit distribution to route and connect power or ground circuits. Useful for consolidating multiple wires or feeding multiple circuits. Accepts standard 1/4" x 1-1/4" AGC Style Fuses (444101-444120, and 444190; sold separately). 20A @ 12VDC. Constructed of molded Bakelite with brass fuse clips and screws. Installs with #8 RH fasteners (not included).

⚠ WARNING: Cancer and Reproductive Harm - www.P65Warnings.ca.gov



AGC WATERTIGHT INLINE FUSE HOLDER

Injection Molded PVC

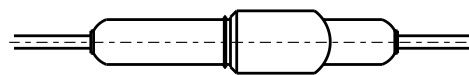

Bulk	Display	Amps	Wire Gauge	Wt.(lb.)	Std. Pack
420552	420552-1	10	16	.02	10 ea
420553	420553-1	15	14	.02	10 ea
420554	420554-1	20	12	.03	10 ea
420555	420555-1	30	10	.04	10 ea
420557	420557-1	50	8	.06	10 ea

AGC Watertight Inline Fuse Holders feature a snap tight connection for use in wet or semi-wet locations. Includes standard 1/4" x 1-1/4" 10A, 15A, 20A, 30A, or 50A glass fuse. Wire gauge from 8-16 AWG. Constructed of injection molded PVC.

⚠ WARNING: Cancer and Reproductive Harm - www.P65Warnings.ca.gov



AGC WATERTIGHT INLINE DUAL FUSE HOLDER

Injection Molded PVC

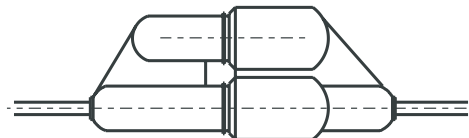

Bulk	Display	Amps	Wire Gauge	Wt.(lb.)	Std. Pack
420562	420562-1	10	16	.04	10 ea
420563	420563-1	15	14	.04	10 ea
420564	420564-1	20	12	.05	10 ea
420565	420565-1	30	10	.05	10 ea

AGC Watertight Inline Dual Fuse Holders feature a snap tight connection for use in wet or semi-wet locations. Includes standard 1/4" x 1-1/4" 10A, 15A, 20A, or 30A glass fuse and an extra emergency fuse. Fuse holder has a specially designed case that is molded with a second fuse pocket for convenient access to a spare fuse. Wire gauge from 10-16 AWG. Constructed of injection molded PVC.

⚠ WARNING: Cancer and Reproductive Harm - www.P65Warnings.ca.gov



AGC INLINE FUSE HOLDER

Tin Plated Copper/Injection Molded Nylon

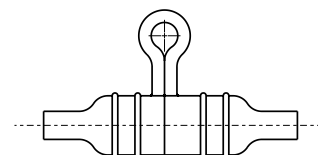

Bulk	Display	Max. Amps	Wire Gauge	Wt.(lb.)	Std. Pack
420570	420570-1	30	18-12	.02	10 ea

The AGC Inline Fuse Holder is ideal for the harsh marine environment. Includes two crimp-on terminals for 12-18 AWG wire. Accepts AGC and MDL fuses (not included). Maximum 30A. Constructed of waterproof and UV resistant injection molded nylon with tin plated copper contacts.

⚠ WARNING: Cancer and Reproductive Harm - www.P65Warnings.ca.gov



THERMAL AC/DC CIRCUIT BREAKER

Stamped Brass/Molded Bakelite

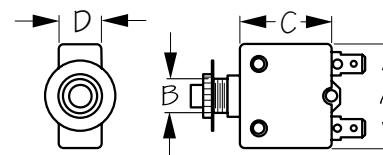

Bulk	Display	Amps	A	B	C	D	UL Listed	Panel Depth	Wt.(lb.)	Std. Pack
420805	420805-1	5	1-3/8"	7/16"	1-1/4"	9/16"	A-0701	3/16"	.07	10 ea
420806	420806-1	6	1-3/8"	7/16"	1-1/4"	9/16"	A-0701	3/16"	.07	10 ea
420808	420808-1	8	1-3/8"	7/16"	1-1/4"	9/16"	A-0701	3/16"	.07	10 ea
420810	420810-1	10	1-3/8"	7/16"	1-1/4"	9/16"	A-0701	3/16"	.07	10 ea
420815	420815-1	15	1-3/8"	7/16"	1-1/4"	9/16"	A-0701	3/16"	.07	10 ea
420820	420820-1	20	1-3/8"	7/16"	1-1/4"	9/16"	A-0701	3/16"	.07	10 ea
420830	420830-1	30	1-3/8"	7/16"	1-1/4"	9/16"	A-0701	3/16"	.07	10 ea
420839	420839-1	Thermal Breaker Boot Only							.01	10 pr

Thermal AC/DC Circuit Breakers are designed to protect an electrical circuit from damage caused by excess current. Vibration and shock resistant these push-to-reset circuit breakers are an economical alternative to magnetic breakers. Unlike sacrificial fuses they have the advantage of being resettable after tripping. Panel mounted compact design. Constructed of molded Bakelite with quick connect, terminal style, stamped brass contacts. Optional Thermal Breaker Boot (420839) provides additional protection in wet environments. 5-30A @ 125-250VAC. 32VDC.

⚠ WARNING: Cancer and Reproductive Harm - www.P65Warnings.ca.gov

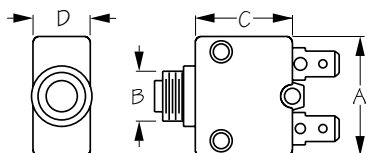

MINI THERMAL AC/DC CIRCUIT BREAKER

Stamped Brass/Molded Bakelite



Bulk	Display	Amps	A	B	C	D	UL Listed	Panel Depth	Wt.(lb.)	Std. Pack
420805M	420805M-1	5	1-1/8"	7/16"	15/16"	9/16"	A-0709	3/16"	.03	10 ea
420808M	420808M-1	8	1-1/8"	7/16"	15/16"	9/16"	A-0709	3/16"	.03	10 ea
420810M	420810M-1	10	1-1/8"	7/16"	15/16"	9/16"	A-0709	3/16"	.03	10 ea
420815M	420815M-1	15	1-1/8"	7/16"	15/16"	9/16"	A-0709	3/16"	.03	10 ea
420820M	420820M-1	20	1-1/8"	7/16"	15/16"	9/16"	A-0709	3/16"	.03	10 ea
420839	420839-1	Thermal Breaker Boot Only							.01	10 pr

Mini Thermal AC/DC Circuit Breakers can replace glass fuse holders in Sea-Dog® Switch Panels (425130, 425144, 425146, and 425160). Constructed of molded Bakelite with terminal style stamped brass contacts. Optional Thermal Breaker Boot (420839) provides additional protection in wet environments. 5-20A @125-250VAC. 32VDC.

⚠ **WARNING:** Cancer and Reproductive Harm - www.P65Warnings.ca.gov

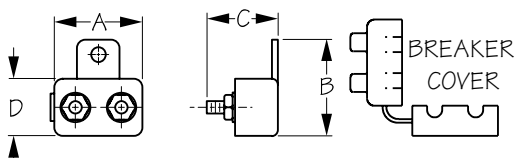

RESETTABLE CIRCUIT BREAKER

Stamped Brass/Injection Molded Nylon/Polycarbonate

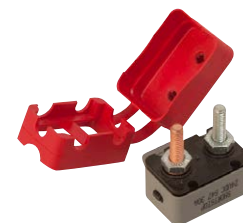

Bulk	Display	Amps	Volts	Cover Included	A	B	C	D	Wt.(lb.)	Std. Pack
420842	420842-1	20	12 or 24	No	1-5/16"	1-7/16"	1-3/8"	7/8"	.04	10 ea
n/a	420852-1	20	12 or 24	Yes	1-5/16"	1-7/16"	1-3/8"	7/8"	.05	5 ea
420843	420843-1	30	12 or 24	No	1-5/16"	1-7/16"	1-3/8"	7/8"	.04	10 ea
n/a	420853-1	30	12 or 24	Yes	1-5/16"	1-7/16"	1-3/8"	7/8"	.05	5 ea
420844	420844-1	40	12 or 24	No	1-5/16"	1-7/16"	1-3/8"	7/8"	.04	10 ea
n/a	420854-1	40	12 or 24	Yes	1-5/16"	1-7/16"	1-3/8"	7/8"	.05	5 ea
420845	420845-1	50	12 or 24	No	1-5/16"	1-7/16"	1-3/8"	7/8"	.04	10 ea
n/a	420855-1	50	12 or 24	Yes	1-5/16"	1-7/16"	1-3/8"	7/8"	.05	5 ea
420840	420840-1	Breaker Cover Only							.01	1 ea

Inline Resettable Circuit Breakers with manual reset button are for use with higher amperage accessories. These breakers are ignition protected and can be installed aboard gasoline powered boats. May be used on 12V or 24V systems. Constructed of injection molded nylon and polycarbonate and stamped brass #10-32 studs with nuts. The copper post is the battery or "power in" post and the silver post is the auxiliary or "power out" protected post. Available with or without splash proof Breaker Cover (420840). Complies with SAE standard J553 and SAE J1171.

⚠ **WARNING:** Cancer and Reproductive Harm - www.P65Warnings.ca.gov

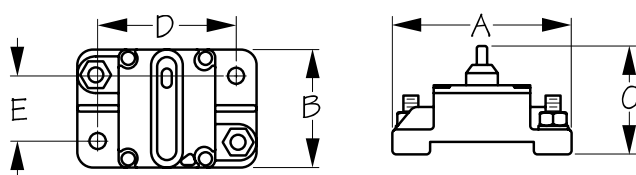

HI AMP SURFACE MOUNT RESETTABLE CIRCUIT BREAKER

Stainless Steel Studs and Washers/Thermoset Plastic



Bulk	Display	Amps	A	B	C	D	E	Wt.(lb.)	Std. Pack
420864	420864-1	40	2-7/8"	1-7/8"	1-3/4"	2-3/16"	1-1/16"	.22	1 ea
420865	420865-1	50	2-7/8"	1-7/8"	1-3/4"	2-3/16"	1-1/16"	.22	1 ea
420867	420867-1	80	2-7/8"	1-7/8"	1-3/4"	2-3/16"	1-1/16"	.22	1 ea

These Hi Amp Resettable Circuit Breakers provide a visible indication of tripped condition. Single pole thermal type breaker they have a voltage rating of 48VDC and an interrupt level of 3000 amperes. Surface mounted, a mounting panel is not required. Sealed for engine compartment and bilge area applications. Constructed of Thermoset plastic with stainless steel studs and washers.

⚠ **WARNING:** Cancer and Reproductive Harm - www.P65Warnings.ca.gov



OLED VOLTmeter

Injection Molded Nylon

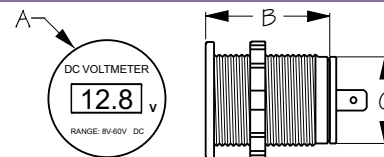

Bulk	Display	A	B	C	Volts	Wt.(lb.)	Std. Pack
n/a	421600-1	1-7/16"	3/4"	1-1/8"	8-60	.02	5 ea

The OLED (Organic LED) Voltmeter is designed to withstand constant vibration and the rigors of a marine environment. Monitors voltage on a bright, waterproof, daylight readable OLED screen. High contrast and resolution make this screen visible from a wide viewing angle, even with polarized sunglasses. Reverse polarity protected. Constructed of injection molded nylon with terminal spade contacts. Installation is as easy as drilling a 1-1/8" hole, inserting the socket body, tightening the locking nut, and connecting the wires. Also fits Sea-Dog® Power Socket Shell (426100) and Mounting Bracket (426105). Input 8-60VDC. IP66 rating.

⚠ **WARNING:** Cancer and Reproductive Harm - www.P65Warnings.ca.gov



OLED TEMPERATURE METER

Injection Molded Nylon

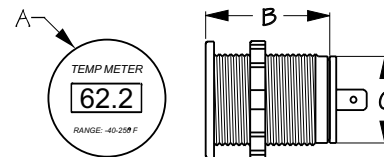

Bulk	Display	A	B	C	Volts	Temp Range	Wt.(lb.)	Std. Pack
421610	421610-1	1-7/16"	3/4"	1-1/8"	12-24	-67°F to 248°F	.02	5 ea

OLED (Organic LED) Temperature Meter is designed to withstand constant vibration and the rigors of a wet marine or dusty outback environment. Includes a prewired temperature sensor with a 6' cable. Monitors temperature on a bright, waterproof, daylight readable OLED screen. High contrast and resolution make this screen visible from a wide viewing angle, even with polarized sunglasses. Reverse polarity protected. Same compact round size as a standard 12V receptacle, this OLED Temperature Meter supports many installation options. Constructed of injection molded nylon. Installation is as easy as drilling a 1-1/8" hole, inserting the socket body, tightening the locking nut, and connecting the wires. IP66 rating.

⚠ **WARNING:** Cancer and Reproductive Harm - www.P65Warnings.ca.gov



ROUND DIGITAL VOLTmeter

Injection Molded Nylon

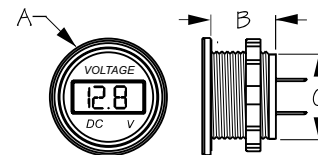

Bulk	Display	A	B	C	Volts	Wt.(lb.)	Std. Pack
421615	421615-1	1-7/16"	3/4"	1-1/8"	4-30	.02	10 ea

Round Digital Voltmeter is the same compact round size as a standard 12V receptacle supporting many installation options. Constructed of injection molded nylon. Designed for use in interior or fully protected locations only. Red LED display. Input 4-30VDC. RoHS compliant.

⚠ **WARNING:** Cancer and Reproductive Harm - www.P65Warnings.ca.gov



DUAL ROUND VOLTmeter

Injection Molded Nylon

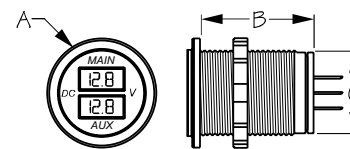

Bulk	Display	A	B	C	Volts	Wt.(lb.)	Std. Pack
421616	421616-1	1-7/16"	1-3/8"	1-1/8"	10-48	.04	5 ea

This digital Dual Round Voltmeter displays voltage for main and auxiliary batteries simultaneously. The same compact size as a standard 12V receptacle socket, this voltmeter supports many installation options. Constructed of injection molded nylon. Red LED display. Input 10-48VDC. IP65 rating.

⚠ **WARNING:** Cancer and Reproductive Harm - www.P65Warnings.ca.gov

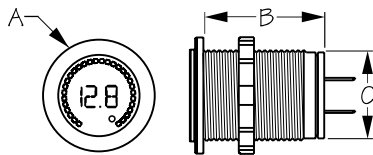

RAINBOW DISPLAY DIGITAL VOLTMETER

Injection Molded Nylon



Bulk	Display	A	B	C	Volts	Wt.(lb.)	Std. Pack
421617	421617-1	1-7/16"	3/4"	1-1/8"	5-15	.02	5 ea

The Rainbow Display Digital Voltmeter gives the user quick, visual, color-coded voltage information. Red/orange means the voltage is too low. Green means voltage is normal. The same compact round size as a standard 12V receptacle, this voltmeter supports many installation options. Constructed of injection molded nylon. Rainbow LED display. For use with 12V systems. IP65 rating.

⚠ **WARNING:** Cancer and Reproductive Harm - www.P65Warnings.ca.gov

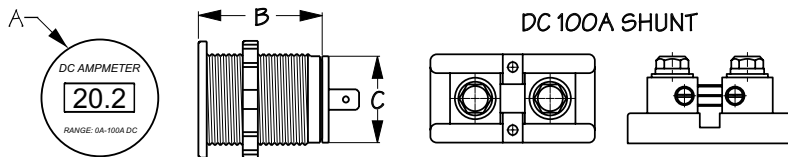

OLED 100 AMP METER

Injection Molded Nylon



Bulk	Display	A	B	C	Volts	Amps	Wt.(lb.)	Std. Pack
421620	421620-1	1-7/16"	3/4"	1-1/8"	12-24	0-100	.02	5 ea

OLED (Organic LED) 100 Amp Meter is designed to withstand constant vibration and the rigors of a wet marine or dusty outback environment. Includes 100A/50mV shunt. Monitors amperage on a bright, waterproof, daylight readable OLED screen. High contrast and resolution make this screen visible from a wide viewing angle, even with polarized sunglasses. Reverse polarity protected. Same compact round size as a standard 12V receptacle, this OLED 100 Amp Meter supports many installation options. Constructed of injection molded nylon. Installation is as easy as drilling a 1-1/8" hole, inserting the socket body, tightening the locking nut, and connecting the wires. IP66 rating.



⚠ **WARNING:** Cancer and Reproductive Harm - www.P65Warnings.ca.gov

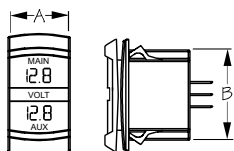

DUAL VOLTMETER ROCKER SWITCH STYLE

Injection Molded Nylon



Bulk	Display	A	B	Volts	Wt.(lb.)	Std. Pack
421636	421636-1	13/16"	1-7/16"	10-48	.04	5 ea

This Digital Dual Voltmeter monitors and displays the voltage for main and auxiliary batteries simultaneously. Rocker switch styling means this voltmeter fits any standard 13/16" x 1-7/16" rocker switch panel slot. Constructed of injection molded nylon. Red LED display. Input 10-48VDC. IP65 rating.

⚠ **WARNING:** Cancer and Reproductive Harm - www.P65Warnings.ca.gov

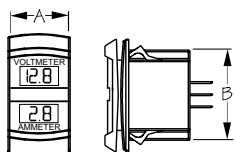

DUAL VOLT/AMP METER ROCKER SWITCH STYLE

Injection Molded Nylon



Bulk	Display	A	B	Volts	Amps	Wt.(lb.)	Std. Pack
421645	421645-1	13/16"	1-7/16"	6-30	10	.04	5 ea

This Digital Dual Volt/Amp Meter monitors and displays voltage and amps simultaneously. Rocker switch styling means this meter will fit into any standard 13/16" x 1-7/16" rocker switch panel slot. Constructed of injection molded nylon. Red LED display. Input 6-30VDC. IP65 rating.

⚠ **WARNING:** Cancer and Reproductive Harm - www.P65Warnings.ca.gov



ROUND DIGITAL VOLT/AMP METER

Injection Molded Nylon

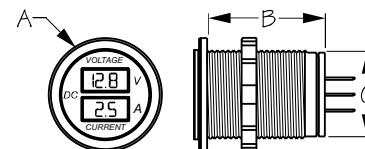

Bulk	Display	A	B	C	Volts	Amps	Wt.(lb.)	Std. Pack
421625	421625-1	1-7/16"	1-3/8"	1-1/8"	4-30	10	.04	10 ea

The Round Digital Volt/Amp Meter displays voltage and amps simultaneously. The same compact round size as a standard 12V receptacle, this meter supports many installation options. Constructed of injection molded nylon. Red LED display. Input 4-30VDC. DC shunt not required. IP65 rating.

⚠ WARNING: Cancer and Reproductive Harm - www.P65Warnings.ca.gov



HEAVY DUTY BATTERY SWITCH WITH CAP

Injection Molded Nylon

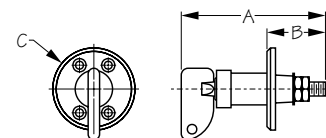

Bulk	Display	A	B	C	Wt.(lb.)	Std. Pack
420600	420600-1	4"	1-5/8"	2-1/4"	.29	10 ea

Heavy Duty Battery Switch with Cap features a removable key for extra security. 500A momentary, 75A continuous. 12-24VDC.

⚠ WARNING: Cancer and Reproductive Harm - www.P65Warnings.ca.gov



BATTERY SWITCH WITH KNOB

Machined Brass/Injection Molded Nylon

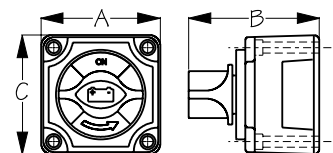

Bulk	Display	A	B	C	Function	Volts	Amps	Fastener	Wt.(lb.)	Std. Pack
422760	422760-1	2-3/4"	2-3/4"	3"	Off/1/Both/2	48	300	#10 RH	.36	1 ea
422761	422761-1	2-3/4"	2-3/4"	3"	On/Off	48	300	#10 RH	.36	1 ea

Battery disconnect and selector switches either switch a single battery to a single load group or isolates and/or combines two battery banks. Can be surface or rear panel mounted. Ignition protected. Safe for installation on gasoline powered boats. Constructed of injection molded nylon with machined brass contacts. Installs with four #10 RH fasteners (not included).

⚠ WARNING: Cancer and Reproductive Harm - www.P65Warnings.ca.gov



SMART DUAL BATTERY ISOLATOR

Machined Brass/Injection Molded Nylon

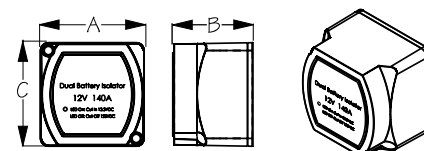

Bulk	Display	A	B	C	Volts	Amps	Fastener	Wt.(lb.)	Std. Pack
n/a	422790-1	2-5/8"	2-5/8"	2"	12	140	#8 RH	.45	1 ea

This Smart Dual Battery Isolator is ideal for dual battery applications. Allows two batteries to automatically charge at the same time and then isolates the batteries, ensuring the starting battery is always charged and ready for use. Automatically engages or disengages the circuit at pre-set voltages by sensing the input voltage generated, eliminating the possibility of discharging the primary starting battery. Cut-in voltage: 13.3V. Cut-out voltage: 12.8V. Also features surge protection and an LED indicator to alert the user when the unit is engaged. Constructed of machined brass with a weatherproof injection molded nylon housing and durable silver tipped contacts. Installs with two #8 RH fasteners (included). 12VDC. 140A. IP65 rating.

⚠ WARNING: Cancer and Reproductive Harm - www.P65Warnings.ca.gov



BATTERY TEST ROCKER SWITCH PANEL

Stamped Anodized Aluminum

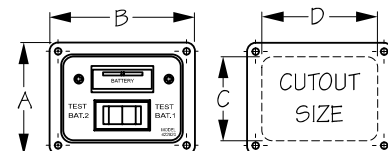

Bulk	Display	A	B	C	D	Wt.(lb.)	Std. Pack
n/a	422020-1	2-1/2"	3-1/4"	1-3/4"	2-9/16"	.17	1 ea
420443	420443-1	Replacement Rocker Switch				.02	10 ea

This Battery Test Rocker Switch Panel is an economical gauge to quickly test the current charge on two separate batteries. Clear gauge shows current charge status of each battery by toggling the 3-position rocker switch between the two. Constructed of corrosion resistant stamped anodized aluminum. 2-1/2" H x 3-1/4" W.

⚠ WARNING: Cancer and Reproductive Harm - www.P65Warnings.ca.gov

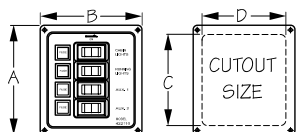

ALUMINUM VERTICAL ROCKER SWITCH PANEL

Stamped Anodized Aluminum

Bulk	Display	A	B	C	D	No. of Switches	Wt.(lb.)	Std. Pack
n/a	422010-1	4-7/8"	4-1/2"	3-15/16"	3-1/2"	4	.37	1 ea
0P9A0103	n/a	Replacement Decal Sheet (32 peel and stick labels)					.01	1 ea
420501	420501-1	Replacement Fuse Holder					.02	10 ea
n/a	422199-1	Replacement Red Insert for Fuse Holder					.01	10 pr
420441	420441-1	Replacement Rocker Switch					.02	10 ea

Aluminum Vertical Rocker Switch Panel features four 15A 12VDC illuminated SPST On/Off rocker switches and four 10A 12VDC fuse holders. Individual circuit 10A max. 37A total. Includes a sheet of 20 preprinted decals to customize to your specific applications. Constructed of stamped anodized aluminum. Installs with four #6 RH fasteners (not included). 12VDC.

▲ **WARNING:** Cancer and Reproductive Harm - www.P65Warnings.ca.gov

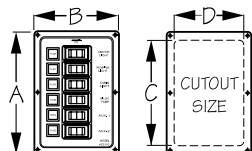

ALUMINUM VERTICAL ROCKER SWITCH PANEL

Stamped Anodized Aluminum

Bulk	Display	A	B	C	D	No. of Switches	Wt.(lb.)	Std. Pack
n/a	422110-1	6-1/2"	4-1/2"	5-1/2"	3-1/2"	6	.51	1 ea
n/a	422199-1	Replacement Red Insert for Fuse Holder					.01	10 pr
420501	420501-1	Replacement Fuse Holder					.02	10 ea
420441	420441-1	Replacement Rocker Switch					.02	10 ea
0P9A0103	n/a	Replacement Decal Sheet (32 peel-and-stick labels)					.01	1 ea

Aluminum Vertical Rocker Switch Panel features six 15A 12VDC illuminated SPST On/Off rocker switches and six 10A 12VDC fuse holders. Individual circuit 10A max. 37A total. Includes a sheet of 20 preprinted decals to customize to your specific applications. Constructed of stamped anodized aluminum. Installs with six #6 RH fasteners (not included). 12VDC.

▲ **WARNING:** Cancer and Reproductive Harm - www.P65Warnings.ca.gov

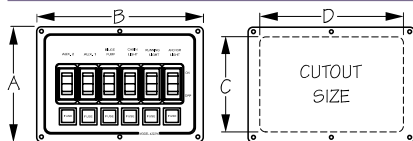
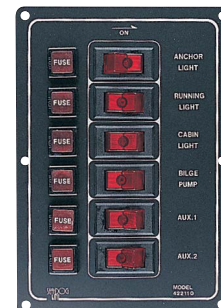

ALUMINUM HORIZONTAL ROCKER SWITCH PANEL

Stamped Anodized Aluminum

Bulk	Display	A	B	C	D	No. of Switches	Wt.(lb.)	Std. Pack
n/a	422210-1	4-1/2"	6-1/2"	3-1/2"	5-1/2"	6	.51	1 ea
420501	420501-1	Replacement Fuse Holder					.02	10 ea
420441	420441-1	Replacement Rocker Switch					.02	10 ea
0P9A0103	n/a	Replacement Decal Sheet (32 peel-and-stick labels)					.01	1 ea

Aluminum Horizontal Rocker Switch Panel features six 15A 12VDC illuminated SPST On/Off rocker switches and six 10A 12VDC fuse holders. Individual circuit 10A max. 37A total. Includes a sheet of 20 preprinted decals to customize to your specific applications. Constructed of stamped anodized aluminum. Installs with six #6 RH fasteners (not included). 12VDC.

▲ **WARNING:** Cancer and Reproductive Harm - www.P65Warnings.ca.gov

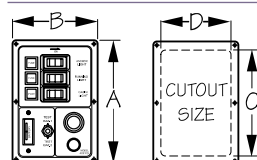

BATTERY TEST ROCKER SWITCH PANEL WITH GAUGE & LIGHTER

Stamped Anodized Aluminum

Bulk	Display	A	B	C	D	No. of Switches	Wt.(lb.)	Std. Pack
n/a	422310-1	6-1/2"	4-1/2"	5-5/8"	3-5/8"	3	.76	1 ea
420441	420441-1	Replacement Rocker Switch					.02	10 ea
n/a	422199-1	Replacement Red Insert for Fuse Holder					.01	10 pr
420501	420501-1	Replacement Fuse Holder					.02	10 ea
420502	420502-1	Replacement Screw-Top Fuse Holder					.03	10 ea
0P9A0103	n/a	Replacement Decal Sheet (32 peel-and-stick labels)					.01	1 ea

Battery Test Rocker Switch Panel features three 15A 12VDC illuminated SPST On/Off rocker switches, three 10A 12VDC fuse holders, a battery test gauge with toggle switch, and a cigarette lighter with 15A 12VDC fuse holder. Individual circuit 10A max. 37A total. Includes a sheet of 20 preprinted decals to customize to your specific applications. Constructed of stamped anodized aluminum. Installs with six #6 RH fasteners (not included). 12VDC.

▲ **WARNING:** Cancer and Reproductive Harm - www.P65Warnings.ca.gov



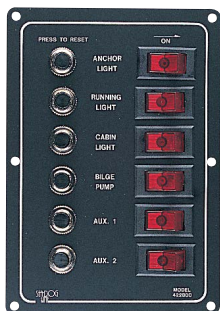

ALUMINUM BREAKER PANEL

Stamped Anodized Aluminum

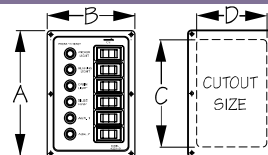

Bulk	Display	A	B	C	D	No. of Circuits	Wt.(lb.)	Std. Pack
n/a	422800-1	6-1/2"	4-1/2"	5-1/2"	3-1/2"	6	.80	1 ea
420441	420441-1	Replacement Rocker Switch					.02	10 ea
0P9A0103	n/a	Replacement Decal Sheet (32 peel-and-stick labels)					.01	1 ea

Aluminum Breaker Panel features six 15A 12VDC illuminated SPST On/Off rocker switches and six thermal AC/DC circuit breakers (two 3A, two 6A, one 8A, and one 10A). Individual circuit 10A max. 40A total. Includes a sheet of 20 preprinted decals to customize to your specific applications. Constructed of stamped anodized aluminum. Installs with six #6 RH fasteners (not included). 12VDC.

⚠ **WARNING:** Cancer and Reproductive Harm - www.P65Warnings.ca.gov



BILGE PUMP PANEL WITH FUSE HOLDER

Injection Molded ABS

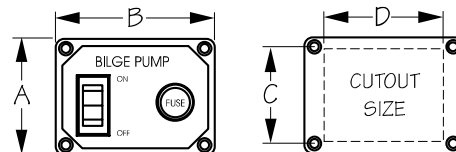

Bulk	Display	A	B	C	D	Fastener	Wt.(lb.)	Std. Pack
423030	423030-1	2-3/16"	3"	1-11/16"	2-1/4"	#6 RH	.07	5 ea
420441	420441-1	Replacement Rocker Switch					.02	10 ea
420503	420503-1	Replacement Screw-Top Fuse Holder					.03	10 ea

The Sea-Dog® Bilge Pump Switch Panel comes complete with an illuminating On/Off rocker switch and panel mounted fuse holder. The panel is designed so the words "Bilge Pump" will illuminate when back lit, allowing for easy location and operation at night. Accepts AGC fuses (not included). 15A. Constructed of injection molded ABS for corrosion resistance and durability. Installs with four #6 RH fasteners (not included).

⚠ **WARNING:** Cancer and Reproductive Harm - www.P65Warnings.ca.gov



BILGE PUMP WATER ALARM PANEL

Injection Molded ABS

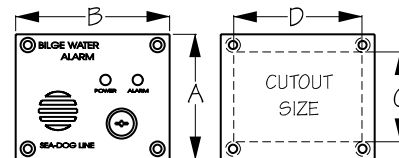

Bulk	Display	A	B	C	D	Wt.(lb.)	Std. Pack
n/a	423033-1	2-7/16"	3"	1-3/4"	2-1/2"	.12	1 ea
420504	420504-1	Replacement Fuse Holder (15 Amp)				.01	10 ea

The Bilge Water Alarm Panel provides both an audible and visual means of warning that the water level in your bilge is above your bilge pump float switch level. For maximum effectiveness, bilge pumps should be used in conjunction with a Sea-Dog® Bilge Pump Switch Panel (423030, 423040, or 423046). 15A. Constructed of injection molded ABS. Installs with four RH fasteners (not included).

⚠ **WARNING:** Cancer and Reproductive Harm - www.P65Warnings.ca.gov



BILGE WATER ALARM PANEL WITH PUMP SWITCH

Injection Molded ABS

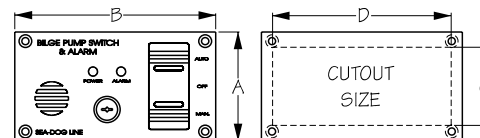

Bulk	Display	A	B	C	D	Wt.(lb.)	Std. Pack
n/a	423035-1	2-7/16"	4-1/2"	1-3/4"	4"	.20	1 ea
420504	420504-1	Replacement Fuse Holder (15 Amp)				.01	10 ea

The Bilge Water Alarm Panel with Pump Switch provides both an audible and visual means of warning that the water level in your bilge is above your bilge pump float switch level. There is no need for a separate bilge pump switch, as the control switch selects between the automatic and manual (momentary on) function of the bilge pump. 15A. Constructed of injection molded ABS. Installs with four RH fasteners (not included). **WARNING: NOT FOR USE WITH PUMPS THAT HAVE BUILT-IN SWITCHES.**

⚠ **WARNING:** Cancer and Reproductive Harm - www.P65Warnings.ca.gov

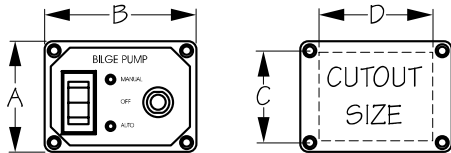
**BILGE PUMP PANEL WITH CIRCUIT BREAKER**

Injection Molded ABS

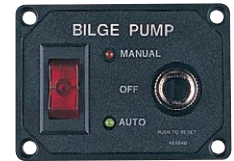

Bulk	Display	A	B	C	D	Fastener	Wt.(lb.)	Std. Pack
423040	423040-1	2-3/16"	3"	1-11/16"	2-1/4"	#6 RH	.11	5 ea
420443	420443-1	Replacement Rocker Switch					.02	10 ea

The deluxe Bilge Pump Panel features a three-way switch, allowing both automatic and manual switching of the bilge pump. When operated in the Manual mode, a red LED light is activated. When in the Automatic mode, a green LED light is activated. In addition, the panel is designed so the words "Bilge Pump" will illuminate when back lit, allowing for easy location and operation at night. Includes UL listed 20A circuit breaker, allowing quick and easy resetting of the system. Additional breaker sizes available (420805-420830). Constructed of injection molded ABS for maximum durability and corrosion resistance. Installs with four #6 RH fasteners (not included).

⚠ **WARNING:** Cancer and Reproductive Harm - www.P65Warnings.ca.gov

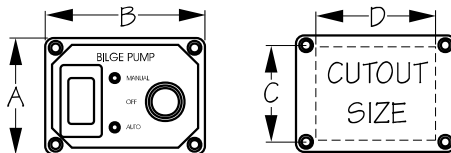
**SPLASH GUARD BILGE PUMP PANEL
W/ CIRCUIT BREAKER**

Injection Molded ABS



Bulk	Display	A	B	C	D	Fastener	Wt.(lb.)	Std. Pack
423046	423046-1	2-3/16"	3"	1-11/16"	2-1/4"	#6 RH	.11	5 ea
420443	420443-1	Replacement Rocker Switch					.02	10 ea
420839	420839-1	Thermal Breaker Boot					.01	10 pr

The Splash Guard Bilge Pump Panel features a splash guard switch cover making this panel ideal for applications where the front might be subjected to light spray or water (NOT designed for total water immersion). This deluxe version features a three-way switch allowing both automatic and manual switching of the bilge pump. When operated in Manual mode, a red LED light is activated. When in Automatic mode, a green LED light is activated. The panel is designed so the words "Bilge Pump" will illuminate when back lit, allowing for easy location and operation at night. UL listed 20A circuit breaker included. Additional breaker sizes available (420805-420830). Constructed of injection molded ABS for maximum durability and corrosion resistance. Installs with four #6 RH fasteners (not included).

⚠ **WARNING:** Cancer and Reproductive Harm - www.P65Warnings.ca.gov

DECAL SHEET

Plastic



Bulk	Display	No. of Decals	Label Width	Label Height	Wt.(lb.)	Std. Pack
0P9A0101	n/a	60 (including 3 blanks)	1.365"	0.365"	.01	1 ea

60 Labels Included:

- AC Main Shore
- Bilge Pump
- Air Cond
- Bow Light
- Running Lights
- Heater
- Cockpit Lights
- Cabin Lights Stbd
- Instruments
- 24 VCD Main
- Eng Room Lights
- Refrig
- Depth Sounder
- Wind Instrument
- Gas Valve
- Horn
- AC Outlets
- Instrument Lights
- Head
- Masthead Lights
- Anchor Light
- Sump Pump
- Accessories
- Cabin Lights
- Fore Deck Lights
- Blower
- Compass Light
- Search Lights
- DC Power
- Shower Pump
- Windlass
- 24 VDC Outlets
- Fans
- Navigation Lights
- Reversed Polarity
- Stereo TV
- AC Power
- Eng Room Blower
- Loran
- Battery Charger
- Cabin Lights Port
- Deck Lights
- 12 VDC Main
- Ignition
- Spreader Lights
- Radar 12 VDC Outlets
- Outlet Stbd
- Outlet Port
- Knotmeter
- Water Heater
- VHF R/T
- Radio
- Computer
- GPS
- Wiper
- Docking Lights
- Security Alarm
- Blank (x3)



VERTICAL 4-GANG ROCKER SWITCH PANEL

Fire Resistant Injection Molded Nylon/4 Illuminating Switches

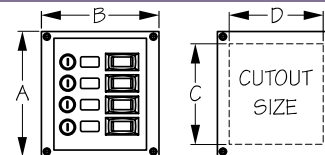

Bulk	Display	A	B	C	D	Fastener	Wt.(lb.)	Std. Pack
n/a	424010-1	4-13/16"	4-1/2"	3-7/8"	3-5/8"	#6 RH	.47	1 ea
OP9A0104	n/a	Replacement Decal Sheet (20 peel and stick labels)						.01 1 ea
420446	420446-1	Replacement Rocker Switch						.02 10 ea
420504	420504-1	Replacement Fuse Holder						.01 10 ea

The Vertical 4-Gang Rocker Switch Panel features four 15A 12VDC illuminated SPST On/Off rocker switches and four fuse holders for use with standard AGC 1/4" x 1-1/4" glass style fuses. Individual circuit 10A max. 37A total. These fire resistant panels are suitable for use in engine room compartments. Includes a sheet of 20 preprinted decals to customize to your specific application. Constructed of injection molded nylon. Installs with four #6 RH fasteners (not included). CE compliant. 12VDC.

⚠ WARNING: Cancer and Reproductive Harm - www.P65Warnings.ca.gov



SPLASH GUARD VERTICAL 4-GANG ROCKER SWITCH PANEL

Fire Resistant Injection Molded Nylon/4 Illuminating Switches

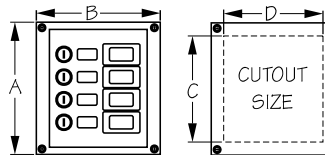

Bulk	Display	A	B	C	D	Fastener	Wt.(lb.)	Std. Pack
n/a	424016-1	4-13/16"	4-1/2"	3-7/8"	3-5/8"	#6 RH	.47	1 ea
420446	420446-1	Replacement Rocker Switch						.02 10 ea
420504	420504-1	Replacement Fuse Holder						.01 10 ea
OP9A0104	n/a	Replacement Decal Sheet (20 peel-and-stick labels)						.01 1 ea

The Splash Guard Vertical 4-Gang Rocker Switch Panel features four 15A 12VDC illuminated SPST On/Off rocker switches and four fuse holders for use with standard AGC 1/4" x 1-1/4" glass style fuses. Individual circuit 10A max. 37A total. The addition of splash guard switch covers make this panel ideal for use where the front might be subject to light spray or water (NOT designed for total immersion). These fire resistant panels are suitable for use in engine room compartments. Includes a mounting gasket and a sheet of 20 preprinted decals to customize to your specific application. Constructed of injection molded nylon. Installs with four #6 RH fasteners (not included). CE compliant. 12VDC.

⚠ WARNING: Cancer and Reproductive Harm - www.P65Warnings.ca.gov



VERTICAL 6-GANG ROCKER SWITCH PANEL

Fire Resistant Injection Molded Nylon/6 Illuminating Switches

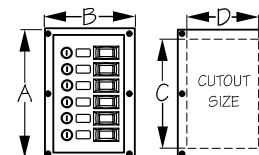

Bulk	Display	A	B	C	D	Fastener	Wt.(lb.)	Std. Pack
n/a	424110-1	6-1/2"	4-1/2"	5-1/2"	3-5/8"	#6 RH	.92	1 ea
420446	420446-1	Replacement Rocker Switch						.02 10 ea
420504	420504-1	Replacement Fuse Holder						.01 10 ea
OP9A0104	n/a	Replacement Decal Sheet (20 peel-and-stick labels)						.01 1 ea

The Vertical 6-Gang Rocker Switch Panel features six 15A 12VDC illuminated SPST On/Off rocker switches and six fuse holders for use with standard AGC 1/4" x 1-1/4" glass style fuses. Individual circuit 10A max. 37A total. These fire resistant panels are suitable for use in engine room compartments. Includes a sheet of 20 preprinted decals to customize to your specific application. Constructed of injection molded nylon. Installs with six #6 RH fasteners (not included). CE compliant. 12VDC.

⚠ WARNING: Cancer and Reproductive Harm - www.P65Warnings.ca.gov

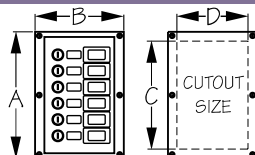

SPLASH GUARD VERTICAL 6-GANG ROCKER SWITCH PANEL

Fire Resistant Injection Molded Nylon/6 Illuminating Switches

Bulk	Display	A	B	C	D	Fastener	Wt.(lb.)	Std. Pack
n/a	424116-1	6-1/2"	4-1/2"	5-1/2"	3-5/8"	#6 RH	.92	1 ea
420446	420446-1	Replacement Rocker Switch					.02	10 ea
420504	420504-1	Replacement Fuse Holder					.01	10 ea
0P9A0104	n/a	Replacement Decal Sheet (20 peel-and-stick labels)					.01	1 ea

The Splash Guard Vertical 4-Gang Rocker Switch Panel features six 15A 12VDC illuminated SPST On/Off rocker switches and six fuse holders for use with standard AGC 1/4" x 1-1/4" glass style fuses. Individual circuit 10A max. 37A total. The addition of splash guard switch covers make this panel ideal for use where the front might be subject to light spray or water (NOT designed for total immersion). These fire resistant panels are suitable for use in engine room compartments. Includes a mounting gasket and a sheet of 20 preprinted decals to customize to your specific application. Constructed of injection molded nylon. Installs with six #6 RH fasteners (not included). CE compliant. 12VDC.

⚠ **WARNING:** Cancer and Reproductive Harm - www.P65Warnings.ca.gov

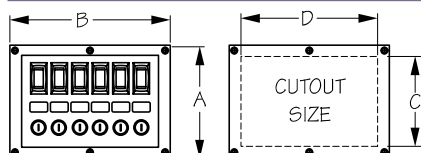

HORIZONTAL 6-GANG ROCKER SWITCH PANEL

Fire Resistant Injection Molded Nylon/6 Illuminating Switches

Bulk	Display	A	B	C	D	Fastener	Wt.(lb.)	Std. Pack
n/a	424210-1	4-1/2"	6-7/16"	3-5/8"	5-1/2"	#6 RH	.65	1 ea
420446	420446-1	Replacement Rocker Switch					.02	10 ea
420504	420504-1	Replacement Fuse Holder					.01	10 ea
0P9A0104	n/a	Replacement Decal Sheet (20 peel-and-stick labels)					.01	1 ea

The Horizontal 6-Gang Rocker Switch Panel features six 15A 12VDC illuminated SPST On/Off rocker switches and six fuse holders for use with standard AGC 1/4" x 1-1/4" glass style fuses. Individual circuit 10A max. 37A total. These fire resistant panels are suitable for use in engine room compartments. Includes a sheet of 20 preprinted decals to customize to your specific application. Constructed of injection molded nylon. Installs with six #6 RH fasteners (not included). CE compliant. 12VDC.

⚠ **WARNING:** Cancer and Reproductive Harm - www.P65Warnings.ca.gov

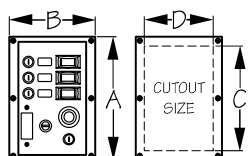

VERTICAL ROCKER SWITCH PANEL W/ BATTERY TESTER & LIGHTER

Fire Resistant Injection Molded Nylon/3 Illuminating Switches

Bulk	Display	A	B	C	D	Fastener	Wt.(lb.)	Std. Pack
n/a	424310-1	6-1/2"	4-1/2"	5-1/2"	3-5/8"	#6 RH	.76	1 ea
420446	420446-1	Replacement Rocker Switch					.02	10 ea
420504	420504-1	Replacement Thermal Breaker					.01	10 ea
0P9A0104	n/a	Replacement Decal Sheet (20 peel-and-stick labels)					.01	1 ea

Vertical Rocker Switch Panel features three 15A 12VDC illuminated SPST On/Off rocker switches, three 10A 12VDC fuse holders, a battery test gauge with switch, and a cigarette lighter with 15A 12VDC fuse holder. Individual circuit 10A max. 37A total. These fire resistant panels are suitable for use in engine room compartments. Includes a sheet of 20 preprinted decals to customize panel. Constructed of injection molded nylon. Installs with six #6 RH fasteners (not included). CE compliant. 12VDC.

⚠ **WARNING:** Cancer and Reproductive Harm - www.P65Warnings.ca.gov

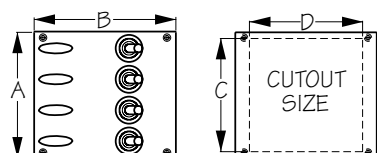

TOGGLE SWITCH PANEL

Injection Molded ABS

Bulk	Display	A	B	C	D	No. of Switches	Wt.(lb.)	Std. Pack
n/a	424604-1	3-3/4"	4-1/4"	3-3/8"	3-3/8"	4	.51	1 ea

The water resistant Toggle Switch Panel features four 15A 12VDC toggle switches, inline fuse holders, and a decal sheet. Constructed of injection molded ABS. Installs with four #6 RH fasteners (not included).

⚠ **WARNING:** Cancer and Reproductive Harm - www.P65Warnings.ca.gov





TOGGLE SWITCH PANEL WITH POWER SOCKET

Injection Molded ABS

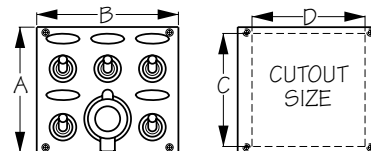

Bulk	Display	A	B	C	D	No. of Switches	Wt.(lb.)	Std. Pack
n/a	424605-1	3-3/4"	4-1/4"	3-3/8"	3-3/8"	5	.69	1 ea

The water resistant Toggle Switch Panel features five 15A 12VDC toggle switches, a 12VDC power socket, inline fuse holders, and a decal sheet. Constructed of injection molded ABS. Installs with four #6 RH fasteners (not included).

⚠ **WARNING:** Cancer and Reproductive Harm - www.P65Warnings.ca.gov



TOGGLE SWITCH PANEL WITH USB POWER SOCKET

Injection Molded ABS/Polycarbonate

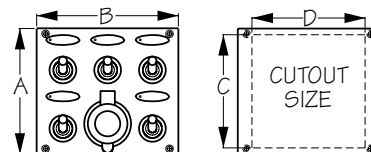

Bulk	Display	A	B	C	D	No. of Switches	Wt.(lb.)	Std. Pack
n/a	424617-1	4"	4-5/16"	3-3/8"	3-3/8"	5	.69	1 ea

The water resistant Toggle Switch Panel features five 15A 12VDC toggle switches with blue LED indicator lights, blue LED lit double USB power socket, ATC fuse holders, and a decal sheet. USB power socket output is 4.8A, 2.4A per side. Constructed of injection molded ABS and polycarbonate. Installs with four #6 RH fasteners (not included). Rated IP66.

⚠ **WARNING:** Cancer and Reproductive Harm - www.P65Warnings.ca.gov



TOGGLE SWITCH PANEL WITH LED POWER SOCKET

Injection Molded ABS/Polycarbonate

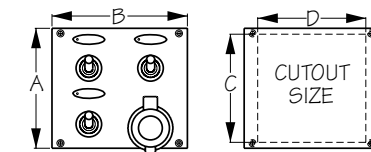

Bulk	Display	A	B	C	D	No. of Switches	Wt.(lb.)	Std. Pack
n/a	424623-1	4"	4-5/16"	3-3/8"	3-3/8"	3	.50	1 ea

The water resistant Toggle Switch Panel features three 15A 12VDC toggle switches with blue LED indicator lights, a blue LED lit power socket, ATC fuse holders, and a decal sheet. Constructed of injection molded ABS and polycarbonate. Installs with four #6 RH fasteners (not included). Rated IP66.

⚠ **WARNING:** Cancer and Reproductive Harm - www.P65Warnings.ca.gov



TOGGLE SWITCH PANEL WITH LED POWER SOCKET

Injection Molded ABS/Polycarbonate

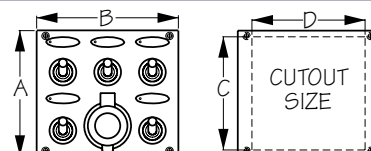

Bulk	Display	A	B	C	D	No. of Switches	Wt.(lb.)	Std. Pack
n/a	424627-1	4"	4-5/16"	3-3/8"	3-3/8"	5	.69	1 ea

The water resistant Toggle Switch Panel features five 15A 12VDC toggle switches with blue LED indicator lights, a blue LED lit power socket, ATC fuse holders, and a decal sheet. Constructed of injection molded ABS and polycarbonate. Installs with four #6 RH fasteners (not included). Rated IP66.

⚠ **WARNING:** Cancer and Reproductive Harm - www.P65Warnings.ca.gov



TOGGLE SWITCH PANEL

Injection Molded ABS/ Polycarbonate

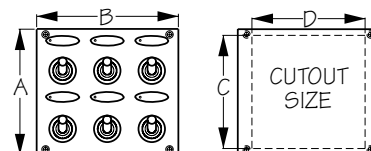

Bulk	Display	A	B	C	D	No. of Switches	Wt.(lb.)	Std. Pack
n/a	424636-1	4"	4-5/16"	3-3/8"	3-3/8"	6	.70	1 ea

The water resistant Toggle Switch Panel features six 15A 12VDC toggle switches with blue LED indicator lights, ATC fuse holders, and a decal sheet. Constructed of injection molded ABS and polycarbonate. Installs with four #6 RH fasteners (not included). Rated IP66.

⚠ **WARNING:** Cancer and Reproductive Harm - www.P65Warnings.ca.gov

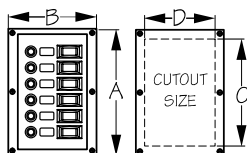

VERTICAL 6-GANG BREAKER ROCKER SWITCH PANEL

Fire Resistant Injection Molded Nylon/6 Illuminating Switches

Bulk	Display	A	B	C	D	Fastener	Wt.(lb.)	Std. Pack
n/a	424800-1	6-1/2"	4-1/2"	5-1/2"	3-5/8"	#6 RH	.92	1 ea
420446	420446-1	Replacement Rocker Switch					.02	10 ea
0P9A0104	n/a	Replacement Decal Sheet (20 peel-and-stick labels)					.01	1 ea

The Vertical 6-Gang Breaker Rocker Switch Panel features six 15A 12VDC illuminated SPST On/Off rocker switches and six thermal AC/DC circuit breakers (two 3A, two 6A, one 8A, and one 10A). Additional sizes available (420805-420810). Individual circuit 10A max. 37A total. These fire resistant panels are suitable for use in engine room compartments. Includes a sheet of 20 preprinted decals to customize to your specific application. Constructed of injection molded nylon. Installs with six #6 RH fasteners (not included). CE compliant. 12VDC.

⚠ **WARNING:** Cancer and Reproductive Harm - www.P65Warnings.ca.gov

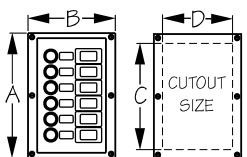

SPLASH GUARD VERTICAL 6-GANG BREAKER ROCKER SWITCH PANEL

Fire Resistant Injection Molded Nylon/6 Illuminating Switches

Bulk	Display	A	B	C	D	Fastener	Wt.(lb.)	Std. Pack
n/a	424806-1	6-1/2"	4-1/2"	5-1/2"	3-5/8"	#6 RH	.71	1 ea
420446	420446-1	Replacement Rocker Switch					.02	10 ea
420504	420504-1	Replacement Fuse Holder					.01	10 ea
420839	420839-1	Thermal Breaker Boot					.01	10 pr
0P9A0104	n/a	Replacement Decal Sheet (20 peel-and-stick labels)					.01	1 ea

The Splash Guard Vertical 6-Gang Breaker Rocker Switch Panel features six 15A 12VDC illuminating SPST On/Off rocker switches and six thermal AC/DC circuit breakers (two 3A, two 6A, one 8A, and one 10A). Additional sizes available (420805-420810). Individual circuit 10A max. 37A total. The addition of splash guard switch covers make this panel ideal for use where the front might be subject to light spray or water (NOT designed for total immersion). These fire resistant panels are suitable for use in engine room compartments. Includes a mounting gasket and a sheet of 20 preprinted decals to customize to your specific application. Constructed of injection molded nylon. Installs with six #6 RH fasteners (not included). 12VDC.

⚠ **WARNING:** Cancer and Reproductive Harm - www.P65Warnings.ca.gov

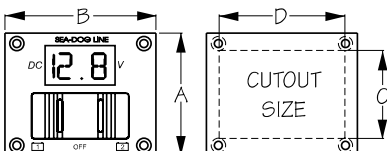

WAVE LED BATTERY TEST ROCKER SWITCH PANEL

Injection Molded Nylon

Bulk	Display	A	B	C	D	Volts	Wt.(lb.)	Std. Pack
n/a	425020-1	2-7/16"	2-15/16"	2"	2-1/2"	14	.20	1 ea

The Wave LED Battery Test Rocker Switch Panel features an illuminating rocker SPDT switch and bright LED display to monitor voltage of two batteries. Constructed of injection molded nylon. Installs with four #6 RH fasteners (not included). 14VDC.

⚠ **WARNING:** Cancer and Reproductive Harm - www.P65Warnings.ca.gov

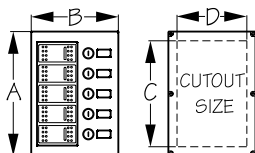

WAVE ROCKER SWITCH FUSE PANEL

Injection Molded Nylon

Bulk	Display	A	B	C	D	No. of Switches	Wt.(lb.)	Std. Pack
n/a	425110-1	6-1/2"	4-1/2"	5-1/2"	3-1/2"	5	.75	1 ea
0P9A0104	n/a	Replacement Decal Sheet (20 peel-and-stick labels)					.01	1 ea

The Wave Rocker Switch Fuse Panel features five ignition protected, illuminating SPST On/Off rocker switches and five fuse holders for use with standard AGC 1/4" x 1-1/4" standard glass fuses (two 3A, two 5A, one 8A, and one 10A). Individual circuit 10A max. 30A total. Includes a sheet of 20 preprinted decals to customize to your specific application. Label decals are back lit with green LEDs. Constructed of injection molded nylon. Installs with six fasteners (not included). 12VDC.

⚠ **WARNING:** Cancer and Reproductive Harm - www.P65Warnings.ca.gov





ROCKER SWITCH PANEL

Stamped Powder Coated Aluminum

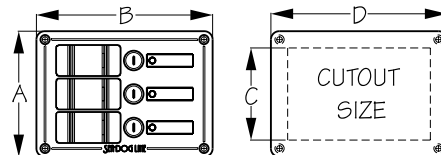

Bulk	Display	A	B	C	D	No. of Switches	Wt.(lb.)	Std. Pack
425130	425130-1	3-3/4"	5-1/4"	2-3/4"	4-3/16"	3	.37	1 ea
OP9A0101	n/a	Replacement Decal Sheet (60 peel-and-stick labels)					.01	1 ea

The Rocker Switch Panel features two illuminating SPST On/Off rocker switches and one illuminating DPDT rocker switch for typical navigation/anchor lighting setup. Constructed of stamped powder coated aluminum. Installs with four RH fasteners (not included). Panel Decal (OP9A0101) sold separately. 12VDC.

⚠ WARNING: Cancer and Reproductive Harm - www.P65Warnings.ca.gov



ROCKER SWITCH PANEL WITH POWER SOCKET & HORN BUTTON

Stamped Powder Coated Aluminum

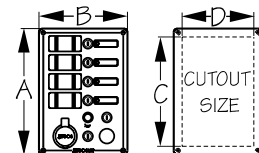

Bulk	Display	A	B	C	D	No. of Switches	Wt.(lb.)	Std. Pack
425144	425144-1	7-1/2"	5-1/4"	6-1/2"	4-3/16"	4	.76	1 ea
OP9A0101	n/a	Replacement Decal Sheet (60 peel-and-stick labels)					.01	1 ea

The Rocker Switch Panel features four illuminating SPST On/Off rocker switches, a horn button, and a 12VDC power socket. Panel has a pre-drilled hole for the addition of an ignition switch if desired (hole capped with plug). Constructed of stamped powder coated aluminum. Installs with four RH fasteners (not included). Panel Decal (OP9A0101) sold separately.

⚠ WARNING: Cancer and Reproductive Harm - www.P65Warnings.ca.gov



ROCKER SWITCH PANEL WITH DUAL POWER SOCKETS

Stamped Powder Coated Aluminum

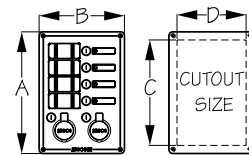

Bulk	Display	A	B	C	D	No. of Switches	Wt.(lb.)	Std. Pack
425146	425146-1	7-1/2"	5-1/4"	6-1/2"	4-3/16"	4	.71	1 ea
OP9A0101	n/a	Replacement Decal Sheet (60 peel-and-stick labels)					.01	1 ea

The Rocker Switch Panel with Dual Power Sockets features four illuminating SPST On/Off rocker switches and two 12VDC power sockets. Constructed of stamped powder coated aluminum. Installs with four RH fasteners (not included). Panel Decal (OP9A0101) sold separately.

⚠ WARNING: Cancer and Reproductive Harm - www.P65Warnings.ca.gov



ROCKER SWITCH PANEL 6-GANG

Stamped Powder Coated Aluminum

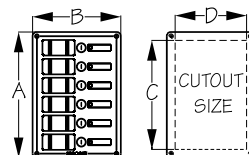

Bulk	Display	A	B	C	D	No. of Switches	Wt.(lb.)	Std. Pack
425160	425160-1	7-1/2"	5-1/4"	6-1/2"	4-3/16"	6	.75	1 ea
OP9A0101	n/a	Replacement Decal Sheet (60 peel-and-stick labels)					.01	1 ea

The 6-Gang Rocker Switch Panel features six illuminating SPST On/Off rocker switches, one illuminating DPDT rocker switch for typical navigation/anchor lighting setup, and six fuse holders for use with standard AGC 1/4" x 1-1/4" standard glass fuses (two 3A, two 5A, one 8A, and one 10A). Constructed of stamped powder coated aluminum. Installs with four RH fasteners (not included). Panel Decal (OP9A0101) sold separately. 12VDC.

⚠ WARNING: Cancer and Reproductive Harm - www.P65Warnings.ca.gov

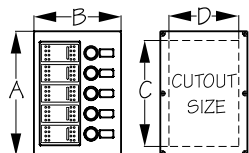

WAVE ROCKER SWITCH BREAKER PANEL

Injection Molded Nylon



Bulk	Display	A	B	C	D	No. of Switches	Wt.(lb.)	Std. Pack
n/a	425800-1	6-1/2"	4-1/2"	5-1/2"	3-1/2"	5	.95	1 ea
0P9A0104	n/a	Replacement Decal Sheet (20 peel-and-stick labels)					.01	1 ea

The Wave Rocker Switch Breaker Panel features five ignition protected, illuminating SPST On/Off rocker switches and five thermal resettable breakers (two 3A, one 5A, one 8A, and one 10A). Individual circuit 10A max. 30A total. Includes a sheet of 20 preprinted decals to customize to your specific application. Label decals are back lit with green LEDs. Constructed of injection molded nylon. Installs with six fasteners (not included). 12VDC.

⚠ **WARNING:** Cancer and Reproductive Harm - www.P65Warnings.ca.gov

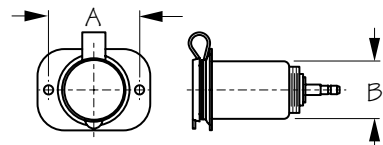

POWER SOCKET WITH PLATE

Stamped 304 Stainless Steel Mounting Plate



Bulk	Display	Socket Material	A	B	Fastener	Wt.(lb.)	Std. Pack
426013	426013-1	Chrome Steel Socket & Molded Cap	1-11/16"	1-1/8"	#8 RH	.12	10 ea
426053	426053-1	Stainless Steel Socket & Molded Cap	1-11/16"	1-1/8"	#8 RH	.12	10 ea

Power Socket with Plate is ideal for installing additional power outlets. Constructed of stainless steel or chrome steel sockets with a stamped 304 stainless steel mounting plate. Installs with two #8 RH fasteners (not included). Chrome version recommended for fresh water use. Maximum: 12VDC, 16A.

⚠ **WARNING:** Cancer and Reproductive Harm - www.P65Warnings.ca.gov

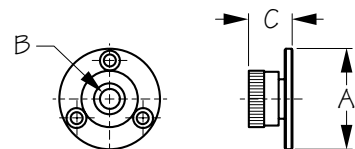

CHROME PLATED CABLE OUTLET

Cast Brass/Chrome Plated



Bulk	Display	A	B	C	Cable Type	Fastener	Wt.(lb.)	Std. Pack
426040	426040-1	1-1/4"	1/4"	5/8"	RG58	#6 FH	.07	10 ea
426042	426042-1	1-1/4"	5/16"	5/8"	RG8X	#6 FH	.07	10 ea
426051	426051-1	1-1/2"	3/8"	11/16"	RG8U	#6 FH	.12	10 ea

Cable Outlets provide a watertight seal for cable installations. Sized to fit coaxial cables RG58, RG8X, or RG8U. Constructed of chrome plated cast brass. Installs with three #6 FH fasteners (not included).

⚠ **WARNING:** Cancer and Reproductive Harm - www.P65Warnings.ca.gov

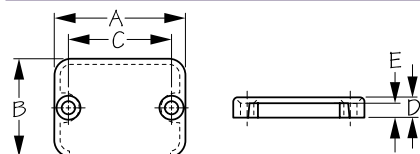

WIRE COVER

Injection Molded ABS



Bulk	Display	A	B	C	D	E	Fastener	Wt.(lb.)	Std. Pack
426090	426090-1	2"	1-1/2"	1-9/16"	5/16"	3/16"	#10 FH	.01 / .02	10 ea / 10 pr

Wire Cover provides protection and decorative cover for wire run holes. Designed to cover holes up to 1-1/4" diameter. Accepts wire up to 3/16" in diameter. Constructed of impact resistant injection molded ABS. Installs with two #10 FH fasteners (not included).

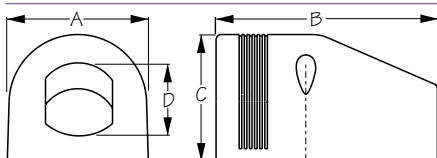

POWER SOCKET SHELL

Injection Molded ABS



Bulk	Display	A	B	C	D	Wt.(lb.)	Std. Pack
426100	426100-1	2-3/16"	3-7/16"	1-15/16"	1-1/8"	.05	10 ea / 5 ea

The Power Socket Shell is used for under dash mounting when drilling a hole in the dash is neither practical or possible. Fits all Sea-Dog® round power sockets, gauges, and meters. Constructed of UV stabilized injection molded ABS. Installs with two fasteners (not included).



INSTRUMENT HOLE ADAPTER FOR SOCKETS & METERS

Injection Molded Nylon

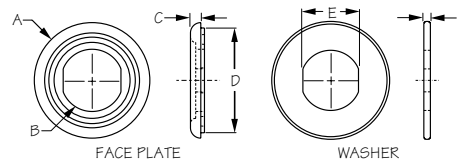

Bulk	Display	A	B	C	D	E	F	Wt.(lb.)	Std. Pack
n/a	426101-1	2-3/16"	1-3/16"	3/16"	1-15/16"	1-1/16"	1/8"	.04	5 ea

This Instrument Hole Adapter is designed to install standard 1-1/8" gauges and meters into 2" instrument dash panel holes. The socket adapter installs by placing the face plate in front of the dashboard, inserting the socket/meter in the hole with the washer behind. The assembly is held in place by the socket/meter nut for a clean finished look. Constructed of UV resistant injection molded nylon.



ROUND POWER SOCKET/METER MOUNTING BRACKET

Injection Molded Nylon

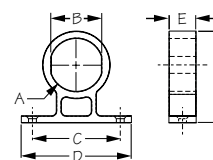

Bulk	Display	A	B	C	D	E	F	Fastener	Wt.(lb.)	Std. Pack
426105	426105-1	1-1/8"	1-1/16"	1-15/16"	2-3/8"	9/16"	1-15/16"	#8 FH	.02	10 ea / 5 ea

This Round Power Socket/Meter Mounting Bracket is designed for the external mounting of round power sockets and gauges 1-1/8" in diameter. Fits all Sea-Dog® round power sockets, gauges, and meters. Constructed of injection molded nylon. Installs with two #8 FH fasteners (not included).

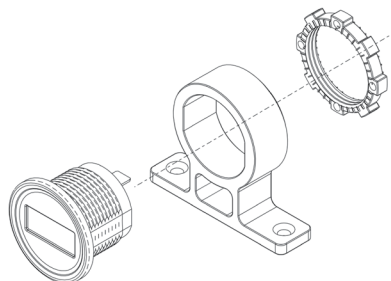

POWER SOCKET REAR BOOT

PVC

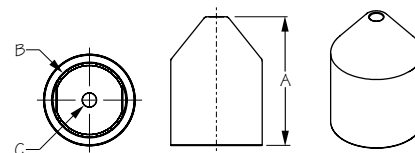

Bulk	Display	A	B	C	Wt.(lb.)	Std. Pack
426106	426106-1	1-7/8"	1-1/8"	1/4"	.03	10 ea / 5 ea

Power Socket Rear Boot protects wire connections and provides a finished appearance. Fits all Sea-Dog® round power sockets, gauges, and meters. Constructed of PVC.

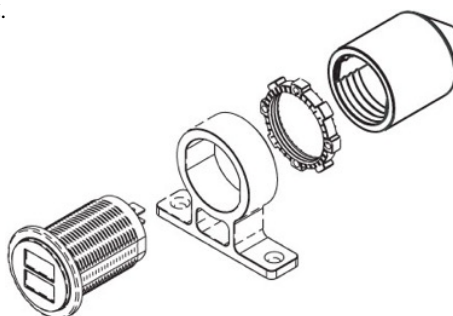

⚠ **WARNING:** Cancer and Reproductive Harm - www.P65Warnings.ca.gov

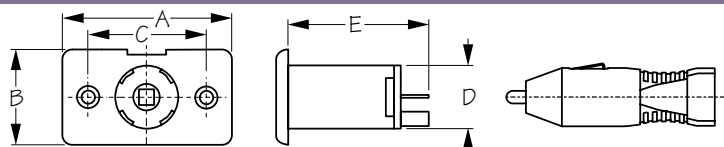
**POWER SOCKET WITH PLUG**

Stamped Brass/Injection Molded Nylon & ABS



Bulk	Display	Description	A	B	C	D	E	Wt.(lb.)	Std. Pack
n/a	426112-1	Socket, Cap & Plug	2-1/4"	1-1/4"	1-1/2"	1-1/16"	1-7/8"	.08	10 ea
426113	426113-1	Socket & Cap	2-1/4"	1-1/4"	1-1/2"	1-1/16"	1-7/8"	.04	10 ea
426114	426114-1	Plug Only	n/a	n/a	n/a	n/a	n/a	.04	10 ea
n/a	426119-1	Cap Only	n/a	n/a	n/a	n/a	n/a	.01	10 ea

Power Socket with Plug easily adds 12V power almost anywhere. Constructed of injection molded nylon and ABS socket with stamped brass plug contacts. Installs with two #8 FH fasteners (not included). Maximum: 12VDC, 16A. Cap and plug may be included or sold separately.

⚠ **WARNING:** Cancer and Reproductive Harm - www.P65Warnings.ca.gov

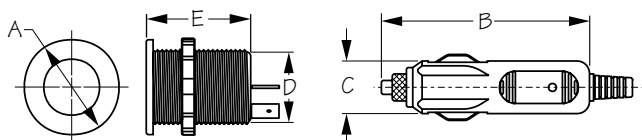
**DELUXE POWER SOCKET WITH PLUG**

Stamped Brass/Injection Molded Nylon & ABS



Bulk	Display	Description	A	B	C	D	E	Wt.(lb.)	Std. Pack
426115	426115-1	Socket & Cap	1-7/16"	n/a	n/a	1-1/16"	1-9/16"	.04	10 ea
n/a	426116-1	Socket, Cap & Plug	1-7/16"	3-3/16"	13/16"	1-7/8"	1-9/16"	.08	10 ea
426118	426118-1	Plug Only	n/a	3-3/16"	13/16"	n/a	n/a	.04	10 ea
426117	426117-1	Cap Only	n/a	n/a	n/a	n/a	n/a	.01	10 ea

Deluxe flush mount Power Socket with Plug adds power virtually anywhere. Installation is as easy as drilling a 1-1/8" hole, inserting the socket body, tightening the nut, and connecting the wires. Plug features a 3 amp fuse and an LED light to indicate when powered. Constructed of injection molded nylon and ABS socket with stamped brass plug contacts. Maximum: 12VDC, 16A. Cap and plug may be included or sold separately.

⚠ **WARNING:** Cancer and Reproductive Harm - www.P65Warnings.ca.gov

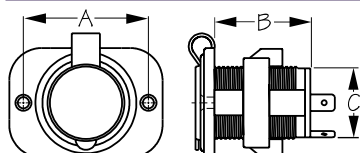
**DELUXE POWER SOCKET**

Stamped Brass/Injection Molded Nylon & ABS



Bulk	Display	Description	A	B	C	Wt.(lb.)	Std. Pack
n/a	426120-1	Receptacle, Speed Nut, Cap & Hardware	1-15/16"	1-1/2"	1-1/16"	.07	10 ea
426125	n/a	Receptacle, Speed Nut & Cap Only	1-15/16"	1-1/2"	1-1/16"	.05	10 ea

Deluxe Power Socket adds power easily almost anywhere. Installation is as easy as drilling a 1-1/8" hole, inserting the socket body, tightening the locking nut, and connecting the wires. Constructed of injection molded nylon and ABS with stamped brass contacts. Display packed version includes all necessary mounting hardware and wire connectors. Maximum: 12VDC, 16A.



⚠ **WARNING:** Cancer and Reproductive Harm - www.P65Warnings.ca.gov



LED POWER SOCKET

Stamped Brass/Injection Molded Nylon & ABS

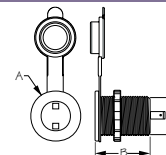

Bulk	Display	A	B	C	Volts	LEDs	LED Color	Wt.(lb.)	Std. Pack
426127	426127-1	1-7/16"	1-9/16"	1-1/16"	12-24	2	Blue	.08	5 ea

LED Power Socket adds power easily almost anywhere. 2 blue LEDs light up the interior. Constructed of injection molded nylon and ABS with stamped brass contacts. Installation is as easy as drilling a 1-1/8" hole, inserting the socket body, tightening the locking nut, and connecting the wires. Also fits Sea-Dog® Power Socket Shell (426100). Input 12-24VDC. 16A. IP65 rating.

⚠ WARNING: Cancer and Reproductive Harm - www.P65Warnings.ca.gov



DUAL POWER SOCKET

Stamped Brass/Plastic

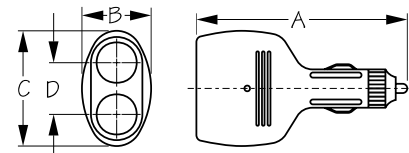

Bulk	Display	A	B	C	D	Wt.(lb.)	Std. Pack
n/a	426130-1	4-3/8"	1-7/16"	2-3/8"	1-1/16"	.14	10 ea

The Dual Power Socket allows two separate 12V devices to be operated at the same time using a power socket or cigarette lighter. Features an internal 10A fuse and LED indicator light. Constructed of stamped brass and plastic. 12VDC @ 5A each.

⚠ WARNING: Cancer and Reproductive Harm - www.P65Warnings.ca.gov



POLARIZED ELECTRICAL OUTLET

Cast Brass/Chrome Plated/Polyethylene

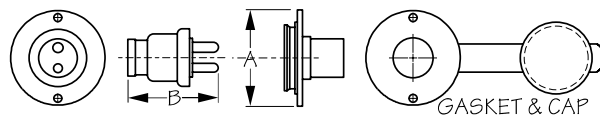

Bulk	Display	Description	A	B	Amps	Fastener	Wt.(lb.)	Std. Pack
426142	426142-1	Complete	1-7/16"	1-3/8"	3	#6 RH	.13	10 ea
426143	426143-1	Deck Outlet & Cap Only	1-7/16"	n/a	3	#6 RH	.09	10 ea
426144	426144-1	Plug Only	n/a	1-3/8"	3		.03	10 ea
n/a	426149-1	Replacement Cap					.01	10 ea

The Polarized Electrical Outlet is designed for use as a 2-conductor deck cable outlet. Pins are sized differently, ensuring only one way to connect the plug, avoiding reverse polarity issues. Includes a rubber gasket and water resistant cap. Constructed of chrome plated cast brass. Installs with two #6 RH fasteners (not included). 3A. 12/24VDC.

⚠ WARNING: Cancer and Reproductive Harm - www.P65Warnings.ca.gov



POLARIZED ELECTRICAL OUTLET - SQUARE

Cast Brass/Chrome Plated/Polyethylene

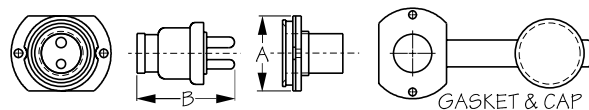

Bulk	Display	Description	A	B	Amps	Fastener	Wt.(lb.)	Std. Pack
426145	n/a	Complete	1-7/64"	1-3/8"	3	#6 RH	.12	10 ea
426148	n/a	Replacement Cap					.01	10 ea
426144	426144-1	Plug Only					.03	10 ea

The Square Polarized Electrical Outlet is designed for use as a 2-conductor deck cable outlet. Pins are sized differently, ensuring only one way to connect the plug, avoiding reverse polarity issues. Includes a rubber gasket and waterproof cap. Designed to mount in 1-1/4" square tubing common on pontoon boats. Constructed of chrome plated cast brass. Installs with two #6 RH fasteners (not included). 3A. 12/24VDC.

⚠ WARNING: Cancer and Reproductive Harm - www.P65Warnings.ca.gov

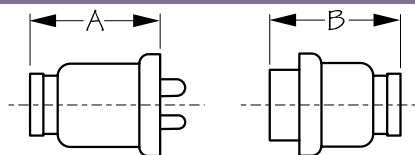

POLARIZED MOLDED ELECTRICAL CONNECTOR

Machined Brass/Molded Bakelite & Neoprene



Bulk	Display	Pin	A	B	Amps	Wt.(lb.)	Std. Pack
426162	426162-1	2	1-1/4"	1-3/16"	3	.06	10 ea
426163	426163-1	3	1-1/4"	1-3/16"	4	.07	10 ea
426164	426164-1	4	1-1/4"	1-3/16"	5	.07	10 ea

The Polarized Molded Electrical Connector is constructed of a molded Bakelite and neoprene body with machined brass polarized pins. Pins are sized differently, ensuring only one way to connect the plug, avoiding reverse polarity issues. 3-5A. 12/24VDC.

⚠ WARNING: Cancer and Reproductive Harm - www.P65Warnings.ca.gov

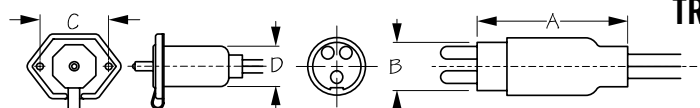

TROLLING MOTOR RECEPTACLE & PLUG

Injection Molded PVC



Bulk	Display	Description	Pin	A	B	C	D	Wt.(lb.)	Std. Pack
426183	426183-1	Receptacle Only	3	n/a	n/a	1-13/16"	1-1/16"	.13	5 ea
426184	426184-1	Plug Only	3	2-1/4"	5/8"	n/a	n/a	.09	5 ea

The Trolling Motor Receptacle & Plug features two 10-gauge wire leads. Receptacle fits 1-1/8" hole. Plug and receptacle sold separately. Constructed of injection molded PVC. 30A. 12/24VDC.

⚠ WARNING: Cancer and Reproductive Harm - www.P65Warnings.ca.gov

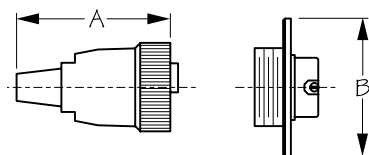

POLARIZED ELECTRICAL OUTLET

Machined Brass/Injection Molded Thermo Plastic



Bulk	Display	A	B	Amps	Pin	Fastener	Wt.(lb.)	Std. Pack
426234	426234-1	2-1/16"	1-7/8"	5	4	#6 FH	.15	10 ea

The Polarized Electrical Outlet is designed for use as a 4-conductor deck cable outlet. Pins are sized differently, ensuring only one way to connect the plug, avoiding reverse polarity issues. Constructed of an injection molded thermo plastic body and cap, with machined brass polarized pins. Installs with two #6 FH fasteners (not included). 5A. 12/24VDC.

⚠ WARNING: Cancer and Reproductive Harm - www.P65Warnings.ca.gov

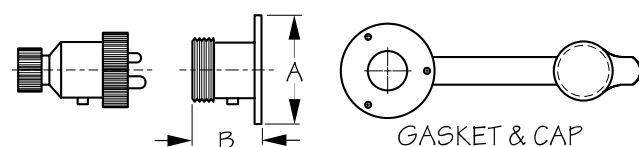

POLARIZED ELECTRICAL OUTLET

Cast Brass/Chrome Plated



Bulk	Display	A	B	Amps	Pin	Fastener	Wt.(lb.)	Std. Pack
426262	426262-1	1-7/16"	15/16"	3	2	#6 RH	.21	10 ea
426263	426263-1	1-7/16"	15/16"	4	3	#6 RH	.22	10 ea
426264	426264-1	1-7/16"	15/16"	5	4	#6 RH	.25	10 ea

The Polarized Electrical Outlet is designed for use as a 2-conductor deck cable outlet. Pins are sized differently, ensuring only one way to connect the plug, avoiding reverse polarity issues. Includes a rubber gasket and water resistant cap. Constructed of chrome plated brass. Installs with three #6 RH fasteners (not included). 3-5A. 12/24VDC.

⚠ WARNING: Cancer and Reproductive Harm - www.P65Warnings.ca.gov



CIGARETTE LIGHTER/CHART LIGHT

Stamped 304 Stainless Steel Mounting Plate

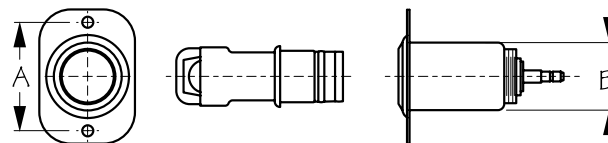

Bulk	Display	Socket Material	A	B	Fastener	Wt.(lb.)	Std. Pack
426312	426312-1	Chrome Steel Socket & Lighter (Complete)	1-11/16"	1-1/8"	#8 RH	.25	10 ea
426352	426352-1	Stainless Steel Socket & Lighter (Complete)	1-11/16"	1-1/8"	#8 RH	.25	10 ea

Cigarette Lighter/Chart Light is dual function with the flick of a switch. Will only accept the Lighter/Chart Light; NOT FOR USE AS POWER SOCKET. Constructed of 304 stainless steel or chrome plated steel with a 304 stainless steel mounting plate. Installs with two #8 RH fasteners (not included). Chrome version recommended for fresh water use. Maximum: 12V, 16A.

⚠ WARNING: Cancer and Reproductive Harm - www.P65Warnings.ca.gov



DUAL OUTLET POWER SOCKET RECEPTACLE

Stamped Brass/Injection Molded Nylon

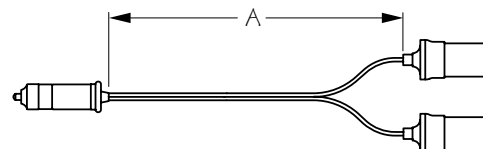

Bulk	Display	A	Wt.(lb.)	Std. Pack
426412	426412-1	14"	.19	10 ea

The Dual Outlet Power Socket Receptacle allows two separate 12V devices to be operated at the same time using a power socket or cigarette lighter. 14" lead wire. Constructed of injection molded nylon and stamped brass. Maximum: 12VDC, 16A.

⚠ WARNING: Cancer and Reproductive Harm - www.P65Warnings.ca.gov



POWER SOCKET WITH BATTERY CLIPS

Stamped Brass/Injection Molded Nylon

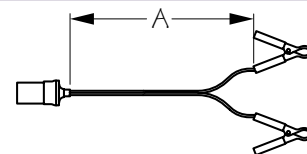

Bulk	Display	A	Wt.(lb.)	Std. Pack
426450	426450-1	6'	.26	10 ea

Power Socket with Battery Clips allow for the temporary use of 12V power accessories on small boats without a built-in power socket. Features 6' lead and color coded clips to avoid polarity misidentification. Constructed of injection molded nylon and stamped brass.

⚠ WARNING: Cancer and Reproductive Harm - www.P65Warnings.ca.gov



BATTERY CLIPS

Stamped Copper Plated Steel

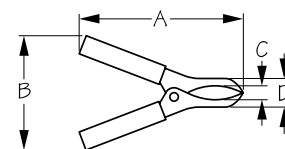

Bulk	Display	A	B	C	D	Volts	Amps	Wt.(lb.)	Std. Pack
426460	426460-1	3"	2-1/8"	1/4"	9/16"	12	10	.07	10 pr

Spring loaded Battery Clips are used for creating temporary electrical connections. Color coded to avoid polarity misidentification. Includes one positive and one negative battery clip. Constructed of stamped copper plated steel for better conductivity. 10A. 12VDC.

⚠ WARNING: Cancer and Reproductive Harm - www.P65Warnings.ca.gov



ALLIGATOR CLIPS

Chrome Plated Steel

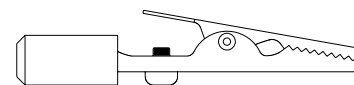

Bulk	Display	Color	Max. Amps	Wt.(lb.)	Std. Pack
n/a	426470-1	Red & Black	10	.02	10 pr
426471	n/a	Red	10	.01	10 ea
426472	n/a	Black	10	.01	10 ea

Spring-loaded, serrated jaw Alligator Clips are used for creating temporary electrical connections. Color coded to avoid polarity misidentification. Includes one positive and one negative battery clip. Constructed of chrome plated steel. 10A max.

⚠ WARNING: Cancer and Reproductive Harm - www.P65Warnings.ca.gov

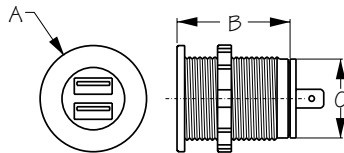
**DOUBLE USB POWER SOCKET W/O LIGHT**

Stamped Stainless Steel/Injection Molded Nylon



Bulk	Display	A	B	C	Volts	Total Output	Wt.(lb.)	Std. Pack
426503	n/a	1-7/16"	1-1/2"	1-1/16"	12-24	5V/4.2A	.08	10 ea

This Double USB Power Socket has no LED indicator light so it will not drain the battery when not in use. Capable of charging two devices simultaneously. The total output 4.8A load is split 2.4A per side as needed. Enough power to charge phones, pads, and tablets quickly and efficiently. Protective dust cap extends the life of the charger. Constructed of injection molded nylon with terminal spade contacts. Installation is as easy as drilling a 1-1/8" hole, inserting the socket body, tightening the locking nut, and connecting the wires. Also fits Sea-Dog® Power Socket Shell (426100) and Mounting Bracket (426105). Output DC 5V/4.8A. Input 12-24VDC.

⚠ **WARNING:** Cancer and Reproductive Harm - www.P65Warnings.ca.gov

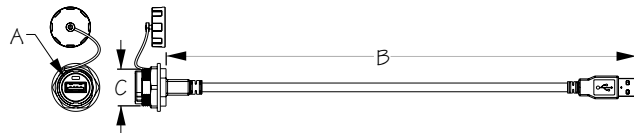
**USB MALE TO FEMALE EXTENSION CORD**

Stamped Stainless Steel/Injection Molded Nylon



Bulk	Display	A	B	C	Volts	Total Output	Wt.(lb.)	Std. Pack
426509	426509-1	7/8"	108"	1"	12-24	5V/4.2A	.15	10 ea / 1 ea

The nine foot 2.4A Male to Female USB Extension Cord extends your USB connection for use charging and accessing printers, keyboards, mice, cameras, and other USB computer peripherals. Perfect for applications where a USB device with a fixed output needs to be connected to the USB port of a computer. Attached cap protects the USB port from water and debris when not in use. Not illuminated. IP67 waterproof rating. RoHS compliant.

⚠ **WARNING:** Cancer and Reproductive Harm - www.P65Warnings.ca.gov

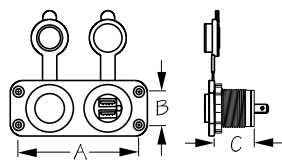
**DOUBLE USB & POWER SOCKET PANEL**

Injection Molded Nylon



Bulk	Display	A	B	C	Volts	USB Total Output	Wt.(lb.)	Std. Pack
426505	426505-1	3-1/2"	1"	1-5/8"	12-24	5V/4.8A	.16	10 ea

Double USB & Power Socket Panel charges two devices simultaneously. Can accommodate both USB connectors, as well as standard power sockets. The total output 4.8A load is split 2.4A per side as needed. Enough power to charge phones, pads, and tablets quickly and efficiently. Protective dust cap extends the life of the charger. Constructed of injection molded nylon. Includes mounting screws and electrical connectors. Output DC 5V/4.8A. Input 12-24VDC. Maximum: 12V, 16A. RoHS compliant.

⚠ **WARNING:** Cancer and Reproductive Harm - www.P65Warnings.ca.gov

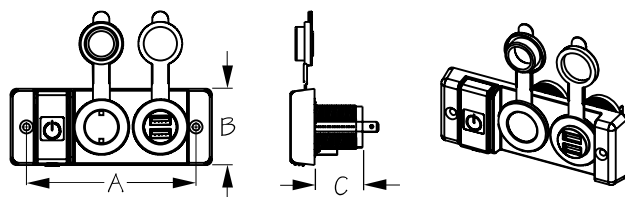
**DOUBLE USB & POWER SOCKET PANEL WITH BREAKER SWITCH**

Injection Molded Nylon



Bulk	Display	A	B	C	Volts	USB Total Output	Wt.(lb.)	Std. Pack
n/a	426506-1	4-1/4"	2"	1-1/4"	12-24	5V/4.8A	.24	1 ea

Double USB & Power Socket Panel with Breaker Switch charges two devices simultaneously. Featuring a 16A illuminating breaker switch it accommodates both USB connectors and standard power sockets. The total output 4.8A load is split 2.4A per side as needed. Enough power to charge phones, pads, and tablets quickly and efficiently. Protective dust cap extends the life of the charger. Constructed of injection molded nylon. Includes mounting screws and electrical connectors. Output DC 5V/4.8A. Input 12-24VDC. Maximum: 12V, 16A.

⚠ **WARNING:** Cancer and Reproductive Harm - www.P65Warnings.ca.gov



DUAL USB POWER SOCKET

Injection Molded Nylon

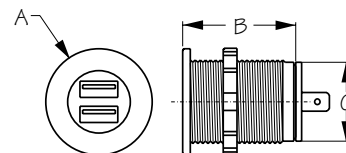

Bulk	Display	A	B	C	Volts	Total Output	Wt.(lb.)	Std. Pack
426515	426515-1	1-7/16"	1-1/2"	1-1/16"	12-24	5V/4.8A	.08	10 ea

Dual USB Power Socket charges two devices simultaneously. The total output 4.8A load is split 2.4A per side as needed. Enough power to charge phones, pads, and tablets quickly and efficiently. Protective dust cap extends the life of the charger. Constructed of injection molded nylon. Installation is as easy as drilling a 1-1/8" hole, inserting the socket body, tightening the locking nut, and connecting the wires. Also fits Sea-Dog® Power Socket Shell (426100). Output DC 5V/4.8A. Input 12-24VDC. Blue LED illumination. IP65 rating. RoHS compliant.

⚠ WARNING: Cancer and Reproductive Harm - www.P65Warnings.ca.gov



DUAL USB POWER PLUG W/ VOLTAGE/AMP METER

Stamped Stainless Steel/Injection Molded Nylon

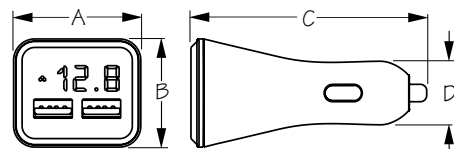

Bulk	Display	A	B	C	D	Volts	Total Output	Wt.(lb.)	Std. Pack
426513	426513-1	1-1/2"	1-1/4"	2-13/16"	13/16"	12-24	5V/4.8A	.05	5 ea

Double USB Power Plug charges two devices simultaneously while the LCD screen displays charging status in both amps and voltage. Features a low voltage audible alarm. The total output 4.8A load is split 2.4A per side as needed. Enough power to charge phones, pads, and tablets quickly and efficiently. Can be used on a boat, car, or RV. This portable version fits all Sea-Dog® Power Sockets and any standard 12V receptacle. Constructed of stamped stainless steel and injection molded nylon. Output DC 5V/4.8A. Input 12-24VDC. Blue LED display. RoHS compliant.

⚠ WARNING: Cancer and Reproductive Harm - www.P65Warnings.ca.gov



DUAL USB SOCKET/VOLTMETER W/ HIDDEN DISPLAY

Injection Molded Nylon

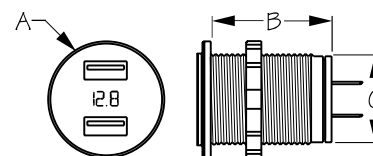

Bulk	Display	A	B	C	Volts	Total Output	Wt.(lb.)	Std. Pack
426517	426517-1	1-7/16"	1-1/2"	1-1/16"	12-24	5V/4.8A	.08	5 ea

This Dual USB Socket charges two devices simultaneously while also displaying the batteries output. The total output 4.8A load is split 2.4A per side as needed. Enough power to charge phones, pads, and tablets quickly and efficiently. Protective dust cap extends the life of the charger. Constructed of injection molded nylon. Installation is as easy as drilling a 1-1/8" hole, inserting the socket body, tightening the locking nut, and connecting the wires. Also fits Sea-Dog® Power Socket Shell (426100). Output DC 5V/4.8A. Input 12-24VDC. Red LED display. IP65 rating.

⚠ WARNING: Cancer and Reproductive Harm - www.P65Warnings.ca.gov



DUAL USB ROCKER SWITCH STYLE POWER SOCKET

Injection Molded Nylon

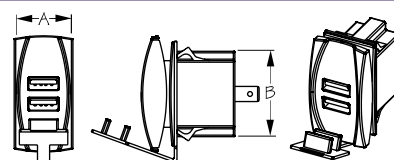

Bulk	Display	A	B	Volts	Total Output	Wt.(lb.)	Std. Pack
426520	426520-1	13/16"	1-7/16"	12-24	5V/4.8A	.05	10 ea

Dual USB Rocker Switch Style Power Socket charges two devices simultaneously. Fits into any 13/16" x 1-7/16" rocker switch hole. The total output 4.8A load is split 2.4A per side as needed. Enough power to charge phones, pads, and tablets quickly and efficiently. Protective dust cap extends the life of the charger. Constructed of injection molded nylon. Output DC 5V/4.8A. Input 12-24VDC. Blue LED illumination. IP65 rating. RoHS compliant.

⚠ WARNING: Cancer and Reproductive Harm - www.P65Warnings.ca.gov

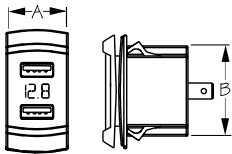

DUAL USB ROCKER SWITCH STYLE VOLTMETER W/ HIDDEN DISPLAY

Injection Molded Nylon



Bulk	Display	A	B	Volts	Total Output	Wt.(lb.)	Std. Pack
426527	426527-1	13/16"	1-7/16"	12-24	5V/4.8A	.05	5 ea

This Dual USB Rocker Switch Style Voltmeter charges two devices simultaneously while also displaying the batteries output. Fits into any 13/16" x 1-7/16" rocker switch hole. The total output 4.8A load is split 2.4A per side as needed. Enough power to charge phones, pads, and tablets quickly and efficiently. Protective dust cap extends the life of the charger. Constructed of injection molded nylon. Output DC 5V/4.8A. Input 12-24VDC. Red LED display. IP65 rating.

⚠ **WARNING:** Cancer and Reproductive Harm - www.P65Warnings.ca.gov

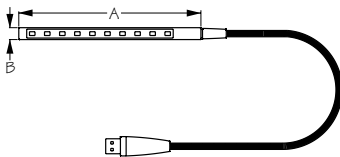

USB MAP LIGHT

Injection Molded Nylon/Powder Coated Steel



Bulk	Display	A	B	LEDs	Wt.(lb.)	Std. Pack
n/a	426560-1	5-3/4"	3/8"	10	.07	1 ea

USB Map Light adds light anywhere a USB port is present. Features 10 bright LEDs and a flexible 7" gooseneck that can rotate 360°, illuminating any dark corner. A three function touch switch provides a full 10 bulb brightness mode as well as a 5 bulb, half bright mode. Light head is detachable for easy storage. Constructed of injection molded nylon and powder coated steel.

⚠ **WARNING:** Cancer and Reproductive Harm - www.P65Warnings.ca.gov

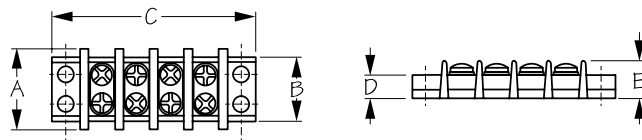

TERMINAL BLOCKS

Stamped Brass/Molded Bakelite



Bulk	Display	Terminals	A	B	C	D	E	Fastener	Wt.(lb.)	Std. Pack
426620	426620-1	10	1-1/8"	7/8"	5-1/16"	5/16"	1/2"	#6 RH	.01	10 ea
426624	426624-1	4	1-1/8"	7/8"	2-1/2"	5/16"	1/2"	#6 RH	.06	10 ea
426626	426626-1	6	1-1/8"	7/8"	3-5/16"	5/16"	1/2"	#6 RH	.08	10 ea
426628	426628-1	8	1-1/8"	7/8"	4-3/16"	5/16"	1/2"	#6 RH	.11	10 ea

Terminal Blocks are modular, insulated, screw-type electrical connectors that are used to secure and/or terminate two or more wires together. Useful for connecting wiring to a ground or for connecting electrical switches and outlets to the mains. Designed for use with tinned copper marine wire which shares the same expansion rate to prevent loosening wires and reducing electrolytic corrosion caused by pairing two disparate metals. Constructed of molded Bakelite and stamped brass. Installs with four #6 RH fasteners (not included). 20A.

⚠ **WARNING:** Cancer and Reproductive Harm - www.P65Warnings.ca.gov

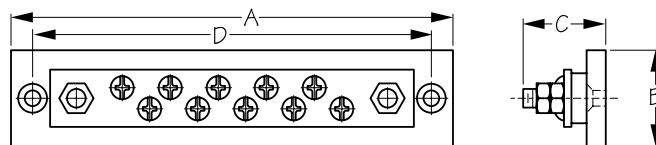

BUSS BAR

Stamped Brass/Molded Bakelite



Bulk	Display	Terminals	A	B	C	D	Fastener	Wt.(lb.)	Std. Pack
426671	426671-1	10	5-3/4"	1-1/4"	1-1/16"	5-3/16"	#10 FH	.26	10 ea
426672	426672-1	20	8-7/8"	1-1/4"	1-1/8"	8-5/16"	#10 FH	.38	10 ea

Electrical Buss Bars provide a convenient way to connect electrical wires, prevent shorts, eliminate splicing, tidy up wire harnesses, and conserve panel space. Non-fused, these distribution blocks are used primarily for routing and connecting power or ground circuits. Designed for use with tinned copper marine wire which shares the same expansion rate to prevent loosening wires and reducing electrolytic corrosion caused by pairing two disparate metals. Constructed of molded Bakelite and stamped brass. Installs with two #10 FH fasteners (not included).

⚠ **WARNING:** Cancer and Reproductive Harm - www.P65Warnings.ca.gov



BUSS BAR WITH COVER

Tin Plated Brass/ABS

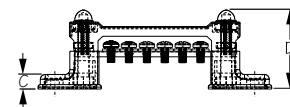
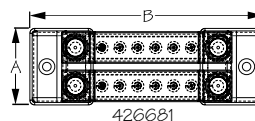
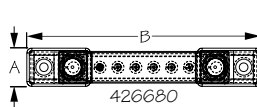

Bulk	Display	Terminals	A	B	C	D	Max. Amps	Fastener	Wt.(lb.)	Std. Pack
n/a	426680-1	6	13/16"	4-7/8"	3/16"	1-11/16"	100	#8 FH	.15	1 ea
n/a	426681-1	12	1-9/16"	4-7/8"	3/16"	1-11/16"	100	#8 FH	.29	1 ea

These Buss Bars are designed for use with tinned copper marine wire which shares the same expansion rate. This prevents loosening wires and reduces electrolytic corrosion caused by pairing two disparate metals. Includes protective covers. 426681-1 has two buss strips that allow both negative and positive connections on the same block. Constructed of tin-plated brass and ABS with a polycarbonate cover. Installs with two #8 FH fasteners (not included). Maximum: 48VDC, 100A. #8-32 terminals. CE, RoHS compliant.

⚠ **WARNING:** Cancer and Reproductive Harm - www.P65Warnings.ca.gov



COMBINATION BUSS BAR

Tin Plated Brass/ABS

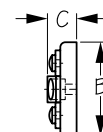
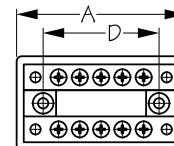

Bulk	Display	Terminals	A	B	C	D	Max. Amps	Fastener	Wt.(lb.)	Std. Pack
426685	426685-1	10 x #8-32	3-1/4"	1-13/16"	9/16"	2-1/4"	100	#10 RH	.13	1 ea
426686	426686-1	20 x #8-32	5-5/16"	1-13/16"	9/16"	4-5/16"	100	#10 RH	.24	1 ea

This Combination Buss Bar features separate buss strips that allow both negative and positive connections on the same block. Designed for use with tinned copper marine wire which shares the same expansion rate to prevent loosening wires and reducing electrolytic corrosion caused by pairing two disparate metals. Constructed of tin plated brass and ABS. Installs with two #10 RH fasteners (not included). Maximum: 48VDC, 100A. #8-32 terminals.

⚠ **WARNING:** Cancer and Reproductive Harm - www.P65Warnings.ca.gov



BUSS BAR SCREW-TERMINAL BLOCK

Tin Plated Brass/ABS

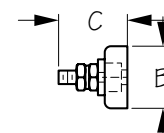
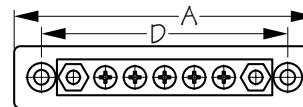

Bulk	Display	Terminals	A	B	C	D	Max. Amps	Fastener	Wt.(lb.)	Std. Pack
426710	426710-1	5 x #8-32	4-3/16"	7/8"	15/16"	3-7/16"	100	#10 RH	.10	1 ea
426711	426711-1	10 x #8-32	6-1/4"	7/8"	15/16"	5-1/2"	100	#10 RH	.15	1 ea

This Buss Bar Screw-Terminal Block is equipped with two each #10-24 studs for main wire connection. Designed for use with tinned copper marine wire which shares the same expansion rate to prevent loosening wires and reducing electrolytic corrosion caused by pairing two disparate metals. Constructed of tin plated brass and ABS. Installs with two #10 RH fasteners (not included). Maximum: 48VDC, 100 amps. #8-32 terminals.

⚠ **WARNING:** Cancer and Reproductive Harm - www.P65Warnings.ca.gov



BUSS BAR STUD TERMINAL BLOCK

Tin Plated Brass/ABS

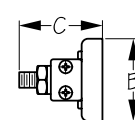
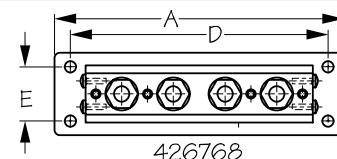

Bulk	Display	Terminals	A	B	C	D	E	Max. Amps	Wt.(lb.)	Std. Pack
426718	426718-1	4 x #10-24	4-3/16"	7/8"	7/8"	3-7/16"	n/a	100	.11	1 ea
426728	426728-1	4 x 1/4"-20	6"	1-1/4"	1-3/8"	5-3/16"	n/a	150	.33	1 ea
426738	426738-1	4 x 5/16"-18	8"	1-1/2"	1-5/8"	7-1/8"	n/a	250	.81	1 ea
426768	426768-1	4 x 3/8"-16	7"	2"	2"	6-1/4"	1-5/16"	600	1.48	1 ea
426719	n/a	Terminal Cover for 426718							.01	10 ea
426729	n/a	Terminal Cover for 426728							.01	10 ea
426739	n/a	Terminal Cover for 426738							.01	10 ea

These Buss Bar Stud Terminal Blocks are primarily used to route and connect power or ground circuits. The raised bus provides easy access on a single stud, making it useful for consolidating multiple wires or feeding multiple circuits. Constructed of tin plated brass and ABS. Installs with #10 RH fasteners (not included). Maximum: 48VDC. 426768 has four #8-32 screw terminals in addition to the four studs.

⚠ **WARNING:** Cancer and Reproductive Harm - www.P65Warnings.ca.gov

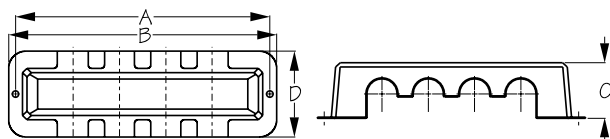
**BUSS BAR STUD TERMINAL BLOCK COVER**

Injection Molded Polystyrene



Bulk	Display	A	B	C	D	Wt.(lb.)	Std. Pack
426719	n/a	5-3/16"	4-3/4"	1-1/16"	1-3/4"	.01	10 ea
426729	n/a	7-7/16"	7-3/4"	1-5/8"	2-1/2"	.01	10 ea
426739	n/a	8-15/16"	9-1/2"	2-3/16"	2-3/4"	.01	10 ea

Block Covers are designed to protect stud terminal blocks from the elements. For use with Buss Bar Stud Terminals (426718-426738). Constructed of injection molded polystyrene.

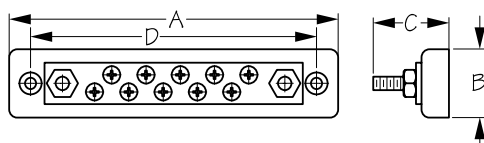
**BUSS BAR SCREW-TERMINAL BLOCK**

Tin Plated Brass/ABS



Bulk	Display	Terminals	A	B	C	D	Amps	Fastener	Wt.(lb.)	Std. Pack
426722	426722-1	10 x #8-32	6"	1-1/4"	1-3/8"	5-3/16"	150	#10 RH	.24	1 ea
426724	426724-1	20 x #8-32	9-1/8"	1-1/4"	1-3/8"	8-7/16"	150	#10 RH	.36	1 ea
426733	426733-1	12 x #10	7-15/16"	1-1/2"	1-5/8"	7-1/8"	250	#10 RH	.69	1 ea

Buss Bar Screw-Terminal Blocks (426722 and 426724) are each equipped with a two 1/4" studs for main wire connection. 426733 is equipped with two 5/16" studs for main wire connection. Constructed of ABS with tin plated brass contacts. Installs with two #10 RH fasteners (not included). Maximum: 48VDC. 426722 has certification by ISO, ABYC, SAE, USCG, and CE low voltage directive standards.

⚠ WARNING: Cancer and Reproductive Harm - www.P65Warnings.ca.gov

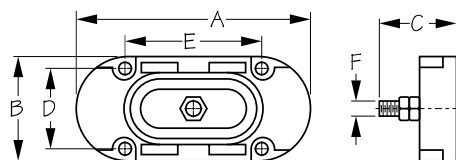
**TERMINAL POST**

Injection Molded Nylon/Stainless Steel



Bulk	Display	A	B	C	D	E	F	Fastener	Wt.(lb.)	Std. Pack
426806	426806-1	3-3/4"	1-11/16"	1-5/8"	1-5/16"	2-3/16"	1/4-20	#10 RH	.09	5 ea
426808	426808-1	3-3/4"	1-11/16"	1-5/8"	1-5/16"	2-3/16"	5/16-18	#10 RH	.10	5 ea
426810	426810-1	3-3/4"	1-11/16"	1-5/8"	1-5/16"	2-3/16"	3/8-16	#10 RH	.11	5 ea
426800	n/a	Terminal Post Cover							.01	5 ea

Terminal Posts include a cover to meet ABYC/USCG requirements. Constructed of injection molded nylon with a stainless steel terminal. Installs with four #10 RH fasteners (not included). Maximum: 48VDC, 150A.

⚠ WARNING: Cancer and Reproductive Harm - www.P65Warnings.ca.gov

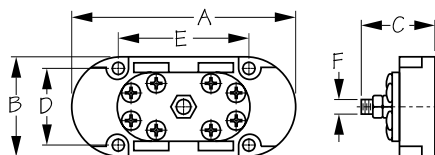
**TERMINAL POST WITH BUSS PLATE**

Nylon/Nickel Plated Brass/Stainless Steel



Bulk	Display	A	B	C	D	E	F	Fastener	Wt.(lb.)	Std. Pack
426826	426826-1	3-3/4"	1-11/16"	1-5/8"	1-5/16"	2-3/16"	1/4-20	#10 RH	.16	5 ea
426828	426828-1	3-3/4"	1-11/16"	1-5/8"	1-5/16"	2-3/16"	5/16-18	#10 RH	.17	5 ea
426830	426830-1	3-3/4"	1-11/16"	1-5/8"	1-5/16"	2-3/16"	3/8-16	#10 RH	.19	5 ea
426800	n/a	Terminal Post Cover							.01	5 ea

Terminal Posts with Buss Plates include a cover to meet ABYC/USCG requirements. Constructed of injection molded nylon with a nickel plated brass and stainless steel terminal. Installs with four #10 RH fasteners (not included). Maximum: 48VDC, 150A.

⚠ WARNING: Cancer and Reproductive Harm - www.P65Warnings.ca.gov



POLARIZED ELECTRICAL CONNECTOR 2-WIRE - PLUG AND SOCKET

Injection Molded PVC

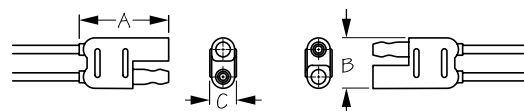

Bulk	Display	A	B	C	Volts	Amps	Wire Gauge	Wt.(lb.)	Std. Pack
426880	426880-1	1-1/16"	5/8"	5/16"	12-24	20	16 Ga. AWM/12"	.03	10 ea

2-Wire Polarized Electrical Connector is an SAE type, two-prong plug and socket connector set. Polarized to assure the proper mating of circuits, reducing the chance of accidental reverse polarity. Color coded 16-gauge 12" lead wire with bullet-type contact pins. Weather resistant connectors are vibration and strain resistant. Use of dielectric grease recommended to further protect circuit from salt spray, debris, and corrosion. Constructed of injection molded PVC. 20A. 12-24VDC.

⚠ WARNING: Cancer and Reproductive Harm - www.P65Warnings.ca.gov



UL CABLE TIE - STANDARD

Injection Molded Nylon

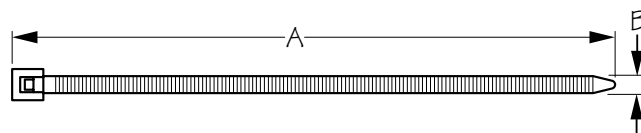

Bulk	Display	A	B	Color	B.S. (lb.)	Qty. Per Bag	Wt.(lb.)	Std. Pack
427204	n/a	4"	7/64"	Black	18	100	.07	5 bags
n/a	427204-2	4"	7/64"	Black	18	25	.02	5 bags
427205	n/a	5-5/8"	7/64"	Black	40	100	.18	5 bags
n/a	427205-2	5-5/8"	7/64"	Black	40	25	.04	5 bags
427209	n/a	7-7/8"	9/64"	Black	50	100	.34	5 bags
n/a	427209-2	7-7/8"	9/64"	Black	50	25	.08	5 bags
427210	n/a	10-1/2"	3/16"	Black	50	100	.41	5 bags
n/a	427210-2	10-1/2"	3/16"	Black	50	25	.10	5 bags
427215	n/a	14-1/2"	19/64"	Black	120	100	1.17	5 bags
n/a	427215-2	14-1/2"	19/64"	Black	120	25	.29	5 bags

Standard UL Cable Ties are used to bundle, organize, and protect cable and wire runs, as well as to simplify installation and maintenance. Temperature Rating: -40°F to 185°F. Flammability Rating: UL 94 V-2L. Constructed of UV stabilized injection molded nylon for continuous or extended exposure to the outdoor environment.



UL CABLE TIE - MIXED KIT

Injection Molded Nylon



Bulk	Display	Description	Wt.(lb.)	Std. Pack
n/a	427290-1	Cable Tie - Mixed Kit (Black)	.24	5 ea

The Cable Tie Mixed Kit includes 25 each of black UL cable ties in 4", 5-5/8", 8-1/2", and 10-1/2" sizes. Temperature Rating: -40°F to 185°F. Flammability Rating: UL 94 V-2L. Constructed of UV stabilized injection molded nylon for continuous or extended exposure to the outdoor environment.



UL CABLE TIE - W/ MOUNTING HOLE

Injection Molded Nylon

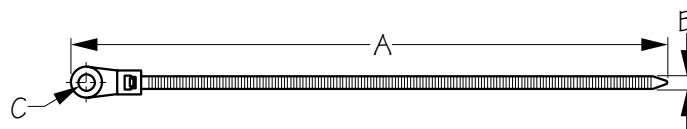

Bulk	Display	A	B	C	Color	B.S. (lb.)	Qty. Per Bag	Wt.(lb.)	Std. Pack
427406	n/a	6-1/4"	9/64"	3/16"	Black	18	100	.23	5 bags
n/a	427406-2	6-1/4"	9/64"	3/16"	Black	18	25	.06	5 bags
427408	n/a	8"	9/64"	3/16"	Black	50	100	.37	5 bags
n/a	427408-2	8"	9/64"	3/16"	Black	50	25	.09	5 bags
427416	n/a	15"	19/64"	3/16"	Black	120	100	.75	5 bags
n/a	427416-2	15"	19/64"	3/16"	Black	120	25	.19	5 bags

UL Cable Tie with Mounting Hole is used to bundle, organize, and protect cable and wire runs, as well as simplify installation and maintenance. These ties include a mounting hole for permanent installations. Temperature Rating: -40°F to 185°F. Flammability Rating: UL 94 V-2L. Constructed of UV stabilized injection molded nylon for continuous or extended exposure to the outdoor environment.

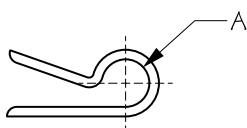
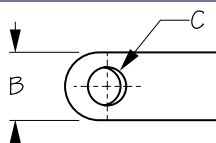
**UL CABLE CLAMP**

Injection Molded Nylon



Bulk	Display	Color	A	B	C	Qty. Per Bag	Wt.(lb.)	Std. Pack
428232	n/a	Black	3/16"	3/8"	3/16"	100	.12	5 bags
n/a	428232-2	Black	3/16"	3/8"	3/16"	25	.03	5 bags
428233	n/a	Black	1/4"	3/8"	3/16"	100	.12	5 bags
n/a	428233-2	Black	1/4"	3/8"	3/16"	25	.03	5 bags
428234	n/a	Black	5/16"	3/8"	3/16"	100	.15	5 bags
n/a	428234-2	Black	5/16"	3/8"	3/16"	25	.04	5 bags
428235	n/a	Black	3/8"	3/8"	3/16"	100	.17	5 bags
n/a	428235-2	Black	3/8"	3/8"	3/16"	25	.04	5 bags
428237	n/a	Black	1/2"	3/8"	3/16"	100	.19	5 bags
n/a	428237-2	Black	1/2"	3/8"	3/16"	25	.05	5 bags
428259	n/a	Black	5/8"	1/2"	3/16"	100	.30	5 bags
n/a	428259-2	Black	5/8"	1/2"	3/16"	25	.08	5 bags
428261	n/a	Black	3/4"	1/2"	3/16"	100	.37	5 bags
n/a	428261-2	Black	3/4"	1/2"	3/16"	25	.09	5 bags
428265	n/a	Black	1"	1/2"	3/16"	100	.44	5 bags
n/a	428265-2	Black	1"	1/2"	3/16"	25	.11	5 bags
428273	n/a	Black	1-1/2"	1/2"	3/16"	100	.73	5 bags
n/a	428273-2	Black	1-1/2"	1/2"	3/16"	25	.19	5 bags

UL Cable Clamp are used to bundle, organize, and protect cable and wire runs, as well as simplify installation and maintenance. Temperature Rating: -40°F to 185°F. Flammability Rating: UL 94 V-2L. Constructed of UV stabilized injection molded nylon.

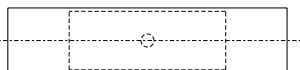
**BUTT CONNECTOR**

Tin Plated Copper/Injection Molded Nylon

Bulk	Display	AWG	Color	Qty. Per Bag	Listed	Wt.(lb.)	Std. Pack
429110	429110-1	22-18	Red	100/10	UL/CSA	1.00 / .10	5 bag / 10 sets
n/a	429110-2	22-18	Red	25	UL/CSA	.25	10 sets
429130	429130-1	16-14	Blue	100/10	UL/CSA	1.00 / .10	5 bag / 10 sets
n/a	429130-2	16-14	Blue	25	UL/CSA	.25	10 sets
429150	429150-1	12-10	Yellow	100/10	UL/CSA	1.00 / .10	5 bag / 10 sets
n/a	429150-2	12-10	Yellow	25	UL/CSA	.25	10 sets

Butt Connectors are designed to transfer electrical current. Most commonly used to connect or splice two wires together to lengthen, change, or repair an electrical circuit. Frequently used during product installation to eliminate soldering the wire joint. Pliable when crimping, the insulation also offers superior heat and deformation resistance. Transparent insulation allows for easy inspection of wire connections. Industry standard color-coding indicates wire size range. Constructed of injection molded nylon insulation and tin plated copper solid barrel for maximum conductivity and holding strength.

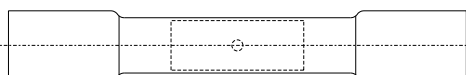
**HEAT SHRINK BUTT CONNECTOR**

Tin Plated Copper/Injection Molded Nylon

Bulk	Display	AWG	Color	Qty. Per Bag	Listed	Wt.(lb.)	Std. Pack
429110H	429110H-1	22-18	Red	100/6	UL/CSA	1.00 / .06	5 bag / 10 sets
n/a	429110H-2	22-18	Red	25	UL/CSA	.25	10 sets
429130H	429130H-1	16-14	Blue	100/6	UL/CSA	1.00 / .06	5 bag / 10 sets
n/a	429130H-2	16-14	Blue	25	UL/CSA	.25	10 sets
429150H	429150H-1	12-10	Yellow	100/6	UL/CSA	1.00 / .06	5 bag / 10 sets
n/a	429150H-2	12-10	Yellow	25	UL/CSA	.25	10 sets

Heat Shrink Butt Connectors are designed to transfer electrical current. Most commonly used to connect or splice two wires together to lengthen, change, or repair an electrical circuit. Frequently used during product installation to eliminate soldering the wire joint. Pliable when crimping, the insulation also offers superior heat and deformation resistance. Transparent insulation allows for easy inspection of wire connections. These connectors benefit from the addition of heat shrink insulation, protecting against moisture and vibration, preventing corrosion and accidental wire pull-out, and significantly increasing the longevity and dependability of the connection. Industry standard color-coding indicates wire size range. Constructed of injection molded nylon insulation and tin plated copper solid barrel for maximum conductivity and holding strength.





HEAT SHRINK RING TERMINAL

Tin Plated Copper/Injection Molded Nylon

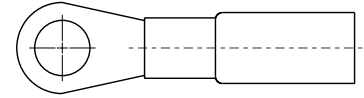

Bulk	Display	AWG	Ring	Color	Qty. Per Bag	Listed	Wt.(lb.)	Std. Pack
429212H	429212H-1	22-18	#4-6	Red	100/6	UL/CSA	1.00 / .06	5 bag / 10 sets
429213H	429213H-1	22-18	#8	Red	100/6	UL/CSA	1.00 / .06	5 bag / 10 sets
429214H	429214H-1	22-18	#10	Red	100/6	UL/CSA	1.00 / .06	5 bag / 10 sets
429216H	429216H-1	22-18	1/4"	Red	100/6	UL/CSA	1.00 / .06	5 bag / 10 sets
429217H	429217H-1	22-18	5/16"	Red	100/6	UL/CSA	1.00 / .06	5 bag / 10 sets
429218H	429218H-1	22-18	3/8"	Red	100/6	UL/CSA	1.00 / .06	5 bag / 10 sets
429232H	429232H-1	16-14	#4-6	Blue	100/6	UL/CSA	1.00 / .06	5 bag / 10 sets
429233H	429233H-1	16-14	#8	Blue	100/6	UL/CSA	1.00 / .06	5 bag / 10 sets
429234H	429234H-1	16-14	#10	Blue	100/6	UL/CSA	1.00 / .06	5 bag / 10 sets
429236H	429236H-1	16-14	1/4"	Blue	100/6	UL/CSA	1.00 / .06	5 bag / 10 sets
429237H	429237H-1	16-14	5/16"	Blue	100/6	UL/CSA	1.00 / .06	5 bag / 10 sets
429238H	429238H-1	16-14	3/8"	Blue	100/6	UL/CSA	1.00 / .06	5 bag / 10 sets
429252H	429252H-1	12-10	#4-6	Yellow	100/6	UL/CSA	1.00 / .06	5 bag / 10 sets
429253H	429253H-1	12-10	#8	Yellow	100/6	UL/CSA	1.00 / .06	5 bag / 10 sets
429254H	429254H-1	12-10	#10	Yellow	100/6	UL/CSA	1.00 / .06	5 bag / 10 sets
429256H	429256H-1	12-10	1/4"	Yellow	100/6	UL/CSA	1.00 / .06	5 bag / 10 sets
429257H	429257H-1	12-10	5/16"	Yellow	100/6	UL/CSA	1.00 / .06	5 bag / 10 sets
429258H	429258H-1	12-10	3/8"	Yellow	100/6	UL/CSA	1.00 / .06	5 bag / 10 sets

Heat Shrink Ring Terminals are designed to transfer electrical current. Ring terminals connect two or more wires to a single connection point. These connectors can be crimped anywhere and are frequently used during electronic installations to eliminate soldering the wire joint. Pliable when crimping, the insulation also offers superior heat and deformation resistance. Transparent insulation allows for easy inspection of wire connection. These connectors benefit from the addition of heat shrink insulation, protecting against moisture and vibration, preventing corrosion and accidental wire pull-out, and significantly increasing the longevity and dependability of the connection. Industry standard color-coding indicates wire size range. Constructed of injection molded nylon insulation and tin plated copper barrel and ring for maximum conductivity and holding strength. Terminals comply with ABYC standard E-11.

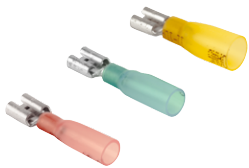

HEAT SHRINK PUSH-ON TERMINAL

Tin Plated Copper/Injection Molded Nylon

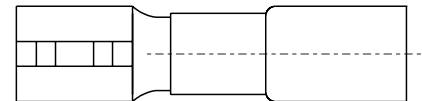

Bulk	Display	Size	AWG	Male/Female	Color	Qty. Per Bag	Listed	Wt.(lb.)	Std. Pack
429319H	429319H-1	.250"	22-18	Female	Red	100/6	UL/CSA	1.00 / .06	5 bag / 10 sets
429339H	429339H-1	.250"	16-14	Female	Blue	100/6	UL/CSA	1.00 / .06	5 bag / 10 sets
429359H	429359H-1	.250"	12-10	Female	Yellow	100/6	UL/CSA	1.00 / .06	5 bag / 10 sets

Heat Shrink Push-On Terminals are designed to transfer electrical current. These connectors can be crimped anywhere and are frequently used during electronic installations to eliminate soldering the wire joint. Pliable when crimping, the insulation also offers superior heat and deformation resistance. Transparent insulation allows for easy inspection of wire connection. These connectors benefit from the addition of heat shrink insulation, protecting against moisture and vibration, preventing corrosion and accidental wire pull-out, and significantly increasing the longevity and dependability of the connection. Industry standard color-coding indicates wire size range. Constructed of injection molded nylon insulation and tin plated copper barrel for maximum conductivity and holding strength. Terminals comply with ABYC standard E-11.



MINI TORCH

Plastic

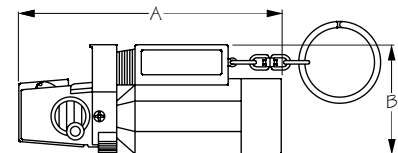

Bulk	Display	A	B	Wt.(lb.)	Std. Pack
n/a	429590-1	3"	1-1/4"	.10	1 ea

The refillable butane Mini Torch features a piezo waterproof ignition, flame lock, windproof flame, protective flip-open style cap, see-through fuel tank, and key chain attachment. Flame can be adjusted with a simple twist. Refillable using standard butane fuel. Can be used for heat shrinking, soldering, igniting outdoor grills, and thawing locks. 30 minute non-stop burn time. 2400°F (1300°C) pin point flame. A great addition to any tool box or emergency kit.

⚠ WARNING: Cancer and Reproductive Harm - www.P65Warnings.ca.gov

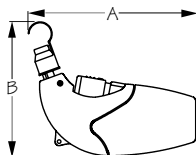

FLAMELESS HEAT GUN WITH WIND GUARD

Plastic



Bulk	Display	A	B	Wt.(lb.)	Std. Pack
n/a	429595-1	4-3/4"	4"	.21	1 ea
429599	429599-1	Replacement Butane Cartridge		.10	1 ea

This water resistant Flameless Heat Gun with Wind Guard features a piezo ignition and built-in locking switch. Powered by refillable butane fuel cell or disposable cigarette lighter. Use it to activate adhesives, bend or form plastics, apply heat shrink tubing, repair vinyl, or thaw locks. Includes a refillable 20-minute butane fuel cell and wind-resistant catalytic heating element. 1300°F (700°C). A great addition to any tool box or emergency kit.

⚠ **WARNING:** Cancer and Reproductive Harm - www.P65Warnings.ca.gov

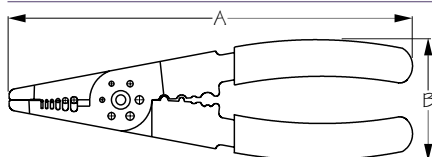

WIRE STRIPPER & CRIMPER

Powder Coated Steel



Bulk	Display	A	B	Wt.(lb.)	Std. Pack
n/a	429900-1	8-1/8"	2-9/16"	.40	1 ea

Wire Stripper & Crimper tool crimps and strips 22-10 gauge wire. Constructed of powder coated steel. A great tool for any tool box.

⚠ **WARNING:** Cancer and Reproductive Harm - www.P65Warnings.ca.gov

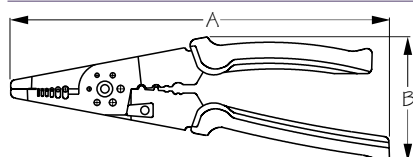

DELUXE WIRE STRIPPER & CRIMPER

Chrome Plated Steel



Bulk	Display	A	B	Wt.(lb.)	Std. Pack
n/a	429905-1	8-7/8"	3"	.50	1 ea

Deluxe Wire Stripper & Crimper tool is spring loaded and strips & crimps 22-10 gauge wire. Constructed of chrome plated steel. A great addition to any tool box.

⚠ **WARNING:** Cancer and Reproductive Harm - www.P65Warnings.ca.gov

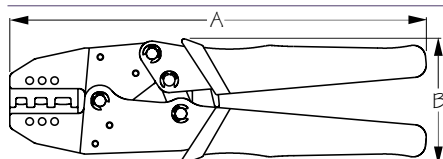

DELUXE TERMINAL CRIMPER

Powder Coated Steel



Bulk	Display	A	B	Wt.(lb.)	Std. Pack
n/a	429910-1	9"	2-7/8"	1.06	1 ea

Deluxe Terminal Crimper tool is designed for use with standard nylon terminal connectors. This deluxe, double ratchet crimper strips and crimps wire from 22-10 gauge. Ratchet action ensures correct crimping pressure. Constructed of powder coated steel. A great addition to any tool box.

⚠ **WARNING:** Cancer and Reproductive Harm - www.P65Warnings.ca.gov

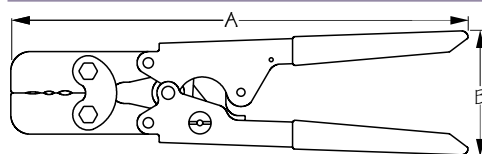

PREMIUM HEAT SHRINK CRIMPER

Powder Coated/Stainless Steel



Bulk	Display	A	B	Wt.(lb.)	Std. Pack
n/a	429920-1	9"	2-3/16"	.77	1 ea

Premium Heat Shrink Crimper tool is designed for use with heat shrink terminals. This high end, single ratchet crimper strips and crimps wire from 22-10 gauge. Ratchet action ensures correct crimping pressure. Constructed of powder coated steel. A great addition to any tool box.

⚠ **WARNING:** Cancer and Reproductive Harm - www.P65Warnings.ca.gov



ADJUSTABLE WIRE STRIPPER & CUTTER

Powder Coated Steel

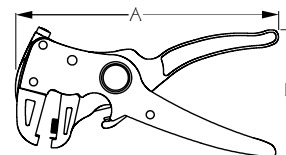

Bulk	Display	A	B	Wt.(lb.)	Std. Pack
n/a	429930-1	6-3/4"	3-3/8"	.56	1 ea

This professional grade Adjustable Wire Stripper & Cutter tool is two tools in one. Self-adjusting and easy to use, it strips or cuts 24-10 gauge wire with ease. Constructed of powder coated steel. A great addition to any tool box.

⚠ WARNING: Cancer and Reproductive Harm - www.P65Warnings.ca.gov



SINGLE MINI COMPACT HORN

Stamped 304 Stainless Steel Cover

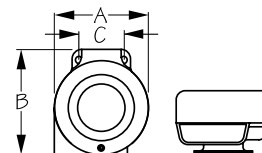

Bulk	Display	Amps	dB	Frequency (Hz)	Finish	A	B	Wt.(lb.)	Std. Pack
431110	431110-1	3	108	440±20	Stainless	3-5/16"	1-9/16"	.75	12 ea / 6 ea

Single Mini Compact Horn features a prewired, sealed sound unit with 304 stainless steel diaphragm and stamped 304 stainless cover. Mounting bracket can be used as a wiring template. A drop-in replacement for many common OEM horns. When installed, horns should point slightly downward to permit water drainage. At 108 decibels and a frequency (Hz) of 440±20A, this horn meets US Coast Guard's COLREGS and ABYC standard A-23 for use on vessels under 12m (39'). NMMA Type Accepted #2577059. 12VDC.

⚠ WARNING: Cancer and Reproductive Harm - www.P65Warnings.ca.gov



TWIN MINI COMPACT HORN

Stamped 304 Stainless Steel Cover

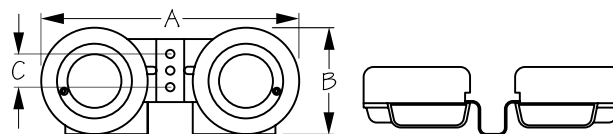

Bulk	Display	Amps	dB	Frequency (Hz)	Finish	A	B	C	Wt.(lb.)	Std. Pack
431120	431120-1	6	111	490±20	Stainless	8"	3-5/16"	1"	1.58	6 ea

Twin Mini Compact Horn features a prewired, sealed sound unit with 304 stainless steel diaphragm and stamped 304 stainless cover. Mounting bracket can be used as a wiring template. A drop-in replacement for many common OEM horns. When installed, horns should point slightly downward to permit water drainage. At 111 decibels and a frequency (Hz) of 490±20A, this horn meets US Coast Guard's COLREGS and ABYC standard A-23 for use on vessels under 12m (39'). NMMA Type Accepted #2577061. 12VDC.

⚠ WARNING: Cancer and Reproductive Harm - www.P65Warnings.ca.gov



MAXBLAST SINGLE MINI COMPACT HORN

Stamped 304 Stainless Steel w/ Injection Molded Housing

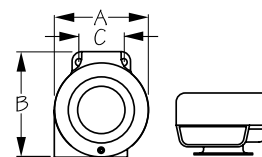

Bulk	Display	Amps	dB	Frequency (Hz)	Finish	A	B	C	Wt.(lb.)	Std. Pack
431115	431115-1	3	108	440±20	Stainless	3-5/16"	3-5/8"	1-9/16"	.75	12 ea / 6 ea

MaxBlast Single Mini Compact Horn is constructed of an injection molded housing under a stamped 304 stainless steel cover. Corrosion resistant stainless steel cover protects the internal components. After a 600 hour salt spray test, this electric horn was completely rust-free! Mounting bracket can be used as a wiring template. When installed, horns should point slightly downward to permit water drainage. At 108 decibels and a frequency (Hz) of 440±20A, this horn meets US Coast Guard's COLREGS and ABYC standard A-23 for use on vessels under 12m (39'). Five-year rust-free warranty. NMMA Type Accepted #2577060. 12VDC.

⚠ WARNING: Cancer and Reproductive Harm - www.P65Warnings.ca.gov

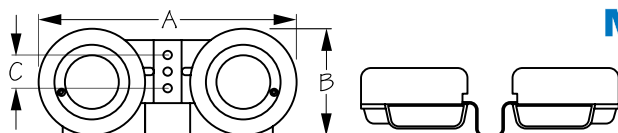
**MAXBLAST TWIN MINI COMPACT HORN**

Stamped 304 Stainless Steel w/ Injection Molded Housing



Bulk	Display	Amps	dB	Frequency (Hz)	Finish	A	B	C	Wt.(lb.)	Std. Pack
431125	431125-1	6	111	490±20	Stainless	8"	3-5/16"	1"	1.58	6 ea

MaxBlast Twin Mini Compact Horn is constructed of an injection molded housing under a stamped 304 stainless steel cover. Corrosion resistant stainless steel cover protects the the internal components. After a 600 hour salt spray test, this electric horn was completely rust-free! Mounting bracket can be used as a wiring template. When installed, horns should point slightly downward to permit water drainage. At 111 decibels and a frequency (Hz) of 490±20A, this horn meets US Coast Guard's COLREGS and ABYC standard A-23 for use on vessels under 12m (39'). Five-year rust-free warranty. NMMA Type Accepted #2577062. 12VDC.

⚠ **WARNING:** Cancer and Reproductive Harm - www.P65Warnings.ca.gov

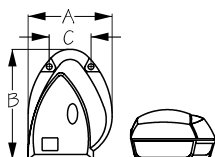
**SONIC MINI COMPACT HORN**

ASA Plastic Cover



Bulk	Display	Amps	dB	Frequency (Hz)	Finish	A	B	C	Wt.(lb.)	Std. Pack
431151	431151-1	3	108	440±20	Chrome	3-3/8"	4-3/8"	1-5/8"	.65	12 ea / 6 ea
431152	431152-1	3	108	440±20	White	3-3/8"	4-3/8"	1-5/8"	.65	12 ea / 6 ea
431153	431153-1	3	108	440±20	Black	3-3/8"	4-3/8"	1-5/8"	.65	12 ea / 6 ea

These Sonic Mini Compact Horns have no polarity, so the negative or positive wire can be attached to either side. Mounting bracket can be used as a wiring template. When installed, horns should point slightly downward to permit water drainage. At 108 decibels and a frequency (Hz) of 440±20A, this horn meets US Coast Guard's COLREGS and ABYC standard A-23 for use on vessels under 12m (39'). Constructed of impact and UV resistant ASA plastic. 12VDC.

⚠ **WARNING:** Cancer and Reproductive Harm - www.P65Warnings.ca.gov

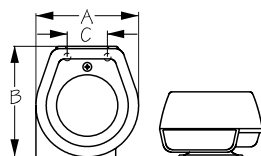
**MINI COMPACT HORN**

Stamped 304 Stainless Steel Cover



Bulk	Display	Amps	dB	Frequency (Hz)	Finish	A	B	C	Wt.(lb.)	Std. Pack
431173	431173-1	4	109	350±15	Black	4"	4-1/2"	1-9/16"	1.07	6 ea

The Mini Compact Horn has no polarity, so the negative or positive wire can be attached to either side. Mounting bracket can be used as a wiring template. When installed, horns should point slightly downward to permit water drainage. At 109 decibels and a frequency (Hz) of 350±15A, this horn meets US Coast Guard's COLREGS and ABYC standard A-23 for use on vessels under 12m (39'). NMMA Type Accepted #2577063. Constructed of a stamped 304 stainless cover with a black finish. 12VDC.

⚠ **WARNING:** Cancer and Reproductive Harm - www.P65Warnings.ca.gov

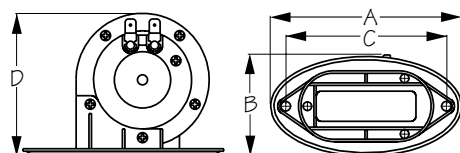
**DROP-IN HIDDEN HORN V.1 WITH GRILLS**

Powder Coated Steel/Injection Molded Nylon



Bulk	Display	Amps	dB	Frequency (Hz)	A	B	C	D	Wt.(lb.)	Std. Pack
n/a	431210-1	3	106	440±20	4-7/8"	2-3/4"	4"	3-3/8"	.72	1 ea

Drop-In Hidden Horn V.1 kit includes a horn plus one chrome and one white decorative billet snap-in grill. Hole size 1-7/8" x 3-3/8". At 106 decibels and a frequency (Hz) of 440±20A, this horn meets US Coast Guard's COLREGS and ABYC standard A-23 for use on vessels under 12m (39'). Constructed of powder coated steel and injection molded nylon. NMMA Type Accepted #2577064. 12VDC.

⚠ **WARNING:** Cancer and Reproductive Harm - www.P65Warnings.ca.gov



DROP-IN HIDDEN HORN V.1

Powder Coated Steel/Injection Molded Nylon

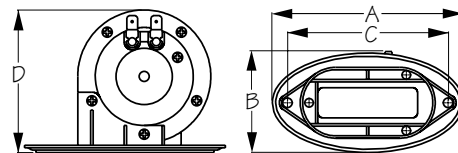

Bulk	Display	Amps	dB	Frequency (Hz)	A	B	C	D	Wt.(lb.)	Std. Pack
431215	n/a	3	106	440±20	4-7/8"	2-3/4"	4"	3-3/8"	.69	1 ea

Drop-In Hidden Horn V.1 is a horn only (grill sold separately). Hole size 1-7/8" x 3-3/8". At 106 decibels and a frequency (Hz) of 440±20A, this horn meets US Coast Guard's COLREGS and ABYC standard A-23 for use on vessels under 12m (39'). Constructed of powder coated steel and injection molded nylon. NMMA Type Accepted #2577064. 12VDC.

⚠ WARNING: Cancer and Reproductive Harm - www.P65Warnings.ca.gov



DROP-IN HIDDEN HORN V.1 (OVER MOLDED)

Powder Coated Steel/Injection Molded Nylon

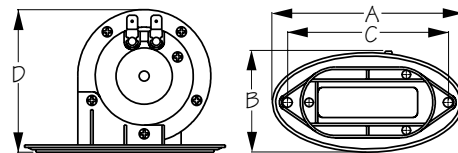

Bulk	Display	Amps	dB	Frequency (Hz)	A	B	C	D	Wt.(lb.)	Std. Pack
431220	n/a	3	106	440±20	4-7/8"	2-3/4"	4"	3-3/8"	.69	1 ea

Over Molded Drop-In Hidden Horn V.1 is a horn only (grill sold separately). Hole size 1-7/8" x 3-3/8". At 106 decibels and a frequency (Hz) of 440±20A, this horn meets US Coast Guard's COLREGS and ABYC standard A-23 for use on vessels under 12m (39'). Constructed of powder coated steel and injection molded nylon. 5-year rust free warranty. NMMA Type Accepted #2577064. 12VDC.

⚠ WARNING: Cancer and Reproductive Harm - www.P65Warnings.ca.gov



SCREW-IN HORN GRILLS FOR V.1 & V.2 HORNS

ASA & ABS w/ Waterproof Fabric/304 Stamped Stainless Steel

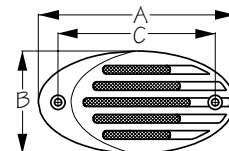

Bulk	Display	Finish	A	B	C	Wt.(lb.)	Std. Pack
431211	n/a	Chrome Grill	4-7/8"	2-3/4"	4"	.04	10 ea
431212	n/a	White Grill	4-7/8"	2-3/4"	4"	.04	10 ea
431213	n/a	Black Grill	4-7/8"	2-3/4"	4"	.04	10 ea
431214	n/a	Stainless Grill Cover	4-7/8"	2-3/4"	4"	.06	10 ea

Screw-In Horn Grills (431211-431213) can only be used with Drop-In Hidden Horns V.1 & V.2 (431215 and 431235) and Mini Compact Horn (431410). The decorative Stainless Grill Cover (431214) is for use in conjunction with Screw-In Horn Grills (431211-431213) for waterproof protection. Constructed of molded ASA and ABS with waterproof fabric to protect the horn from salt spray. Avoid contact with acetone or strong solvents.

⚠ WARNING: Cancer and Reproductive Harm - www.P65Warnings.ca.gov



SNAP-IN GRILLS FOR V.1 & V.2 HORNS

ASA & ABS w/ Waterproof Fabric

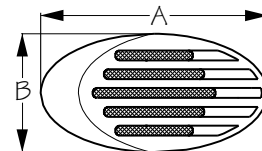

Bulk	Display	Finish	A	B	Wt.(lb.)	Std. Pack
431221	n/a	Chrome	4-7/8"	2-3/4"	.04	10 ea
431222	n/a	White	4-7/8"	2-3/4"	.04	10 ea
431223	n/a	Black	4-7/8"	2-3/4"	.04	10 ea

Snap-In Horn Grills give horns a sleek, modern look with no visible fasteners. For use with Drop-In Hidden Horns V.1 & V.2 (431215 and 431235). Constructed of molded ASA and ABS with waterproof fabric to protect the horn from salt spray. Avoid contact with acetone or strong solvents.

⚠ WARNING: Cancer and Reproductive Harm - www.P65Warnings.ca.gov

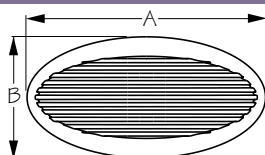

BILLET SNAP-IN HORN GRILLS FOR V.1 & V.2 HORNS

ASA & ABS w/ Waterproof Fabric

Bulk	Display	Finish	A	B	Wt.(lb.)	Std. Pack
431411	n/a	Chrome	4-7/8"	2-3/4"	.04	10 ea
431412	n/a	White	4-7/8"	2-3/4"	.04	10 ea
431413	n/a	Black	4-7/8"	2-3/4"	.04	10 ea

Billet Snap-In Horn Grills give horns a sleek, modern look with no visible fasteners. For use with Drop-In Hidden Horns V.1 & V.2 (431215 and 431235). Constructed of molded ASA and ABS with waterproof fabric to protect the horn from salt spray. Avoid contact with acetone or strong solvents.

⚠ WARNING: Cancer and Reproductive Harm - www.P65Warnings.ca.gov

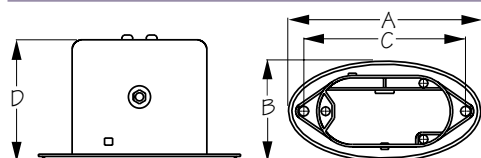

DROP-IN HIDDEN HORN V.2 WITH GRILLS

Powder Coated Steel/Injection Molded Nylon

Bulk	Display	Amps	dB	Frequency (Hz)	A	B	C	D	Wt.(lb.)	Std. Pack
n/a	431230-1	4	108	370±20	4-7/8"	2-3/4"	4"	3-3/8"	.72	1 ea

The Drop-In Hidden Horn V.2 kit includes a horn plus one chrome and one white decorative billet snap-in grill. Hole size 1-7/8" x 3-3/8". At 108 decibels and a frequency (Hz) of 370±20A, this horn meets US Coast Guard's COLREGS and ABYC standard A-23 for use on vessels under 12m (39'). Constructed of powder coated steel and injection molded nylon. NMMA Type Accepted #2577065. 12VDC.

⚠ WARNING: Cancer and Reproductive Harm - www.P65Warnings.ca.gov

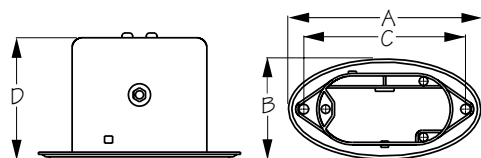

DROP-IN HIDDEN HORN V.2

Powder Coated Steel/Injection Molded Nylon/ASA

Bulk	Display	Amps	dB	Frequency (Hz)	A	B	C	D	Wt.(lb.)	Std. Pack
431235	n/a	4	108	370±20	4-7/8"	2-3/4"	4"	3-3/8"	.69	1 ea

The Drop-In Hidden Horn V.2 is a horn only the grill is sold separately. Hole size 1-7/8" x 3-3/8". At 108 decibels and a frequency (Hz) of 370±20A, this horn meets US Coast Guard's COLREGS and ABYC standard A-23 for use on vessels under 12m (39'). Constructed of powder coated steel and injection molded nylon. NMMA Type Accepted #2577065. 12VDC.

⚠ WARNING: Cancer and Reproductive Harm - www.P65Warnings.ca.gov

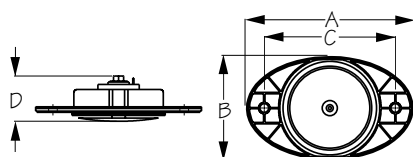

DROP-IN HIDDEN HORN V.3 WITH GRILLS

Powder Coated Steel/Injection Molded Nylon/ASA

Bulk	Display	Amps	dB	Frequency (Hz)	A	B	C	D	Wt.(lb.)	Std. Pack
n/a	431250-1	4	111	370±20	5-1/4"	3-3/8"	4"	1-1/2"	.42	1 ea

The Drop-In Hidden Horn V.3 kit includes a horn plus one chrome and one white decorative billet screw-in grill. Hole size 2-3/4" diameter. At 111 decibels and a frequency (Hz) of 370±20A, this horn meets US Coast Guard's COLREGS and ABYC standard A-23 for use on vessels under 12m (39'). Constructed of powder coated steel and injection molded nylon. NMMA Type Accepted #2577066. 12VDC.

⚠ WARNING: Cancer and Reproductive Harm - www.P65Warnings.ca.gov



DROP-IN HIDDEN HORN V.3

Powder Coated Steel/Injection Molded Nylon/ASA

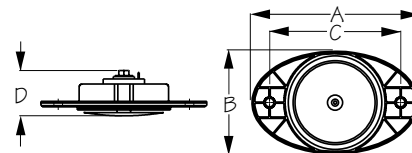

Bulk	Display	Amps	dB	Frequency (Hz)	A	B	C	D	Wt.(lb.)	Std. Pack
431255	n/a	4	111	370±20	5-1/4"	3-3/8"	4"	1-1/2"	.37	1 ea

The Drop-In Hidden Horn V.3 is a horn only the grill is sold separately. Hole size 2-3/4" diameter. At 111 decibels and a frequency (Hz) of 370±20A, this horn meets US Coast Guard's COLREGS and ABYC standard A-23 for use on vessels under 12m (39'). Constructed of powder coated steel and injection molded nylon. NMMA Type Accepted #2577066. 12VDC.

⚠ WARNING: Cancer and Reproductive Harm - www.P65Warnings.ca.gov



BILLET SCREW-IN GRILLS FOR 431255 HORN

ASA & ABS w/ Waterproof Fabric

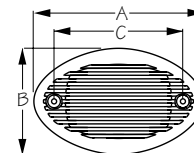

Bulk	Display	Finish	A	B	C	Wt.(lb.)	Std. Pack
431351	n/a	Chrome	5-1/4"	3-3/8"	4"	.05	10 ea
431352	n/a	White	5-1/4"	3-3/8"	4"	.05	10 ea
431353	n/a	Black	5-1/4"	3-3/8"	4"	.05	10 ea

Billet Screw-In Horn Grills are for use with Drop-In Hidden Horns V.3 (431255). Constructed of molded ASA and ABS with a waterproof fabric to protect the horn from salt spray. Avoid contact with acetone or strong solvents.

⚠ WARNING: Cancer and Reproductive Harm - www.P65Warnings.ca.gov



BILLET SCREW-IN GRILL COVER FOR 431255 HORN

Stamped 304 Stainless Steel

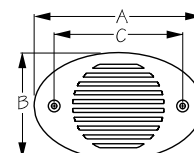

Bulk	Display	Finish	A	B	C	Wt.(lb.)	Std. Pack
431354	n/a	Stainless	5-1/4"	3-3/8"	4"	.09	10 ea

The decorative Stainless Billet Screw-In Horn Grill Cover is for use in conjunction with Screw-In Horn Grills (431351-431353) for waterproof protection. For use with Drop-In Hidden Horn V.3 (431255). Constructed of stamped 304 stainless steel.



BILLET SCREW-IN GRILL W/ GRILL COVER FOR 431255 HORN

304 Stainless Steel/ABS

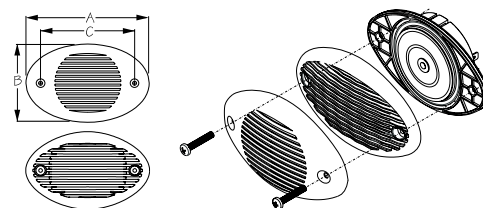

Bulk	Display	Finish	A	B	C	Wt.(lb.)	Std. Pack
431355	n/a	Stainless/Black	5-1/4"	3-3/8"	4"	.14	10 ea

Set comes complete with one Billet Screw-In Grill (431353) and one Stainless Grill Cover (431354) to create a contemporary look for your Drop-In Hidden Horn V.3 (431255). Grill is constructed of black plastic ASA and ABS with waterproof fabric. Cover is constructed of corrosion resistant 304 stainless steel. Horn and fasteners not included.



HIDDEN MOUNT MINI COMPACT HORN

Powder Coated Steel

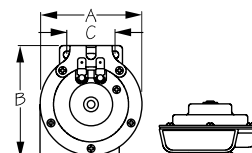

Bulk	Display	Amps	dB	Frequency (Hz)	A	B	C	Wt.(lb.)	Std. Pack
431310	431310-1	3	107	440±20	3-5/16"	3-5/8"	1-9/16"	.68	12 ea / 6 ea

At 107 decibels and a frequency (Hz) of 440±20A, the Hidden Mount Mini Compact Horn meets US Coast Guard's COLREGS and ABYC standard A-23 for use on vessels under 12m (39'). Constructed of powder coated steel. NMMA Type Accepted #2577068. 12VDC.

⚠ WARNING: Cancer and Reproductive Harm - www.P65Warnings.ca.gov

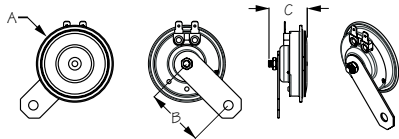

PONTOON BOAT MINI COMPACT HORN W/ BRACKET

Powder Coated Steel/304 Stainless Steel



Bulk	Display	Amps	dB	Frequency (Hz)	A	B	C	Wt.(lb.)	Std. Pack
431430	431430-1	4	111	370±20	2-13/16"	2-3/16"	1-7/16"	.35	12 ea / 6 ea

At 111 decibels and a frequency (Hz) of 370±20A, the Pontoon Boat Mini Compact Horn meets US Coast Guard's COLREGS and ABYC standard A-23 for use on vessels under 12m (39'). Constructed of powder coated steel with corrosion resistant 304 stainless steel bracket for easy mounting. Recommended for freshwater use. NMMA Type Accepted #2601746. 12VDC.

⚠ WARNING: Cancer and Reproductive Harm - www.P65Warnings.ca.gov

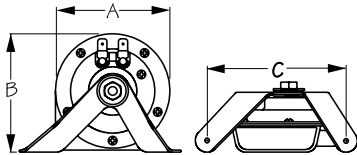

MINI COMPACT HORN W/ BRACKET

Powder Coated Steel



Bulk	Display	Amps	dB	Frequency (Hz)	A	B	C	Wt.(lb.)	Std. Pack
431410	n/a	3	107	440±20	3-5/16"	3-5/8"	4"	.72	12 ea

At 107 decibels and a frequency (Hz) of 440±20A, the Mini Compact Horn meets US Coast Guard's COLREGS and ABYC standard A-23 for use on vessels under 12m (39'). Constructed of powder coated steel. Includes mounting bracket. NMMA Type Accepted #2577067. 12VDC.

⚠ WARNING: Cancer and Reproductive Harm - www.P65Warnings.ca.gov

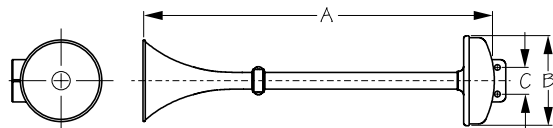

MAXBLAST SINGLE TRUMPET HORN

Stamped 304 Stainless Steel w/ Over Molded Motor Housing



Bulk	Display	Amps	dB	Frequency (Hz)	A	B	C	Volts	Wt.(lb.)	Std. Pack
431510	431510-1	5	118	390±15	16"	4"	1-3/16"	12	1.71	1 ea
431530	431530-1	2.5	118	390±15	16"	4"	1-3/16"	24	1.71	1 ea

MaxBlast Single Trumpet Horn features a prewired, sealed sound unit. After a 600 hour salt spray test, this electric horn was completely rust-free! Horn wiring has no polarity, negative or positive can be attached to either wire. Mounting bracket can be used as a wiring template. When installed, the trumpet should point slightly downward to permit drainage. At 118 decibels and a frequency (Hz) of 390±15A, this horn meets US Coast Guard's COLREGS and ABYC standard A-23 for use on vessels under 12m (39'). Constructed with an over molded housing under a 304 stainless steel exterior and diaphragm, which protects the internal components from corrosion. 5-year rust free warranty. NMMA Type Accepted #2577069 & 2577070. 12 or 24VDC.

⚠ WARNING: Cancer and Reproductive Harm - www.P65Warnings.ca.gov

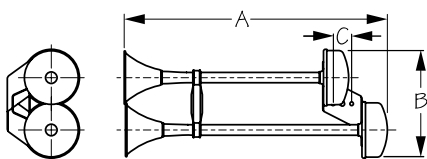

MAXBLAST DUAL TRUMPET HORN

Stamped 304 Stainless Steel w/ Over Molded Motor Housing



Bulk	Display	Amps	dB	Frequency (Hz)	A	B	C	Volts	Wt.(lb.)	Std. Pack
431520	431520-1	10	123	390±15/330±15	18-1/4"	7"	1-5/16"	12	3.55	1 ea
431540	431540-1	5	123	390±15/330±15	18-1/4"	7"	1-5/16"	24	3.55	1 ea

MaxBlast Single Trumpet Horn features a prewired, sealed sound unit. After a 600 hour salt spray test, this electric horn was completely rust-free! Horn wiring has no polarity, negative or positive can be attached to either wire. Mounting bracket can be used as a wiring template. When installed, the trumpet should point slightly downward to permit water drainage. At 123 decibels and a frequency (Hz) of 390±15/330±15, this horn meets the US Coast Guard's COLREGS, US Inland Navigation Rules, Annex III Regulations, and ABYC standard A-23 for boats up to 20 meters (66'). Constructed with an over molded motor housing under a stamped 304 stainless steel exterior and diaphragm, which protects the internal components from corrosion. 5-year rust free warranty. NMMA Type Accepted #2577051 & 2577052. 12 or 24VDC.

⚠ WARNING: Cancer and Reproductive Harm - www.P65Warnings.ca.gov



COMPACT SINGLE TRUMPET HORN

Stamped 304 Stainless Steel

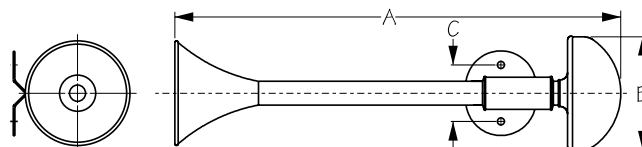

Bulk	Display	Amps	dB	Frequency (Hz)	A	B	C	Volts	Wt.(lb.)	Std. Pack
431610	431610-1	3.5	108	460±15	14"	3-1/2"	1-3/4"	12	1.12	1 ea

The Compact Single Trumpet Horn features a prewired, sealed sound unit. Mounting bracket can be used as a wiring template. When installed, the trumpet should point slightly downward to permit water drainage. At 108 decibels and a frequency (Hz) of 460±15A, this horn meets US Coast Guard's COLREGS and ABYC standard A-23 for use on vessels under 12m (39'). Constructed of corrosion resistant 100% stainless steel exterior with a stamped 304 stainless steel diaphragm. NMMA Type Accepted #2577071. 12VDC.

⚠ WARNING: Cancer and Reproductive Harm - www.P65Warnings.ca.gov



COMPACT DUAL TRUMPET HORN

Stamped 304 Stainless Steel

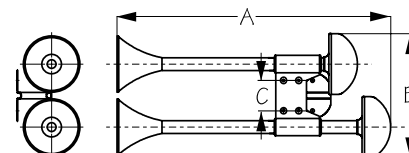

Bulk	Display	Amps	dB	Frequency (Hz)	A	B	C	Volts	Wt.(lb.)	Std. Pack
431620	431620-1	7	110	460±15/415±15	16"	7-1/2"	1-3/4"	12	2.34	1 ea

The Compact Dual Trumpet Horn features a prewired, sealed sound unit. Mounting bracket can be used as a wiring template. When installed, the trumpet should point slightly downward to permit water drainage. At 110 decibels and a frequency (Hz) of 460±15/415±15, this horn meets US Coast Guard's COLREGS and ABYC standard A-23 for use on vessels under 12m (39'). Constructed of corrosion resistant 100% stainless steel exterior with a stamped 304 stainless steel diaphragm. NMMA Type Accepted #2577072. 12VDC.

⚠ WARNING: Cancer and Reproductive Harm - www.P65Warnings.ca.gov



BULLDOG HORN

Chrome ABS/Stamped 304 Stainless Steel

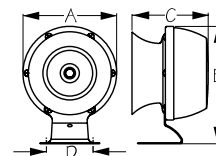

Bulk	Display	Amps	dB	Frequency (Hz)	A	B	C	D	Wt.(lb.)	Std. Pack
n/a	431900-1	4	123	295±15	5"	6-1/2"	4-1/4"	2-1/8"	1.62	1 ea

At 123 decibels and a frequency (Hz) of 295±15A, the Bulldog Horn meets the US Coast Guard's COLREGS, US Inland Navigation Rules, Annex III Regulations, and ABYC standard A-23 for boats up to 20 meters (66'). Mounting bracket can be used as a wiring template. Constructed of chromed ABS and corrosion resistant stamped 304 stainless steel. NMMA Type Accepted #2577053. 12VDC.

⚠ WARNING: Cancer and Reproductive Harm - www.P65Warnings.ca.gov



MAXBLAST AIR HORN - SINGLE TRUMPET

Chrome Plated Brass

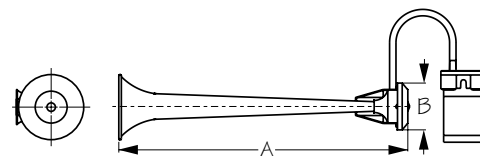

Bulk	Display	Amps	dB	Frequency (Hz)	A	B	PSI	Volts	Wt.(lb.)	Std. Pack
n/a	432510-1	20	120	315±15	17"	2-3/4"	11	12	3.22	1 ea
432510	n/a	Horn Only							1.33	1 ea

The MaxBlast Single Trumpet Air Horn display pack includes the horn, compressor, air tubing, and mounting hardware. At 120 decibels and a frequency (Hz) of 315±15A, this horn meets the US Coast Guard's COLREGS, US Inland Navigation Rules, Annex III Regulations, and ABYC standard A-23 for boats up to 20 meters (66'). When installed, the trumpet should point slightly downward to permit water drainage. Maximum: 20A. Constructed of durable chrome plated brass. NMMA Type Accepted #2577054. 12VDC.

⚠ WARNING: Cancer and Reproductive Harm - www.P65Warnings.ca.gov

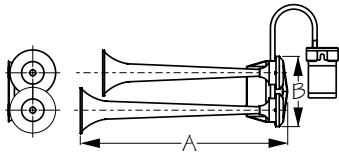
**MAXBLAST AIR HORN - DUAL TRUMPET**

Chrome Plated Brass



Bulk	Display	Amps	dB	Frequency (Hz)	A	B	PSI	Volts	Wt.(lb.)	Std. Pack
n/a	432520-1	20	121	375±15/315±15	17"	5-7/8"	11	12	4.53	1 ea
432520	n/a	Horn Only							2.64	1 ea

The MaxBlast Dual Trumpet Air Horn display pack includes the horn, compressor, air tubing, and mounting hardware. At 121 decibels and a frequency (Hz) of 375±15A/315±15A, this horn meets the US Coast Guard's COLREGS, US Inland Navigation Rules, Annex III Regulations, and ABYC standard A-23 for boats up to 20 meters (66'). When installed, the trumpet should point slightly downward to permit water drainage. Maximum: 20A. Constructed of durable chrome plated brass. NMMA Type Accepted #2577055. 12VDC.

⚠ **WARNING:** Cancer and Reproductive Harm - www.P65Warnings.ca.gov

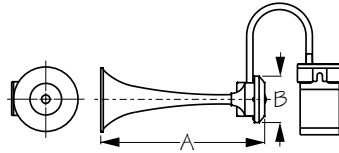
**MAXBLAST AIR HORN - MINI SINGLE TRUMPET**

Chrome Plated Brass/Powder Coated Brass



Bulk	Display	Amps	dB	Finish	A	B	PSI	Volts	Wt.(lb.)	Std. Pack
n/a	432610-1	20	124	Chrome	9-5/8"	2-3/4"	11	12	2.80	1 ea
432610	n/a	Horn Only							.92	1 ea
n/a	432611-1	20	124	White	9-5/8"	2-3/4"	11	12	2.80	1 ea
432611	n/a	Horn Only							.92	1 ea

The MaxBlast Mini Single Trumpet Air Horn display pack includes the horn, compressor, air tubing, and mounting hardware. At 124 decibels and a frequency (Hz) of 630±15A/525±15A, this horn meets the US Coast Guard's COLREGS, US Inland Navigation Rules, Annex III Regulations, and ABYC standard A-23 for boats up to 20 meters (66'). When installed, the trumpet should point slightly downward to permit water drainage. Maximum: 20A. Constructed of durable chrome plated brass. NMMA Type Accepted #2577056 & 2577057. 12VDC.

⚠ **WARNING:** Cancer and Reproductive Harm - www.P65Warnings.ca.gov

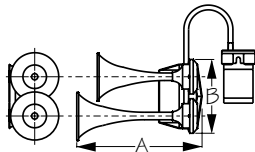
**MAXBLAST AIR HORN - MINI DUAL TRUMPET**

Chrome Plated Brass



Bulk	Display	Amps	dB	Finish	A	B	PSI	Volts	Wt.(lb.)	Std. Pack
n/a	432620-1	20	125	Chrome	9-5/8"	5-7/8"	9-11	12	4.08	1 ea
432620	n/a	Horn Only							2.20	1 ea

The MaxBlast Mini Dual Trumpet Air Horn display pack includes the horn, compressor, air tubing, and mounting hardware. At 125 decibels and a frequency (Hz) of 630±15A/525±15A, this horn meets the US Coast Guard's COLREGS, US Inland Navigation Rules, Annex III Regulations, and ABYC standard A-23 for boats up to 20 meters (66'). When installed, the trumpet should point slightly downward to permit water drainage. Maximum: 20A. Constructed of durable chrome plated brass. NMMA Type Accepted #2577058. 12VDC.

⚠ **WARNING:** Cancer and Reproductive Harm - www.P65Warnings.ca.gov

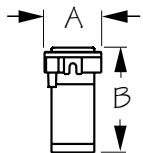
**UNIVERSAL AIR HORN COMPRESSOR W/ SIDE AIR EXIT**

Bulk	Display	Amps	A	B	PSI	Volts	Wt.(lb.)	Std. Pack
432597	432597-1	20	2-1/2"	4-1/4"	11	12	1.30	1 ea

The Universal Air Horn Compressor works with all Sea-Dog® MaxBlast air horns. Features a side air exit for use in tight installation applications. Does not include air tubing or mounting hardware. Maximum: 20A. 12VDC.

⚠ **WARNING:** Cancer and Reproductive Harm - www.P65Warnings.ca.gov



MAXBLAST AIR HORN COMPRESSOR - 12V & 24V

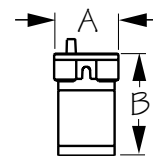

Bulk	Display	Amps	A	B	PSI	Volts	Wt.(lb.)	Std. Pack
432599	432599-1	20	2-1/2"	4"	11	12	1.37	1 ea
432598	432598-1	20	2-1/2"	4"	11	24	1.37	1 ea

The MaxBlast Air Horn Compressor works with all Sea-Dog® MaxBlast air horns. For use in standard installations where head room is not an issue. Does not include air tubing or mounting hardware. Maximum: 20A. 12 or 24VDC. CE compliant.

⚠ WARNING: Cancer and Reproductive Harm - www.P65Warnings.ca.gov



TRUMPET HORN TUBE COVER

Stamped 304 Stainless Steel

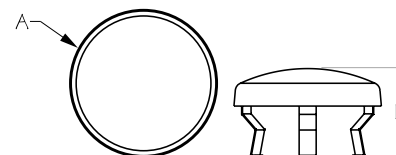

Bulk	Display	A	B	Wt.(lb.)	Std. Pack
n/a	432590-1	3-15/16"	2-3/16"	.40	1 ea

The Trumpet Horn Tube Cover fits all MaxBlast Trumpet Horns. Keeps green water and bugs from getting into the trumpet tube. Snaps over the end of the tube - no tools required. Constructed of corrosion resistant stamped 304 stainless steel.



BILGE BLOWER

Injection Molded ABS Housing

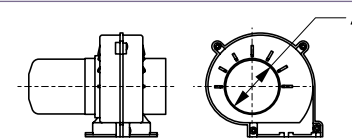

Bulk	Display	A (Hose Size)	CFM	Amps	Volts	Fastener	Wt.(lb.)	Std. Pack
435210	n/a	3"	100	3	12	1/4" Bolt	1.39	1 ea

The 100 CFM Bilge Blower circulates air removing fumes from bilge, engine compartment, heads, and galley. Constructed of injection molded ABS. Installs with four 1/4" bolts (not included). For use with 3" vent hose. 12VDC.

⚠ WARNING: Cancer and Reproductive Harm - www.P65Warnings.ca.gov

IN-LINE BILGE BLOWER

Injection Molded ABS Housing

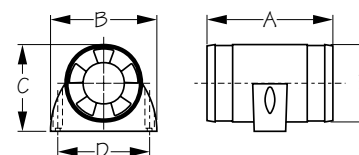

Bulk	Display	A	B	C	D	E (Hose Size)	CFM	Fastener	Wt.(lb.)	Std. Pack
n/a	435215-3	5"	4-1/4"	3-1/2"	3-11/16"	3"	100	#10 RH	.72	1 ea

100 CFM In-Line Bilge Blower circulates air, removing fumes from bilge, heads, and galley. Constructed of injection molded ABS. Installs with two #10 RH fasteners (not included). For use with 3" vent hose. 1.5A @ 12VDC. CE compliant.

⚠ WARNING: Cancer and Reproductive Harm - www.P65Warnings.ca.gov

SINGLE CONTACT BAYONET BASE LIGHT BULB

Nickel Plated Brass Base

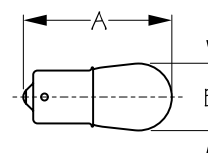

Bulk	Display	A	B	Amps	Volts	Watts	Candle Power	Wt.(lb.)	Std. Pack
441003	441003-1	1-5/8"	3/4"	0.94	12.8	12.0	15	.01 / .02	10 ea / 10 pr
441067	441067-1	1-3/8"	3/4"	0.59	12.8	8.0	4	.01 / .02	10 ea / 10 pr
441093	441093-1	1-7/8"	1"	1.04	12.8	13.3	15	.01 / .02	10 ea / 10 pr
441141	441141-1	1-15/16"	1"	1.44	12.8	18.4	21	.01 / .02	10 ea / 10 pr
441156	441156-1	1-15/16"	1"	2.1	12.8	26.9	32	.01 / .02	10 ea / 10 pr

Single Contact Bayonet Base Light Bulbs are a general purpose incandescent light. Constructed of heavy duty glass housing and filament for break resistance and longevity with nickel plated brass base for corrosion resistance and positive contact. 12.8VDC.

⚠ WARNING: Cancer and Reproductive Harm - www.P65Warnings.ca.gov

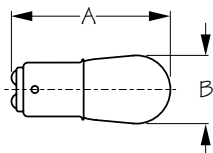
**DOUBLE CONTACT BAYONET BASE LIGHT BULB**

Nickel Plated Brass Base



Bulk	Display	A	B	Amps	Volts	Watts	Candle Power	Wt.(lb.)	Std. Pack
441004	441004-1	1-3/4"	3/4"	0.94	12.8	12.0	15	.01 / .02	10 ea / 10 pr
441032	441032-1	1-3/8"	3/4"	0.25	12.8	5.0	4.5	.01 / .02	10 ea / 10 pr
441034	441034-1	1-15/16"	1"	1.8/0.59	12.8	23.04/8.26	32/3	.01 / .02	10 ea / 10 pr
441076	441076-1	1-7/8"	1"	1.80	12.8	23.0	32	.01 / .02	10 ea / 10 pr
441082	441082-1	1-3/8"	3/4"	1.02	6.5	6.6	6	.01 / .02	10 ea / 10 pr
441090	441090-1	1-3/8"	3/4"	0.58	12.8	7.5	6	.01 / .02	10 ea / 10 pr
441094	441094-1	1-7/8"	1"	1.04	12.8	13.3	15	.01 / .02	10 ea / 10 pr
441142	441142-1	1-7/8"	1"	1.44	12.8	18.4	21	.01 / .02	10 ea / 10 pr
441143	441143-1	1-7/8"	1"	1.44	12.8	18.4	21	.01 / .02	10 ea / 10 pr
441157	441157-1	1-15/16"	1"	2.1/0.59	12.8	26.88/8.26	32/3	.02 / .04	10 ea / 10 pr

Double Contact Bayonet Base Light Bulbs are a general purpose incandescent light. Constructed of heavy duty glass bulb housing and filament for break resistance and longevity with nickel plated brass base for corrosion resistance and positive contact. 441143 has a red lens. 441034 & 441157 (pictured) are dual filament bulbs. 441082 is 6.5VDC; all others are 12.8VDC.

⚠ WARNING: Cancer and Reproductive Harm - www.P65Warnings.ca.gov

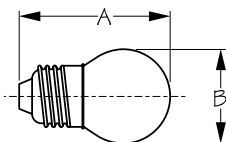
**MEDIUM SCREW BASE LIGHT BULB**

Brass Base



Bulk	Display	A	B	Amps	Volts	Watts	Wt.(lb.)	Std. Pack
441027	441027-1	2-1/2"	1-9/16"	1.25	12.8	15	.03	10 ea

This Medium Screw Base Light Bulb is a general purpose incandescent light. Constructed of heavy duty glass bulb housing and filament for break resistance and longevity with an Edison-style, single contact brass base. 15W. 12.8VDC.

⚠ WARNING: Cancer and Reproductive Harm - www.P65Warnings.ca.gov

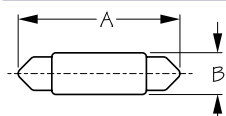
**FESTOON LIGHT BULB**

Nickel Plated Brass Base



Bulk	Display	A	B	Amps	Volts	Watts	Candle Power	Wt.(lb.)	Std. Pack
441035	441035-1	1-5/8"	7/16"	0.77	12.8	10	10	.01 / .02	10 ea / 10 pr
441070	441070-1	1-9/16"	7/16"	1.17	12.8	15	12	.01 / .02	10 ea / 10 pr
441071	441071-1	1-3/16"	7/16"	0.72	12.8	10	6	.01 / .02	10 ea / 10 pr
441854	441854-1	1-1/4"	5/16"	0.72	12.8	10	6	.01 / .02	10 ea / 10 pr
441209	441209-1	1-3/16"	1/4"	0.25	12.8	5	2	.01 / .02	10 ea / 10 pr
441211	441211-1	1-11/16"	7/16"	1.17	12.8	15	12	.01 / .02	10 ea / 10 pr
441212	441212-1	1-11/16"	7/16"	0.72	12.8	10	6	.01 / .02	10 ea / 10 pr

Festoon Light Bulbs are double ended bulbs that resemble AGC style glass fuses and are often used for marine navigation lighting. They give off a warm, incandescent white light. Constructed of heavy duty glass bulb housing and filament for break resistance and longevity with nickel plated brass base ends for corrosion resistance and positive contact. 12.8VDC.

⚠ WARNING: Cancer and Reproductive Harm - www.P65Warnings.ca.gov

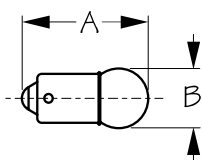
**MINI BAYONET BASE LIGHT BULB**

Nickel Plated Brass Base



Bulk	Display	A	B	Amps	Volts	Watts	Candle Power	Wt.(lb.)	Std. Pack
441053	441053-1	15/16"	7/16"	0.12	12.8	1.7	1	.01 / .02	10 ea / 10 pr
441057	441057-1	1-1/16"	9/16"	0.2	12.8	3.4	2	.01 / .02	10 ea / 10 pr

These Mini Bayonet Base Light Bulbs are a general purpose incandescent light. Constructed of heavy duty glass bulb housing and filament for break resistance and longevity with nickel plated, single contact brass base for corrosion resistance and positive contact. 12.8VDC.

⚠ WARNING: Cancer and Reproductive Harm - www.P65Warnings.ca.gov



HALOGEN FLOOD LIGHT BULB

Nickel Plated Brass/Glass



Bulk	Display	A	B	Amps	Volts	Watts	Style	Wt.(lb.)	Std. Pack
n/a	405111-1	13/16"	3-15/16"	4.58	12	55	H3	.02	5 ea
n/a	405121-1	13/16"	3-15/16"	2.91	24	70	H3	.02	5 ea

Replacement Bulbs for 405110-1, 405115-1, 405120, & 405510. PK22S base type.

⚠ **WARNING:** Cancer and Reproductive Harm - www.P65Warnings.ca.gov



HALOGEN FLOOD LIGHT BULB

Nickel Plated Brass/Glass

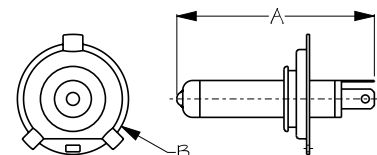

Bulk	Display	A	B	Amps	Volts	Watts	Style	Wt.(lb.)	Std. Pack
405969	n/a	3"	1-11/16"	8.3/7.5	12	100/90	H4	.06	5 ea

Replacement Bulb for 405610-3. P43T base type.

⚠ **WARNING:** Cancer and Reproductive Harm - www.P65Warnings.ca.gov



WEDGE BASE LIGHT BULB

Glass

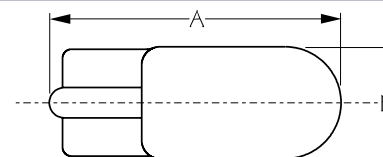

Bulk	Display	A	B	Amps	Volts	Watts	Base	Candle Power	Wt.(lb.)	Std. Pack
441194	441194-1	1"	3/8"	0.27	12.8	3.8	194	2	.01 / .02	10 ea / 10 pr

Similar to a bi-pin connector, a Wedge Base Light Bulb uses two wires that extend into the bulb and are bent up onto the sides of the base where they make contact with the socket. Compression force holds the bulb in the socket to prevent it from loosening from vibration. Ideal for inside or under cabinets and shelves. 12.8VDC.

⚠ **WARNING:** Cancer and Reproductive Harm - www.P65Warnings.ca.gov



HALOGEN BULB WITH REFLECTOR MR-16

Glass

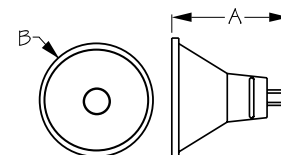

Bulk	Display	A	B	Amps	Volts	Watts	Style	Candle Power	Wt.(lb.)	Std. Pack
441816	441816-1	1-3/4"	2"	0.83	12.8	10	MR-16	500	.06	10 ea

MR-16 Halogen Bulbs with Reflectors and bi-pin base. 10W. 500 candlepower. 12.8VDC.

⚠ **WARNING:** Cancer and Reproductive Harm - www.P65Warnings.ca.gov



HALOGEN LIGHT BULB

Glass

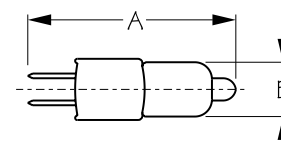

Bulk	Display	A	B	Amps	Volts	Watts	Candle Power	Wt.(lb.)	Std. Pack
441890	441890-1	1-1/4"	5/16"	1.66	12.8	10	350	.01 / .02	10 ea / 10 pr
441891	441891-1	1-1/4"	5/16"	1.66	12.8	20	700	.01 / .02	10 ea / 10 pr

JC type, bi-pin, G4 style Halogen Light Bulb. 10W or 20W. 350 or 700 candlepower. 12.8VDC.

⚠ **WARNING:** Cancer and Reproductive Harm - www.P65Warnings.ca.gov

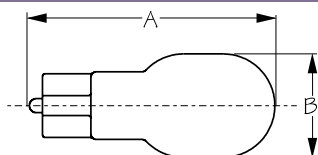
**WEDGE BASE LIGHT BULB**

Glass

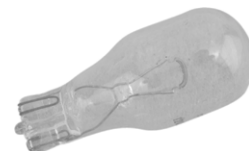

Bulk	Display	A	B	Amps	Volts	Watts	Base/Color	Candle Power	Wt.(lb.)	Std. Pack
441906	441906-1	1-3/8"	9/16"	0.69	12.8	9.0	906/White	6	.01 / .02	10 ea / 10 pr

Similar to a bi-pin connector, a Wedge Base Light Bulb uses two wires that extend into the bulb and are bent up on the sides of the base where they make contact with the socket. Compression force holds the bulb in the socket to prevent loosening from vibration. Ideal for inside or under cabinets and shelves. 12.8VDC.

⚠ WARNING: Cancer and Reproductive Harm - www.P65Warnings.ca.gov

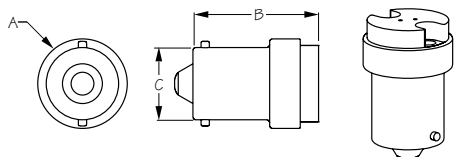
**SINGLE CONTACT BAYONET BASE G4 ADAPTER**

Nickel Plated Brass



Bulk	Display	A	B	C	Base Type	Wt.(lb.)	Std. Pack
n/a	442041-1	3/4"	1-1/16"	9/16"	BA15S	.01	5 ea

Adapts any G4 bi-pin style halogen bulb to a BA15S Single Contact Bayonet Base for use in standard marine light sockets. Constructed of nickel plated brass.

⚠ WARNING: Cancer and Reproductive Harm - www.P65Warnings.ca.gov

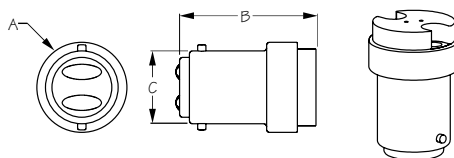
**DOUBLE CONTACT BAYONET BASE G4 ADAPTER**

Nickel Plated Brass



Bulk	Display	A	B	C	Base Type	Wt.(lb.)	Std. Pack
n/a	442042-1	3/4"	1-1/16"	9/16"	BA15D	.01	5 ea

Adapts any G4 bi-pin style halogen bulb to a BA15D Double Contact Bayonet Base for use in standard marine light sockets. Constructed of nickel plated brass.

⚠ WARNING: Cancer and Reproductive Harm - www.P65Warnings.ca.gov

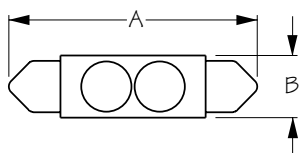
**LED FESTOON**

Nickel Plated Brass



Bulk	Display	A	B	Amps	Volts	Watts	Light Color	LEDs	Wt.(lb.)	Std. Pack
442131	442131-1	1-1/4"	3/8"	40 mA	12.8	0.5	White	1	.01	5 ea
442142	442142-1	1-5/8"	3/8"	70 mA	12.8	0.8	White	2	.01	5 ea

LED Festoons are recommended for indoor use only. Constructed of nickel plated brass.

⚠ WARNING: Cancer and Reproductive Harm - www.P65Warnings.ca.gov

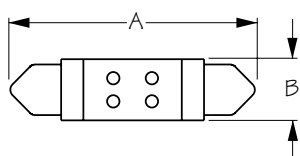
**LED FESTOON**

Nickel Plated Brass



Bulk	Display	A	B	Amps	Volts	Watts	Light Color	LEDs	Wt.(lb.)	Std. Pack
442232	442232-1	1-1/4"	3/8"	20 mA	12.8	0.24	White	4	.01	10 ea
442236	442236-1	1-1/2"	3/8"	20 mA	12.8	0.24	White	4	.01	10 ea
442237	442237-1	1-1/2"	3/8"	20 mA	12.8	0.24	White	6	.01	10 ea
442244	442244-1	1-3/4"	3/8"	30 mA	12.8	0.40	White	6	.01	10 ea
442245	442245-1	1-3/4"	3/8"	30 mA	12.8	0.40	White	8	.01	10 ea

⚠ WARNING: Cancer and Reproductive Harm - www.P65Warnings.ca.gov



ALL AROUND LED FESTOON

Nickel Plated Brass

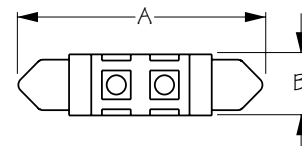

Bulk	Display	A	B	Amps	Volts	Watts	Light Color	LEDs	Wt.(lb.)	Std. Pack
442431	442431-1	1-1/4"	3/8"	30 mA	12.8	0.4	White	4	.01	5 ea
442436	442436-1	1-1/2"	3/8"	55 mA	12.8	0.6	White	8	.01	5 ea
442439	442439-1	1-9/16"	3/8"	60 mA	12.8	0.7	White	8	.01	5 ea
442444	442444-1	1-3/4"	3/8"	80 mA	12.8	1	White	12	.01	5 ea

All Around LED Festoon is for interior installations only. Constructed of nickel plated brass.

⚠ WARNING: Cancer and Reproductive Harm - www.P65Warnings.ca.gov



WARM WHITE LED G4 BASE BULB

Nickel Plated Brass/Plastic

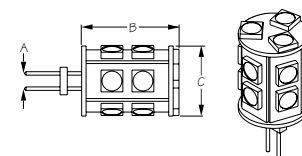

Bulk	Display	A	B	C	Lumens	Watts/Volts	Light Color	LEDs	Wt.(lb.)	Std. Pack
n/a	442642-1	4 MM	1"	5/8"	225	2/12	Warm White	13	.01	5 ea

These Warm White LED G4 Base Bulbs feature a bi-pin base with 13 high quality LEDs that produce 225 lumens. The equivalent of a 15W halogen bulb with an energy efficient 2W power consumption. These bulbs boast 360° omnidirectional light distribution and 50,000 service life hours. Constructed of nickel plated brass and plastic. For use with 12VDC systems only.

⚠ WARNING: Cancer and Reproductive Harm - www.P65Warnings.ca.gov



WARM WHITE LED G4 BASE BULB

Nickel Plated Brass/Plastic

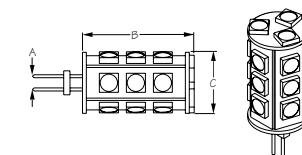

Bulk	Display	A	B	C	Lumens	Watts/Volts	Light Color	LEDs	Wt.(lb.)	Std. Pack
n/a	442643-1	4 MM	1-3/16"	5/8"	290	3/12	Warm White	18	.01	5 ea

These Warm White LED G4 Base Bulbs feature a bi-pin base with 18 high quality LEDs that produce 290 lumens. The equivalent of a 20W halogen bulb with an energy efficient 3W power consumption. These bulbs boast 360° omnidirectional light distribution and 50,000 service life hours. Constructed of nickel plated brass and plastic. For use with 12VDC systems only.

⚠ WARNING: Cancer and Reproductive Harm - www.P65Warnings.ca.gov



DAYLIGHT MR-16 LED BULB WITH REFLECTOR

Glass

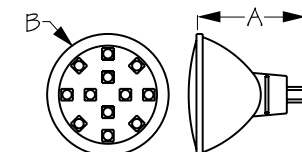

Bulk	Display	A	B	Amps	Volts	Watts	Light Color	LEDs	Wt.(lb.)	Std. Pack
442816	442816-1	1-15/16"	1-15/16"	70 mA	12/24	2.4	White	12	.07	10 ea

Daylight MR-16 LED Bulb with Reflector features 12 LEDs with a low amp draw (70 mA) and domed lens. 6000K. 12 or 24VDC.

⚠ WARNING: Cancer and Reproductive Harm - www.P65Warnings.ca.gov



LED G4 BULB

Plastic

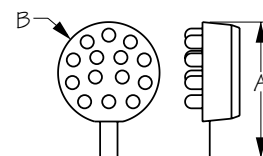

Bulk	Display	A	B	Amps	Volts	Watts	Light Color	LEDs	Wt.(lb.)	Std. Pack
442944	442944-1	1-1/4"	7/8"	60 mA	12.8	0.7	White	14	.01	5 ea

These LED G4 Bulbs feature 14 LEDs with a low amp draw (60 mA) that produce 60 lumens. A direct drop-in replacement for halogen bulbs with a 2-pin GU4 base. These LEDs offer direct 120° illumination with no wasted light. Energy efficient 0.7 watt power consumption. 12VDC. For interior installations only.

⚠ WARNING: Cancer and Reproductive Harm - www.P65Warnings.ca.gov

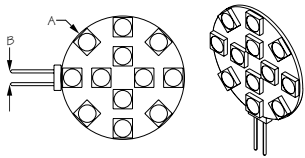

WARM WHITE LED HORIZONTAL G4 BASE BULB

Nickel Plated Brass/Plastic



Bulk	Display	A	B	Base	Lumens	Watts/Volts	Light Color	LEDs	Wt.(lb.)	Std. Pack
n/a	442942-1	1-1/4"	4 MM	G4	200	2.4/12	Warm White	12	.01	5 ea

These Warm White LED Horizontal G4 Base Bulbs feature 12 high quality LEDs that produce 200 lumens. Bi-pin base is mounted on the side of the disc for easy plug and play installation. These LEDs offer direct 120° illumination with no wasted light. The equivalent of a 20W halogen bulb with an energy efficient 2.4W power consumption. Rated for 50,000 service life hours. Constructed of nickel plated brass and plastic. For use with 12VDC systems only.

⚠ **WARNING:** Cancer and Reproductive Harm - www.P65Warnings.ca.gov

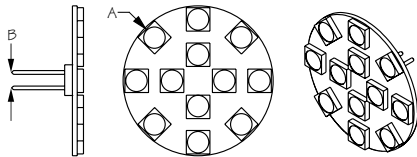

WARM WHITE LED VERTICAL G4 BASE BULB

Nickel Plated Brass/Plastic

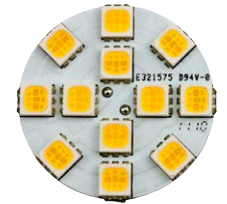

Bulk	Display	A	B	Base	Lumens	Watts/Volts	Light Color	LEDs	Wt.(lb.)	Std. Pack
n/a	442947-1	1-1/4"	4 MM	G4	200	2.4/12	Warm White	12	.01	5 ea



These Warm White LED Vertical G4 Base Bulbs feature 12 high quality LEDs that produce 200 lumens. Bi-pin base is mounted on the back of the disc for easy plug and play installation. These LEDs offer direct 120° illumination with no wasted light. The equivalent of a 20W halogen bulb with an energy efficient 2.4W power consumption. Rated for 50,000 service life hours. Constructed of nickel plated brass and plastic. For use with 12VDC systems only.

⚠ **WARNING:** Cancer and Reproductive Harm - www.P65Warnings.ca.gov

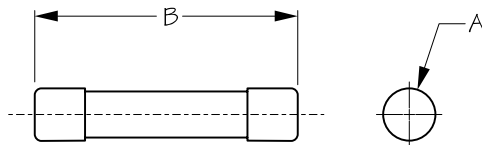

AGC GLASS TUBE FUSE

Nickel Plated Brass/Glass



Bulk	Display	Type	Amps	A	B	Fuses Per Set	Wt.(lb.)	Std. Pack
n/a	444101-1	AGC	1	1/4"	1-1/4"	5	.01	10 sets
n/a	444102-1	AGC	2	1/4"	1-1/4"	5	.01	10 sets
n/a	444103-1	AGC	3	1/4"	1-1/4"	5	.01	10 sets
n/a	444104-1	AGC	4	1/4"	1-1/4"	5	.01	10 sets
n/a	444105-1	AGC	5	1/4"	1-1/4"	5	.01	10 sets
n/a	444157-1	AGC	7.5	1/4"	1-1/4"	5	.01	10 sets
n/a	444110-1	AGC	10	1/4"	1-1/4"	5	.01	10 sets
n/a	444115-1	AGC	15	1/4"	1-1/4"	5	.01	10 sets
n/a	444120-1	AGC	20	1/4"	1-1/4"	5	.01	10 sets
n/a	444125-1	AGC	25	1/4"	1-1/4"	5	.01	10 sets
n/a	444130-1	AGC	30	1/4"	1-1/4"	5	.01	10 sets
n/a	444135-1	AGC	35	1/4"	1-1/4"	5	.01	10 sets
n/a	444050-1	AGC	50	1/4"	1-1/4"	5	.01	10 sets

AGC Glass Tube Fuses are sacrificial devices used to provide over-current protection of an electrical circuit. Designed to burn out when the power load exceeds the safe limit, interrupting the current thereby breaking the circuit and protecting the device. Constructed of glass with nickel plated brass contacts.

⚠ **WARNING:** Cancer and Reproductive Harm - www.P65Warnings.ca.gov

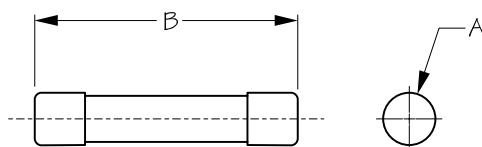

AGC STYLE MIXED FUSE KIT

Nickel Plated Brass/Glass



Bulk	Display	A	B	Wt.(lb.)	Std. Pack
n/a	444190-1	1/4"	1-1/4"	.25	10 sets

AGC Style Mixed Fuse Kit includes five each of 3A, 5A, 7.5A, 10A, 15A, and 20A fuses. Constructed of glass with nickel plated brass contacts.

⚠ **WARNING:** Cancer and Reproductive Harm - www.P65Warnings.ca.gov



ATM MINI STYLE FUSE

Tin Plated Zinc Alloy/Injection Molded Nylon

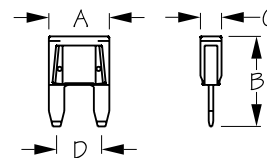

Bulk	Display	Type	Amps	A	B	C	D	Fuses Per Set	Wt.(lb.)	Std. Pack
n/a	445002-1	ATM	2	7/16"	5/8"	3/16"	5/16"	5	.01	10 Sets
n/a	445003-1	ATM	3	7/16"	5/8"	3/16"	5/16"	5	.01	10 Sets
n/a	445004-1	ATM	4	7/16"	5/8"	3/16"	5/16"	5	.01	10 Sets
n/a	445005-1	ATM	5	7/16"	5/8"	3/16"	5/16"	5	.01	10 Sets
n/a	445007-1	ATM	7.5	7/16"	5/8"	3/16"	5/16"	5	.01	10 Sets
n/a	445010-1	ATM	10	7/16"	5/8"	3/16"	5/16"	5	.01	10 Sets
n/a	445015-1	ATM	15	7/16"	5/8"	3/16"	5/16"	5	.01	10 Sets
n/a	445020-1	ATM	20	7/16"	5/8"	3/16"	5/16"	5	.01	10 Sets
n/a	445025-1	ATM	25	7/16"	5/8"	3/16"	5/16"	5	.01	10 Sets
n/a	445030-1	ATM	30	7/16"	5/8"	3/16"	5/16"	5	.01	10 Sets

ATM Mini Style Fuses are fast acting fuses to provide better protection for electronic devices. For use with Sea-Dog® ATM Mini Style Fuse Holders (445097 and 445098). Constructed of injection molded nylon with tin plated connector blades for superior conductivity and improved corrosion resistance.

⚠ WARNING: Cancer and Reproductive Harm - www.P65Warnings.ca.gov



ATM MINI BLADE STYLE MIXED FUSE KIT

Tin Plated Zinc Alloy/Injection Molded Nylon

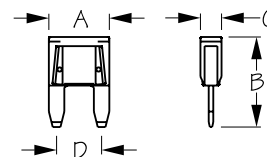

Bulk	Display	Type	A	B	C	D	Wt.(lb.)	Std. Pack
n/a	445090-1	ATM	7/16"	5/8"	3/16"	5/16"	.25	10 sets

ATM Mini Blade Style Mixed Fuse Kit includes five each of 3A, 5A, 7.5A, 10A, 15A, and 20A fuses. Constructed of injection molded nylon with tin plated connector blades for superior conductivity and improved corrosion resistance.

⚠ WARNING: Cancer and Reproductive Harm - www.P65Warnings.ca.gov

ATM MINI STYLE INLINE FUSE HOLDER

Injection Molded PVC

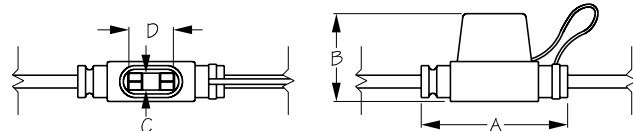

Bulk	Display	A	B	C	D	Max. Amps	Wire/Length	Wt.(lb.)	Std. Pack
n/a	445098-1	1-9/16"	15/16"	3/16"	1/2"	30	14 ga/12"	.03	5 ea

ATM Mini Style Inline Fuse Holder is designed to accept ATM mini automotive-style spade terminal fuses. For use with Sea-Dog® ATM Mini Style Fuses (445002-445030, sold separately). Maximum: 30A. 14 gauge 12" AWG wire lead. Constructed of Injection molded PVC. IP67 waterproof rating.

⚠ WARNING: Cancer and Reproductive Harm - www.P65Warnings.ca.gov

ATM MINI STYLE INLINE LED FUSE HOLDER

Injection Molded PVC

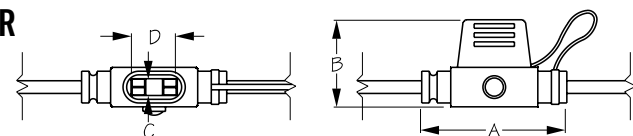

Bulk	Display	A	B	C	D	Max. Amps	Wire/Length	Wt.(lb.)	Std. Pack
n/a	445097-1	1-9/16"	15/16"	3/16"	1/2"	30	14 ga/12"	.04	5 ea

ATM Mini Style Inline LED Fuse Holder features an LED indicator which lights up when the fuse is blown. Designed to accept ATM mini automotive-style spade terminal fuses. For use with Sea-Dog® ATM Mini Style Fuses (445002-445030, sold separately). Maximum: 30A. 14 gauge 12" AWG wire lead. Constructed of Injection molded PVC. IP67 waterproof rating.

⚠ WARNING: Cancer and Reproductive Harm - www.P65Warnings.ca.gov

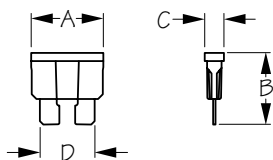
**ATO STYLE FUSE**

Tin Plated Zinc Alloy/Injection Molded Nylon



Bulk	Display	Type	Amps	A	B	C	D	Fuses Per Set	Wt.(lb.)	Std. Pack
n/a	445101-1	ATO	1	3/4"	3/4"	3/16"	9/16"	5	.01	5 sets
n/a	445101-2	ATO	1	3/4"	3/4"	3/16"	9/16"	20	.20	1 set
n/a	445102-1	ATO	2	3/4"	3/4"	3/16"	9/16"	5	.01	5 sets
n/a	445102-2	ATO	2	3/4"	3/4"	3/16"	9/16"	20	.20	1 set
n/a	445103-1	ATO	3	3/4"	3/4"	3/16"	9/16"	5	.01	5 sets
n/a	445103-2	ATO	3	3/4"	3/4"	3/16"	9/16"	20	.20	1 set
n/a	445104-1	ATO	4	3/4"	3/4"	3/16"	9/16"	5	.01	5 sets
n/a	445104-2	ATO	4	3/4"	3/4"	3/16"	9/16"	20	.20	1 set
n/a	445105-1	ATO	5	3/4"	3/4"	3/16"	9/16"	5	.01	5 sets
n/a	445105-2	ATO	5	3/4"	3/4"	3/16"	9/16"	20	.20	1 set
n/a	445107-1	ATO	7.5	3/4"	3/4"	3/16"	9/16"	5	.01	5 sets
n/a	445107-2	ATO	7.5	3/4"	3/4"	3/16"	9/16"	20	.20	1 set
n/a	445110-1	ATO	10	3/4"	3/4"	3/16"	9/16"	5	.01	5 sets
n/a	445110-2	ATO	10	3/4"	3/4"	3/16"	9/16"	20	.20	1 set
n/a	445115-1	ATO	15	3/4"	3/4"	3/16"	9/16"	5	.01	5 sets
n/a	445115-2	ATO	15	3/4"	3/4"	3/16"	9/16"	20	.20	1 set
n/a	445120-1	ATO	20	3/4"	3/4"	3/16"	9/16"	5	.01	5 sets
n/a	445120-2	ATO	20	3/4"	3/4"	3/16"	9/16"	20	.20	1 set
n/a	445125-1	ATO	25	3/4"	3/4"	3/16"	9/16"	5	.01	5 sets
n/a	445125-2	ATO	25	3/4"	3/4"	3/16"	9/16"	20	.20	1 set
n/a	445130-1	ATO	30	3/4"	3/4"	3/16"	9/16"	5	.01	5 sets
n/a	445130-2	ATO	30	3/4"	3/4"	3/16"	9/16"	20	.20	1 set
n/a	445140-1	ATO	40	3/4"	3/4"	3/16"	9/16"	5	.01	5 sets
n/a	445140-2	ATO	40	3/4"	3/4"	3/16"	9/16"	20	.20	1 set

ATO Style Fuses are fast acting ATO (open) fuses to provide better protection for electronic devices. Constructed of injection molded nylon with tin plated connector blades for superior conductivity and improved corrosion resistance.

- -1's contain 5 fuses per set
- -2's contain 20 fuses per set

⚠ **WARNING:** Cancer and Reproductive Harm - www.P65Warnings.ca.gov

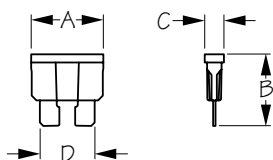
**ATC STYLE MIXED FUSE KITS**

Tin Plated Zinc Alloy/Injection Molded Nylon



Bulk	Display	Kit Quantity	A	B	C	D	Wt.(lb.)	Std. Pack
n/a	445156-1	30 Piece	3/4"	3/4"	3/16"	9/16"	.62	10 ea
n/a	445157-1	80 Piece	3/4"	3/4"	3/16"	9/16"	.92	5 ea

ATC Style Mixed Fuse Kits contain fast acting ATC (closed) fuses to provide better protection for electronic devices. 30 piece includes five 3A, five 5A, five 10A, five 15A, five 20A, and five 30A. The 80 piece includes fifteen 3A, fifteen 5A, fifteen 10A, fifteen 15A, ten 20A, and ten 30A. Constructed of injection molded nylon with tin plated connector blades for superior conductivity and improved corrosion resistance.

⚠ **WARNING:** Cancer and Reproductive Harm - www.P65Warnings.ca.gov

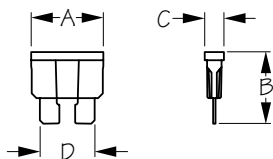
**ATO STYLE MIXED FUSE KIT**

Tin Plated Zinc Alloy/Injection Molded Nylon



Bulk	Display	Type	A	B	C	D	Wt.(lb.)	Std. Pack
n/a	445190-1	ATO	3/4"	3/4"	3/16"	9/16"	.25	10 sets

ATO Style Mixed Fuse Kit includes five each of 3A, 5A, 7.5A, 10A, 15A, and 20A fuses. Constructed of injection molded nylon with tin plated connector blades for superior conductivity and improved corrosion resistance.

⚠ **WARNING:** Cancer and Reproductive Harm - www.P65Warnings.ca.gov

LED INDICATOR FUSE BLOCK

Nickel Plated Copper/Stainless Steel/Injection Molded ABS

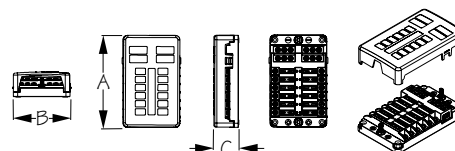

Bulk	Display	Terminals	A	B	C	Fastener	Wt.(lb.)	Std. Pack
445185	445185-1	6	3-7/16"	3-3/8"	1-7/16"	#8 FH	.33	4 ea
445188	445188-1	12	5-1/2"	3-3/8"	1-7/16"	#8 FH	.53	4 ea

These LED Indicator Fuse Blocks are used to provide over-current protection to help protect wiring in electrical circuits. Features a LED indicator which lights up when the fuse is blown. For use with Sea-Dog® ATO/ATC (445101-445130, 445190, 445156, and 445157; sold separately) and ATM Mini Style Fuses (445002-445030, 445090; sold separately). Main line terminal rating is 100A 32VDC max, with M5 metric threaded studs. Single line terminal rating is 30A 32VDC max, with M4 metric threaded studs. Includes semi-transparent cover and 71 labels. Constructed of injection molded ABS with nickel plated copper terminals and stainless steel screws. Installs with four #8 FH fasteners (not included).

⚠ **WARNING:** Cancer and Reproductive Harm - www.P65Warnings.ca.gov

ATO/ATC STYLE FUSE BLOCK W/ GROUND BLOCK

Tin Plated Copper/Injection Molded ABS

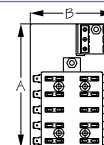

Bulk	Display	Terminals	A	B	Fastener	Wt.(lb.)	Std. Pack
445191	445191-1	6	3-3/8"	3-3/4"	#10 RH	.20	5 ea
445193	445193-1	10	3-3/8"	5-1/16"	#10 RH	.40	5 ea

ATO/ATC Style Fuse Block with Ground Block are used to provide over-current protection to help protect wiring in electrical circuits. For use with Sea-Dog® ATO or ATC Style Fuses (445101-445130, 445190, 445156, and 445157; sold separately). Maximum: 30A per circuit @ 12VDC. Constructed of injection molded ABS with tin plated copper contact and ground tabs. Installs with four #10 RH fasteners (not included).

INLINE ATO/ATC STYLE FUSE HOLDER

Injection Molded PVC

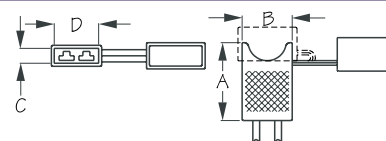

Bulk	Display	A	B	C	D	Max. Amps	Wire/Length	Wt.(lb.)	Std. Pack
420509	420509-1	1-3/16"	1"	3/16"	3/4"	20	14 ga/3-1/2" Side	.02	10 ea

The Inline ATO/ATC Style Fuse Holder is designed to accept ATO/ATC automotive-style spade terminal fuses. For use with Sea-Dog® ATO or ATC Style Fuses (445101-445120, 445190, 445156, and 445157; sold separately). Maximum 20A. 14 gauge 3-1/2" AWG wire lead. Constructed of injection molded PVC.

⚠ **WARNING:** Cancer and Reproductive Harm - www.P65Warnings.ca.gov

INLINE FUSE HOLDER - ATO/ATC

Injection Molded Fiberglass Reinforced Nylon

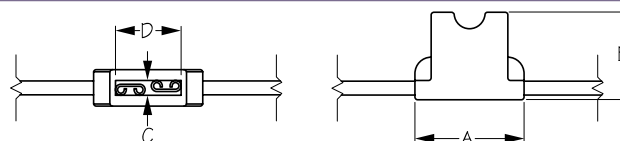

Bulk	Display	A	B	C	D	Max. Amps	Wire/Length	Wt.(lb.)	Std. Pack
445199	445199-1	1-1/4"	1"	3/16"	3/4"	30 A	14 ga/4" Side	.04	10 ea

ATO/ATC Inline Fuse Holder is designed to accept ATO/ATC automotive-style spade terminal fuses. For use with Sea-Dog® ATO or ATC Style Fuses (445101-445130, 445190, 445156, and 445157; sold separately). Maximum: 30A. 14 gauge 4" AWG wire lead. Constructed of injection molded, fiberglass reinforced nylon.

⚠ **WARNING:** Cancer and Reproductive Harm - www.P65Warnings.ca.gov

ATO/ATC STYLE INLINE FUSE HOLDER

Injection Molded PVC

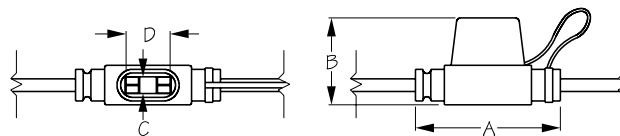

Bulk	Display	A	B	C	D	Max. Amps	Wire/Length	Wt.(lb.)	Std. Pack
n/a	445198-1	1-1/4"	1"	3/16"	3/4"	30	14 ga/12"	.05	5 ea

ATO/ATC Style Inline Fuse Holder is designed to accept ATO/ATC automotive-style spade terminal fuses. For use with Sea-Dog® ATO or ATC Style Fuses (445101-445130, 445190, 445156, and 445157; sold separately). 14 gauge 12" AWG wire lead. Maximum: 30A. IP67 waterproof rating.

⚠ **WARNING:** Cancer and Reproductive Harm - www.P65Warnings.ca.gov

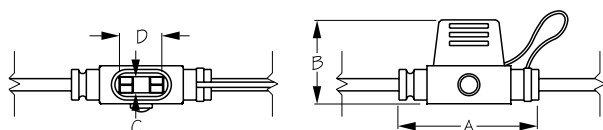

ATO/ATC STYLE INLINE LED FUSE HOLDER

Injection Molded PVC



Bulk	Display	A	B	C	D	Max. Amps	Wire/Length	Wt.(lb.)	Std. Pack
n/a	445197-1	1-1/4"	1"	3/16"	3/4"	30	14 ga/12"	.05	5 ea

ATO/ATC Style Inline LED Fuse Holder features an LED indicator which lights up when the fuse is blown. Designed to accept ATO/ATC automotive-style spade terminal fuses. For use with Sea-Dog® ATO or ATC Style Fuses (445101-445130, 445190, 445156, and 445157; sold separately). 14 gauge 12" AWG wire lead. Maximum: 30A. IP67 waterproof rating.

⚠ **WARNING:** Cancer and Reproductive Harm - www.P65Warnings.ca.gov

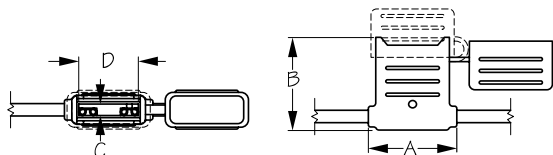

INLINE FUSE HOLDER - MAXI

Injection Molded PVC



Bulk	Display	A	B	C	D	Max. Amps	Wire/Length	Wt.(lb.)	Std. Pack
445299	445299-1	1-7/8"	1-15/16"	1/4"	1-1/4"	60	8 ga/5" Side	.16	5 ea

Maxi Inline Fuse Holder is designed to accept Maxi style fuses (not included). Constructed of injection molded PVC. Maximum: 60A.

⚠ **WARNING:** Cancer and Reproductive Harm - www.P65Warnings.ca.gov

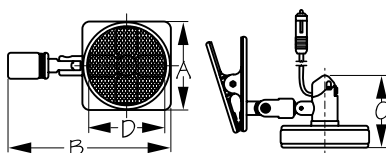

CLAMP-ON MOUNT FAN

ABS Housing



Bulk	Display	A	B	C	D	Amps	Volts	Watts	Wt.(lb.)	Std. Pack
n/a	450110-1	5-5/16"	10"	4-1/4"	4-5/8"	0.28/0.38	12	3.4/4.5	.81	1 ea

The Clamp-On Mount Fan can be mounted almost anywhere. 6' cord plugs into a 12VDC power socket. Features an integral high/low speed switch. Constructed of impact resistant ABS plastic. Amps: high 0.38A, low 0.28A. Watts: high 4.5W, low 3.4W.

⚠ **WARNING:** Cancer and Reproductive Harm - www.P65Warnings.ca.gov

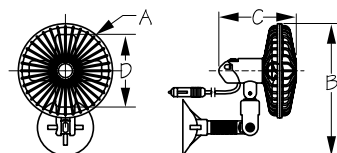

SUCTION CUP MOUNT FAN

ABS Housing



Bulk	Display	A	B	C	D	Amps	Volts	Watts	Wt.(lb.)	Std. Pack
n/a	450120-1	5-7/8"	8-1/4"	4-3/4"	4-1/2"	0.28/0.38	12	3.4/4.5	.56	1 ea

The Suction Cup Mount Fan can be mounted almost anywhere. 6' cord plugs into a 12VDC power socket. Features an integral high/low speed switch. Constructed of impact resistant ABS plastic. Amps: high 0.38A, low 0.28A. Watts: high 4.5W, low 3.4W.

⚠ **WARNING:** Cancer and Reproductive Harm - www.P65Warnings.ca.gov

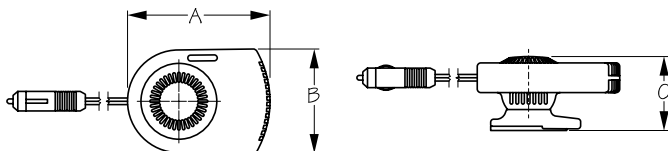

CERAMIC HEATER

ABS Housing



Bulk	Display	A	B	C	Amps	Volts	Watts	BTU	Wt.(lb.)	Std. Pack
n/a	450150-1	5-15/16"	4-5/16"	3-1/16"	12.5	12	150	550	.94	1 ea

Ceramic Heater works great for keeping small windows clear of condensation. Not intended for cabin heating in large areas. 5-1/2' cord plugs into a 12VDC power socket. Base pivots and rotates and can be attached with Velcro strip (included).

⚠ **WARNING:** Cancer and Reproductive Harm - www.P65Warnings.ca.gov

DUAL USB POWER OUTLETS



Dual USB
Power Outlet w/
Hidden Voltmeter



Dual USB
with Voltmeter
Rocker Style



Double USB & Power
Socket w/ Breaker Switch



Double USB
Power Plug
w/ Volt Meter



Dual USB
Power Outlet



Dual USB
Power Outlet
Rocker Style

TAKE CHARGE ⚡

**2.4A OUTPUT PER OUTLET
4.8A TOTAL**

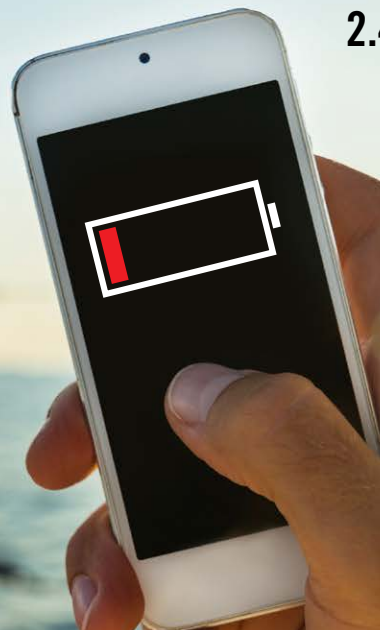

SEA-DOG.COM

SEA DOG[®] LINE
QUALITY MARINE GEAR

MAKES BOATING EASIER



Universal Blade Style Fuse Blocks

- Red LED lights indicate when fuse is blown or missing



Motion Sensor Switch

- 15' range, 120° angle
- Activation time can be set at 10, 20, 50, or 70 seconds



LED On/Off Switch

- Push button
- LED ring lights up blue when ON

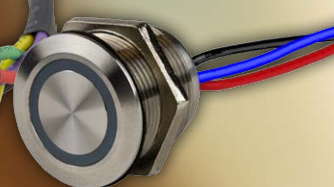

LED Continuous Dimmer Switch

- LED ring changes color as the light intensity is adjusted