

7



Vents &
Ventilators

Collector Boxes

Pitot Tube Shields

Deck Plates

Deck Plate Keys

Hose Adapters

Drains

Deck Fills

Deck Fill Keys

Gas Tank Vents

Ski Tows

Vents & Fuel Fittings

2011

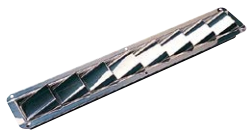

LOUVERED VENT

Stamped 316 Stainless Steel

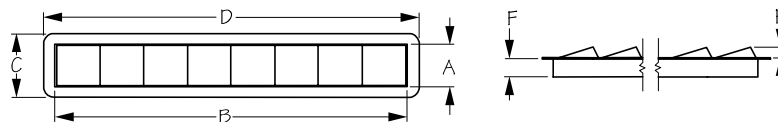

| Bulk | Display | A (Cutout Size) | B | C (Overall Size) | D | E | F | Fastener | Wt.(lb.) | Std. Pack |
|--------|---------|-----------------|---------|------------------|---------|------|------|----------|----------|-----------|
| 331200 | n/a | 1-7/8" | 15-1/4" | 2-7/8" | 16-3/8" | 5/8" | 7/8" | #6 RH | .95 | 1 ea |

This Louvered Vent is designed to be used in conjunction with a collector box to facilitate air intake and exhaust. Constructed of corrosion resistant 316 stainless steel. Installs with six #6 RH fasteners (not included). Vent area 9.74 in².



RECESSED LOUVERED VENT

Stamped 316 Stainless Steel

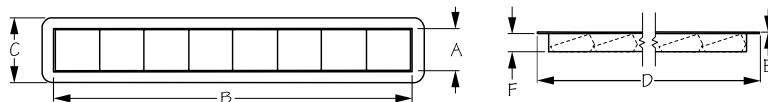

| Bulk | Display | A (Cutout Size) | B | C (Overall Size) | D | E | F | Fastener | Wt.(lb.) | Std. Pack |
|--------|---------|-----------------|---------|------------------|---------|-------|------|----------|----------|-----------|
| 331201 | n/a | 1-7/8" | 15-1/4" | 2-7/8" | 16-3/8" | 1/32" | 7/8" | #6 RH | .67 | 1 ea |

This Recessed Louvered Vent is designed to be used in conjunction with a collector box to facilitate air intake and exhaust. Recessed louvers create a flush surface area, reducing possible damage to the vent as well as preventing chafing to mooring lines, fishing lines, etc. Constructed of corrosion resistant stamped 316 stainless steel. Installs with six #6 RH fasteners (not included). Vent area 7.6 in².



COLLECTOR BOX

Injection Molded Polypropylene

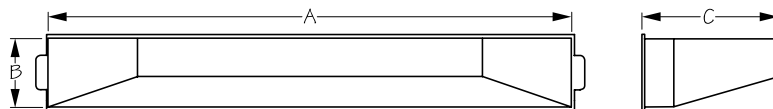

| Bulk | Display | A | B | C | Hose Size | Vent Area | Wt.(lb.) | Std. Pack |
|--------|---------|---------|----|----|-----------|-----------------------|----------|-----------|
| 331202 | n/a | 15-1/2" | 2" | 4" | None | None | .20 | 5 ea |
| 331203 | n/a | 15-1/2" | 2" | 4" | 3" (2) | 12.80 in ² | .18 | 5 ea |
| 331204 | n/a | 15-1/2" | 2" | 4" | 4" (1) | 9.10 in ² | .18 | 5 ea |

These Collector Boxes are designed to be used in conjunction with a louvered vent to facilitate air intake and exhaust. For use with either the stainless Louvered Vents (331200 or 331201) or injection molded ABS Louvered Vents (337210 or 337211). Constructed of injection molded polypropylene. Interchangeable with Attwood® part numbers 1341 and 1342. 331202 is available without holes to allow for custom installations.

⚠ WARNING: Cancer and Reproductive Harm - www.P65Warnings.ca.gov



LOUVERED VENT

Stamped 316 Stainless Steel

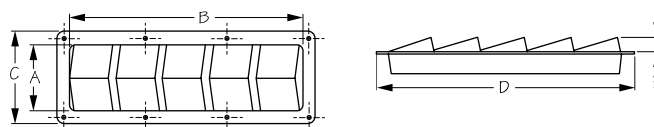

| Bulk | Display | Louvers | A (Cutout Size) | B | C (Overall Size) | D | E | Vent Area | Wt.(lb.) | Std. Pack |
|--------|----------|---------|-----------------|---------|------------------|---------|--------|-----------------------|----------|-----------|
| 331280 | n/a | 10 | 3-5/8" | 19-7/8" | 4-1/2" | 20-7/8" | 13/16" | 24.21 in ² | 1.52 | 1 ea |
| n/a | 331290-3 | 5 | 3-5/8" | 12" | 4-1/2" | 12-7/8" | 13/16" | 11.65 in ² | 1.03 | 1 ea |
| 331300 | n/a | 3 | 3-5/8" | 7-1/8" | 4-1/2" | 8-1/8" | 13/16" | 6.63 in ² | .66 | 1 ea |

These Louvered Vents are designed to be used in conjunction with a collector box to facilitate air intake and exhaust. 331290-3 and 331300 can be used in conjunction with ABS Collector Boxes (331293-331298). 331280 does not have a collector box available. Constructed of corrosion resistant stamped 316 stainless steel.

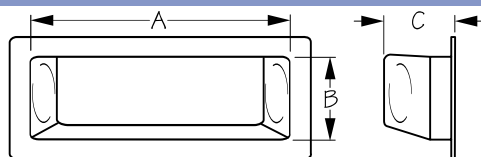
**COLLECTOR BOX**

Vacuum Formed ABS



| Bulk | Display | Hose Size | A | B | C | Mounting | Vent Area | Wt.(lb.) | Std. Pack |
|---------------|---------|-----------|---------|--------|----|----------|----------------------|----------|-----------|
| 331293 | n/a | 3" | 12-1/4" | 3-5/8" | 5" | Right | 5.29 in ² | .25 | 5 ea |
| 331294 | n/a | 4" | 12-1/4" | 3-5/8" | 5" | Right | 9.68 in ² | .26 | 5 ea |
| 331296 | n/a | 3" | 12-1/4" | 3-5/8" | 5" | Left | 5.29 in ² | .23 | 5 ea |
| 331298 | n/a | 4" | 12-1/4" | 3-5/8" | 5" | Left | 9.68 in ² | .22 | 5 ea |

These Collector Boxes are designed to be used in conjunction with a louvered vent to facilitate air intake and exhaust. The collector boxes are available with either a 3" or 4" hose attachment and left hand or right hand mounting options. For use with either stainless Louvered Vent (331290) or injection molded ABS Louvered Vent (337290). Constructed of impact resistant vacuum formed ABS. 3" hose vent area 5.29 in². 4" hose vent area 9.68 in².

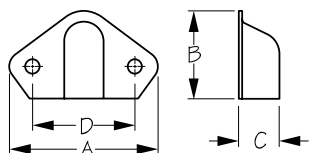
**PITOT TUBE SHIELD**

Stamped 304 Stainless Steel



| Bulk | Display | A | B | C | D | Wt.(lb.) | Std. Pack |
|---------------|-----------------|--------|------|------|------|----------|-----------|
| 331310 | 331310-1 | 1-1/4" | 3/4" | 3/8" | 7/8" | .01 | 10 ea |

Designed to be vertically mounted, the Pitot Tube Shield protects electrical wiring when passing through transom holes. Ideal for use with depth sounders, speedometers, and coaxial cables. Constructed of corrosion resistant stamped 304 stainless steel for durability.

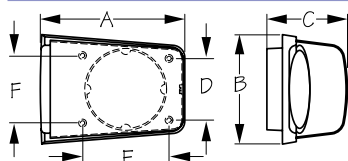
**COWL VENT WITH BASE**

Stamped 304 Stainless Steel/Plastic



| Bulk | Display | A | B | C | D | E | F | Fastener | Wt.(lb.) | Std. Pack |
|---------------|-----------------|---------|----------|---------|--------|---------|--------|----------|----------|-----------|
| 331320 | 331320-1 | 5-7/8" | 4-7/16" | 3-5/16" | 2-1/2" | 3-9/16" | 2-3/4" | #8 FH | .52 | 1 ea |
| 331325 | 331325-1 | 7-5/16" | 5-13/16" | 4" | 3-1/2" | 4-7/8" | 3-1/2" | #10 FH | .88 | 1 ea |

Cowl Vents provide fresh air below decks by trapping air that comes across the top deck and forcing it into your boat's cabin interior. Designed for use with a 3" or 4" ventilation hose. Constructed of corrosion resistant stamped 304 stainless steel with a black plastic base. Installs with four FH fasteners (not included).

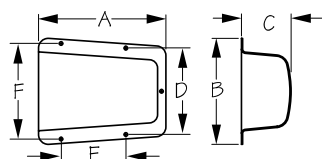
**COWL VENT**

Stamped 304 Stainless Steel



| Bulk | Display | A | B | C | D | E | F | Fastener | Wt.(lb.) | Std. Pack |
|---------------|-----------------|--------|----------|---------|----------|--------|---------|----------|----------|-----------|
| 331330 | 331330-1 | 5-3/4" | 4-13/16" | 2-5/16" | 3-15/16" | 3-1/8" | 4-5/16" | #8 RH | .45 | 1 ea |

Cowl Vents provide fresh air below decks by trapping air that comes across the top deck and forcing it into your boat's cabin interior. Constructed of corrosion resistant stamped 304 stainless steel. Installs with four #8 FH fasteners (not included).

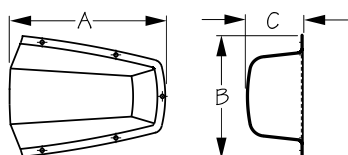
**CLAM SHELL VENT - MINI**

Stamped 304 Stainless Steel



| Bulk | Display | A | B | C | Vent Area | Fastener | Wt.(lb.) | Std. Pack |
|---------------|-----------------|----|--------|----|----------------------|----------|----------|-----------|
| 331335 | 331335-1 | 5" | 4-1/2" | 2" | 4.51 in ² | #6 RH | .40 | 1 ea |

This Mini Clam Shell Vent provides splash protection for vent holes, wire and cable runs, or blower-exhaust hose openings. Can be used for cabin ventilation with the addition of a dorade box. Ideal for applications where a taller vent would foul lines or restrict crew movement. Constructed of corrosion resistant 304 stamped stainless steel. Installs with five #6 RH fasteners (not included).



CLAM SHELL VENT

Stamped 304 Stainless Steel

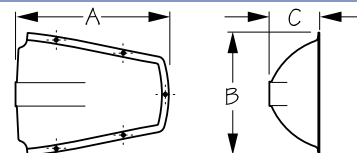

| Bulk | Display | A | B | C | Vent Area | Fastener | Wt.(lb.) | Std. Pack |
|--------|----------|--------|--------|--------|-----------------------|----------|----------|--------------|
| 331340 | 331340-1 | 7" | 5-3/4" | 2-1/4" | 7.51 in ² | #6 RH | .58 | 1 ea / 10 ea |
| 331350 | 331350-1 | 7-1/2" | 6-3/4" | 2-7/8" | 12.02 in ² | #6 RH | .79 | 1 ea / 10 ea |

Large Clam Shell Vent provides splash protection for vent holes, wire and cable runs, or blower-exhaust hose openings. Can be used for cabin ventilation with the addition of a dorade box. Ideal for applications where a taller vent would foul lines or restrict movement. Constructed of corrosion resistant 304 stamped stainless steel. Installs with five #6 RH fasteners (not included).



MIDGET VENT

Stamped 304 Stainless Steel

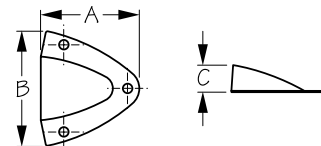

| Bulk | Display | A | B | C | Vent Area | Fastener | Wt.(lb.) | Std. Pack |
|--------|----------|--------|--------|------|---------------------|----------|----------|-----------|
| 331360 | 331360-1 | 1-5/8" | 1-3/4" | 1/2" | .29 in ² | #6 RH | .01 | 10 ea |
| 331370 | 331370-1 | 2-1/4" | 2-1/8" | 5/8" | .52 in ² | #6 RH | .03 | 10 ea |

These Midget Vents provide a splash proof opening through transoms, cabin sides, etc. Great for routing cables and wires or for covering thru-hull openings to shield water spray. Ideal for small lockers, they provide attractive cover for ventilation holes while also preventing odors. Constructed of corrosion resistant stamped 304 stainless steel. Installs with three #6 RH fasteners (not included).



MIDGET VENT - HEAVY DUTY

Stamped 304 Stainless Steel

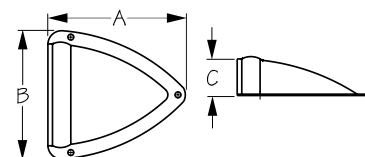

| Bulk | Display | A | B | C | Vent Area | Fastener | Wt.(lb.) | Std. Pack |
|--------|----------|--------|--------|--------|----------------------|----------|----------|-----------|
| 331375 | 331375-1 | 3-3/4" | 3-1/2" | 15/16" | 1.25 in ² | #6 RH | .12 | 10 ea |

This Heavy Duty Midget Vent features a reinforced rim, making them durable enough to stand on. Great for routing cables or wires through a hole or for covering thru-hull openings to shield water spray. Ideal for small lockers, they provide attractive cover for ventilation holes while also preventing odors. Constructed of corrosion resistant stamped 304 stainless steel. Installs with three #6 RH fasteners (not included).



LOUVERED VENT

Stamped 304 Stainless Steel

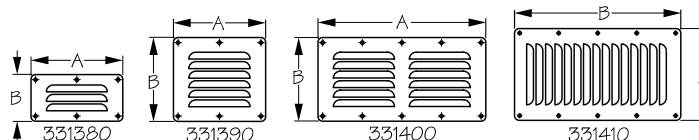

| Bulk | Display | A | B | Vent Area | Fastener | Wt.(lb.) | Std. Pack |
|--------|----------|--------|--------|----------------------|----------|----------|-----------|
| 331380 | 331380-1 | 5" | 2-5/8" | .81 in ² | #6 RH | .11 | 10 ea |
| 331390 | 331390-1 | 5" | 4-5/8" | 1.62 in ² | #6 RH | .18 | 10 ea |
| 331400 | 331400-1 | 9-1/8" | 4-5/8" | 3.24 in ² | #6 RH | .35 | 10 ea |
| 331410 | 331410-1 | 5" | 9" | 4.05 in ² | #6 RH | .40 | 10 ea |

These Louvered Vents are designed to promote air circulation and prevent mold, mildew, and unpleasant odors. Ideal for cabin doors, lockers, dock boxes, etc. Constructed of corrosion resistant stamped 304 stainless steel. Installs with #6 RH fasteners (not included).



LOUVERED VENT - OVAL

Stamped 304 Stainless Steel

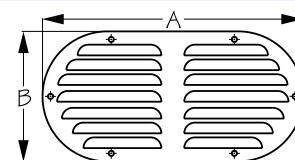

| Bulk | Display | A | B | Vent Area | Fastener | Wt.(lb.) | Std. Pack |
|--------|----------|--------|--------|----------------------|----------|----------|-----------|
| 331405 | 331405-1 | 9-1/8" | 4-5/8" | 2.94 in ² | #6 RH | .32 | 10 ea |

This Oval Louvered Vent is designed to promote air circulation and prevent mold, mildew, and unpleasant odors. Ideal for cabin doors, lockers, dock boxes, etc. Constructed of corrosion resistant stamped 304 stainless steel. Installs with six #6 RH fasteners (not included). Vent area 2.94 in².

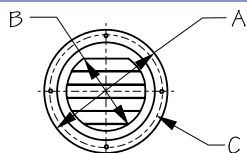
**ROUND LOUVERED VENT**

Stamped 304 Stainless Steel



| Bulk | Display | A | B (Hole Size) | C | Vent Area | Fastener | Wt.(lb.) | Std. Pack |
|--------|----------|----|---------------|--------|----------------------|----------|----------|-----------|
| 331424 | 331424-1 | 4" | 2-1/2" | 3-5/8" | .88 in ² | #6 FH | .07 | 10 ea |
| 331425 | 331425-1 | 5" | 3-1/2" | 4-1/2" | 2.02 in ² | #6 FH | .13 | 10 ea |

These Round Louvered Vents allow air in while keeping water out. Constructed of corrosion resistant stamped 304 stainless steel. Installs with four #6 FH fasteners (not included). 4" vent area 0.88 in². 5" vent area 2.02 in².

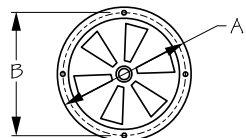
**BUTTERFLY VENT - CENTER KNOB**

Stamped 304 Stainless Steel



| Bulk | Display | A | B | Vent Area | Fastener | Wt.(lb.) | Std. Pack |
|--------|----------|----|--------|----------------------|----------|----------|-----------|
| 331440 | 331440-1 | 4" | 3-5/8" | 2.77 in ² | #6 RH | .16 | 10 ea |
| 331450 | 331450-1 | 5" | 4-3/4" | 2.91 in ² | #6 RH | .29 | 10 ea |

These Butterfly Vents feature a Center Knob that allows for easy adjustment of the opening. Promotes air circulation and prevents mold, mildew, and associated odors. Constructed of corrosion resistant stamped 304 stainless steel. Installs with four #6 RH fasteners (not included).

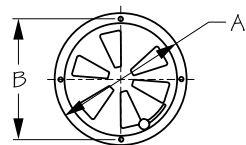
**BUTTERFLY VENT - SIDE KNOB**

Stamped 304 Stainless Steel



| Bulk | Display | A | B | Vent Area | Fastener | Wt.(lb.) | Std. Pack |
|--------|---------|----|--------|----------------------|----------|----------|-----------|
| 331455 | n/a | 5" | 4-3/4" | 2.89 in ² | #6 RH | .29 | 10 ea |

These Butterfly Vents features a Side Knob that allows for easy adjustment of the opening. Promotes air circulation and prevents mold, mildew, and associated odors. Constructed of corrosion resistant 304 stainless steel. Installs with four #6 RH fasteners (not included).

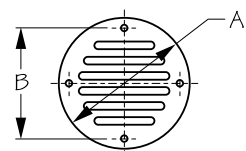
**DRAIN COVER**

Stamped 304 Stainless Steel



| Bulk | Display | A | B | Vent Area | Fastener | Wt.(lb.) | Std. Pack |
|--------|----------|--------|--------|----------------------|----------|----------|-----------|
| 331600 | 331600-1 | 3-1/4" | 2-3/4" | 2.11 in ² | #6 RH | .06 | 10 ea |
| 331601 | 331601-1 | 2-1/2" | 2-1/8" | .85 in ² | #6 RH | .04 | 10 ea |

These Drain Covers are constructed of stamped 304 stainless steel. Installs with four #6 RH fasteners (not included).

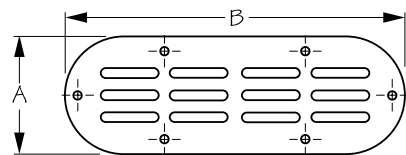
**LOCKER VENT**

Stamped 304 Stainless Steel



| Bulk | Display | A | B | Vent Area | Fastener | Wt.(lb.) | Std. Pack |
|--------|----------|--------|--------|----------------------|----------|----------|-----------|
| 331620 | 331620-1 | 2-3/8" | 6-3/4" | 2.56 in ² | #8 RH | .10 | 10 ea |

Locker Vent is designed to promote air circulation in interior areas and prevent mold, mildew, and odors. Constructed of corrosion resistant stamped 304 stainless steel. Installs with six #8 RH fasteners (not included). Vent area 2.56 in².



DECK PLATE

Investment Cast 316 Stainless Steel

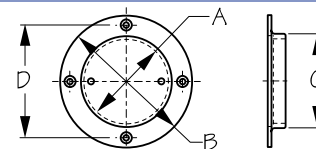

| Bulk | Display | A | B | C | D | Fastener | Wt.(lb.) | Std. Pack |
|--------|----------|---------|----------|--------|----------|----------|----------|-----------|
| 335653 | 335653-1 | 3-1/4" | 4-11/16" | 3-1/2" | 4" | #12 FH | 1.05 | 1 ea |
| 335654 | 335654-1 | 4-3/16" | 5-9/16" | 4-1/2" | 4-13/16" | #12 FH | 1.50 | 1 ea |

These Deck Plates can be opened with Deck Plate Keys (335680 or 335699, not included). Use anti-seize lubricant to protect threads from galling. Constructed of corrosion resistant investment cast 316 stainless steel. Installs with four #12 FH fasteners (not included).



ADJUSTABLE DECK PLATE KEY

Sand Cast Bronze

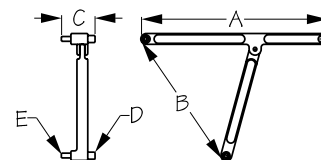

| Bulk | Display | A | B | C | D | E | Wt.(lb.) | Std. Pack |
|--------|----------|--------|----|--------|-------|-------|----------|-----------|
| 335680 | 335680-1 | 7-3/4" | 6" | 1-3/8" | 5/16" | 3/16" | .68 | 5 ea |

The Adjustable Deck Plate Key opens to a maximum of 6" and comes with two sizes of stainless steel pins (3/16" and 5/16") to accommodate most plates or caps. Features a drilled hole in the handle to attach an optional lanyard. Constructed of sand cast bronze.

- Heavy duty construction
- Great addition to every tool box
- Corrosion resistant

⚠ WARNING: Cancer and Reproductive Harm - www.P65Warnings.ca.gov



DECK PLATE KEY

Formed 304 Stainless Steel

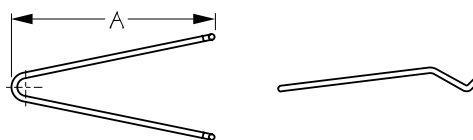

| Bulk | Display | A | Wt.(lb.) | Std. Pack |
|--------|----------|----|----------|-----------|
| 335699 | 335699-1 | 7" | .14 | 10 ea |

This Deck Plate Key is adjustable and fits all Sea-Dog® two-prong Deck Fills and Deck Plate Caps, as well as most competitor's caps. For use with Deck Fills (351320-351331 and 351350-351353). Constructed of corrosion resistant formed 304 stainless steel.



SCREW-OUT DECK PLATE

Injection Molded Polypropylene

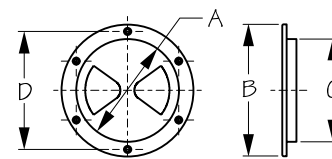

| Bulk | Display | A | B | C | D | Color | Fastener | Wt.(lb.) | Std. Pack |
|--------|----------|---------|--------|--------|--------|-------|----------|----------|--------------|
| 335740 | 335740-1 | 4-7/16" | 5-3/4" | 4-1/2" | 5-1/8" | White | #8 FH | .19 | 10 ea / 5 ea |
| n/a | 335745-1 | 4-7/16" | 5-3/4" | 4-1/2" | 5-1/8" | Black | #8 FH | .19 | 5 ea |
| n/a | 335750-1 | 5-7/16" | 6-3/4" | 5-1/2" | 6-1/8" | White | #8 FH | .25 | 5 ea |
| n/a | 335755-1 | 5-7/16" | 6-3/4" | 5-1/2" | 6-1/8" | Black | #8 FH | .25 | 5 ea |
| 335760 | 335760-1 | 6-1/2" | 8-1/8" | 6-1/2" | 7-1/4" | White | #8 FH | .44 | 10 ea / 5 ea |
| n/a | 335765-1 | 6-1/2" | 8-1/8" | 6-1/2" | 7-1/4" | Black | #8 FH | .44 | 5 ea |

These Screw-Out Deck Plates are molded to the highest standards. Keep threads clean with hot, soapy water. Lubricate with Vaseline or Teflon grease. Constructed of UV resistant and antioxidant injection molded polypropylene. Installs with six #8 FH fasteners (not included). When installing, use silicone sealant on hull or deck surface. Available in black or white.

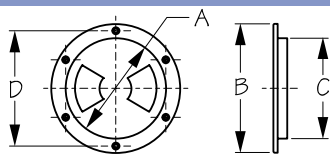
**QUARTER-TURN DECK PLATE**

Injection Molded ABS/Polycarbonate



| Bulk | Display | A | B | C | D | Color | Lid Texture | Fastener | Wt.(lb.) | Std. Pack |
|---------|----------|--------------------------|--------|--------|----------|-------|-------------|----------|----------|--------------|
| 336140 | 336140-1 | 4-1/2" | 6-1/8" | 4-1/2" | 5-3/8" | White | Smooth | #8 FH | .28 | 10 ea |
| 336140G | n/a | 4-1/2" | 6-1/8" | 4-1/2" | 5-3/8" | Gray | Smooth | #8 FH | .28 | 10 ea |
| 336145 | 336145-1 | 4-1/2" | 6-1/8" | 4-1/2" | 5-3/8" | Black | Smooth | #8 FH | .28 | 10 ea |
| 336150 | 336150-1 | 5-1/2" | 6-3/4" | 5-3/8" | 6-1/8" | White | Smooth | #8 FH | .32 | 10 ea |
| 336152 | 336152-1 | 5-1/2" | 6-3/4" | 5-3/8" | 6-1/8" | White | Textured | #8 FH | .32 | 10 ea |
| 336155 | 336155-1 | 5-1/2" | 6-3/4" | 5-3/8" | 6-1/8" | Black | Smooth | #8 FH | .32 | 10 ea |
| 336157 | 336157-1 | 5-1/2" | 6-3/4" | 5-3/8" | 6-1/8" | Black | Textured | #8 FH | .32 | 10 ea |
| 336160 | 336160-1 | 6-1/2" | 8-1/8" | 6-1/2" | 7-3/8" | White | Smooth | #8 FH | .41 | 10 ea |
| 336162 | 336162-1 | 6-1/2" | 8-1/8" | 6-1/2" | 7-3/8" | White | Textured | #8 FH | .42 | 10 ea |
| 336165 | 336165-1 | 6-1/2" | 8-1/8" | 6-1/2" | 7-3/8" | Black | Smooth | #8 FH | .41 | 10 ea |
| 336167 | 336167-1 | 6-1/2" | 8-1/8" | 6-1/2" | 7-3/8" | Black | Textured | #8 FH | .42 | 10 ea |
| 336180 | 336180-1 | 8-5/16" | 9-7/8" | 8-1/4" | 8-15/16" | White | Smooth | #8 FH | .55 | 5 ea |
| 336182 | 336182-1 | 8-5/16" | 9-7/8" | 8-1/4" | 8-15/16" | White | Textured | #8 FH | .56 | 5 ea |
| 336185 | 336185-1 | 8-5/16" | 9-7/8" | 8-1/4" | 8-15/16" | Black | Smooth | #8 FH | .55 | 5 ea |
| 336187 | 336187-1 | 8-5/16" | 9-7/8" | 8-1/4" | 8-15/16" | Black | Textured | #8 FH | .56 | 5 ea |
| 337198 | 337198-1 | Deck plate lanyard - 12" | | | | | | | .01 | 10 ea / 5 ea |
| 337199 | n/a | Lid retaining strap - 8" | | | | | | | .01 | 10 ea |

These Quarter-Turn Deck Plates feature a new locking system that prevents over tightening, jamming, or cross threading. Easy to open and close. A specially engineered lubricated gasket is used in conjunction with a knife edge for a leak tested seal. Avoid contact with acetone or strong solvents. Constructed of UV resistant injection molded ABS. Installs with six #8 FH fasteners (not included). Available in black or white, smooth or textured. Patent Pending.

- Special Order Requirements May Apply
- Custom Colors Available With Large Order

⚠ **WARNING:** Cancer and Reproductive Harm - www.P65Warnings.ca.gov

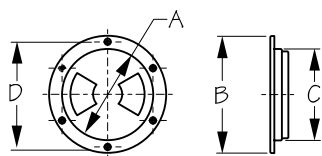
**QUARTER-TURN DECK PLATE WITH INTERNAL COLLAR**

Injection Molded ABS/Polycarbonate



| Bulk | Display | A | B | C | D | Color | Lid Texture | Fastener | Wt.(lb.) | Std. Pack |
|--------|----------|--------------------------|--------|--------|----------|-------|-------------|----------|----------|--------------|
| 336340 | 336340-1 | 4-1/2" | 6-1/8" | 4-1/2" | 5-3/8" | White | Smooth | #8 FH | .28 | 10 ea |
| 336345 | 336345-1 | 4-1/2" | 6-1/8" | 4-1/2" | 5-3/8" | Black | Smooth | #8 FH | .28 | 10 ea |
| 336350 | 336350-1 | 5-1/2" | 6-3/4" | 5-3/8" | 6-1/8" | White | Smooth | #8 FH | .32 | 10 ea |
| 336352 | 336352-1 | 5-1/2" | 6-3/4" | 5-3/8" | 6-1/8" | White | Textured | #8 FH | .32 | 10 ea |
| 336355 | 336355-1 | 5-1/2" | 6-3/4" | 5-3/8" | 6-1/8" | Black | Smooth | #8 FH | .32 | 10 ea |
| 336357 | 336357-1 | 5-1/2" | 6-3/4" | 5-3/8" | 6-1/8" | Black | Textured | #8 FH | .32 | 10 ea |
| 336360 | 336360-1 | 6-1/2" | 8-1/8" | 6-1/2" | 7-3/8" | White | Smooth | #8 FH | .41 | 10 ea |
| 336362 | 336362-1 | 6-1/2" | 8-1/8" | 6-1/2" | 7-3/8" | White | Textured | #8 FH | .42 | 10 ea |
| 336365 | 336365-1 | 6-1/2" | 8-1/8" | 6-1/2" | 7-3/8" | Black | Smooth | #8 FH | .41 | 10 ea |
| 336367 | 336367-1 | 6-1/2" | 8-1/8" | 6-1/2" | 7-3/8" | Black | Textured | #8 FH | .42 | 10 ea |
| 336380 | 336380-1 | 8-5/16" | 9-7/8" | 8-1/4" | 8-15/16" | White | Smooth | #8 FH | .55 | 10 ea |
| 336382 | 336382-1 | 8-5/16" | 9-7/8" | 8-1/4" | 8-15/16" | White | Textured | #8 FH | .56 | 10 ea |
| 336385 | 336385-1 | 8-5/16" | 9-7/8" | 8-1/4" | 8-15/16" | Black | Smooth | #8 FH | .55 | 10 ea |
| 336387 | 336387-1 | 8-5/16" | 9-7/8" | 8-1/4" | 8-15/16" | Black | Textured | #8 FH | .56 | 10 ea |
| 337198 | 337198-1 | Deck plate lanyard - 12" | | | | | | | .01 | 10 ea / 5 ea |
| 337199 | n/a | Lid Retaining strap - 8" | | | | | | | .01 | 10 ea |

These Quarter-Turn Deck Plates feature a new locking system that prevents over tightening, jamming, or cross threading. An internal, molded-in collar on the bottom holds deck plate bags or other round containers. When installing, use silicone sealant on hull or deck surface. Keep threads clean with hot, soapy water. Lubricate with Vaseline or Teflon grease. Avoid contact with acetone or strong solvents. Constructed of UV resistant injection molded ABS. Installs with six #8 FH fasteners (not included). Available in black or white, smooth or textured.



POP-OUT DECK PLATE

Injection Molded ABS/Polycarbonate

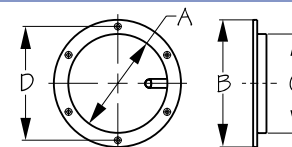

| Bulk | Display | A | B | C | D | Color | Lid Texture | Fastener | Wt.(lb.) | Std. Pack |
|---------|----------|--------|--------|--------|--------|-------|-------------|----------|----------|-----------|
| 336260 | n/a | 6-1/2" | 8-1/8" | 6-1/2" | 7-3/8" | White | Smooth | #8 FH | .58 | 10 ea |
| 336262 | 336262-1 | 6-1/2" | 8-1/8" | 6-1/2" | 7-3/8" | White | Textured | #8 FH | .58 | 10 ea |
| 336265 | n/a | 6-1/2" | 8-1/8" | 6-1/2" | 7-3/8" | Black | Smooth | #8 FH | .58 | 10 ea |
| 336267 | n/a | 6-1/2" | 8-1/8" | 6-1/2" | 7-3/8" | Black | Textured | #8 FH | .58 | 10 ea |
| 336267G | n/a | 6-1/2" | 8-1/8" | 6-1/2" | 7-3/8" | Gray | Textured | #8 FH | .58 | 10 ea |
| 336280 | n/a | 8-1/2" | 10" | 8-3/8" | 9" | White | Smooth | #8 FH | .83 | 5 ea |
| 336282 | 336282-1 | 8-1/2" | 10" | 8-3/8" | 9" | White | Textured | #8 FH | .83 | 5 ea |
| 336285 | n/a | 8-1/2" | 10" | 8-3/8" | 9" | Black | Smooth | #8 FH | .83 | 5 ea |
| 336287 | n/a | 8-1/2" | 10" | 8-3/8" | 9" | Black | Textured | #8 FH | .83 | 5 ea |
| 336287G | n/a | 8-1/2" | 10 " | 8-3/8" | 9" | Gray | Textured | #8 FH | .83 | 5 ea |

These Pop-Out Deck Plates feature an integrated, pop-up lever to make opening and closing a snap; no tools required. Rubber O-ring provides a watertight seal. Avoid contact with acetone or strong solvents. Constructed of UV resistant injection molded ABS and polycarbonate for its structural strength, as well as weather and corrosion resistance. Installs with six #8 FH fasteners (not included). Available in black or white, smooth or textured. Patent Pending.

- Custom colors available

⚠ WARNING: Cancer and Reproductive Harm - www.P65Warnings.ca.gov



TRIPLE LATCH RECTANGULAR MARINE HATCH

Injection Molded Polypropylene

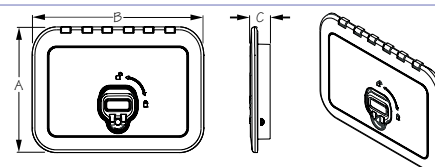

| Bulk | Display | A | B | C | Color | Fastener | Wt.(lb.) | Std. Pack |
|--------|----------|---------|-----|----------|-------|----------|----------|-----------|
| 336520 | 336520-3 | 10-1/4" | 14" | 1-11/16" | White | #10 FH | 2.00 | 1 ea |
| 336525 | 336525-3 | 10-1/4" | 14" | 1-11/16" | Black | #10 FH | 2.00 | 1 ea |

This Triple Latch Marine Deck Hatch features 3 locking points which when engaged cause the camming surface to pull the lid into the gasket creating a water tight seal. Constructed of injection molded polypropylene with a structural honeycomb lid for superior rigidity and strength. Non-slip textured surface. Can be mounted horizontally or vertically. Full length piano hinge for added strength and security. Installs with ten #10 FH fasteners (not included). Available in black or white.

⚠ WARNING: Cancer and Reproductive Harm - www.P65Warnings.ca.gov



INSPECTION COVER

Injection Molded ABS

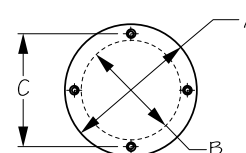

| Bulk | Display | Color | A | B | C | Fastener | Wt.(lb.) | Std. Pack |
|--------|----------|-------|--------|--------|----------|----------|----------|-----------|
| 337050 | 337050-1 | Black | 5-5/8" | 4-1/4" | 4-13/16" | #10 FH | .11 | 10 ea |
| 337051 | 337051-1 | White | 5-5/8" | 4-1/4" | 4-13/16" | #10 FH | .11 | 10 ea |
| 337052 | n/a | Gray | 5-5/8" | 4-1/4" | 4-13/16" | #10 FH | .11 | 10 ea |

These screw mounted Inspection Covers offer an economical alternative to a screw out deck plate and are ideal for use in situations where access will be infrequent. These covers are a more secure option, requiring a screwdriver for removal. Use silicone sealant when installing for easier removal later. Avoid contact with acetone or strong solvents. Constructed of UV resistant injection molded ABS. Installs with four #10 FH fasteners (not included).

⚠ WARNING: Cancer and Reproductive Harm - www.P65Warnings.ca.gov

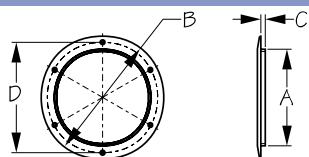
**INSPECTION COVER**

Injection Molded ABS



| Bulk | Display | Color | A (Cutout) | B (Overall) | C | D | Fastener | Wt.(lb.) | Std. Pack |
|--------|---------|-------|------------|-------------|------|---------|----------|----------|-----------|
| 337060 | n/a | Black | 6-3/8" | 8-1/2" | 1/4" | 7-5/16" | #8 FH | .46 | 10 ea |
| 337061 | n/a | White | 6-3/8" | 8-1/2" | 1/4" | 7-5/16" | #8 FH | .46 | 10 ea |

These screw mounted Inspection Covers offer an economical alternative to a screw out deck plate and are ideal for use in situations where access will be infrequent. These covers are a more secure option, requiring a screwdriver for removal. Use silicone sealant when installing for easier removal later. Avoid contact with acetone or strong solvents. Hole pattern matches our existing 6" Screw-Out Deck Plates. Constructed of UV resistant injection molded ABS. Installs with six #8 FH fasteners (not included).

⚠ WARNING: Cancer and Reproductive Harm - www.P65Warnings.ca.gov

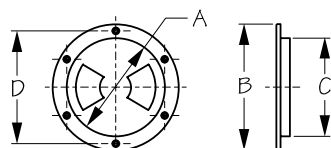
**SCREW-OUT DECK PLATE**

Injection Molded ABS



| Bulk | Display | A | B | C | D | Color | Fastener | Wt.(lb.) | Std. Pack |
|--------|----------|--------------------------|--------|--------|--------|-------|----------|----------|--------------|
| 337140 | 337140-1 | 4-7/16" | 5-3/4" | 4-1/2" | 5-1/8" | White | #8 FH | .19 | 10 ea |
| 337145 | 337145-1 | 4-7/16" | 5-3/4" | 4-1/2" | 5-1/8" | Black | #8 FH | .19 | 10 ea |
| 337150 | 337150-1 | 5-7/16" | 6-3/4" | 5-1/2" | 6-1/8" | White | #8 FH | .25 | 10 ea |
| 337155 | 337155-1 | 5-7/16" | 6-3/4" | 5-1/2" | 6-1/8" | Black | #8 FH | .25 | 10 ea |
| 337160 | 337160-1 | 6-1/2" | 8-1/8" | 6-1/2" | 7-1/4" | White | #8 FH | .44 | 10 ea |
| 337165 | 337165-1 | 6-1/2" | 8-1/8" | 6-1/2" | 7-1/4" | Black | #8 FH | .44 | 10 ea |
| 337198 | 337198-1 | Deck plate lanyard - 12" | | | | | | .01 | 10 ea / 5 ea |
| 337199 | n/a | Lid retaining strap - 8" | | | | | | .01 | 10 ea |

These Screw-Out Deck Plates are molded to the highest standards. Keep threads clean with hot soapy water. Lubricate with Vaseline or Teflon grease. Avoid contact with acetone or strong solvents. Constructed of UV resistant and antioxidant injection molded ABS. Installs with six #8 FH fasteners (not included). When installing, use silicone sealant on hull or deck surface. Available in black or white.

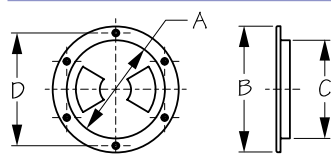
**SCREW-OUT DECK PLATE WITH CLEAR COVER**

Injection Molded ABS/Polycarbonate



| Bulk | Display | A | B | C | D | Color | Fastener | Wt.(lb.) | Std. Pack |
|--------|----------|--------------------------|--------|--------|--------|-------|----------|----------|--------------|
| 337146 | 337146-1 | 4-7/16" | 5-3/4" | 4-1/2" | 5-1/8" | Black | #8 FH | .22 | 10 ea |
| 337151 | 337151-1 | 5-7/16" | 6-3/4" | 5-1/2" | 6-1/8" | White | #8 FH | .29 | 10 ea |
| 337161 | 337161-1 | 6-1/2" | 8-1/8" | 6-1/2" | 7-1/4" | White | #8 FH | .44 | 10 ea |
| 337198 | 337198-1 | Deck plate lanyard - 12" | | | | | | .01 | 10 ea / 5 ea |
| 337199 | n/a | Lid retaining strap - 8" | | | | | | .01 | 10 ea |

These Screw-Out Deck Plates feature a clear polycarbonate lid, allowing visual inspection of the watertight compartment without removing the lid. Lubricate with Vaseline or Teflon grease. Keep threads clean with hot, soapy water. Avoid contact with acetone or strong solvent. Constructed of UV resistant injection molded ABS and polycarbonate. Installs with six #8 FH fasteners (not included). When installing, use silicone sealant on hull or deck surface. Available in black or white.



SCREW-OUT DECK PLATE WITH INTERNAL COLLAR

Injection Molded ABS

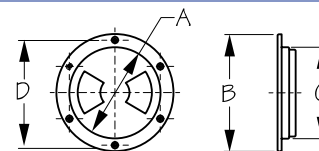

| Bulk | Display | A | B | C | D | Color | Fastener | Wt.(lb.) | Std. Pack |
|--------|----------|--------------------------|--------|--------|--------|-------|----------|----------|--------------|
| 337142 | n/a | 4-7/16" | 5-3/4" | 4-1/2" | 5-1/8" | White | #8 FH | .18 | 10 ea |
| 337147 | n/a | 4-7/16" | 5-3/4" | 4-1/2" | 5-1/8" | Black | #8 FH | .18 | 10 ea |
| 337152 | n/a | 5-7/16" | 6-3/4" | 5-1/2" | 6-1/8" | White | #8 FH | .31 | 10 ea |
| 337157 | n/a | 5-7/16" | 6-3/4" | 5-1/2" | 6-1/8" | Black | #8 FH | .31 | 10 ea |
| 337162 | n/a | 6-1/2" | 8-1/8" | 6-1/2" | 7-1/4" | White | #8 FH | .46 | 10 ea |
| 337167 | n/a | 6-1/2" | 8-1/8" | 6-1/2" | 7-1/4" | Black | #8 FH | .46 | 10 ea |
| 337198 | 337198-1 | Deck plate lanyard - 12" | | | | | | .01 | 10 ea / 5 ea |
| 337199 | n/a | Lid retaining strap - 8" | | | | | | .01 | 10 ea |

These Screw-Out Deck Plates are molded to the highest standards. An internal, molded-in collar on the bottom holds deck plate bags or other round containers. Lubricate with Vaseline or Teflon grease. Keep threads clean with hot, soapy water. Avoid contact with acetone or strong solvents. Constructed of UV resistant injection molded ABS. Installs with six #8 FH fasteners (not included). When installing, use silicone sealant on hull or deck surface. Available in black or white.



DECK PLATE LANYARD

304 Stainless Steel

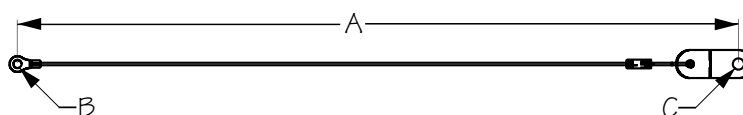

| Bulk | Display | A | B | C | Wt.(lb.) | Std. Pack |
|--------|----------|-----|-------|--------|----------|--------------|
| 337198 | 337198-1 | 12" | #6 RH | #10 RH | .01 | 10 ea / 5 ea |

This Deck Plate Lanyard is designed to retain deck plate lids. Fits all Sea-Dog® Deck Plates. Constructed of corrosion resistant 304 stainless steel. Attaches to lid with #6 RH fastener (included) and to the interior hull with a #10 RH fastener (not included).



LOUVERED VENTILATORS

Injection Molded ABS

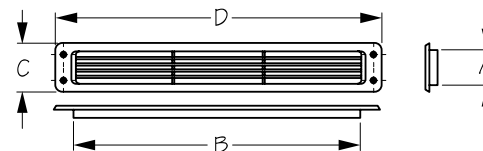

| Bulk | Display | Color | A (Cutout Size) | B | C | D | Vent Area | Fastener | Wt.(lb.) | Std. Pack |
|--------|----------|-------|-----------------|---------|--------|---------|-----------|----------|----------|-----------|
| 337210 | 337210-1 | White | 1-7/8" | 15-1/2" | 2-5/8" | 17-1/2" | 18.56 in² | #8 FH | .26 | 10 ea |
| 337211 | 337211-1 | Black | 1-7/8" | 15-1/2" | 2-5/8" | 17-1/2" | 18.56 in² | #8 FH | .26 | 10 ea |

These Louvered Ventilators are designed to be used in conjunction with a collector box to facilitate air intake and exhaust. Avoid contact with acetone or strong solvents. Constructed of impact resistant injection molded ABS. Installs with four #8 FH fasteners (not included). Available in black or white. Interchangeable with Attwood® vent #1494.



LOUVERED VENT

Injection Molded ABS

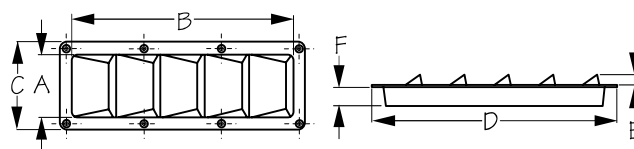

| Bulk | Display | Color | A (Cutout Size) | B | C (Overall Size) | D | E | F | Wt.(lb.) | Std. Pack |
|--------|---------|-------|-----------------|---------|------------------|---------|-------|---------|----------|-----------|
| 337290 | n/a | White | 3-5/8" | 12-1/8" | 4-3/4" | 13-1/4" | 9/16" | 1-1/16" | .35 | 1 ea |
| 337291 | n/a | Black | 3-5/8" | 12-1/8" | 4-3/4" | 13-1/4" | 9/16" | 1-1/16" | .35 | 1 ea |

These Louvered Vents are designed to be used in conjunction with a collector box to facilitate air intake and exhaust. Avoid contact with acetone or strong solvents. Constructed of impact resistant injection molded ABS. Installs with eight #8 FH fasteners (not included). Available in black or white.

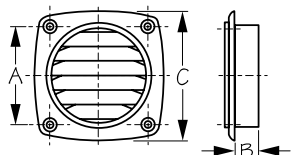
**THRU VENT**

Injection Molded Polypropylene



| Bulk | Display | Color | A | B | C (Overall) | Hose/Hole Size | Vent Area | Fastener | Wt.(lb.) | Std. Pack |
|--------|---------|-------|----------|------|-------------|----------------|----------------------|----------|----------|-----------|
| 337310 | n/a | White | 2-13/16" | 5/8" | 3-11/16" | 3" | 3.04 in ² | #8 FH | .07 | 10 ea |
| 337320 | n/a | Black | 2-13/16" | 5/8" | 3-11/16" | 3" | 3.04 in ² | #8 FH | .07 | 10 ea |

These Thru Vents are designed for cabin or bilge ventilation. For use with 3" exhaust hose. Constructed of UV resistant injection molded polypropylene. Installs with four #8 FH fasteners (not included). Available in black or white. Vent area 3.04 in².

- Available in custom colors for large volume orders

▲ **WARNING:** Cancer and Reproductive Harm - www.P65Warnings.ca.gov

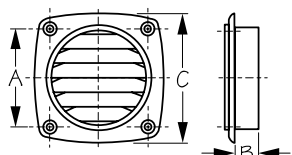
**THRU VENT**

Injection Molded ABS



| Bulk | Display | Color | A | B | C (Overall) | Hose/Hole Size | Vent Area | Fastener | Wt.(lb.) | Std. Pack |
|--------|---------|-------|----------|------|-------------|----------------|----------------------|----------|----------|-----------|
| 337311 | n/a | White | 2-13/16" | 5/8" | 3-11/16" | 3" | 3.04 in ² | #8 FH | .07 | 10 ea |
| 337321 | n/a | Black | 2-13/16" | 5/8" | 3-11/16" | 3" | 3.04 in ² | #8 FH | .07 | 10 ea |
| 337341 | n/a | Tan | 2-13/16" | 5/8" | 3-11/16" | 3" | 3.04 in ² | #8 FH | .07 | 10 ea |

These Thru Vents are designed for cabin or bilge ventilation. For use with 3" exhaust hose. Avoid contact with acetone or strong solvents. Constructed of UV and impact resistant injection molded ABS. Installs with four #8 FH fasteners (not included). Available in black, white, or tan. Vent area 3.04 in².

- Available in custom colors for large volume orders

▲ **WARNING:** Cancer and Reproductive Harm - www.P65Warnings.ca.gov

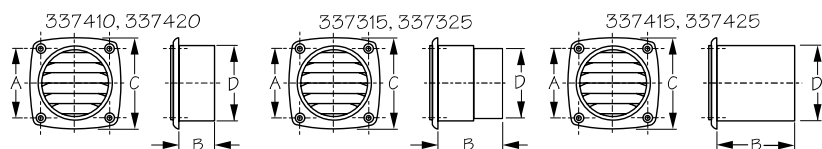
**HOSE THRU VENT**

Injection Molded ABS



| Bulk | Display | Color | A | B | C (Overall) | D (Hose/Hole Size) | Vent Area | Fastener | Wt.(lb.) | Std. Pack |
|--------|---------|-------|----------|---------|-------------|--------------------|----------------------|----------|----------|-----------|
| 337325 | n/a | Black | 2-13/16" | 2-7/16" | 3-11/16" | 3"/3-1/8" | 3.04 in ² | #8 FH | .16 | 10 ea |
| 337420 | n/a | Black | 3-9/16" | 1-3/8" | 4-15/16" | 4" | 4.05 in ² | #8 FH | .19 | 10 ea |
| 337425 | n/a | Black | 3-9/16" | 3" | 4-15/16" | 4" | 4.05 in ² | #8 FH | .27 | 10 ea |
| 337315 | n/a | White | 2-13/16" | 2-7/16" | 3-11/16" | 3"/3-1/8" | 3.04 in ² | #8 FH | .16 | 10 ea |
| 337410 | n/a | White | 3-9/16" | 1-3/8" | 4-15/16" | 4" | 4.05 in ² | #8 FH | .19 | 10 ea |
| 337415 | n/a | White | 3-9/16" | 3" | 4-15/16" | 4" | 4.05 in ² | #8 FH | .27 | 10 ea |

These Hose Thru Vents are designed for cabin or bilge ventilation. For use with 3" or 4" exhaust hose. Avoid contact with acetone or strong solvents. Constructed of UV resistant injection molded ABS. Installs with four #8 FH fasteners (not included). Available in black or white.

- Available in custom colors for large volume orders

▲ **WARNING:** Cancer and Reproductive Harm - www.P65Warnings.ca.gov

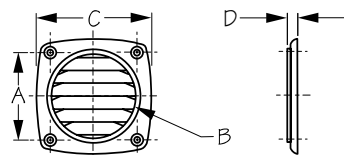
**FLUSH THRU VENT**

Injection Molded ABS



| Bulk | Display | Color | A | B | C (Overall) | D | Hose/Hole Size | Vent Area | Wt.(lb.) | Std. Pack |
|--------|----------|-------|----------|--------|-------------|-------|----------------|----------------------|----------|-----------|
| 337326 | 337326-1 | Black | 2-13/16" | 2-3/4" | 3-11/16" | 5/16" | Up to 3" | 3.04 in ² | .07 | 10 ea |
| 337426 | 337426-1 | Black | 3-9/16" | 3-3/4" | 4-15/16" | 5/16" | Up to 4" | 4.05 in ² | .09 | 10 ea |
| 337316 | 337316-1 | White | 2-13/16" | 2-3/4" | 3-11/16" | 5/16" | Up to 3" | 3.04 in ² | .07 | 10 ea |
| 337416 | 337416-1 | White | 3-9/16" | 3-3/4" | 4-15/16" | 5/16" | Up to 4" | 4.05 in ² | .09 | 10 ea |

These Flush Thru Vents are designed for cabin or bilge ventilation. For use with 3" or 4" exhaust hose. Avoid contact with acetone or strong solvents. Constructed of UV resistant injection molded ABS. Installs with four #8 FH fasteners (not included).

- Available in custom colors for large volume orders



HOSE VENT ELBOW

Injection Molded ABS

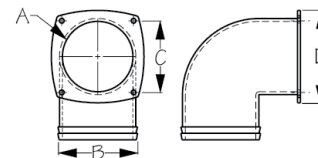

| Bulk | Display | A | B (Hose Size) | C | D | Wt.(lb.) | Std. Pack |
|--------|---------|--------|---------------|----------|----------|----------|-----------|
| 337350 | n/a | 2-3/4" | 3" | 2-13/16" | 3-11/16" | .25 | 1 ea |

This Hose Vent Elbow is for use with 3" hose vents to create a 90° bend. Constructed of impact resistant injection molded ABS. Installs with four #8 FH fasteners (not included). Installation hole pattern matches Flush Thru Vents (337316, 337326, and 337590).



VENT PLUG

Injection Molded Nylon

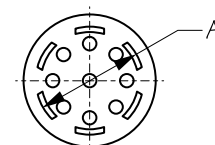

| Bulk | Display | A | Vent Area | Per Pack | Color | Wt.(lb.) | Std. Pack |
|------|----------|----|----------------------|----------|---------|----------|-----------|
| n/a | 337360-1 | 1" | 0.11 in ² | 4 | Natural | .02 | 5 sets |

This Vent Plug is designed to press fit into a 1" diameter round hole. Ideal for venting areas that may be subjected to heat or moisture build-up. Constructed of UV resistant injection molded nylon. Vent area 0.11 in². Four per set.



LOUVERED VENT

Injection Molded ABS

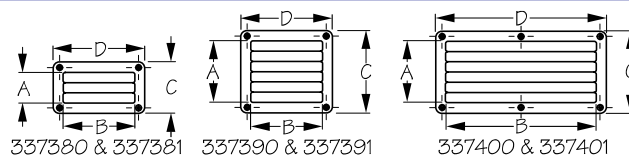

| Bulk | Display | A (Cutout Size) | B | C (Overall Size) | D | Color | Vent Area | Fastener | Wt.(lb.) | Std. Pack |
|--------|----------|-----------------|--------|------------------|---------|-------|-----------------------|----------|----------|-----------|
| 337380 | 337380-1 | 1-7/8" | 4-1/4" | 3" | 5-1/2" | Black | 3.33 in ² | #8 FH | .10 | 10 ea |
| 337390 | 337390-1 | 3-11/16" | 4-1/4" | 4-7/8" | 5-1/2" | Black | 6.65 in ² | #8 FH | .16 | 10 ea |
| 337400 | 337400-1 | 3-11/16" | 9" | 4-7/8" | 10-1/8" | Black | 13.30 in ² | #8 FH | .30 | 10 ea |
| 337381 | 337381-1 | 1-7/8" | 4-1/4" | 3" | 5-1/2" | White | 3.33 in ² | #8 FH | .10 | 10 ea |
| 337391 | 337391-1 | 3-11/16" | 4-1/4" | 4-7/8" | 5-1/2" | White | 6.65 in ² | #8 FH | .16 | 10 ea |
| 337401 | 337401-1 | 3-11/16" | 9" | 4-7/8" | 10-1/8" | White | 13.30 in ² | #8 FH | .30 | 10 ea |

These Louvered Vents are designed to promote air circulation and prevent mold, mildew, and unpleasant odors. Ideal for cabin doors, lockers, dock boxes, etc. Avoid contact with acetone or strong solvents. Constructed of UV resistant injection molded ABS. Installs with #8 FH fasteners (not included). Available in black or white.

- Available in custom colors for large volume orders



LOUVERED VENT

Injection Molded ABS

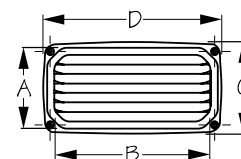

| Bulk | Display | Color | A (Cutout Size) | B | C (Overall Size) | D | Vent Area | Fastener | Wt.(lb.) | Std. Pack |
|--------|---------|-------|-----------------|--------|------------------|--------|----------------------|----------|----------|-----------|
| 337500 | n/a | Black | 2-15/16" | 6-7/8" | 3-7/8" | 7-7/8" | 8.02 in ² | #8 FH | .17 | 10 ea |
| 337501 | n/a | White | 2-15/16" | 6-7/8" | 3-7/8" | 7-7/8" | 8.02 in ² | #8 FH | .17 | 10 ea |

These Louvered Vents are designed to promote air circulation and prevent mold, mildew, and unpleasant odors. Ideal for cabin doors, lockers, dock boxes, etc. Avoid contact with acetone or strong solvents. Constructed of UV resistant injection molded ABS. Installs with four #8 FH fasteners (not included). Available in black or white.



FLUSH THRU VENT

Investment Cast 316 Stainless Steel

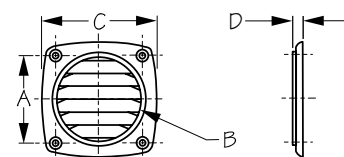

| Bulk | Display | A | B | C (Overall) | D | Hose/Hole Size | Vent Area | Fastener | Wt.(lb.) | Std. Pack |
|--------|----------|--------|--------|-------------|-------|----------------|----------------------|----------|----------|-----------|
| 337590 | 337590-1 | 2-7/8" | 2-7/8" | 3-7/8" | 5/16" | Up to 3" | 3.04 in ² | #8 FH | .46 | 1 ea |

This Flush Thru Vent is designed for cabin or bilge ventilation. For use with 3" exhaust hose. Constructed of corrosion resistant investment cast 316 stainless steel. Installs with four #8 FH fasteners (not included).

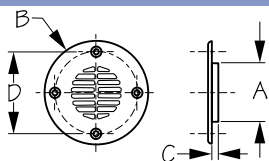
**DECK DRAIN**

Injection Molded ABS

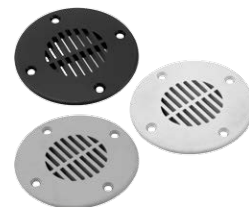

| Bulk | Display | Color | A (Cutout) | B (Overall) | C | D | Vent Area | Fastener | Wt.(lb.) | Std. Pack |
|--------|----------|-------|------------|-------------|------|----------|----------------------|----------|----------|-----------|
| 340020 | 340020-1 | Black | 2-1/2" | 4-3/16" | 1/4" | 3-3/8" | 1.70 in ² | #10 FH | .08 | 10 ea |
| 340040 | 340040-1 | Black | 4" | 5-5/8" | 1/4" | 4-13/16" | 4.60 in ² | #10 FH | .15 | 10 ea |
| 340021 | 340021-1 | White | 2-1/2" | 4-3/16" | 1/4" | 3-3/8" | 1.70 in ² | #10 FH | .08 | 10 ea |
| 340041 | 340041-1 | White | 4" | 5-5/8" | 1/4" | 4-13/16" | 4.60 in ² | #10 FH | .15 | 10 ea |
| 340022 | n/a | Gray | 2-1/2" | 4-3/16" | 1/4" | 3-3/8" | 1.70 in ² | #10 FH | .08 | 10 ea |
| 340042 | n/a | Gray | 4" | 5-5/8" | 1/4" | 4-13/16" | 4.60 in ² | #10 FH | .15 | 10 ea |

These Deck Drains are designed to drain water from cabin soles of bass, pontoon, and other open deck boats. Can be used to vent lockers, refrigerator cabinets, or as a grille for enclosed horns and speakers. Avoid contact with acetone or strong solvents. Constructed of UV resistant injection molded ABS. Installs with four #10 FH fasteners (not included).

⚠ WARNING: Cancer and Reproductive Harm - www.P65Warnings.ca.gov

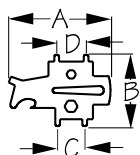
**UNIVERSAL DECK FILL KEY**

Stamped 304 Stainless Steel



| Bulk | Display | A | B | C | D | Wt.(lb.) | Std. Pack |
|--------|----------|----|--------|---------|---------|----------|-----------|
| 335690 | 335690-1 | 4" | 2-3/4" | 1-1/16" | 1-3/16" | .13 | 10 ea |

This Universal Deck Fill Key fits all Sea-Dog® Fuel Fills as well as most other competitors fills. A multi-purpose tool that also functions as a shackle key, bottle opener, straight blade screwdriver, plus 5/16" and 7/16" hex head wrenches. Constructed of corrosion resistant stamped 304 stainless steel.

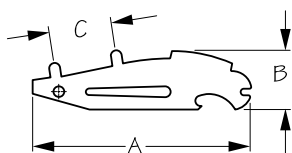
**UNIVERSAL DECK FILL KEY - SMALL**

Stamped 304 Stainless Steel



| Bulk | Display | A | B | C | Wt.(lb.) | Std. Pack |
|--------|----------|----|---------|--------|----------|-----------|
| 335695 | 335695-1 | 4" | 1-1/16" | 1-1/8" | .06 | 10 ea |

Universal Deck Fill Key fits most deck fills and includes a bottle opener and shackle key. Constructed of corrosion resistant stamped 304 stainless steel.

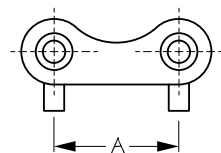
**DECK FILL KEY**

Investment Cast 316 Stainless Steel



| Bulk | Display | A | Wt.(lb.) | Std. Pack |
|--------|----------|---------|----------|-----------|
| 351399 | 351399-1 | 1-3/16" | .04 | 10 ea |

Deck Fill Key is for use with all Fill Caps with 1-3/16" holes on center. Fits all cast stainless steel Sea-Dog® Deck Fill Caps (351320-351331 and 351350-351353). Constructed of corrosion resistant investment cast 316 stainless steel.

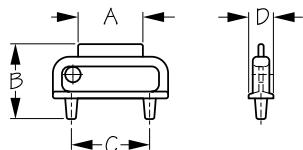
**DECK FILL KEY**

Injection Molded Nylon Glass Filled



| Bulk | Display | A | B | C | D | Wt.(lb.) | Std. Pack |
|--------|----------|----|--------|---------|------|----------|-----------|
| 357399 | 357399-1 | 1" | 1-1/8" | 1-3/16" | 3/8" | .01 | 10 ea |

Deck Fill Key is for use with all Fill Caps featuring 1-3/16" holes on center. Constructed of UV resistant injection molded nylon.

⚠ WARNING: Cancer and Reproductive Harm - www.P65Warnings.ca.gov



EMERGENCY DECK FILL PLUG

Nitrile-Buna Rubber

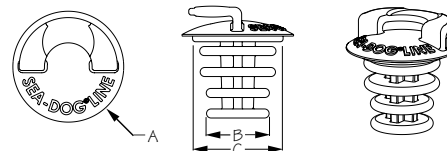

| Bulk | Display | A | B | C | Wt.(lb.) | Std. Pack |
|--------|----------|--|---------|--------|----------|-----------|
| 357390 | 357390-1 | 2-3/8" | 1-5/16" | 1-7/8" | .05 | 10 ea |
| n/a | 357390-5 | Display POP-Emergency Deck Fill Plug-10 pcs. | | | | .50 1 ea |

This Emergency Deck Fill Plug is a must for any vessel. Fits most 1-1/2" hose deck fills in the event you lose your cap. For temporary use only until you can replace your OEM cap. Constructed of fuel resistant Nitrile-Buna rubber.



⚠ WARNING: Cancer and Reproductive Harm - www.P65Warnings.ca.gov



FLIP TOP HOSE GAS FILL

Investment Cast 316 Stainless Steel

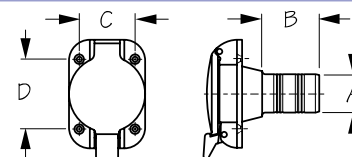

| Bulk | Display | Marking | A | B | C | D | Fastener | Wt.(lb.) | Std. Pack |
|--------|---------|-----------------------------------|-------------|--------|---------|--------|----------|----------|-----------|
| 351100 | n/a | Gas | 2" Hose | 2-1/2" | 2-3/16" | 2-3/4" | #10 FH | 2.07 | 1 ea |
| 351110 | n/a | Gas | 1-1/2" Hose | 3" | 2-3/16" | 2-3/4" | #10 FH | 2.04 | 1 ea |
| 351119 | n/a | Stainless Lever & Cap Rebuild Kit | | | | | | | .04 1 ea |

Flip Top Hose Gas Fill features a convenient thumb latch to open the fill. Hinged lid guarantees cap will not fall overboard. Constructed of corrosion resistant investment cast 316 stainless steel. Installs with four #10 FH fasteners (not included). USCG regulations require bonding wire to prevent sparking.

Stainless Lever & Cap Rebuild Kit (351119, pictured right) contains: 1 Lever, 1 Lever Spring, 2 Pivot Pins, 1 Cotter Pin, 1 Cap Spring, and 1 Gasket/Washer.



⚠ WARNING: Cancer and Reproductive Harm - www.P65Warnings.ca.gov



HOSE DECK FILL WITH KEYLESS CAP

Investment Cast 316 Stainless Steel/Injection Molded Nylon Glass Filled

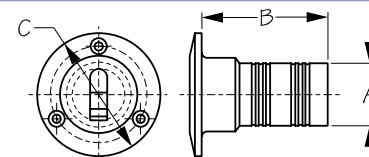

| Bulk | Display | Cap Marking | Cap Color | A | B | C | Fastener | Wt.(lb.) | Std. Pack |
|---------|----------|--|-----------|-----------------|----|----|----------|----------|-----------|
| 351310 | 351310-1 | Gas | Red | 1-1/2" Hose | 3" | 3" | #10 FH | .75 | 1 ea |
| 351311 | 351311-1 | Diesel | Green | 1-1/2" Hose | 3" | 3" | #10 FH | .75 | 1 ea |
| 351312 | 351312-1 | Water | Blue | 1-1/2" Hose | 3" | 3" | #10 FH | .75 | 1 ea |
| 351313 | 351313-1 | Waste | Black | 1-1/2" Hose | 3" | 3" | #10 FH | .75 | 1 ea |
| n/a | 357090-1 | Gas | Red | Replacement Cap | | | | .08 | 5 ea |
| n/a | 357091-1 | Diesel | Green | Replacement Cap | | | | .08 | 5 ea |
| n/a | 357093-1 | Water | Blue | Replacement Cap | | | | .08 | 5 ea |
| n/a | 357094-1 | Waste | Black | Replacement Cap | | | | .08 | 5 ea |
| 351300 | 351300-1 | None (Body Only) for 1-1/2" Hose | | | | | | .67 | 1 ea |
| OP35701 | n/a | Replacement O-Ring for 1-1/2" Deck Fills | | | | | | .01 | 10 ea |

These Hose Deck Fills with Keyless Caps have a built-in key for easy cap removal. The key can be locked in the upright position to open or close the fill and then recessed into the cap for a flush surface. Cap diameter 1-7/8", thread pitch 11-1/2 NPSM straight. Caps are color-coded for easy deck fill identification, eliminating dangerous and potentially costly problems caused by misidentification. Gas, diesel, and water caps include attachment chains. Constructed of corrosion resistant investment cast 316 stainless steel with molded fiberglass filled nylon cap. Installs with three #10 FH fasteners (not included). USCG regulations require bonding wire to prevent sparking.

- Black Caps With All Markings Available Through Special Order
- Special Order Requirements May Apply
- Custom Colors Available With Large Order

⚠ WARNING: Cancer and Reproductive Harm - www.P65Warnings.ca.gov

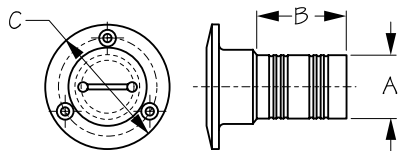
**HOSE DECK FILL**

Investment Cast 316 Stainless Steel



| Bulk | Display | Body Marking | A | B | C | Fastener | Wt.(lb.) | Std. Pack |
|---------|----------|--|-------------|--------|---------|----------|----------|-----------|
| 351320 | 351320-1 | Gas | 1-1/2" Hose | 3" | 3" | #10 FH | .86 | 1 ea |
| 351321 | 351321-1 | Diesel | 1-1/2" Hose | 3" | 3" | #10 FH | .83 | 1 ea |
| 351322 | 351322-1 | Water | 1-1/2" Hose | 3" | 3" | #10 FH | .85 | 1 ea |
| 351323 | 351323-1 | Waste | 1-1/2" Hose | 3" | 3" | #10 FH | .85 | 1 ea |
| 351300 | 351300-1 | None (Body Only) | 1-1/2" Hose | 3" | 3" | #10 FH | .67 | 1 ea |
| 351330 | n/a | Gas | 2" Hose | 3-1/4" | 3-7/16" | #10 FH | 1.12 | 1 ea |
| 351331 | n/a | Diesel | 2" Hose | 3-1/4" | 3-7/16" | #10 FH | 1.12 | 1 ea |
| 351400 | n/a | None (Body Only) | 2" Hose | 3-1/4" | 3-7/16" | #10 FH | .90 | 1 ea |
| n/a | 351390-1 | Replacement Cap | 1-1/2" Hose | | | | .22 | 5 ea |
| 351391 | 351391-1 | Replacement Cap | 2" Hose | | | | .29 | 5 ea |
| OP35701 | n/a | Replacement O-Ring for 1-1/2" Deck Fills | | | | | .01 | 10 ea |
| 351399 | 351399-1 | Deck Fill Key - Stainless | | | | | .04 | 10 ea |
| 357399 | 357399-1 | Deck Fill Key - Nylon | | | | | .01 | 10 ea |

These Hose Deck Fills feature a slotted cap which requires a key to open and close for extra security. 1-1/2" hose deck fill cap diameter 1-7/8", thread pitch 11-1/2 NPSM straight. 2" hose deck fill cap diameter 2-1/8", thread pitch 11-1/2 NPSM straight. All fills and replacement caps (except waste) include attachment chain. Constructed of corrosion resistant investment cast 316 stainless steel. Installs with three #10 FH fasteners (not included). USCG regulations require bonding wire to prevent sparking.

⚠ **WARNING:** Cancer and Reproductive Harm - www.P65Warnings.ca.gov

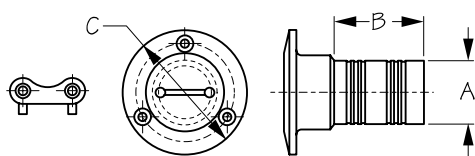
**HOSE DECK FILL WITH KEY**

Investment Cast 316 Stainless Steel



| Bulk | Display | Body Marking | A | B | C | Fastener | Wt.(lb.) | Std. Pack |
|---------|----------|--|-------------|----|----|----------|----------|-----------|
| 351320K | n/a | Gas | 1-1/2" Hose | 3" | 3" | #10 FH | .90 | 1 ea |
| 351322K | n/a | Water | 1-1/2" Hose | 3" | 3" | #10 FH | .90 | 1 ea |
| n/a | 351390-1 | Replacement Cap | 1-1/2" Hose | | | | .22 | 5 ea |
| OP35701 | n/a | Replacement O-Ring for 1-1/2" Deck Fills | | | | | .01 | 10 ea |

These Hose Deck Fills include a stainless Deck Fill Key (351399) necessary to open and close the slotted cap. Cap diameter 1-7/8", thread pitch 11-1/2 NPSM straight. Includes attachment chain. Constructed of corrosion resistant investment cast 316 stainless steel. Installs with three #10 FH fasteners (not included). USCG regulations require bonding wire to prevent sparking.

⚠ **WARNING:** Cancer and Reproductive Harm - www.P65Warnings.ca.gov

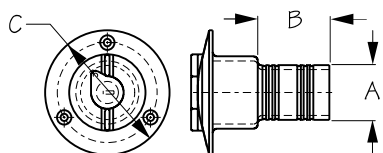
**LOCKING HOSE DECK FILL**

Investment Cast 316 Stainless Steel



| Bulk | Display | Body Marking | A | B | C | Fastener | Wt.(lb.) | Std. Pack |
|---------|-----------|------------------------------|-------------|--------|---------|----------|----------|-----------|
| 351320L | 351320L-1 | Gas | 1-1/2" Hose | 3-1/4" | 3-7/16" | #10 FH | 1.25 | 1 ea |
| 351321L | 351321L-1 | Diesel | 1-1/2" Hose | 3-1/4" | 3-7/16" | #10 FH | 1.25 | 1 ea |
| 351322L | n/a | Water | 1-1/2" Hose | 3-1/4" | 3-7/16" | #10 FH | 1.25 | 1 ea |
| 351330L | n/a | Gas | 2" Hose | 3-1/4" | 3-7/16" | #10 FH | 1.35 | 1 ea |
| 351331L | n/a | Diesel | 2" Hose | 3-1/4" | 3-7/16" | #10 FH | 1.35 | 1 ea |
| OP35105 | n/a | Replacement Attachment Cable | | | | | .05 | 5 ea |

These Locking Hose Deck Fills feature a locking cap to prevent fuel theft. Cap spins freely when in the locked position. To unlock the cap, turn key until key hole is inline with the cap tabs (shown in photo). Cap diameter 2-1/8", thread pitch 11-1/2 NPSM straight. Color-coded with international symbols for easy deck fill identification. Includes two keys and cap attachment cable. Constructed of corrosion resistant investment cast 316 stainless steel for long term durability. Installs with three #10 FH fasteners (not included). USCG regulations require bonding wire to prevent sparking.

⚠ **WARNING:** Cancer and Reproductive Harm - www.P65Warnings.ca.gov



HOSE DECK FILL WITH GUARD

Investment Cast 316 Stainless Steel

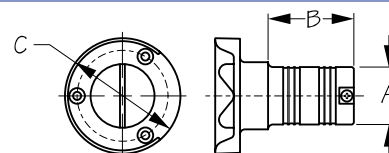

| Bulk | Display | Body Marking | A | B | C | Fastener | Wt.(lb.) | Std. Pack |
|--------|----------|--|-------------|----|----|----------|----------|-----------|
| 351340 | 351340-1 | Gas | 1-1/2" Hose | 3" | 3" | #10 FH | .84 | 1 ea |
| n/a | 351393-1 | Replacement Cap | 1-1/2" Hose | | | | .21 | 5 ea |
| 351349 | n/a | Replacement Gasket For Deck Fill With Guard (351340) | | | | #10 FH | .01 | 10 ea |

These Hose Deck Fills with Splash Guards feature a cap attachment chain and easy-to-use tabs for key-less operation (no deck plate key required). Cap diameter 1-11/16", thread pitch 12 NPSM straight. Fits 1-1/2" ID hose. Constructed of corrosion resistant investment cast 316 stainless steel. Installs with three #10 FH fasteners (not included). USCG regulations require bonding wire to prevent sparking.

⚠ WARNING: Cancer and Reproductive Harm - www.P65Warnings.ca.gov



PIPE DECK FILL

Investment Cast 316 Stainless Steel

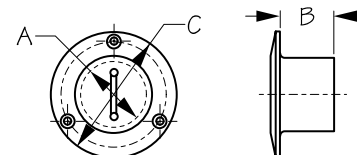

| Bulk | Display | Body Marking | A | B | C | Fastener | Wt.(lb.) | Std. Pack |
|---------|----------|--|--------|--------|---------|----------|----------|-----------|
| 351350 | 351350-1 | Gas | 1-1/2" | 1-1/2" | 3-7/16" | #10 FH | .75 | 1 ea |
| 351351 | 351351-1 | Diesel | 1-1/2" | 1-1/2" | 3-7/16" | #10 FH | .75 | 1 ea |
| 351352 | 351352-1 | Water | 1-1/2" | 1-1/2" | 3-7/16" | #10 FH | .75 | 1 ea |
| 351353 | 351353-1 | Waste | 1-1/2" | 1-1/2" | 3-7/16" | #10 FH | .75 | 1 ea |
| n/a | 351391-1 | Replacement Cap (351350-351353) | | | | | .24 | 5 ea |
| OP35701 | n/a | Replacement O-Ring for 1-1/2" Deck Fills | | | | | .01 | 10 ea |
| 351399 | 351399-1 | Deck Fill Key - Stainless | | | | | .04 | 10 ea |
| 357399 | 357399-1 | Deck Fill Key - Nylon | | | | | .01 | 10 ea |

These Pipe Deck Fills are designed to be used in conjunction with 1-1/2" - 11-1/2 NPSM straight threaded pipe. Cap diameter 2-1/8", thread pitch 11-1/2 NPSM straight. All fills and replacement caps (except waste) include attachment chain. Constructed of corrosion resistant investment cast 316 stainless steel. Installs with three #10 FH fasteners (not included). USCG regulations require bonding wire to prevent sparking.

⚠ WARNING: Cancer and Reproductive Harm - www.P65Warnings.ca.gov



KEY FREE HOSE DECK FILL

Investment Cast 316 Stainless Steel

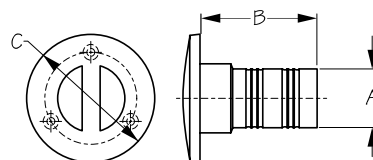

| Bulk | Display | Cap Marking | A | B | C | Fastener | Wt.(lb.) | Std. Pack |
|---------|----------|--|-------------|--------|----------|----------|----------|-----------|
| 351380 | 351380-1 | Gas | 1-1/2" Hose | 3" | 3-1/4" | #10 FH | 1.16 | 1 ea |
| 351381 | 351381-1 | Diesel | 1-1/2" Hose | 3" | 3-1/4" | #10 FH | 1.16 | 1 ea |
| 351382 | 351382-1 | Water | 1-1/2" Hose | 3" | 3-1/4" | #10 FH | 1.16 | 1 ea |
| 351383 | 351383-1 | Waste | 1-1/2" Hose | 3" | 3-1/4" | #10 FH | 1.16 | 1 ea |
| n/a | 351385-1 | Replacement Cap - Gas | 1-1/2" Hose | | | | .47 | 1 ea |
| n/a | 351386-1 | Replacement Cap - Diesel | 1-1/2" Hose | | | | .47 | 1 ea |
| n/a | 351387-1 | Replacement Cap - Water | 1-1/2" Hose | | | | .47 | 1 ea |
| n/a | 351388-1 | Replacement Cap - Waste | 1-1/2" Hose | | | | .47 | 1 ea |
| 351480 | n/a | Gas | 2" Hose | 3-1/4" | 3-11/16" | #10 FH | 1.53 | 1 ea |
| 351481 | n/a | Diesel | 2" Hose | 3-1/4" | 3-11/16" | #10 FH | 1.53 | 1 ea |
| 351485 | n/a | Replacement Cap-Gas | 2" Hose | | | | .63 | 1 ea |
| 351486 | n/a | Replacement Cap-Diesel | 2" Hose | | | | .63 | 1 ea |
| 351300 | 351300-1 | None (Body Only) | 1-1/2" Hose | 3" | 3" | #10 FH | .67 | 1 ea |
| 351400 | n/a | None (Body Only) | 2" Hose | 3-1/4" | 3-11/16" | #10 FH | .90 | 1 ea |
| OP35701 | n/a | Replacement O-Ring for 1-1/2" Deck Fills | | | | | .01 | 10 ea |

These Key Free Hose Deck Fills feature a cap which covers mounting holes for a clean appearance. 1-1/2" hose deck fill cap diameter 3-1/4", thread pitch 11-1/2 NPSM straight. 2" hose deck fill cap diameter 3-11/16", thread pitch 11-1/2 NPSM straight. All fills and replacement caps (except waste) include attachment chain. Constructed of corrosion resistant investment cast 316 stainless steel. Installs with three #10 FH fasteners (not included). USCG regulations require bonding wire to prevent sparking.

⚠ WARNING: Cancer and Reproductive Harm - www.P65Warnings.ca.gov

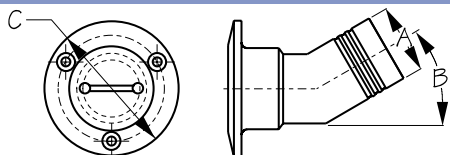
**ANGLED HOSE DECK FILL**

Investment Cast 316 Stainless Steel



| Bulk | Display | Body Marking | A | B | C | Fastener | Wt.(lb.) | Std. Pack |
|---------|----------|--|-------------|-----|---------|----------|----------|-----------|
| 351520 | n/a | Gas | 1-1/2" Hose | 30° | 3" | #10 FH | .86 | 1 ea |
| 351521 | n/a | Diesel | 1-1/2" Hose | 30° | 3" | #10 FH | .83 | 1 ea |
| 351522 | n/a | Water | 1-1/2" Hose | 30° | 3" | #10 FH | .85 | 1 ea |
| 351523 | n/a | Waste | 1-1/2" Hose | 30° | 3" | #10 FH | .85 | 1 ea |
| 351500 | n/a | None (Body Only) | 1-1/2" Hose | 30° | 3" | #10 FH | .67 | 1 ea |
| 351620 | n/a | Gas | 2" Hose | 30° | 3-7/16" | #10 FH | 1.12 | 1 ea |
| 351621 | n/a | Diesel | 2" Hose | 30° | 3-7/16" | #10 FH | 1.12 | 1 ea |
| OP35701 | n/a | Replacement O-Ring for 1-1/2" Deck Fills | | | | | .01 | 10 ea |
| n/a | 351390-1 | Replacement Cap (351520-351523) | | | | | .22 | 5 ea |
| n/a | 351391-1 | Replacement Cap (351620-351621) | | | | | .24 | 5 ea |
| OP35105 | n/a | Replacement Cap Attachment Cable | | | | | .05 | 5 ea |
| 351399 | 351399-1 | Deck Fill Key - Stainless | | | | | .04 | 10 ea |
| 357399 | 357399-1 | Deck Fill Key - Nylon | | | | | .01 | 10 ea |

These 30° Angled Hose Deck Fills feature a slotted cap which requires a key to open and close for extra security. 1-1/2" hose deck fill cap diameter 1-7/8", thread pitch 11-1/2 NPSM straight. 2" hose deck fill cap diameter 2-1/8", thread pitch 11-1/2 NPSM straight. All fills and replacement caps (except waste) include attachment cable (OP35105). Constructed of investment cast 316 stainless steel. Installs with three #10 FH fasteners (not included). USCG regulations require bonding wire to prevent sparking.

⚠ **WARNING:** Cancer and Reproductive Harm - www.P65Warnings.ca.gov

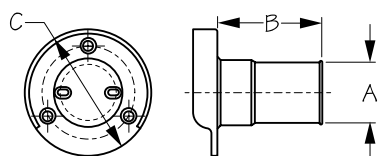
**HOSE DECK FILL WITH SPLASH GUARD**

Die Cast Zinc Chrome Plated



| Bulk | Display | Marking | A | B | C | Fastener | Wt.(lb.) | Std. Pack |
|--------|----------|------------------------------------|-------------|---------|--------|----------|----------|-----------|
| 351750 | 351750-1 | Gas | 1-1/2" Hose | 2-9/16" | 3-1/8" | #10 FH | .55 | 1 ea |
| n/a | 351755-1 | Replacement Cap (351750, 351750-1) | | | | | .10 | 10 ea |

This Hose Deck Fill with Splash Guard features a cap with easy-to-use tabs for keyless operation (no deck plate key required). Cap diameter 1-11/16", thread pitch 12 NPSM straight. Fits 1-1/2" ID hose. Includes attachment chain. Constructed of chrome plated die cast zinc. Installs with three #10 FH fasteners (not included). USCG regulations require bonding wire to prevent sparking.

⚠ **WARNING:** Cancer and Reproductive Harm - www.P65Warnings.ca.gov

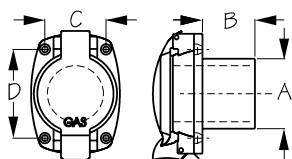
**FLIP TOP HOSE GAS FILL**

Cast Aluminum



| Bulk | Display | Marking | A | B | C | D | Fastener | Wt.(lb.) | Std. Pack |
|--------|---------|---------|---------|--------|--------|--------|----------|----------|-----------|
| 351800 | n/a | Gas | 2" Hose | 1-1/2" | 1-3/4" | 2-1/2" | #10 FH | .57 | 1 ea |

Flip Top Hose Gas Fill features a convenient thumb latch to open the fill. Hinged lid guarantees cap will not fall overboard. Constructed of cast aluminum, making it ideal for aluminum hull boats. Installs with four #10 FH fasteners (not included). USCG regulations require bonding wire to prevent sparking.

⚠ **WARNING:** Cancer and Reproductive Harm - www.P65Warnings.ca.gov



HOSE DECK FILL WITH SLOTTED CAP

Injection Molded Nylon Glass Filled

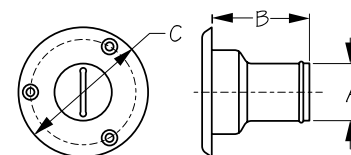

| Bulk | Display | Body Color | Cap Marking | Cap Color | A | B | C | Fastener | Wt.(lb.) | Std. Pack |
|---------|----------|--|-------------|-----------|-------------|--------|--------|----------|----------|-----------|
| 357010 | 357010-1 | Black | Gas | Red | 1-1/2" Hose | 2-1/2" | 3-3/8" | #10 FH | .21 | 1 ea |
| 357011 | 357011-1 | Black | Diesel | Green | 1-1/2" Hose | 2-1/2" | 3-3/8" | #10 FH | .21 | 1 ea |
| 357013 | 357013-1 | Black | Water | Blue | 1-1/2" Hose | 2-1/2" | 3-3/8" | #10 FH | .21 | 1 ea |
| 357014 | 357014-1 | Black | Waste | Black | 1-1/2" Hose | 2-1/2" | 3-3/8" | #10 FH | .21 | 1 ea |
| n/a | 357000-1 | Black | n/a | Body Only | 1-1/2" Hose | 2-1/2" | 3-3/8" | #10 FH | .15 | 1 ea |
| n/a | 357015-1 | Red - Gas Replacement Cap | | | | | | | .06 | 1 ea |
| n/a | 357016-1 | Green - Diesel Replacement Cap | | | | | | | .06 | 1 ea |
| n/a | 357017-1 | Blue - Water Replacement Cap | | | | | | | .06 | 1 ea |
| n/a | 357018-1 | Black - Waste Replacement Cap | | | | | | | .06 | 1 ea |
| 351399 | 351399-1 | Deck Fill Key - Stainless | | | | | | | .04 | 10 ea |
| 357399 | 357399-1 | Deck Fill Key - Nylon | | | | | | | .01 | 10 ea |
| OP35701 | n/a | Replacement O-Ring for 1-1/2" Deck Fills | | | | | | | .01 | 10 ea |

These Hose Deck Fills feature a slotted cap which requires a key to open and close for extra security. Cap diameter 1-7/8", thread pitch 11-1/2 NPSM straight. Caps are color-coded for easy deck fill identification, eliminating dangerous and potentially costly problems caused by misidentification. All fills and replacement caps (except waste) include attachment chain. Constructed of fiberglass filled injection molded nylon. These fills contain no metal and do not require grounding to the boat's electrical system. Installs with three #10 FH fasteners (not included).

- Black Caps With All Markings Available Through Special Order
- Special Order Requirements May Apply
- Custom Colors Available With Large Order

⚠ WARNING: Cancer and Reproductive Harm - www.P65Warnings.ca.gov



HOSE DECK FILL WITH KEYLESS CAP

Injection Molded Nylon Glass Filled

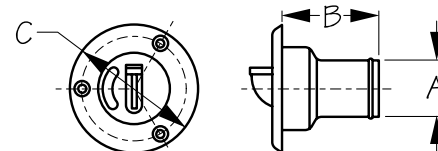

| Bulk | Display | Body Color | Cap Marking | Cap Color | A | B | C | Fastener | Wt.(lb.) | Std. Pack |
|---------|----------|--|-------------|-----------|-------------|--------|--------|----------|----------|-----------|
| 357030 | 357030-1 | Black | Gas | Red | 1-1/2" Hose | 2-1/2" | 3-3/8" | #10 FH | .22 | 1 ea |
| 357031 | 357031-1 | Black | Diesel | Green | 1-1/2" Hose | 2-1/2" | 3-3/8" | #10 FH | .22 | 1 ea |
| 357032 | 357032-1 | Black | Oil | Black | 1-1/2" Hose | 2-1/2" | 3-3/8" | #10 FH | .22 | 1 ea |
| 357033 | 357033-1 | Black | Water | Blue | 1-1/2" Hose | 2-1/2" | 3-3/8" | #10 FH | .22 | 1 ea |
| 357034 | 357034-1 | Black | Waste | Black | 1-1/2" Hose | 2-1/2" | 3-3/8" | #10 FH | .22 | 1 ea |
| n/a | 357092-1 | Black - Oil Replacement Cap | | | | | | | .08 | 5 ea |
| n/a | 357090-1 | Red - Gas Replacement Cap | | | | | | | .08 | 5 ea |
| n/a | 357091-1 | Green - Diesel Replacement Cap | | | | | | | .08 | 5 ea |
| n/a | 357093-1 | Blue - Water Replacement Cap | | | | | | | .08 | 5 ea |
| n/a | 357094-1 | Black - Waste Replacement Cap | | | | | | | .08 | 5 ea |
| n/a | 357000-1 | Black (Body Only) | | | | | | | .15 | 5 ea |
| OP35701 | n/a | Replacement O-Ring for 1-1/2" Deck Fills | | | | | | | .01 | 10 ea |

These Hose Deck Fills feature a built-in key for easy cap removal. The key can be locked in the upright position to open or close the fill and then recessed into the cap for a flush surface. Cap diameter 1-7/8", thread pitch 11-1/2 NPSM straight. Caps are color-coded for easy deck fill identification, eliminating dangerous and potentially costly problems caused by misidentification. Gas, diesel, and water caps include attachment chains. Constructed of fiberglass filled injection molded nylon. These fills contain no metal and do not require grounding to the boat's electrical system. Installs with three #10 FH fasteners (not included). Will not work with pressurized oil injection systems. Connect deck fill to reservoir via hose (not included).

- Black Caps With All Markings Available Through Special Order
- Special Order Requirements May Apply
- Custom Colors Available With Large Order

⚠ WARNING: Cancer and Reproductive Harm - www.P65Warnings.ca.gov

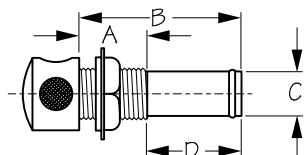
**GAS TANK VENT**

Machined Brass Chrome Plated



| Bulk | Display | A | B | C | D | Wt.(lb.) | Std. Pack |
|--------|----------|--------|--------|-----------|---------|----------|-----------|
| 352010 | 352010-1 | 15/16" | 2-1/4" | 5/8" Hose | 1-5/16" | .21 | 10 ea |

This Gas Tank Vent provides the needed air flow to maintain proper fuel flow while filling and during use. Vents compensate for changes in tank level due to consumption, as well as temperature related expansion and contraction. Designed to prevent vacuum build up during use, which can disrupt fuel delivery. They also double as a pressure release valve for the gas tank. Helps prevent fuel spills, blow-back, and ensures fumes vent outboard instead of inside the boat. Two screens provide a barrier to keep unwanted contaminants from entering the tank. An integral 5/8" hose barb securely connects vent hose. Constructed of chrome plated machined brass.

⚠ WARNING: Cancer and Reproductive Harm - www.P65Warnings.ca.gov

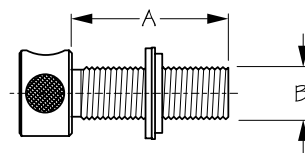
**GAS TANK VENT - ALL THREAD**

Machined Brass Chrome Plated



| Bulk | Display | A | B | Wt.(lb.) | Std. Pack |
|--------|----------|----------|------------|----------|-----------|
| 352020 | 352020-1 | 1-13/16" | 5/8"-18 NF | .21 | 10 ea |

This All Thread Gas Tank Vent provides the needed air flow to maintain proper fuel flow while filling and during use. Vents compensate for changes in tank level due to consumption, as well as temperature related expansion and contraction. Designed to prevent vacuum build-up during use, which can disrupt fuel delivery they also double as a pressure release valve for the gas tank. Helps prevent fuel spills, blow-back, and ensures fumes vent outboard instead of inside the boat. Two screens provide a barrier to keep unwanted contaminants from entering the tank. Integral 5/8"-18 NH threads to securely connect vent hose. Constructed of chrome plated machined brass.

⚠ WARNING: Cancer and Reproductive Harm - www.P65Warnings.ca.gov

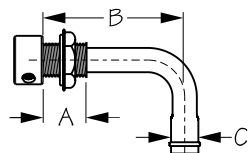
**GAS TANK VENT 90°**

Machined Brass Chrome Plated



| Bulk | Display | A | B | C | Wt.(lb.) | Std. Pack |
|--------|----------|------|--------|-----------|----------|-----------|
| 352030 | 352030-1 | 7/8" | 2-3/8" | 5/8" Hose | .27 | 10 ea |

This 90° Gas Tank Vent provides the needed air flow to maintain proper fuel flow while filling and during use. Vents compensate for changes in tank level due to consumption, as well as temperature related expansion and contraction. Designed to prevent vacuum build-up during use, which can disrupt fuel delivery they also double as a pressure release valve for the gas tank. Helps prevent fuel spills, blow-back, and ensures fumes vent outboard instead of inside the boat. An integral 5/8" hose barb securely connects vent hose at a 90° angle. Constructed of chrome plated machined brass.

⚠ WARNING: Cancer and Reproductive Harm - www.P65Warnings.ca.gov

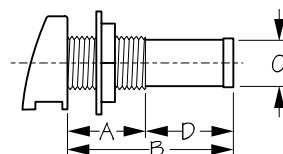
**GAS TANK VENT**

Die Cast Zinc Chrome Plated



| Bulk | Display | A | B | C | D | Wt.(lb.) | Std. Pack |
|--------|----------|----|--------|-----------|--------|----------|-----------|
| 352100 | 352100-1 | 1" | 2-1/8" | 5/8" Hose | 1-1/8" | .16 | 10 ea |

Gas Tank Vents provide the needed air flow to maintain proper fuel flow while filling and during use. Vents compensate for changes in tank level due to consumption, as well as temperature related expansion and contraction. Designed to prevent vacuum build-up during use, which can disrupt fuel delivery they also double as a pressure release valve for the gas tank. Helps prevent fuel spills, blow-back, and ensures fumes vent outboard instead of inside the boat. An integral 5/8" hose barb securely connects vent hose. Constructed of chrome plated die cast zinc. Recommended for fresh water use.

⚠ WARNING: Cancer and Reproductive Harm - www.P65Warnings.ca.gov

**GAS TANK VENT**

Die Cast Zinc Chrome Plated

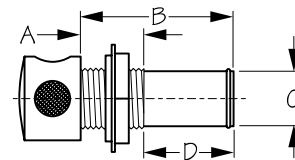

| Bulk | Display | A | B | C | D | Wt.(lb.) | Std. Pack |
|--------|----------|------|--------|-----------|----|----------|-----------|
| 352110 | 352110-1 | 3/4" | 1-3/4" | 5/8" Hose | 1" | .16 | 10 ea |

This Gas Tank Vent provides the needed air flow to maintain proper fuel flow while filling and during use. Vents compensate for changes in tank level due to consumption as well as temperature related expansion and contraction. Designed to prevent vacuum build up during use which can disrupt fuel delivery they also double as a pressure release valve for the gas tank. Helps prevent fuel spills, blow-back, and ensures fumes vent outboard instead of inside the boat. Two screens provide a barrier to keep unwanted contaminants from entering the tank. An integral 5/8" hose barb securely connects vent hose. Constructed of chrome plated die cast zinc. Recommended for fresh water use.

⚠ **WARNING:** Cancer and Reproductive Harm - www.P65Warnings.ca.gov

**GAS TANK VENT**

Investment Cast 316 Stainless Steel

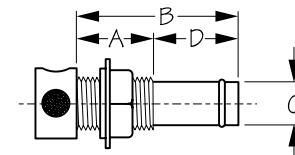

| Bulk | Display | A | B | C | D | Wt.(lb.) | Std. Pack |
|--------|----------|---------|--------|-----------|---------|----------|-----------|
| 352210 | 352210-1 | 1-3/16" | 2-1/2" | 5/8" Hose | 1-5/16" | .21 | 10 ea |

This Gas Tank Vent provides the needed air flow to maintain proper fuel flow while filling and during use. Vents compensate for changes in tank level due to consumption, as well as temperature related expansion and contraction. Designed to prevent vacuum build-up during use, which can disrupt fuel delivery they also double as a pressure release valve for the gas tank. Helps prevent fuel spills, blow-back, and ensures fumes vent outboard instead of inside the boat. Two screens provide a barrier to keep unwanted contaminants from entering the tank. An integral 5/8" hose barb securely connects vent hose. Constructed of corrosion resistant investment cast 316 stainless steel.

**GAS TANK VENT 90°**

Investment Cast 316 Stainless Steel

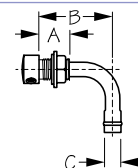

| Bulk | Display | A | B | C | Wt.(lb.) | Std. Pack |
|--------|----------|----|--------|-----------|----------|-----------|
| 352230 | 352230-1 | 1" | 2-5/8" | 5/8" Hose | .27 | 10 ea |

This 90° Gas Tank Vent provides the needed air flow to maintain proper fuel flow while filling and during use. Vents compensate for changes in tank level due to consumption, as well as temperature related expansion and contraction. Designed to prevent vacuum build-up during use, which can disrupt fuel delivery they also double as a pressure release valve for the gas tank. Helps prevent fuel spills, blow-back, and ensures fumes vent outboard instead of inside the boat. Two screens provide a barrier to keep unwanted contaminants from entering the tank. An integral 5/8" hose barb securely connects vent hose at a 90° angle. Constructed of corrosion resistant investment cast 316 stainless steel.

**FLUSH MOUNT GAS TANK VENT**

Investment Cast 316 Stainless Steel

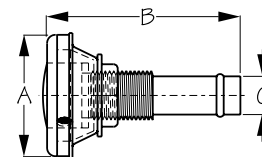

| Bulk | Display | A | B | C | Wt.(lb.) | Std. Pack |
|--------|----------|----------|----|-----------|----------|-----------|
| 353210 | 353210-1 | 1-13/16" | 3" | 5/8" Hose | .30 | 10 ea |

This Flush Mount Gas Tank Vent provides the needed air flow to maintain proper fuel flow while filling and during use. Vents compensate for changes in tank level due to consumption, as well as temperature related expansion and contraction. Designed to prevent vacuum build-up during use, which can disrupt fuel delivery they also double as a pressure release valve for the gas tank. Helps prevent fuel spills, blow-back, and ensures fumes vent outboard instead of inside the boat. An integral 5/8" hose barb securely connects vent hose. Constructed of corrosion resistant investment cast 316 stainless steel.

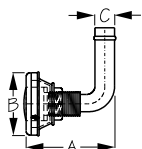
**FLUSH MOUNT GAS TANK VENT 90°**

Investment Cast 316 Stainless Steel



| Bulk | Display | A | B | C | Wt.(lb.) | Std. Pack |
|--------|----------|---------|----------|-----------|----------|-----------|
| 353230 | 353230-1 | 2-9/16" | 1-13/16" | 5/8" Hose | .30 | 10 ea |

This Flush Mount 90° Gas Tank Vent provides the needed air flow to maintain proper fuel flow while filling and during use. Vents compensate for changes in tank level due to consumption, as well as temperature related expansion and contraction. Designed to prevent vacuum build-up during use, which can disrupt fuel delivery they also double as a pressure release valve for the gas tank. Helps prevent fuel spills, blow-back, and ensures fumes vent outboard instead of inside the boat. An integral 5/8" hose barb securely connects vent hose at a 90° angle. Constructed of corrosion resistant investment cast 316 stainless steel.

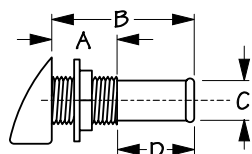
**GAS TANK VENT**

Injection Molded Nylon



| Bulk | Display | A | B | C | D | Color | Wt.(lb.) | Std. Pack |
|--------|----------|----|--------|-----------|--------|-------|----------|-----------|
| 357100 | 357100-1 | 1" | 2-1/8" | 5/8" Hose | 1-1/8" | Black | .05 | 10 ea |
| 357105 | 357105-1 | 1" | 2-1/8" | 5/8" Hose | 1-1/8" | White | .05 | 10 ea |

These Gas Tank Vents provide the needed air flow to maintain proper fuel flow while filling and during use. Vents compensate for changes in tank level due to consumption, as well as temperature related expansion and contraction. Designed to prevent vacuum build-up during use, which can disrupt fuel delivery they also double as a pressure release valve for the gas tank. Helps prevent fuel spills, blow-back, and ensures fumes vent outboard instead of inside the boat. An integral 5/8" hose barb securely connects vent hose. Constructed of UV resistant injection molded nylon construction.

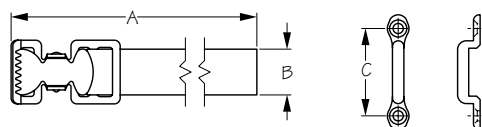
**GAS TANK STRAP**

Nylon Webbing/304 Stainless Steel



| Bulk | Display | A | B | C | Fastener | Wt.(lb.) | Std. Pack |
|--------|----------|----|----|---------|----------|----------|-----------|
| 359995 | 359995-1 | 6' | 1" | 2-3/16" | #10 FH | .23 | 10 ea |

This Gas Tank Strap is for use in securing a portable gas tank. Includes: 1" x 6' webbing strap with buckle, two footman's loops, and four #10 FH fasteners. Constructed of nylon webbing with corrosion resistant 304 stainless steel hardware.

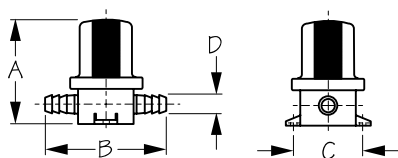
**IN-LINE WATER STRAINER**

Injection Molded Polypropylene/Polycarbonate/Stainless Steel



| Bulk | Display | Screen Size | A | B | C | D | Fasteners | Wt.(lb.) | Std. Pack |
|--------|----------|--|---------|---------|---------|-----------|-----------|----------|-----------|
| 364135 | n/a | 50 Mesh | 3-9/16" | 4-1/16" | 2-9/16" | 1/2" Hose | #10 RH | .19 | 1 ea |
| 364136 | n/a | 50 Mesh | 3-9/16" | 4-1/16" | 2-9/16" | 5/8" Hose | #10 RH | .19 | 1 ea |
| 364137 | n/a | 1/16" Mesh | 3-9/16" | 4-1/16" | 2-9/16" | 3/4" Hose | #10 RH | .21 | 1 ea |
| 364190 | n/a | Polycarbonate cover for strainer | | | | | | .06 | 1 ea |
| n/a | 364195-1 | Replacement 50 Mesh screen | | | | | | .02 | 10 ea |
| n/a | 364196-1 | Replacement 1/16" Mesh screen | | | | | | .04 | 10 ea |
| 364199 | n/a | Buna 70 O-Ring replacement strainer gasket | | | | | | .01 | 10 ea |

These In-Line Water Strainers contain a removable, clear lens for easy cleaning and changing of filter. Filter should be mounted above water level line and on suction side of pump. Constructed of injection molded polypropylene, polycarbonate, and stainless steel. Filter is interchangeable with Jabsco.

⚠ WARNING: Cancer and Reproductive Harm - www.P65Warnings.ca.gov



HIGH SPEED PIPE INTAKE STRAINER

Investment Cast 316 Stainless Steel

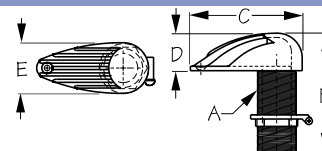

| Bulk | Display | A | B | C | D | E | Wt.(lb.) | Std. Pack |
|--------|---------|----|--------|--------|--------|--------|----------|-----------|
| 369575 | n/a | 1" | 4-1/8" | 3-7/8" | 1-1/4" | 1-5/8" | 1.11 | 1 ea |

High Speed Pipe Intake Strainer features 1" - 11-1/2 NPSM straight threads. Includes grounding stud. Constructed of corrosion resistant investment cast 316 stainless steel.



OUTBOARD MOTOR CABLE

Vinyl Coated Galvanized Steel Wire

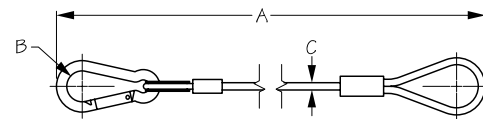

| Bulk | Display | A | B | C | Wt.(lb.) | Std. Pack |
|------|----------|-------|--------|-------|----------|-----------|
| n/a | 371599-1 | 4'-2" | 11/16" | 3/16" | .19 | 5 ea |

Outboard Motor Cable is used to secure the motor to the bracket during transport. 4'-2" total length. Includes Sea-Dog® Snap Hook (156060). Constructed of vinyl coated galvanized steel wire.

⚠ WARNING: Cancer and Reproductive Harm - www.P65Warnings.ca.gov



TRANSMOUNT SKI TOW - STUD STYLE

Formed 316 Stainless Steel

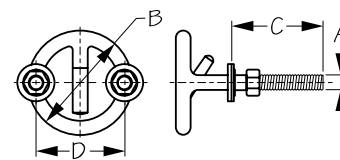

| Bulk | Display | A | B | C | D | Wt.(lb.) | Std. Pack |
|--------|----------|------|--------|--------|---------|----------|-----------|
| 371631 | 371631-1 | 3/8" | 2-1/2" | 2-1/4" | 2-3/16" | .58 | 5 ea |
| 371633 | 371633-1 | 3/8" | 3" | 2-1/4" | 2-5/8" | .65 | 5 ea |
| 371644 | 371644-1 | 1/2" | 3-1/2" | 3" | 3" | 1.28 | 5 ea |

These Stud Style Transom Mount Ski Tows are designed to bolt through the transom for maximum strength. Constructed of corrosion resistant AISI formed 316 stainless steel rod.



FLUSH MOUNT SKI TOW

Investment Cast 316 Stainless Steel

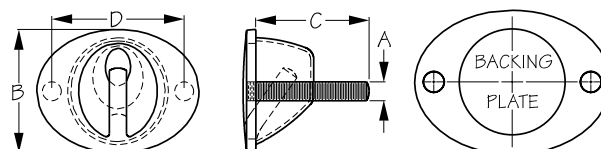

| Bulk | Display | A | B | C | D | Wt.(lb.) | Std. Pack |
|--------|---------|------|--------|--------|---------|----------|-----------|
| 371833 | n/a | 3/8" | 2-7/8" | 2-1/4" | 3-1/16" | .50 | 5 ea |

This Flush Mount Ski Tow has been redesigned to give your transom an updated look. Stud centers allow direct replacement of our most popular standard Ski Tow (371644) with just the addition of a 2-1/8" hole. Includes backing plate. Constructed of corrosion resistant investment cast 316 stainless steel.



FLUSH MOUNT SKI TOW

Investment Cast 316 Stainless Steel

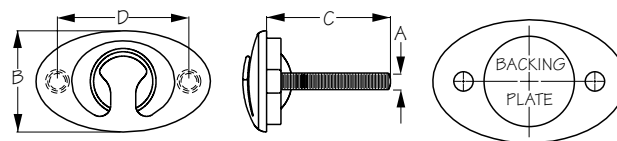

| Bulk | Display | A | B | C | D | Wt.(lb.) | Std. Pack |
|--------|---------|------|---------|----------|----|----------|-----------|
| 371840 | n/a | 3/8" | 2-3/16" | 2-13/16" | 3" | 1.05 | 1 ea |

This Flush Mount Ski Tow gives your transom an updated look. Stud centers allow direct replacement of most popular standard ski tows. Includes backing plate. Constructed of corrosion resistant investment cast 316 stainless steel.