



4

Hinges	Handles
Barrel Bolts	Latches
Door Accessories	Steering Wheels

2005

Cabinet Hardware



SHORT SIDE DOOR HINGE

Stamped 304 Stainless Steel

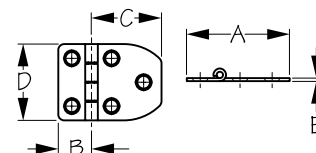

Bulk	Display	A	B	C	D	E	Fastener	Wt.(lb.)	Std. Pack
201020	201020-1	2"	11/16"	1-5/16"	1-1/2"	1.5 mm	#8 FH	.05 / .10	10 ea / 10 pr

This Short Side Door Hinge is great for interior and exterior applications such as cabinets, hatches, folding tables, or seats where mounting space is tight. Constructed of corrosion resistant stamped 304 stainless steel. Installs with five #8 FH fasteners (not included).



OFFSET SHORT SIDE DOOR HINGE

Stamped 304 Stainless Steel

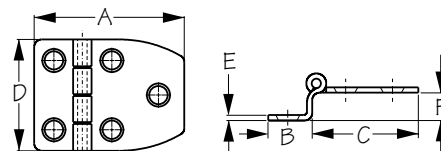

Bulk	Display	A	B	C	D	E	F	Fastener	Wt.(lb.)	Std. Pack
201025	201025-1	2"	5/8"	1-3/8"	1-1/2"	1/16"	3/8"	#8 FH	.10 / .20	10 ea / 10 pr

This Offset Short Side Door Hinge is great for interior and exterior applications such as cabinets, hatches, folding tables, or seats where mounting space is tight. Designed to be mounted on the front surface of a raised door. Constructed of corrosion resistant stamped 304 stainless steel. Installs with five #8 FH fasteners (not included).



DOOR HINGE

Stamped 304 Stainless Steel

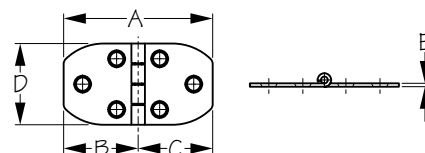

Bulk	Display	A	B	C	D	E	Fastener	Wt.(lb.)	Std. Pack
201030	201030-1	2-3/4"	1-3/8"	1-3/8"	1-1/2"	1.5 mm	#8 FH	.07 / .14	10 ea / 10 pr

These Door Hinges are constructed of corrosion resistant stamped 304 stainless steel to withstand the harsh marine environment. Installs with six #8 FH fasteners (not included).



BUTT HINGE

Stamped 304 Stainless Steel

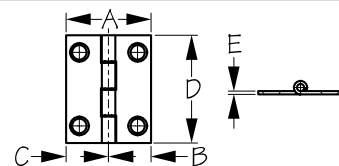

Bulk	Display	A	B	C	D	E	Fastener	Wt.(lb.)	Std. Pack
201070	201070-1	1-1/4"	5/8"	5/8"	1-1/2"	1.5 mm	#8 FH	.03 / .06	10 ea / 10 pr
201071	201071-1	1-1/2"	3/4"	3/4"	2"	1.5 mm	#8 FH	.06 / .12	10 ea / 10 pr
201072	201072-1	2"	1"	1"	2"	1.5 mm	#8 FH	.07 / .14	10 ea / 10 pr

These Butt Hinges consist of two rectangular leaves that attach to the abutting surfaces of a door and door jamb. Designed to be mortised for a flush installation. Constructed of corrosion resistant stamped 304 stainless steel. Installs with four #8 FH fasteners (not included).



BUTT HINGE

Stamped 304 Stainless Steel

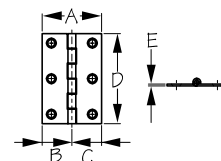

Bulk	Display	A	B	C	D	E	Fastener	Wt.(lb.)	Std. Pack
201080	201080-1	2"	1"	1"	3"	1.5 mm	#8 FH	.11 / .22	10 ea / 10 pr
201081	201081-1	3"	1-1/2"	1-1/2"	3"	1.5 mm	#8 FH	.16 / .32	10 ea / 10 pr

These Butt Hinges consist of two rectangular leaves that attach to the abutting surfaces of a door and door jamb. Designed to be mortised in for a flush installation. Constructed of corrosion resistant stamped 304 stainless steel. Installs with six #8 FH fasteners (not included).

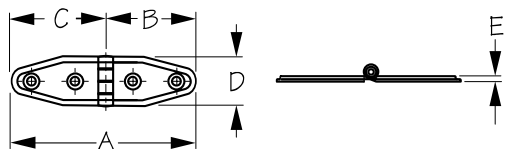
**STRAP HINGE**

Stamped 304 Stainless Steel



Bulk	Display	A	B	C	D	E	Fastener	Wt.(lb.)	Std. Pack
201134	201134-1	4"	2"	2"	1-1/8"	1/8"	#8 FH	.08 / .16	10 ea / 10 pr
201136	201136-1	6-1/8"	3-1/16"	3-1/16"	1-1/8"	1/8"	#8 FH	.11 / .22	10 ea / 10 pr

These Strap Hinges consist of two long narrow leaves extending from a single knuckle. Commonly used for surface mounting dock box lids, fish holds, etc. They are good for outdoor applications where the hinges will be in frequent use. Constructed of corrosion resistant stamped 304 stainless steel. Installs with #8 fasteners (not included).

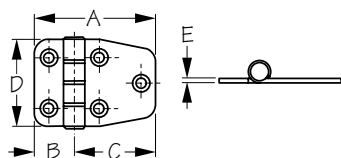
**SHORT SIDE DOOR HINGE**

Stamped 304 Stainless Steel



Bulk	Display	A	B	C	D	E	Fastener	Wt.(lb.)	Std. Pack
201510	201510-1	2-1/8"	11/16"	1-7/16"	1-1/2"	1/16"	#8 FH	.09 / .18	10 ea / 10 pr

These Short Side Door Hinges are great for interior and exterior applications such as cabinets, hatches, folding tables, or seats where mounting space is tight. Constructed of corrosion resistant stamped 304 stainless steel. Installs with five #8 FH fasteners (not included).

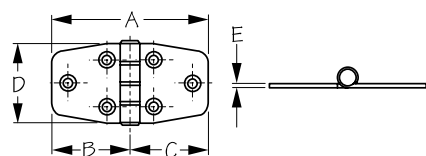
**DOOR HINGE**

Stamped 304 Stainless Steel



Bulk	Display	A	B	C	D	E	Fastener	Wt.(lb.)	Std. Pack
201530	201530-1	2-7/8"	1-7/16"	1-7/16"	1-1/2"	1/16"	#8 FH	.11 / .22	10 ea / 10 pr
201531	201531-1	3-15/16"	1-7/8"	1-7/8"	1-1/2"	1/16"	#8 FH	.13 / .26	10 ea / 10 pr

These Door Hinges are constructed of corrosion resistant stamped 304 stainless steel to withstand the harsh marine environment. Installs with six #8 FH fasteners (not included).

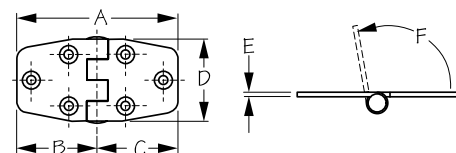
**FLUSH DOOR HINGE**

Stamped 304 Stainless Steel



Bulk	Display	A	B	C	D	E	F	Fastener	Wt.(lb.)	Std. Pack
201535	201535-1	2-7/8"	1-7/16"	1-7/16"	1-1/2"	1/16"	100°	#8 FH	.11 / .22	10 ea / 10 pr

This Flush Door Hinge features a knuckle that sits below the mounting surface, creating a smooth, flat design perfect for deck surfaces or where lines might snag. In door applications, they fit flush with the frame and are completely invisible in the closed position giving cabinet fronts a sleek, clean look. 100° of motion. Ideal for recessed deck hatches or lids. Constructed of corrosion resistant stamped 304 stainless steel. Installs with six #8 FH fasteners (not included).

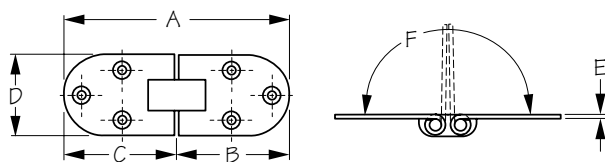
**FLUSH TWO PIN HINGE - LONG**

Stamped 304 Stainless Steel



Bulk	Display	A	B	C	D	E	F	Fastener	Wt.(lb.)	Std. Pack
201550	201550-1	3-1/4"	1-5/8"	1-5/8"	1-3/16"	1/16"	180°	#6 FH	.09 / .18	10 ea / 10 pr

This Long Flush Two Pin Hinge opens 180°, making it ideal for folding tables or doors that must fold back flat. Constructed of corrosion resistant stamped 304 stainless steel. Installs with six #6 FH fasteners (not included).



FLUSH TWO PIN HINGE

Stamped 304 Stainless Steel

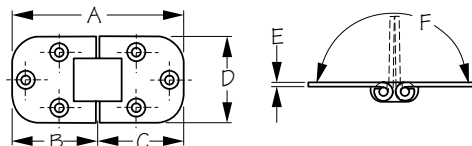

Bulk	Display	A	B	C	D	E	F	Fastener	Wt.(lb.)	Std. Pack
201551	201551-1	3"	1-1/2"	1-1/2"	1-1/2"	1/16"	180°	#8 FH	.13 / .26	10 ea / 10 pr

This Flush Two Pin Hinge opens 180°, making it ideal for folding tables or doors that must fold back flat. Constructed of corrosion resistant stamped 304 stainless steel. Installs with six #8 FH fasteners (not included).



ROUND SIDE TWO PIN HINGE

Stamped 304 Stainless Steel

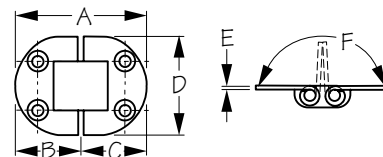

Bulk	Display	A	B	C	D	E	F	Fastener	Wt.(lb.)	Std. Pack
201554	201554-1	2"	1"	1"	1-1/2"	1/16"	180°	#8 FH	.10 / .20	10 ea / 10 pr
201555	201555-1	3"	1-1/2"	1-1/2"	1-1/2"	1/16"	180°	#8 FH	.12 / .24	10 ea / 10 pr

These Round Side Two Pin Hinges opens 180°, making them ideal for folding tables or doors that must fold back flat. Good for use in tight spaces. Constructed of corrosion resistant stamped 304 stainless steel. Installs with #8 FH fasteners (not included).



OFFSET SHORT SIDE DOOR HINGE

Stamped 304 Stainless Steel

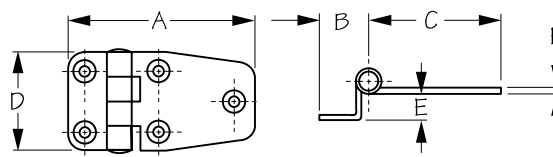

Bulk	Display	A	B	C	D	E	F	Fastener	Wt.(lb.)	Std. Pack
201570	201570-1	2-3/4"	3/4"	2"	1-1/2"	3/8"	1/16"	#8 FH	.12 / .24	10 ea / 10 pr
201572	201572-1	2-1/2"	5/8"	1-7/8"	1-1/2"	3/4"	1/16"	#8 FH	.13 / .26	10 ea / 10 pr

These Offset Short Side Door Hinges are designed to allow more open access by moving the pivot point of the door further away from the hinge. This simple solution provides extra clearance while avoiding the need to create a larger opening by installing a new door frame. Surface mounted on the front side of a raised door, they are used where the hinge does not need to be concealed. Constructed of corrosion resistant 304 stamped stainless steel. Installs with five #8 FH fasteners (not included).



BUTT HINGE

Stamped 304 Stainless Steel

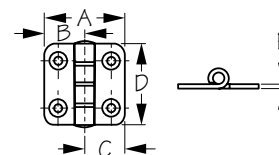

Bulk	Display	A	B	C	D	E	Fastener	Wt.(lb.)	Std. Pack
201580	201580-1	1-3/8"	11/16"	11/16"	1-1/2"	1/16"	#8 FH	.08 / .16	10 ea / 10 pr
201582	201582-1	2"	1"	1"	2"	1/16"	#8 FH	.09 / .18	10 ea / 10 pr

These Butt Hinges consist of two rectangular leaves that attach to the abutting surfaces of a door and door jamb. Usually mortised or recessed into both surfaces they are joined together by a hinge pin. Constructed of corrosion resistant stamped 304 stainless steel. Installs with four #8 FH fasteners (not included).



TAKE-APART HINGE

Stamped 304 Stainless Steel

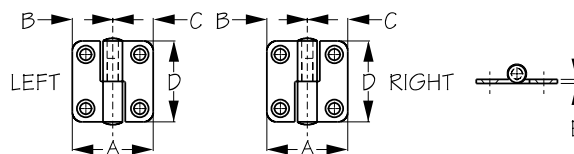

Bulk	Display	A	B	C	D	E	Side	Fastener	Wt.(lb.)	Std. Pack
201585	n/a	1-1/2"	3/4"	3/4"	1-1/2"	1/16"	Right	#10 FH	.07	10 ea
201586	n/a	1-1/2"	3/4"	3/4"	1-1/2"	1/16"	Left	#10 FH	.07	10 ea

Take-Apart Hinges allow a door or lid to be removed after installation without having to remove the fasteners. Designed for situations where occasional removal may be required for easy stowing or cleaning. Constructed of corrosion resistant stamped 304 stainless steel. Installs with four #10 FH fasteners (not included). Right side hinge (201585) pictured.

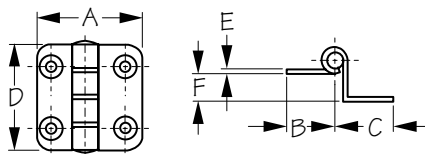
**OFFSET BUTT HINGE**

Stamped 304 Stainless Steel



Bulk	Display	A	B	C	D	E	F	Fastener	Wt.(lb.)	Std. Pack
201590	201590-1	1-1/2"	3/4"	3/4"	1-1/2"	1/16"	3/8"	#8 FH	.09 / .18	10 ea / 10 pr

These Offset Butt Hinges are designed to be mounted on the front surface of a raised door with a 3/8" offset on one side. Constructed of corrosion resistant stamped 304 stainless steel. Installs with four #8 FH fasteners (not included).

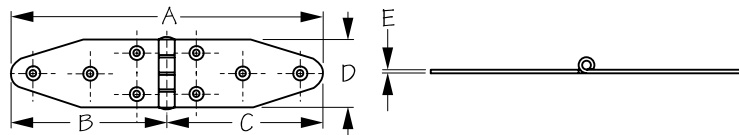
**HEAVY DUTY STRAP HINGE**

Stamped 304 Stainless Steel



Bulk	Display	A	B	C	D	E	Fastener	Wt.(lb.)	Std. Pack
201620	201620-1	7-1/8"	3-9/16"	3-9/16"	1-5/8"	1/16"	#8 FH	.23 / .46	10 ea / 10 pr

This Heavy Duty Strap Hinge consists of two long narrow leaves of equal length extending from a single knuckle. Commonly used for gates, dock box lids, fish holds, etc. They are good for outdoor applications where the hinges will be used frequently. Constructed of corrosion resistant stamped 304 stainless steel. Surface mounted with eight #8 fasteners (not included).

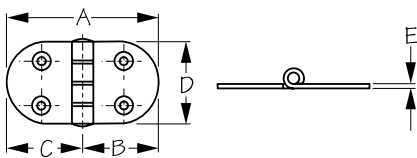
**ROUND SIDE DOOR HINGE - SHORT**

Stamped 304 Stainless Steel



Bulk	Display	A	B	C	D	E	Fastener	Wt.(lb.)	Std. Pack
201700	201700-1	2-3/4"	1-3/8"	1-3/8"	1-1/2"	1/16"	#8 FH	.12 / .24	10 ea / 10 pr

This Short Round Side Door Hinge is ideal for cabinet doors in tight spaces. Constructed of corrosion resistant stamped 304 stainless steel. Installs with four #8 FH fasteners (not included).

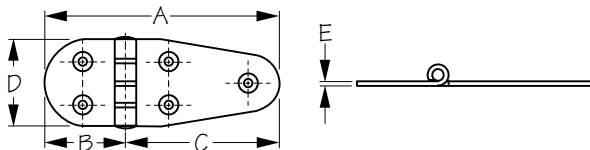
**ROUND SIDE DOOR HINGE - MEDIUM**

Stamped 304 Stainless Steel



Bulk	Display	A	B	C	D	E	Fastener	Wt.(lb.)	Std. Pack
201710	201710-1	4-1/16"	1-3/8"	2-11/16"	1-1/2"	1/16"	#8 FH	.15 / .30	10 ea / 10 pr

This Medium Round Side Door Hinge is ideal for cabinet doors. Constructed of corrosion resistant stamped 304 stainless steel. Installs with five #8 FH fasteners (not included).

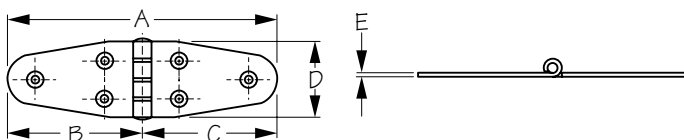
**ROUND SIDE DOOR HINGE - LONG**

Stamped 304 Stainless Steel



Bulk	Display	A	B	C	D	E	Fastener	Wt.(lb.)	Std. Pack
201720	201720-1	5-3/8"	2-11/16"	2-11/16"	1-1/2"	1/16"	#8 FH	.17 / .34	10 ea / 10 pr

This Long Round Side Door Hinge is ideal for cabinet doors. Constructed of corrosion resistant stamped 304 stainless steel. Installs with six #8 FH fasteners (not included).



FLUSH MOUNT ROUND SIDE DOOR HINGE

Stamped 304 Stainless Steel

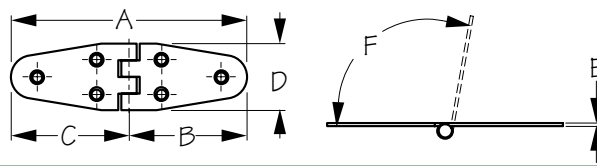

Bulk	Display	A	B	C	D	E	F	Fastener	Wt.(lb.)	Std. Pack
201725	201725-1	5-3/8"	2-11/16"	2-11/16"	1-1/2"	1/16"	100°	#8 FH	.16 / .32	10 ea / 10 pr

This Flush Mount Round Side Door Hinge features a knuckle that sits below the mounting surface, creating a smooth, flat design perfect for deck surfaces or where lines might snag. In door applications, they fit flush with the frame and are completely invisible in the closed position giving cabinet fronts a sleek, clean look. 100° of motion. Ideal for recessed deck hatches or lids. Constructed of corrosion resistant stamped 304 stainless steel. Installs with six #8 FH fasteners (not included).



OFFSET HEAVY DUTY HINGE

Stamped 304 Stainless Steel

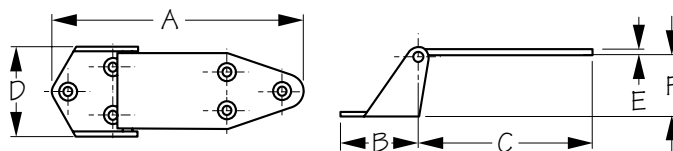

Bulk	Display	A	B	C	D	E	F	Fastener	Wt.(lb.)	Std. Pack
201730	201730-1	5-1/4"	1-5/8"	3-5/8"	1-13/16"	1/16"	1-1/4"	#8 FH	.30 / .60	5 ea / 5 pr

These Offset Heavy Duty Hinges are designed to allow more open access by moving the pivot point of the door further away from the hinge. Designed to be surface mounted on the front side of a raised door. Used in applications where the hinge does not need to be concealed. Constructed of corrosion resistant stamped 304 stainless steel. Installs with six #8 FH fasteners (not included).



SHORT SIDE DOOR HINGE

Stamped 304 Stainless Steel

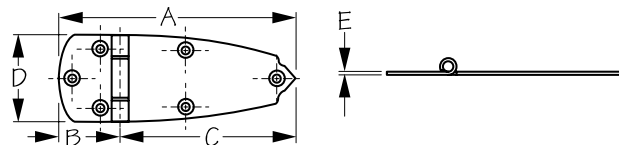

Bulk	Display	A	B	C	D	E	Fastener	Wt.(lb.)	Std. Pack
201750	201750-1	6"	1-1/2"	4-1/2"	2-1/4"	1/16"	#10 FH	.15 / .30	10 ea / 10 pr

This Short Side Door Hinge is great for interior and exterior applications. Designed to be used where mounting space is tight on one side, but added weight would make a longer bracket beneficial on the other. Constructed of corrosion resistant stamped 304 stainless steel. Installs with six #10 FH fasteners (not included).



HEAVY DUTY HINGE

Stamped 304 Stainless Steel

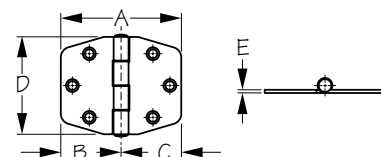

Bulk	Display	A	B	C	D	E	Fastener	Wt.(lb.)	Std. Pack
201800	201800-1	2-7/8"	1-7/16"	1-7/16"	2-3/8"	1/16"	#12 FH	.18 / .36	10 ea / 10 pr
201801	201801-1	2-7/8"	1-7/16"	1-7/16"	2-15/16"	1/16"	#12 FH	.22 / .44	10 ea / 10 pr
201805	201805-1	6"	3"	3"	2-15/16"	1/16"	1/4" FH	.19 / .37	10 ea / 10 pr

These Heavy Duty Hinges are constructed of corrosion resistant stamped 304 stainless steel to withstand the harsh marine environment. Installs with FH fasteners (not included).



PIANO HINGE

Stamped 304 Stainless Steel

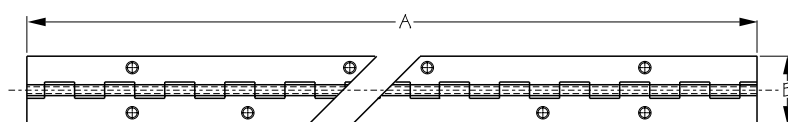

Bulk	Display	A	B	Fastener	Wt.(lb.)	Std. Pack
201850	n/a	36"	1-1/4"	#10 FH	.58	5 ea

This Piano Hinge (or continuous hinge) is used for applications where a longer length is desirable. The longer length affords more surface to hinge connection, allowing heavier weights to be supported with a lighter gauge hinge. Can also be cut to create custom lengths. Constructed of corrosion resistant stamped 304 stainless steel. Installs with #10 FH fasteners (not included).

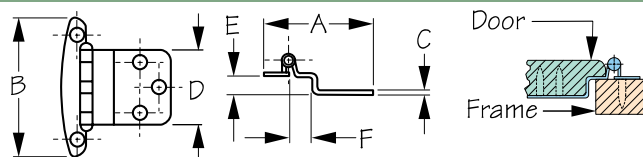
**SEMI-CONCEALED HINGE**

Stamped 304 Stainless Steel or Polished Brass



Bulk	Display	A	B	C	D	E	F	Material	Wt.(lb.)	Std. Pack
201914	201914-1	2-3/16"	2-3/4"	1/16"	1-1/2"	3/8"	1/2"	Stainless	.08 / .16	10 ea / 10 pr
201915	201915-1	2-3/16"	2-3/4"	1/16"	1-1/2"	3/8"	1/2"	Brass	.08 / .16	10 ea / 10 pr
201916	201916-1	2-3/16"	2-3/4"	1/16"	1-1/2"	3/8"	9/16"	Stainless	.08 / .16	10 ea / 10 pr

Semi-Concealed Hinges are mounted on the back surface of a door with a corresponding 3/8" offset mortised into the edge of the door. Constructed of corrosion resistant stamped 304 stainless steel or polished brass. Installs with five #6 RH screws (not included).

⚠ WARNING: Cancer and Reproductive Harm - www.P65Warnings.ca.gov

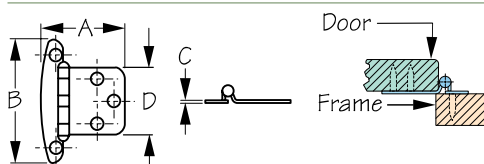
**FLUSH MOUNT CONCEALED HINGE**

Stamped 304 Stainless Steel



Bulk	Display	A	B	C	D	Material	Fastener	Wt.(lb.)	Std. Pack
201954	201954-1	1-7/8"	2-3/4"	1/16"	1-1/2"	Stainless	#6 FH	.03 / .06	10 ea / 10 pr

Flush Mount Concealed Hinges are designed to keep the hinge out of sight when the door is closed. Constructed of corrosion resistant stamped 304 stainless steel. Installs with five #6 FH fasteners (not included).

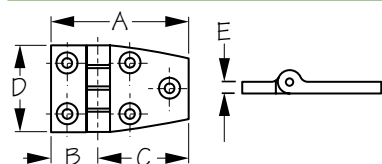
**SHORT SIDE DOOR HINGE**

Injection Molded Fiberglass Nylon/Stainless Steel Pin



Bulk	Display	A	B	C	D	E	Color	Fastener	Wt.(lb.)	Std. Pack
202510	202510-1	2-1/4"	3/4"	1-1/2"	1-3/8"	3/16"	Black	#8 FH	.03 / .06	10 ea / 10 pr
202511	202511-1	2-1/4"	3/4"	1-1/2"	1-3/8"	3/16"	White	#8 FH	.03 / .06	10 ea / 10 pr

These economical Short Side Door Hinges are great for interior and exterior applications such as cabinets, hatches, folding tables, or seats where mounting space is tight. Constructed of UV resistant injection molded fiberglass nylon with a corrosion resistant stainless steel pin. They are practically indestructible! Installs with five #8 FH fasteners (not included). Can be used in conjunction with a Backing Plate (202539) for added rigidity and strength.

- Available in custom colors for large volume orders.

⚠ WARNING: Cancer and Reproductive Harm - www.P65Warnings.ca.gov

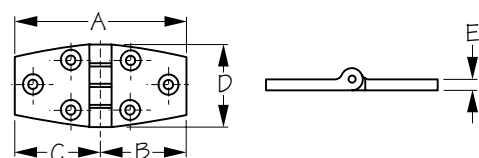
**DOOR HINGE**

Injection Molded Fiberglass Nylon/Stainless Steel Pin



Bulk	Display	A	B	C	D	E	Color	Fastener	Wt.(lb.)	Std. Pack
202530	202530-1	3"	1-1/2"	1-1/2"	1-3/8"	3/16"	Black	#8 FH	.04 / .08	10 ea / 10 pr
202531	202531-1	3"	1-1/2"	1-1/2"	1-3/8"	3/16"	White	#8 FH	.04 / .08	10 ea / 10 pr

These Door Hinges are great for interior and exterior applications. Constructed of UV resistant injection molded fiberglass nylon with a corrosion resistant stainless steel pin. They are practically indestructible! Installs with six #8 FH fasteners (not included). Can be used in conjunction with a Backing Plate (202539) for added rigidity and strength.

- Available in custom colors for large volume orders.

⚠ WARNING: Cancer and Reproductive Harm - www.P65Warnings.ca.gov



BACKING PLATE FOR DOOR HINGE

Injection Molded Fiberglass Nylon

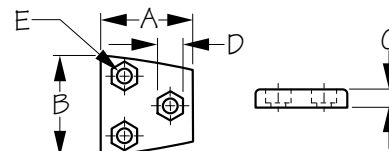

Bulk	Display	A	B	C	D	E	Wt.(lb.)	Std. Pack
202539	n/a	1-1/4"	1-3/8"	1/4"	11/32"	3/16"	.01	20 ea

These Backing Plates are ideal for use on thick hatch covers which may break when using nuts and washers alone. For use where more rigidity and strength are required. Constructed of UV resistant injection molded fiberglass nylon. Installs with three hex nuts. This part can be used with 202510, 202511, 202530, 202531, 205310, & 205350.

- Available in custom colors for large volume orders.

WARNING: Cancer and Reproductive Harm - www.P65Warnings.ca.gov



BUTT HINGE

Injection Molded Fiberglass Nylon/Stainless Steel Pin

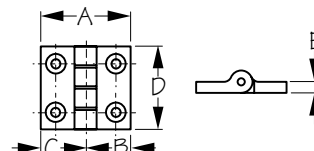

Bulk	Display	A	B	C	D	E	Color	Fastener	Wt.(lb.)	Std. Pack
202580	202580-1	1-1/2"	3/4"	3/4"	1-3/8"	3/16"	Black	#8 FH	.03 / .06	10 ea / 10 pr
202581	202581-1	1-1/2"	3/4"	3/4"	1-3/8"	3/16"	White	#8 FH	.03 / .06	10 ea / 10 pr

These Butt Hinges consist of two rectangular leaves that attach to the abutting surfaces of a door and door jamb. Usually mortised or recessed into both surfaces, they are joined together by a hinge pin. Constructed of UV resistant injection molded fiberglass nylon with a corrosion resistant stainless steel pin. Installs with four #8 FH fasteners (not included).

- Available in custom colors for large volume orders.

WARNING: Cancer and Reproductive Harm - www.P65Warnings.ca.gov



TAKE-APART HINGE

Forged Brass Chrome Plated

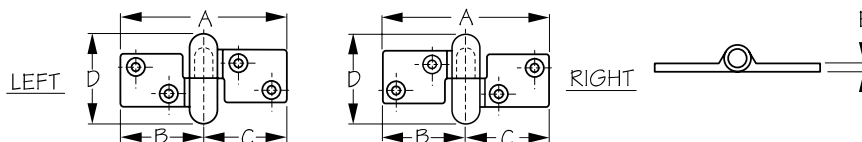

Bulk	Display	A	B	C	D	E	Side	Fastener	Wt.(lb.)	Std. Pack
204278	204278-1	3-7/8"	1-15/16"	1-15/16"	2"	3/16"	Left	#10 FH	.36 / .72	10 ea / 10 pr
204279	204279-1	3-7/8"	1-15/16"	1-15/16"	2"	3/16"	Right	#10 FH	.36 / .72	10 ea / 10 pr

These Take-Apart Hinges allow a door or lid to be removed after installation without having to remove the fasteners. Designed for situations where occasional removal may be required for easy stowing or cleaning. These chrome plated forged brass hinges can be used horizontally or vertically. Surface mounts with four #10 FH fasteners (not included). Left side hinge (204278) pictured.

WARNING: Cancer and Reproductive Harm - www.P65Warnings.ca.gov



HATCH HINGE

Forged Brass Chrome Plated

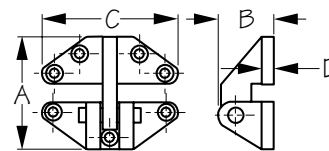

Bulk	Display	A	B	C	D	Fastener	Wt.(lb.)	Std. Pack
204280	204280-1	2-1/2"	1-1/4"	3"	1/4"	#10 FH	.55	10 ea
0P20401	n/a	Replacement Clevis Pin and Split Ring						10 ea

Heavy Duty Hatch Hinge features a removable clevis pin with split ring for easy separation. Designed with stop to hold hatch in upright position when open. Constructed of chrome plated forged brass for corrosion resistance and durability. Installs with seven #10 FH fasteners (not included). Sold Individually.

WARNING: Cancer and Reproductive Harm - www.P65Warnings.ca.gov

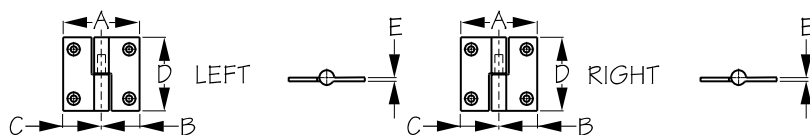
**TAKE-APART BUTT HINGE**

Cast Brass or Chrome Plated Brass



Bulk	Display	A	B	C	D	E	Finish	Side	Wt.(lb.)	Std. Pack
204510	204510-1	1-1/2"	3/4"	3/4"	1-1/2"	1/16"	Chrome	Right	.07 / .14	10 ea / 10 pr
204511	204511-1	1-1/2"	3/4"	3/4"	1-1/2"	1/16"	Brass	Right	.07 / .14	10 ea / 10 pr
204515	204515-1	1-1/2"	3/4"	3/4"	2"	1/16"	Chrome	Right	.09 / .18	10 ea / 10 pr
204516	204516-1	1-1/2"	3/4"	3/4"	2"	1/16"	Brass	Right	.09 / .18	10 ea / 10 pr
204520	204520-1	1-1/2"	3/4"	3/4"	2-3/4"	1/16"	Chrome	Right	.14 / .28	10 ea / 10 pr
204521	204521-1	1-1/2"	3/4"	3/4"	2-3/4"	1/16"	Brass	Right	.14 / .28	10 ea / 10 pr
204510L	204510L-1	1-1/2"	3/4"	3/4"	1-1/2"	1/16"	Chrome	Left	.07 / .14	10 ea / 10 pr
204511L	204511L-1	1-1/2"	3/4"	3/4"	1-1/2"	1/16"	Brass	Left	.07 / .14	10 ea / 10 pr
204515L	204515L-1	1-1/2"	3/4"	3/4"	2"	1/16"	Chrome	Left	.09 / .18	10 ea / 10 pr
204516L	204516L-1	1-1/2"	3/4"	3/4"	2"	1/16"	Brass	Left	.09 / .18	10 ea / 10 pr
204520L	204520L-1	1-1/2"	3/4"	3/4"	2-3/4"	1/16"	Chrome	Left	.14 / .28	10 ea / 10 pr
204521L	204521L-1	1-1/2"	3/4"	3/4"	2-3/4"	1/16"	Brass	Left	.14 / .28	10 ea / 10 pr

Take-Apart Butt Hinges allow a door or lid to be removed after installation without having to remove the fasteners. Designed for situations where occasional removal may be required for easy stowing or cleaning. Great for use on hatches, doors, dining table leaves, engine covers, chart tables, & ladders. Can be used horizontally or vertically. Use two left hand or two right hand hinges for quick removal, no tools required, or use a left and a right together as a heavy duty non-take-apart hinge set. Constructed of cast brass with a plain polished or chrome plated finish. Surface mounts with #6 FH fasteners (not included). Right side hinges pictured. 204510(L) & 204511(L) have 4 holes, 204515(L) & 204516(L) have 6 holes, and 204520(L) & 204521(L) have 8 holes.

⚠ **WARNING:** Cancer and Reproductive Harm - www.P65Warnings.ca.gov

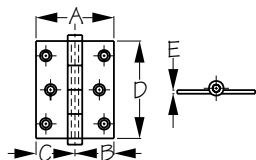
**REMOVABLE PIN BUTT HINGE**

Cast Brass or Chrome Plated Brass



Bulk	Display	A	B	C	D	E	Finish	Holes	Wt.(lb.)	Std. Pack
204610	n/a	1-5/8"	13/16"	13/16"	1-5/8"	1/16"	Chrome	4	.08	10 ea
204611	n/a	1-5/8"	13/16"	13/16"	1-5/8"	1/16"	Brass	4	.08	10 ea
204620	204620-1	2"	1"	1"	2"	1/16"	Chrome	4	.13 / .26	10 ea / 10 pr
204621	204621-1	2"	1"	1"	2"	1/16"	Brass	4	.13 / .26	10 ea / 10 pr
204630	204630-1	2-1/2"	1-1/4"	1-1/4"	2-1/2"	1/16"	Chrome	6	.25 / .50	10 ea / 10 pr
204631	204631-1	2-1/2"	1-1/4"	1-1/4"	2-1/2"	1/16"	Brass	6	.25 / .50	10 ea / 10 pr

These Removable Pin Butt Hinges are designed to be mortised in for a flush installation between door and door jamb. They feature a removable pin for applications where occasional removal may be required for easy stowing or cleaning. Constructed of cast brass with a plain polished or chrome plated finish. Installs with either four #6 or six #8 FH fasteners (not included). 204610, 204611, 204620, and 204621 use #6 fasteners. 204630 and 204631 use #8 fasteners.

⚠ **WARNING:** Cancer and Reproductive Harm - www.P65Warnings.ca.gov

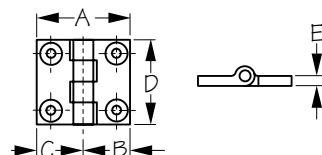
**BUTT HINGE**

Investment Cast 316 Stainless Steel



Bulk	Display	A	B	C	D	E	Fastener	Wt.(lb.)	Std. Pack
205140	205140-1	1-5/8"	13/16"	13/16"	1-1/2"	3/16"	#10 FH	.04 / .08	10 ea / 10 pr
205142	205142-1	1-15/16"	15/16"	15/16"	1-15/16"	3/16"	#10 FH	.06 / .12	10 ea / 10 pr

These Butt Hinges consist of two rectangular leaves that attach to the abutting surfaces of a door and door jamb. They are usually mortised in and joined together by a hinge pin. Constructed of corrosion resistant investment cast 316 stainless steel. Installs with four #10 FH fasteners (not included).



HEAVY DUTY BUTT HINGE - TOP PIN/COMMERCIAL PATTERN

Investment Cast 316 Stainless Steel

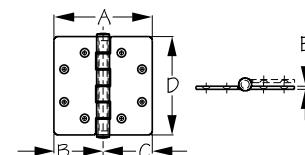

Bulk	Display	A	B	C	D	E	Fastener	Wt.(lb.)	Std. Pack
205225	n/a	4"	2"	2"	4-1/2"	3/16"	1/4" FH	1.50	2 ea
205227	n/a	5-1/2"	2-3/4"	2-3/4"	4-1/2"	3/16"	1/4" FH	1.75	2 ea

These Heavy Duty Butt Hinges with Top Pins are designed for applications where extra strength is required. The integral nylon bearings promote rattle-free, silent movement and give the hinge a smoother action. Commercial ANSI template screw hole pattern. Constructed of corrosion resistant investment cast 316 stainless steel. Installs with eight 1/4" FH fasteners (not included).



HEAVY DUTY BUTT HINGE - TOP PIN

Investment Cast 316 Stainless Steel

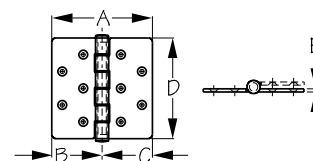

Bulk	Display	A	B	C	D	E	Fastener	Wt.(lb.)	Std. Pack
205228	n/a	6"	3"	3"	6"	3/16"	1/4" FH	2.05	2 ea

This Heavy Duty Butt Hinge with Top Pin is designed for applications where extra strength is required. The integral nylon bearings promote silent, rattle-free movement and give the hinge a smoother action. Constructed of corrosion resistant investment cast 316 stainless steel. Installs with ten 1/4" FH fasteners (not included).



HEAVY DUTY BUTT HINGE - TOP PIN W/ADJUSTMENT SLOTS

Investment Cast 316 Stainless Steel

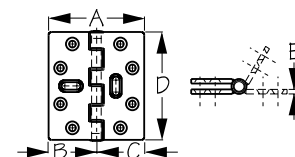

Bulk	Display	A	B	C	D	E	Fastener	Wt.(lb.)	Std. Pack
205225C1	n/a	4"	2"	2"	4-1/2"	3/16"	1/4" FH	1.50	2 ea

This Heavy Duty Butt Hinge with Top Pin is designed for applications where extra strength is required. The integral nylon bearings promote silent, rattle-free movement and give the hinge a smoother action. Slots used for adjustment purposes. Constructed of corrosion resistant investment cast 316 stainless steel. Installs with ten 1/4" FH fasteners (not included).



HEAVY DUTY BUTT HINGE - CENTER PIN/COMMERCIAL PATTERN

Investment Cast 316 Stainless Steel

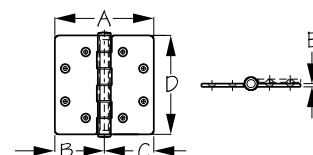

Bulk	Display	A	B	C	D	E	Fastener	Wt.(lb.)	Std. Pack
205235	n/a	4"	2"	2"	4-1/2"	3/16"	1/4" FH	1.50	2 ea
205237	n/a	5-1/2"	2-3/4"	2-3/4"	4-1/2"	3/16"	1/4" FH	1.75	2 ea

These Heavy Duty Butt Hinges with Center Pins are designed to fold flat. For applications where extra strength is required. The integral nylon bearings promote rattle-free, silent movement and give the hinge a smoother action. Commercial ANSI template screw hole pattern. Constructed of corrosion resistant investment cast 316 stainless steel. Installs with eight 1/4" FH fasteners (not included).



HEAVY DUTY BUTT HINGE - CENTER PIN

Investment Cast 316 Stainless Steel

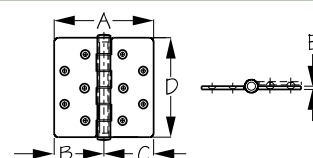

Bulk	Display	A	B	C	D	E	Fastener	Wt.(lb.)	Std. Pack
205238	n/a	6"	3"	3"	6"	3/16"	1/4" FH	2.29	2 ea

This Heavy Duty Butt Hinge with Center Pin is designed to fold flat. For applications where extra strength is required. The integral nylon bearings promote rattle-free, silent movement and give the hinge a smoother action. Constructed of corrosion resistant investment cast 316 stainless steel. Installs with ten 1/4" FH fasteners (not included).

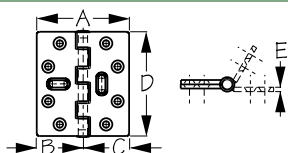
**HEAVY DUTY BUTT HINGE - CENTER PIN W/ ADJUSTMENT SLOTS**

Investment Cast 316 Stainless Steel



Bulk	Display	A	B	C	D	E	Fastener	Wt.(lb.)	Std. Pack
205236C1	n/a	4-3/4"	2-3/8"	2-3/8"	6"	3/16"	1/4" FH	2.00	2 ea

This Heavy Duty Butt Hinge with Center Pin is designed to fold flat. Slots used for adjustment purposes. For applications where extra strength is required. The integral nylon bearings promote rattle-free, silent movement and give the hinge a smoother action. Constructed of corrosion resistant investment cast 316 stainless steel. Installs with ten 1/4" FH fasteners (not included).

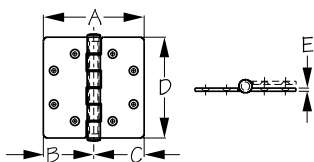
**BUTT HINGE WITH BEARINGS/COMMERCIAL PATTERN**

Investment Cast 316 Stainless Steel

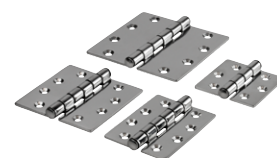

Bulk	Display	A	B	C	D	E	Fastener	Wt.(lb.)	Std. Pack
205242	n/a	3"	1-1/2"	1-1/2"	3"	1/8"	1/4" FH	.50	2 ea
205243	n/a	3"	1-1/2"	1-1/2"	4"	1/8"	1/4" FH	.57	2 ea
205244	n/a	4"	2"	2"	4"	1/8"	1/4" FH	.72	2 ea
205246	n/a	5"	2-1/2"	2-1/2"	5"	1/8"	1/4" FH	1.07	2 ea

These Butt Hinges with Bearings are designed to disburse weight, compensating for heavier doors and increased use. For applications where extra strength is required. The integral nylon bearings promote rattle-free, silent movement and give the hinge a smoother action. Commercial ANSI template screw hole pattern. Constructed of corrosion resistant investment cast 316 stainless steel. Installs with eight 1/4" FH fasteners (not included).

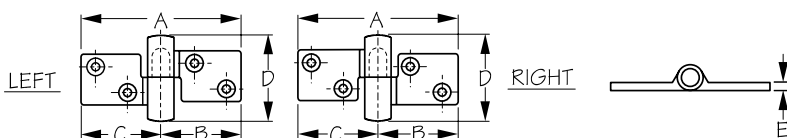
**TAKE-APART HINGE**

Investment Cast 316 Stainless Steel



Bulk	Display	A	B	C	D	E	Side	Fastener	Wt.(lb.)	Std. Pack
205270	205270-1	3-1/2"	1-3/4"	1-3/4"	2"	3/16"	Left	#10 FH	.45 / .90	10 ea / 10 pr
205275	205275-1	3-1/2"	1-3/4"	1-3/4"	2"	3/16"	Right	#10 FH	.45 / .90	10 ea / 10 pr

Take-Apart Hinges allow a door or lid to be removed after installation without having to remove the fasteners. Designed for applications where occasional removal may be required for easy stowing or cleaning. Can be used horizontally or vertically. Constructed of corrosion resistant investment cast 316 stainless steel. Surface mounts with four #10 FH fasteners (not included). Left side hinge (205270) pictured.

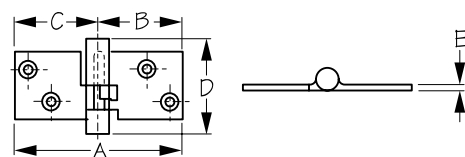
**LOCKING TAKE-APART HINGE**

Investment Cast 316 Stainless Steel



Bulk	Display	A	B	C	D	E	Side	Fastener	Wt.(lb.)	Std. Pack
205276	n/a	3-1/2"	1-3/4"	1-3/4"	2"	1/8"	Left	#10 FH	.23	10 ea

Locking Take-Apart Hinge is left sided only. Designed for a door or lid to be removed when in the fully open (folded back) position without removing fasteners. For applications where occasional removal may be required for easy stowing or cleaning. Constructed of corrosion resistant investment cast 316 stainless steel. Installs with four #10 FH fasteners (not included).

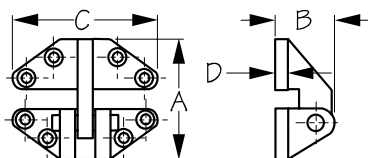
**HATCH HINGE**

Investment Cast 316 Stainless Steel



Bulk	Display	A	B	C	D	Fastener	Wt.(lb.)	Std. Pack
205280	205280-1	2-5/8"	1-1/4"	2-7/8"	1/4"	#10 FH	.60	10 ea
OP20501	n/a	Replacement Clevis Pin and Split Ring						.02 10 ea

Heavy duty Hatch Hinge features a removable clevis pin with split ring for easy separation. Includes stop to hold hatch in upright position when open. Constructed of corrosion resistant investment cast 316 stainless steel. Installs with eight #10 FH fasteners (not included). Sold Individually.



HATCH HINGE WITH REMOVABLE PIN

Investment Cast 316 Stainless Steel

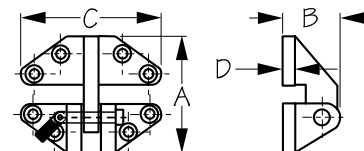

Bulk	Display	A	B	C	D	Fastener	Wt.(lb.)	Std. Pack
205280R	n/a	2-5/8"	1-1/4"	2-7/8"	1/4"	#10 FH	.61	10 ea
OP20502	n/a	Replacement Removable Pin					.04	10 ea

Heavy duty Hatch Hinge features a quick release removable pin for easy separation. Includes stop to hold hatch in upright position when open. Constructed of investment cast 316 stainless steel for corrosion resistance and durability. Installs with eight #10 FH fasteners (not included). Sold Individually. Removable pin (OP20502) fits all Sea-Dog® hatch hinges.



ANGLE BASE HATCH HINGE

Investment Cast 316 Stainless Steel

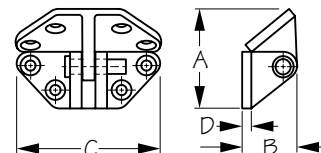

Bulk	Display	A	B	C	D	Fastener	Wt.(lb.)	Std. Pack
205282	205282-1	2-1/16"	1-1/8"	2-15/16"	3/16"	#10 FH	.41	10 ea
OP20501	n/a	Replacement Clevis Pin and Split Ring					.02	10 ea

Heavy duty Angle Base Hatch Hinge features a removable clevis pin with split ring for easy separation. For use where a hinge is needed in a variable angle. Constructed of corrosion resistant investment cast 316 stainless steel. Installs with eight #10 FH fasteners (not included). Sold Individually.



LONG REACH HATCH HINGE

Investment Cast 316 Stainless Steel

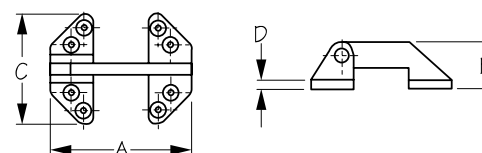

Bulk	Display	A	B	C	D	Fastener	Wt.(lb.)	Std. Pack
205285	205285-1	3-1/2"	1-1/4"	2-7/8"	1/4"	#10 FH	.62	10 ea
OP20501	n/a	Replacement Clevis Pin and Split Ring					.02	10 ea

Heavy duty Long Reach Hatch Hinges feature a removable clevis pin with split ring for easy separation. Particularly suited for wider doors or hatches where a greater spread is required. Constructed of corrosion resistant investment cast 316 stainless steel. Installs with eight #10 FH fasteners (not included). Sold Individually.



LADDER HINGE

Investment Cast 316 Stainless Steel

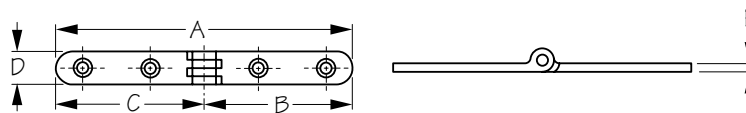

Bulk	Display	A	B	C	D	E	Fastener	Wt.(lb.)	Std. Pack
205290	205290-1	6-11/16"	3-11/32"	3-11/32"	3/4"	3/16"	1/4" FH	.28 / .56	10 ea / 10 pr

This Ladder Hinge is designed for boat ladders, but may be used anywhere a long hinge with a strong hinge knuckle is needed. Constructed of corrosion resistant investment cast 316 stainless steel. Installs with four 1/4" FH fasteners (not included).



SHORT SIDE DOOR HINGE

Investment Cast 316 Stainless Steel

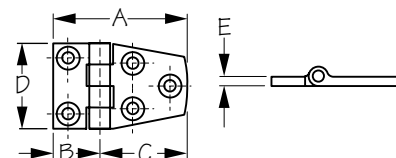

Bulk	Display	A	B	C	D	E	Fastener	Wt.(lb.)	Std. Pack
205310	205310-1	2-3/8"	7/8"	1-1/2"	1-1/2"	3/16"	#10 FH	.16 / .32	10 ea / 10 pr
205320	205320-1	2-7/8"	3/4"	2-1/8"	1-1/2"	3/16"	#10 FH	.18 / .36	10 ea / 10 pr

These Short Side Door Hinges are great for interior and exterior applications such as cabinets, hatches, folding tables, or seats where mounting space is tight. Constructed of corrosion resistant investment cast 316 stainless steel. They are practically indestructible! Installs with five #10 FH fasteners (not included). 205310 can be used in conjunction with Backing Plate (205339) for added rigidity and strength.

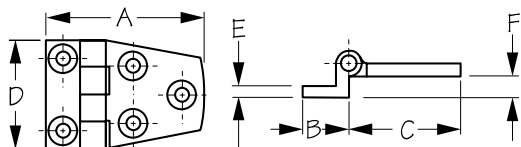
**OFFSET DOOR HINGE**

Investment Cast 316 Stainless Steel



Bulk	Display	A	B	C	D	E	F	Fastener	Wt.(lb.)	Std. Pack
205350	205350-1	2-1/8"	5/8"	1-1/2"	1-1/2"	3/16"	5/16"	#10 FH	.16 / .32	10 ea / 10 pr

This Offset Door Hinge features one side with a 5/16" offset and is designed to be mounted on the front surface of a raised door. Constructed of corrosion resistant investment cast 316 stainless steel. Installs with five #10 FH fasteners (not included). Can be used in conjunction with Backing Plate (20539) for added strength and rigidity.

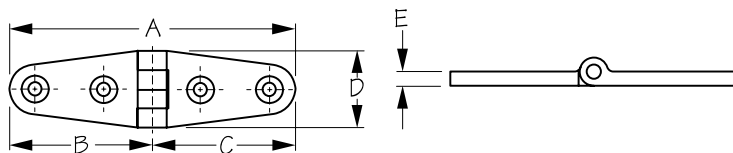
**STRAP HINGE**

Investment Cast 316 Stainless Steel



Bulk	Display	A	B	C	D	E	Fastener	Wt.(lb.)	Std. Pack
205390	205390-1	4-1/8"	2-1/16"	2-1/16"	1"	3/16"	#10 FH	.16 / .32	10 ea / 10 pr
205400	205400-1	5-7/8"	2-15/16"	2-15/16"	1-1/8"	3/16"	#10 FH	.27 / .54	10 ea / 10 pr

These Strap Hinges Consist of two long, narrow leaves of equal length extending from a single knuckle. Commonly used for gates, dock box lids, fish holds, etc. They are good for outdoor applications where the hinges will be in frequent use. Constructed of corrosion resistant investment cast 316 stainless steel. Surface mounts with four #10 fasteners (not included).

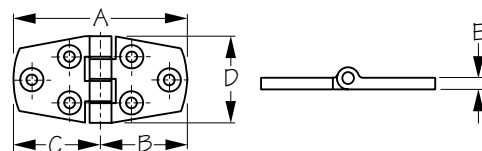
**DOOR HINGE**

Investment Cast 316 Stainless Steel



Bulk	Display	A	B	C	D	E	Fastener	Wt.(lb.)	Std. Pack
205410	205410-1	3"	1-1/2"	1-1/2"	1-1/2"	3/16"	#10 FH	.22 / .44	10 ea / 10 pr
205420	205420-1	4-1/8"	2-1/16"	2-1/16"	1-1/2"	3/16"	#10 FH	.27 / .54	10 ea / 10 pr

These Door Hinges are constructed of corrosion resistant investment cast 316 stainless steel. Installs with six #10 FH fasteners (not included). 205420 pictured.

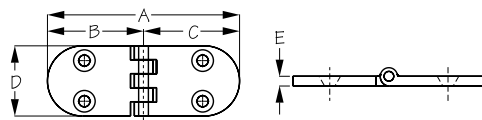
**ROUND DOOR HINGE**

Investment Cast 316 Stainless Steel



Bulk	Display	A	B	C	D	E	Fastener	Wt.(lb.)	Std. Pack
205460	n/a	3-1/4"	1-5/8"	1-5/8"	1-3/16"	3/16"	#10 FH	.16	10 ea

This Round Door Hinge is constructed of corrosion resistant investment cast 316 stainless steel. Installs with four #10 FH fasteners (not included).

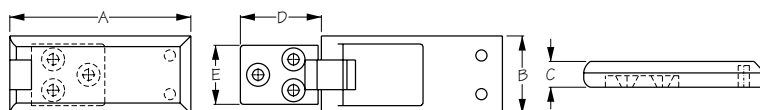
**HIDDEN FASTENER HINGE**

Investment Cast 316 Stainless Steel



Bulk	Display	A	B	C	D	E	Fastener	Wt.(lb.)	Std. Pack
205520	n/a	1-3/4"	1-3/16"	3/8"	9/16"	15/16"	#8 FH	.14	10 ea
205540	n/a	2-3/4"	1-3/16"	3/8"	1-1/4"	15/16"	#8 FH	.18	10 ea

These Hidden Fastener Hinges mount from the underside of the hatch for a clean, smooth look. Constructed of corrosion resistant investment cast 316 stainless steel. Installs with five #8 FH fasteners (not included).



T-HINGE

Investment Cast 316 Stainless Steel

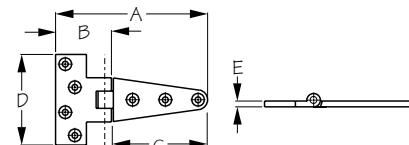

Bulk	Display	A	B	C	D	E	Fastener	Wt.(lb.)	Std. Pack
205705	205705-1	4"	1-1/2"	2-1/2"	2-3/8"	1/8"	#8 FH	.17 / .34	10 ea / 10 pr
205710	205710-1	6"	1-3/4"	4-1/4"	3-1/8"	1/8"	#10 FH	.37 / .74	10 ea / 10 pr

A T-Hinge is a hybrid combination between a butt and strap hinge. The horizontal part of the T goes on the frame, while the vertical part is fastened to the door or cabinet and is visible when closed. This highly decorative and functional hinge is flush mounted (not recessed) and can be used on doors, cabinets, dock boxes, ice chests, etc. Constructed of corrosion resistant investment cast 316 stainless steel. Installs with seven FH fasteners (not included).

DOOR HINGE

Die Cast Zinc Chrome Plated

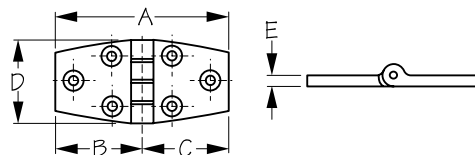

Bulk	Display	A	B	C	D	E	Fastener	Wt.(lb.)	Std. Pack
206530	206530-1	2-7/8"	1-7/16"	1-7/16"	1-1/2"	3/16"	#8 FH	.10 / .20	10 ea / 10 pr

This Door Hinge is an economical option. Constructed of chrome plated die cast zinc. Installs with six #8 FH fasteners (not included). Recommended for freshwater applications.

⚠ WARNING: Cancer and Reproductive Harm - www.P65Warnings.ca.gov

LIFT GATE BUTT HINGE

Aluminum

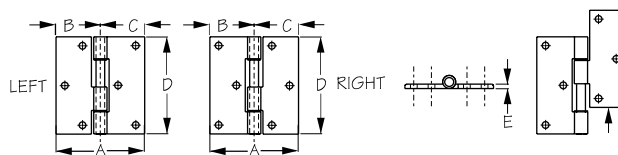

Bulk	Display	A	B	C	D	E	Side	Fastener	Wt.(lb.)	Std. Pack
207730	207730-1	2-1/2"	1-1/4"	1-1/4"	2-3/4"	1/8"	Left	#10 RH	.11 / .22	10 ea / 10 pr
207735	207735-1	2-1/2"	1-1/4"	1-1/4"	2-3/4"	1/8"	Right	#10 RH	.11 / .22	10 ea / 10 pr

This Lift Gate Butt Hinge is constructed of aluminum with nylon washers for quiet movement and smooth operation. Installs with six #10 RH fasteners (not included).

ANTI-RATTLE LATCH

Investment Cast 316 Stainless Steel

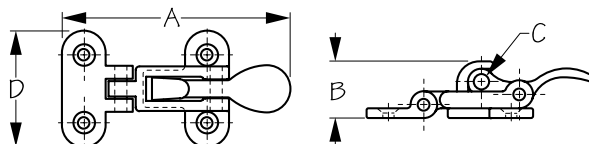

Bulk	Display	A	B	C	D	Fastener	Wt.(lb.)	Std. Pack
221100	221100-1	3"	3/4"	1/4"	1-1/2"	#10 FH	.15	10 ea / 5 ea

Anti-Rattle Latch features an open-mount, center-tensioning cam latch for a tight, no-rattle seal. Ideal for cabinets, doors, and hatches. Latch also features a locking hole that will accept a padlock with up to a 1/4" diameter shank. Constructed of corrosion resistant investment cast 316 stainless steel. Surface mounts with four #10 FH fasteners (not included).

HASP

Stamped 304 Stainless Steel

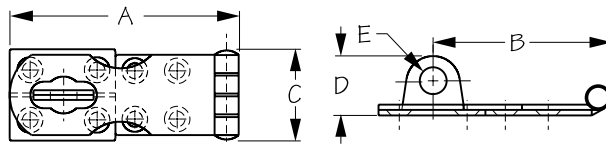

Bulk	Display	A	B	C	D	E	Fastener	Wt.(lb.)	Std. Pack
221120	221120-1	2-11/16"	2-1/16"	1-1/16"	11/16"	5/16"	#6 FH	.09	10 ea
221124	221124-1	3-11/16"	3-1/16"	1-1/16"	11/16"	5/16"	#6 FH	.11	10 ea
221126	221126-1	4-1/2"	3-7/8"	1-1/16"	11/16"	5/16"	#6 FH	.13	10 ea

These Hasps are designed with a slotted plate that fits over a fixed post. Prevents removal when used in conjunction with a padlock. For added security, all mounting screws are concealed when hasp is closed. Ideal for use on doors, cabinets, dock boxes, and lockers. Constructed of corrosion resistant stamped 304 stainless steel. Installs with eight #6 FH fasteners (not included).

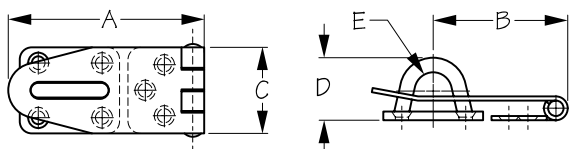
**HEAVY DUTY HASP**

Stamped 304 Stainless Steel



Bulk	Display	A	B	C	D	E	Fastener	Wt.(lb.)	Std. Pack
221127	221127-1	2-11/16"	1-7/8"	1-3/16"	7/8"	1/2"	#6 FH	.13	10 ea
221128	221128-1	3-9/16"	2-3/4"	1-3/16"	7/8"	1/2"	#6 FH	.15	10 ea

These Heavy Duty Hasps are designed with a slotted plate that fits over a fixed post. Prevents removal when used in conjunction with a padlock. For added security, all mounting screws are concealed when hasp is closed. Ideal for securing lockers, cupboards, chests, or hatch doors. Constructed of corrosion resistant stamped 304 stainless steel. Installs with seven #6 FH fasteners (not included).

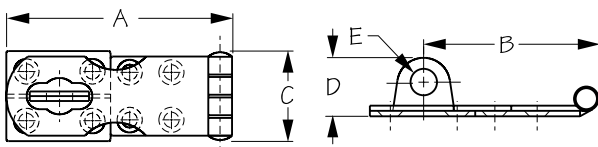
**SWIVEL HASP**

Stamped 304 Stainless Steel



Bulk	Display	A	B	C	D	E	Fastener	Wt.(lb.)	Std. Pack
221130	221130-1	2-11/16"	2-1/16"	1-1/16"	7/8"	5/16"	#8 FH	.11	10 ea

This Swivel Hasp is designed with a slotted plate that fits over a swivel pad eye. The swivel eye rotates acting as a temporary lock, but will accept padlocks with up to a 5/16" bail for more permanent protection. For added security, all mounting screws are concealed when hasp is closed. Ideal for use on doors, cabinets, dock boxes, and lockers. Constructed of corrosion resistant stamped 304 stainless steel. Installs with eight #8 FH fasteners (not included).

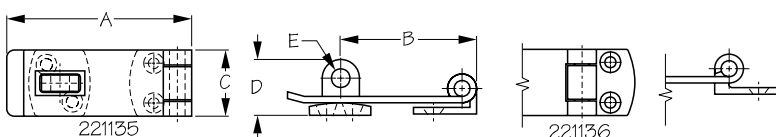
**HEAVY DUTY SWIVEL HASP**

Stamped 304 Stainless Steel



Bulk	Display	A	B	C	D	E	Style	Fastener	Wt.(lb.)	Std. Pack
221135	221135-1	3-1/8"	2-5/16"	1-1/8"	15/16"	5/16"	Flush	#8 FH	.21	10 ea
221136	221136-1	3-1/8"	2-5/16"	1-1/8"	15/16"	5/16"	Angle	#8 FH	.21	10 ea

These Heavy Duty Swivel Hasps are designed with a slotted plate that fits over a swivel pad eye. The swivel eye rotates acting as a temporary lock, but will also accept most padlocks for more permanent protection. Flush mounting plate is hidden when hasp is closed. Ideal for securing lockers, cupboards, chests, or hatch doors. Constructed of corrosion resistant stamped 304 stainless steel. Installs with four #8 FH fasteners (not included).

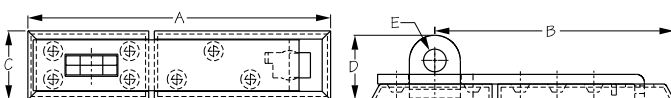
**HEAVY DUTY STRAIGHT BAR HASP**

Stamped 304 Stainless Steel



Bulk	Display	A	B	C	D	E	Fastener	Wt.(lb.)	Std. Pack
221140	n/a	7-1/2"	5-15/16"	1-11/16"	1-5/8"	9/16"	1/4" FH	.92	1 ea

This Heavy Duty Straight Bar Hasp features a stainless steel staple that resists cutting, sawing, and hammering. Fixed eye will accept padlocks with up to a 7/16" bail. Hasp body conceals mounting hardware. Constructed of corrosion resistant stamped 304 stainless steel. Installs with seven 1/4" FH fasteners (not included).

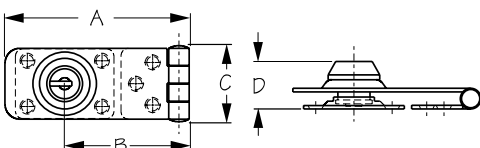
**LOCKING HASP**

Stamped 304 Stainless Steel

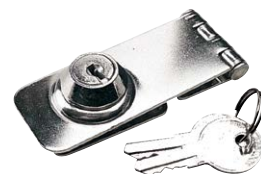

Bulk	Display	A	B	C	D	Fastener	Wt.(lb.)	Std. Pack
221150	221150-1	3-1/8"	2-1/8"	1-1/4"	3/4"	#8 FH	.19	10 ea
221155	221155-1	4-1/8"	3-1/8"	1-1/4"	3/4"	#8 FH	.21	10 ea
OP22102	OP22102-1	Blank Key					.01	1 ea

These Locking Hasps are designed with a locking mechanism which requires the key to actuate, preventing lock out. Functions as a conventional hasp when key is not in use. Comes with two matching keys. Random key availability only from hasp to hasp. For added security, all mounting screws are concealed when hasp is closed. Ideal for securing lockers, cupboards, chests, or hatches. Constructed of corrosion resistant stamped 304 stainless steel. Installs with seven #8 FH fasteners (not included).



HEAVY DUTY ANGLED PADLOCK EYE

Stamped 304 Stainless Steel

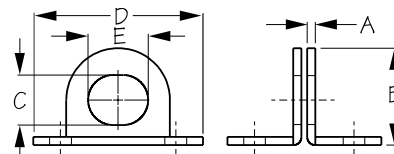

Bulk	Display	A	B	C	D	E	Fastener	Wt.(lb.)	Std. Pack
221160	221160-1	1/8"	1-1/4"	5/8"	2-1/8"	3/4"	1/4" RH	.15	5 pr

When used with a padlock, this Heavy Duty 90° Angled Padlock Eye adds extra security anywhere. Accepts padlocks with a 3/4" bail or less. Constructed of corrosion resistant stamped 304 stainless steel. Installs with four 1/4" RH fasteners (not included).



HEAVY DUTY STRAIGHT PADLOCK EYE

Stamped 304 Stainless Steel

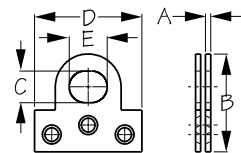

Bulk	Display	A	B	C	D	E	Fastener	Wt.(lb.)	Std. Pack
221165	n/a	1/8"	1-15/16"	5/8"	2-1/8"	3/4"	1/4" FH	.12	5 pr

When used with a padlock, this Heavy Duty Straight Padlock Eye adds extra security anywhere. Accepts padlocks with a 3/4" bail or less. Constructed of corrosion resistant stamped 304 stainless steel. Installs with six 1/4" FH fasteners (not included).



DOOR HOOK

Machined 304 Stainless Steel

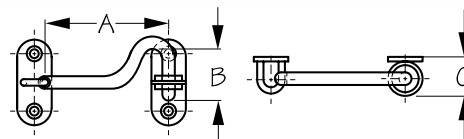

Bulk	Display	A	B	C	Fastener	Wt.(lb.)	Std. Pack
221202	221202-1	2-3/8"	1"	11/16"	#8 FH	.09	10 ea
221203	221203-1	3-1/4"	1"	11/16"	#8 FH	.10	10 ea
221204	221204-1	3-15/16"	1"	11/16"	#8 FH	.11	10 ea
221209	n/a	Replacement Staple				.02	10 ea

These hook-and-eye style cabin Door Hooks feature a unique rubber bushing that prevents accidental unhooking due to vibration and reduces most of the rattling and noise common in other door hooks. Constructed of corrosion resistant machined AISI 304 stainless steel. Surface mounts with four #8 FH fasteners (not included).

⚠ WARNING: Cancer and Reproductive Harm - www.P65Warnings.ca.gov



TWO STAPLE DOOR HOOK

Machined 304 Stainless Steel

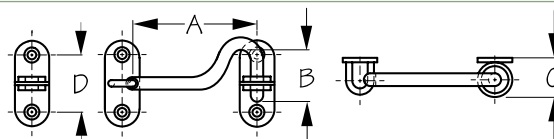

Bulk	Display	A	B	C	D	Fastener	Wt.(lb.)	Std. Pack
n/a	221206-1	2-3/8"	1"	11/16"	1-1/16"	#8 FH	.10	10 ea
n/a	221207-1	3-1/4"	1"	11/16"	1-1/16"	#8 FH	.11	10 ea
n/a	221208-1	3-15/16"	1"	11/16"	1-1/16"	#8 FH	.12	10 ea
221209	n/a	Replacement Staple					.02	10 ea

These hook-and-eye style Two Staple Door Hooks feature a unique rubber bushing that prevents accidental unhooking due to vibration and reduces most of the rattling and noise common in other door hooks. Extra staple can be mounted to secure the cabin door in both open and closed positions. Constructed of corrosion resistant machined AISI 304 stainless steel. Surface mounts with six #8 FH fasteners (not included).

⚠ WARNING: Cancer and Reproductive Harm - www.P65Warnings.ca.gov



HEAVY DUTY BARREL BOLT

Investment Cast 316 Stainless Steel

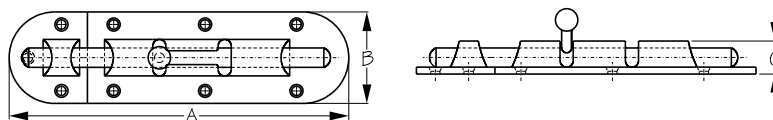

Bulk	Display	A	B	C	Fastener	Wt.(lb.)	Std. Pack
221243	221243-1	3-1/16"	1-1/2"	5/8"	#8 FH	.28	5 ea
221244	221244-1	4-1/4"	1-1/2"	5/8"	#8 FH	.33	5 ea
221255	221255-1	6-1/2"	1-3/4"	5/8"	#10 FH	.59	5 ea

These Barrel Bolts provide additional security as either a primary or back-up locking system. Ideal for use on doors, gates, and cabinets. Appropriate for vertical, horizontal, left, or right-hand applications. In vertical use, the notch in the barrel holds bolt in locked position. Constructed of corrosion resistant investment cast 316 stainless steel. Surface mounts with FH fasteners (not included).

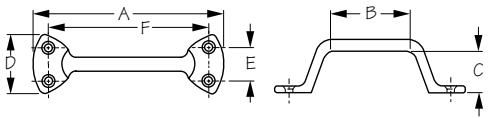
**LIFT HANDLE**

Investment Cast 316 Stainless Steel



Bulk	Display	A	B	C	D	E	F	Fastener	Wt.(lb.)	Std. Pack
221275	221275-1	5-3/4"	2-5/8"	1-1/4"	1-11/16"	1"	4-13/16"	#10 FH	.29	5 ea

This Lift Handle can be used in a multitude of applications including doors, drawers, and cabinets. Constructed of corrosion resistant investment cast 316 stainless steel. Installs with four #10 FH fasteners (not included).

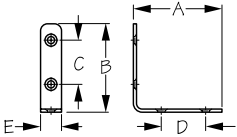
**90° ANGLE BRACKET**

Stamped 304 Stainless Steel



Bulk	Display	A	B	C	D	E	Fastener	Wt.(lb.)	Std. Pack
221305	221305-1	1-1/2"	1-1/2"	7/8"	7/8"	9/16"	#8 FH	.03 / .06	10 ea / 10 pr
221310	221310-1	2-3/8"	2-3/8"	1-3/16"	1-3/16"	9/16"	#8 FH	.05 / .10	10 ea / 10 pr
221315	221315-1	3"	3"	1-13/16"	1-13/16"	9/16"	#8 FH	.06 / .12	10 ea / 10 pr

90° Angle brackets are used as a corner brace to reinforce the inside right angle of corner joints. Constructed of corrosion resistant stamped 304 stainless steel. Installs with four #8 FH fasteners (not included).

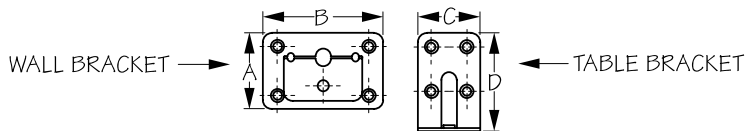
**TABLE BRACKET**

Stamped 304 Stainless Steel

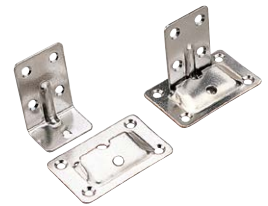

Bulk	Display	A	B	C	D	Fastener	Wt.(lb.)	Std. Pack
221320	221320-1	2-1/8"	3-3/8"	1-3/4"	2-3/4"	#10 FH	.58	5 set / 5 sets

Table Brackets are designed to hold a removable table. One 4-piece set includes two wall and two table brackets. Constructed of corrosion resistant stamped 304 stainless steel. Set installs with sixteen #10 FH fasteners (not included).

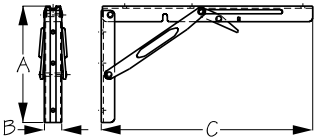
**FOLDING TABLE SUPPORT BRACKET**

Stamped 304 Stainless Steel



Bulk	Display	A	B	C	Style	Load Limit	Fastener	Wt.(lb.)	Std. Pack
221350	221350-1	6-1/2"	15/16"	11-11/16"	Light Duty	300 lbs.	#12 RH	1.50	1 pr
221355	221355-1	6-1/2"	15/16"	11-11/16"	Heavy Duty	500 lbs.	#12 RH	1.90	1 pr

These Folding Table Support Brackets fold and lock your table top in place. The heavy duty version (pictured) is rated for 500 lbs. and features thicker sliders. The light duty version is rated for 300 lbs. Constructed of corrosion resistant stamped 304 stainless steel. Installs with #12 RH fasteners (not included).

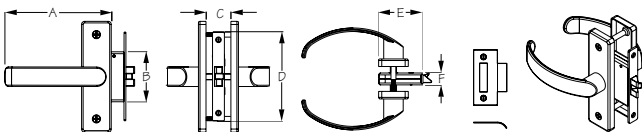
**DOOR HANDLE LATCH**

Investment Cast 316 Stainless Steel

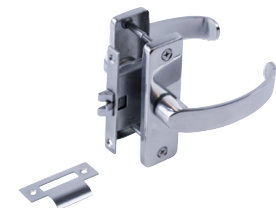

Bulk	Display	A	B	C	D	E	F	Fastener	Wt.(lb.)	Std. Pack
n/a	221610-1	4-1/8"	2"	3/4"-1-1/2"	3-9/16"	1-3/4"	7/16"	#8 FH	.98	1 ea

Door Handle Latch is polished for a modern look. Includes strike plate and mounting template. For doors 3/4" - 1-1/2" thick. Constructed of corrosion resistant 316 stainless steel. Latch and strike plate installs with four #8 FH fasteners (not included).

⚠ **WARNING:** Cancer and Reproductive Harm - www.P65Warnings.ca.gov

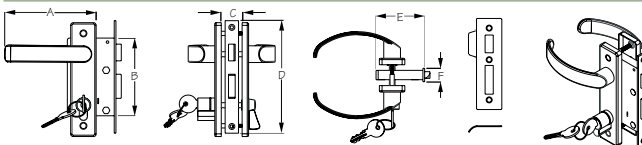
**DOOR HANDLE LATCH - LOCKING**

Investment Cast 316 Stainless Steel



Bulk	Display	A	B	C	D	E	F	Fastener	Wt.(lb.)	Std. Pack
n/a	221615-1	4-1/8"	3-9/16"	3/4"-1-1/2"	3-9/16"	1-1/4"	7/16"	#8 FH	.98	1 ea

Locking Door Handle Latch is polished for a modern look. Opens from outside deadbolt with cylinder lock mechanism. Includes strike plate, mounting template and two keys. For doors 3/4" - 1-1/2" thick. Constructed of corrosion resistant 316 stainless steel. Latch and strike plate install with four #8 FH fasteners (not included).

⚠ **WARNING:** Cancer and Reproductive Harm - www.P65Warnings.ca.gov



DOOR STOP BUTTON

Stamped 304 Stainless Steel/Injection Molded Nylon

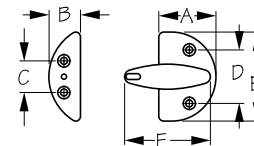

Bulk	Display	A	B	C	D	E	F	Fastener	Wt.(lb.)	Std. Pack
221670	221670-1	1-3/8"	3/4"	3/4"	1-1/4"	2-3/8"	2"	#8 FH	.08	10 ea

These Door Stop Buttons are a sleek, simple, and effective hardware solution to keep doors closed. Constructed of corrosion resistant stamped 304 stainless steel and injection molded nylon. Surface mounts with four #8 FH fasteners (not included). Comparable to Perko® #1217, without spring.



SLIDING DOOR STOP

Investment Cast 316 Stainless Steel



Bulk	Display	A	B	C	D	E	Fastener	Wt.(lb.)	Std. Pack
221700	221700-1	2-7/8"	1-1/4"	1/4"	9/16"	7/8"	#8 FH	.18	5 ea

This Sliding Door Stop is designed to be installed adjacent to a track. Features a hinged arm that flips over to hold open or closed sliding windows or pocket doors. Simple and secure, this stop is constructed of investment cast 316 stainless steel for corrosion resistance and durability. Black polymer coating on stop protects windows or doors from direct metal contact. Installs with two #8 FH fasteners (not included).

⚠ WARNING: Cancer and Reproductive Harm - www.P65Warnings.ca.gov



DOOR STOP AND CATCH

Investment Cast 316 Stainless Steel

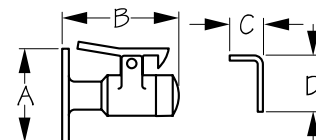

Bulk	Display	A	B	C	D	Fastener	Wt.(lb.)	Std. Pack
221710	221710-1	2"	2-1/2"	11/16"	1-3/16"	#6 FH	.41	5 ea
221715	221715-1	2"	4"	11/16"	1-3/16"	#6 FH	.47	5 ea
OP22100	n/a	Replacement Wall Catch						.01 10 ea
OP22101	n/a	Replacement Rubber Bumper						.01 10 ea
OP22105	n/a	Replacement Spring						.01 10 ea

These Door Stop and Catches hold the door securely against the rubber stop, effectively reducing rattling common with most door hooks. The spring-loaded latch allows for quick and easy release. Constructed of corrosion resistant investment cast 316 stainless steel. Installs with five #6 FH fasteners (not included).

⚠ WARNING: Cancer and Reproductive Harm - www.P65Warnings.ca.gov



MAGNETIC DOOR STOP

Machined 304 Stainless Steel

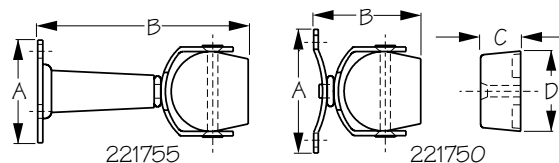

Bulk	Display	A	B	C	D	Fastener	Wt.(lb.)	Std. Pack
221750	221750-1	1-13/16"	1-9/16"	9/16"	1-3/16"	#10 RH	.33	5 ea
221755	221755-1	1-1/2"	3"	9/16"	1-3/16"	#10 RH	.53	5 ea

These two-in-one Magnetic Door Stops both protect walls and hold doors open. Features a powerful, hands-free magnet that can keep door open even in heavy winds. Can be mounted either vertically to the floor, or horizontally to baseboard or wall. Constructed of corrosion resistant machined 304 stainless steel. Installs with #10 RH fasteners (not included).



SPRING LOADED FLUSH RING PULL

Stamped 304 Stainless Steel

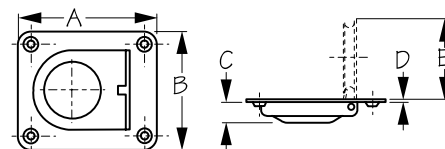

Bulk	Display	A	B	C	D	E	Fastener	Wt.(lb.)	Std. Pack
221810	221810-1	2-9/16"	2-3/16"	7/16"	1/32"	1-1/2"	#8 FH	.11	10 ea
221815	221815-1	1-3/4"	1-1/2"	7/16"	1/32"	1"	#6 FH	.06	10 ea

These Spring Loaded Flush Ring Pulls features a rattle-free handle that stays flush against the base, even in vertical applications. Ideal for use on doors, hatches, lazarettes, and dock boxes. Constructed of corrosion resistant stamped 304 stainless steel. Installs with four FH fasteners (not included).

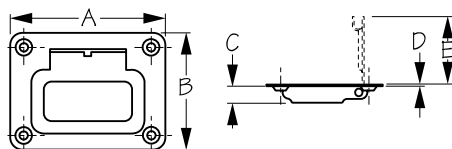
**SPRING LOADED FLUSH HATCH PULL**

Stamped 304 Stainless Steel



Bulk	Display	A	B	C	D	E	Fastener	Wt.(lb.)	Std. Pack
221820	221820-1	3"	2-1/4"	5/16"	1/32"	1-5/16"	#8 FH	.11	10 ea

This Spring Loaded Flush Hatch Pull features a rattle-free handle that stays flush against the base, even in vertical applications. Ideal for use on doors, hatches, lazarettes, and dock boxes. Constructed of corrosion resistant stamped 304 stainless steel. Installs with four #8 FH fasteners (not included).

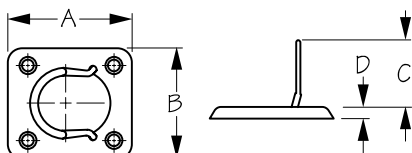
**SURFACE MOUNT RING PULL**

Stamped 304 Stainless Steel



Bulk	Display	A	B	C	D	Fastener	Wt.(lb.)	Std. Pack
221830	221830-1	2-1/8"	1-15/16"	15/16"	3/16"	#10 FH	.04	10 ea

This Surface Mount Ring Pull is ideal for use on doors, hatches, lazarettes, and dock boxes. Constructed of corrosion resistant stamped 304 stainless steel. Surface mounts with four #10 FH fasteners (not included).

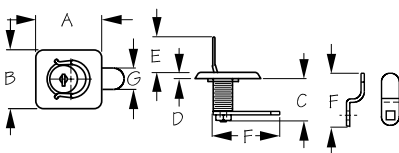
**SURFACE MOUNT LOCKING RING PULL**

Stamped 304 Stainless Steel/Die Cast Zinc Lock



Bulk	Display	A	B	C	D	E	F (Locking Arm)	G	Wt.(lb.)	Std. Pack
221831	221831-1	2-1/8"	1-15/16"	1-1/16"	3/16"	15/16"	1-7/16"-1-7/8"	1/2"	.24	10 ea

This Surface Mount Locking Ring Pull is recessed for a flush, clean installation. Includes two locking arms for flush or offset installations. Ideal for hatches, deck plates, cabinets, and drawers. Designed to keep your valuables protected, it includes two matching keys. Keys are random so requesting multiple ring pulls keyed alike is not possible. Constructed of corrosion resistant stamped 304 stainless steel with a die cast zinc lock. Installs with a back mounted threaded nut.

⚠ **WARNING:** Cancer and Reproductive Harm - www.P65Warnings.ca.gov

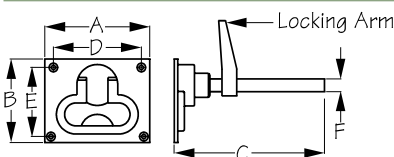
**HATCH HANDLE LATCH**

Investment Cast 316 Stainless Steel



Bulk	Display	A	B	C	D	E	F	Fastener	Wt.(lb.)	Std. Pack
221835	221835-1	3-3/4"	3"	6"	3-1/8"	2-7/16"	1/2"	#8 FH	1.28	1 ea

These Hatch Handle Latches feature a handle that pivots out to open hatches and lays flush when not in use for a clean appearance. Ideal for use on doors, hatches, lazarettes, and dock boxes. Adjustable locking arm adds additional security. Once installed, the locking arm can be trimmed to length. Constructed of corrosion resistant investment cast 316 stainless steel. Installs with four #8 FH fasteners (not included).

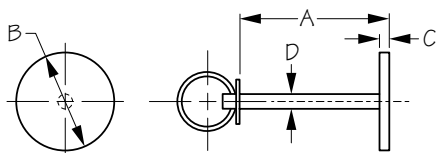
**HATCH COVER PULL**

Stamped 304 Stainless Steel



Bulk	Display	Description	A	B	C	D	Wt.(lb.)	Std. Pack
221840	221840-1	Pull Only	1-15/16"	1-1/4"	1/8"	3/16"	.06	10 ea
221841	n/a	Rubber Gasket Only	n/a	n/a	n/a	n/a	.01	10 ea
221842	221842-1	Pull and Rubber Gasket	1-15/16"	1-1/4"	1/8"	3/16"	.07	10 ea

This Hatch Cover Pull provides a simple and convenient way to open hatches. Easy-to-install, it features a stainless steel washer for a tight and secure fit, and a rubber gasket to reduce noise and resist water penetration. Commonly used on deck mounted access hatches, this hatch cover pull not only looks attractive, but is durable for use in harsh marine conditions. Constructed of corrosion resistant stamped 304 stainless steel. Requires a 3/16" hole. Flange pull is 1-1/4" in diameter x 1/8" thick.

⚠ **WARNING:** Cancer and Reproductive Harm - www.P65Warnings.ca.gov

**RING PULL**

Investment Cast 316 Stainless Steel

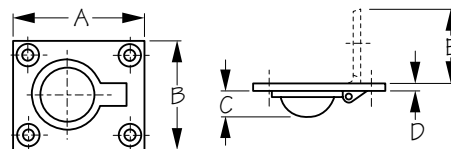

Bulk	Display	A	B	C	D	E	Fastener	Wt.(lb.)	Std. Pack
221850	221850-1	1-15/16"	1-9/16"	3/8"	1/8"	1-1/16"	#8 FH	.12	10 ea

This Ring Pull features a handle that pivots out to open hatches and lays flush when not in use for a clean appearance. Ideal for use on doors, hatches, lazarettes, and dock boxes. Constructed of corrosion resistant investment cast 316 stainless steel. Installs with four #8 FH fasteners (not included).

**FLUSH HATCH PULL**

Investment Cast 316 Stainless Steel

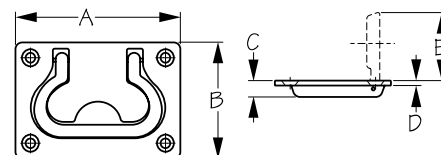

Bulk	Display	A	B	C	D	E	Fastener	Wt.(lb.)	Std. Pack
221860	221860-1	3"	2-1/8"	5/16"	1/16"	1-1/4"	#8 FH	.20	5 ea

These Flush Hatch Pulls feature a handle that pivots out to open hatches and lays flush when not in use for a clean appearance. Ideal for use on doors, hatches, lazarettes, and dock boxes. Constructed of corrosion resistant investment cast 316 stainless steel. Installs with four #8 FH fasteners (not included).

**GATE LATCH**

Investment Cast 316 Stainless Steel

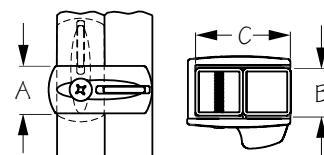

Bulk	Display	A	B	C	Fastener	Wt.(lb.)	Std. Pack
221880	221880-1	1-1/4"	1-1/4"	2-1/2"	1/4" Bolt	.40	5 ea

This Gate Latch is designed to be used with 1-1/4" square tubing. Ideal for pontoon gates. Constructed of corrosion resistant investment cast 316 stainless steel. Installs with 1/4" thru bolt (not included).



⚠ WARNING: Cancer and Reproductive Harm - www.P65Warnings.ca.gov

**ELBOW DECK CATCH**

Investment Cast 316 Stainless Steel

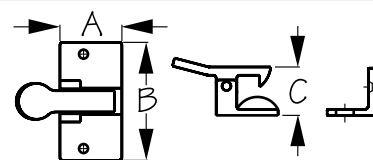

Bulk	Display	A	B	C	Fastener	Wt.(lb.)	Std. Pack
221900	n/a	1-5/16"	2-1/2"	1"	#8 RH	.30	5 ea

This Elbow Deck Catch is ideal for the inactive side of a pair of cabinet doors. For use on wood or metal doors where no frame is present between doors. This catch is quick and simple to install, allowing for the door to lock shut when pushed. Requires releasing the hook to open the door, making it very secure. Traditionally used in conjunction with a touch or magnetic latch on the primary door. Constructed of corrosion resistant investment cast 316 stainless steel. Installs with four #8 RH fasteners (not included).

**T-HANDLE SLAM LATCH**

Investment Cast 316 Stainless Steel

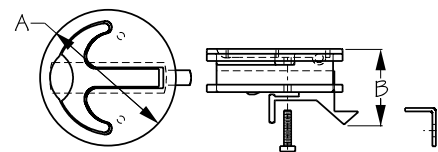

Bulk	Display	A	B	Cutout Hole Size	Fastener	Wt.(lb.)	Std. Pack
221910	221910-1	2-7/16"	1-3/8"	2"	1/8" RH	.31	5 ea

This T-Handle Slam Latch features push-to-close functionality. Activated by the shutting or slamming of a door, they are designed so that a spring inside automatically retracts the latch, engaging the keeper and retaining the cover against the frame. Fast and easy to use, this latch features a recessed, rattle-free, spring loaded T-handle for quick access. Constructed of corrosion resistant investment cast 316 stainless steel. Easy to install by simply inserting the latch body through a single round 2" cut-out and screwing on the back plate. Includes hardware to mount latch. Keeper hardware not included.

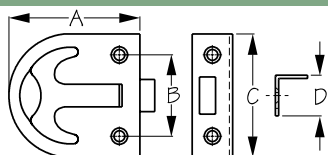
**T-HANDLE LATCH**

Investment Cast 316 Stainless Steel



Bulk	Display	A	B	C	D	Fastener	Wt.(lb.)	Std. Pack
221920	221920-1	2-7/16"	1-1/2"	2-1/4"	3/4"	#8 FH	.31	5 ea

This T-Handle Latch features a recessed T-handle for a flush, clean installation. Constructed of corrosion resistant investment cast 316 stainless steel. Installs with four #8 FH fasteners (not included).

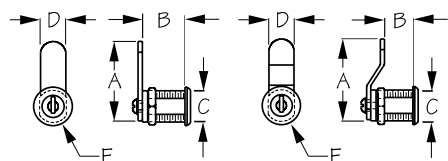
**CAM LOCK**

Die Cast Zinc/Stamped 304 Stainless Steel Nut



Bulk	Display	A (Locking Arm)	B	C	D	E	Wt.(lb.)	Std. Pack
221930	221930-1	1-9/16" - 1-7/8"	1"	3/4"	1/2"	15/16"	.20	10 ea

This cylindrical Cam Lock assembly features a pivot mechanism that will swivel to engage in a locked or open position simply by turning the cam assembly. Includes two locking arms for flush or offset installations and two matching keys. Keys are random so keyed alike cam locks cannot be guaranteed. Constructed of die cast zinc. Installs with back mounted stamped 304 stainless steel nut.

⚠ **WARNING:** Cancer and Reproductive Harm - www.P65Warnings.ca.gov

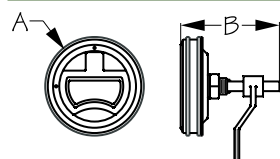
**ROUND HATCH HANDLE LATCH**

Investment Cast 316 Stainless Steel



Bulk	Display	A	B	Cutout Hole Size	Max. Depth	Wt.(lb.)	Std. Pack
221942	n/a	2-3/8"	3-3/4"	2"	7/8"	.96	1 ea
221944	n/a	3-1/2"	3-3/4"	3"	7/8"	2.11	1 ea

These Round Hatch Handle Latches feature a T-handle to engage the offset locking arm. Handle is recessed for a flush, clean installation. Constructed of corrosion resistant investment cast 316 stainless steel. Requires a 2" or 3" size cut-out hole. Installs with a back mounted stainless nut.

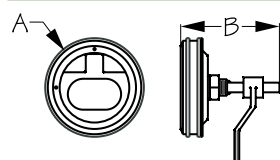
**LARGE ROUND HATCH HANDLE LATCH**

Investment Cast 316 Stainless Steel



Bulk	Display	A	B	Cutout Hole Size	Max. Depth	Wt.(lb.)	Std. Pack
221954	n/a	3-1/2"	3-3/4"	3"	7/8"	2.03	1 ea

This Large Round Hatch Handle Latch features a T-handle to engage the offset locking arm. Handle is recessed for a flush, clean installation. Constructed of corrosion resistant investment cast 316 stainless steel. Requires a 3" size cut-out hole. Installs with a back mounted stainless nut.

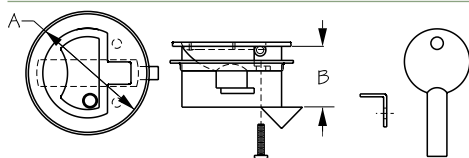
**SLAM LATCH**

Investment Cast 316 Stainless Steel



Bulk	Display	A	B	Cutout Hole Size	Locking	Fastener	Wt.(lb.)	Std. Pack
221961	n/a	1-3/4"	7/8"	1-1/2"	No	1/8" RH	.21	1 ea
221961L	n/a	1-3/4"	7/8"	1-1/2"	Yes	1/8" RH	.25	1 ea

These Slam Latches feature push-to-close functionality. Activated by the shutting or slamming of a door, they are designed so that a spring inside automatically retracts the latch, engaging the keeper and retaining the cover against the frame. Fast and easy to use, this latch features a recessed, rattle-free, spring loaded T-handle for quick access. Constructed of corrosion resistant investment cast 316 stainless steel. Easy to install by simply inserting the latch body through a single round 1-1/2" cutout and screwing on the back plate. Includes hardware to mount latch. Keeper hardware not included. Available in locking (pictured) and non-locking configurations.

**WATERTIGHT SLAM LATCH**

Investment Cast 316 Stainless Steel

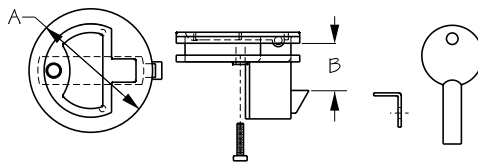

Bulk	Display	A	B	Cutout Hole Size	Locking	Fastener	Wt.(lb.)	Std. Pack
221962	n/a	2-5/16"	1-1/16"	2"	No	1/8" RH	.31	1 ea
221962L	n/a	2-5/16"	1-1/16"	2"	Yes	1/8" RH	.35	1 ea

These Watertight Slam Latches feature push-to-close functionality. Activated by the shutting or slamming of a door, they are designed so that a spring inside automatically retracts the latch, engaging the keeper and retaining the cover against the frame. Includes a pair of seals to prevent water from passing through the latch. Fast and easy to use, this latch features a recessed, rattle-free, spring loaded T-handle for quick access. Constructed of corrosion resistant investment cast 316 stainless steel. Easy to install by simply inserting the latch body through a single round 2" cutout and screwing on the back plate. Includes hardware to mount latch. Keeper hardware not included. Available in locking (pictured) and non-locking configurations.

⚠ **WARNING:** Cancer and Reproductive Harm - www.P65Warnings.ca.gov

**T-HANDLE SLAM LATCH**

Investment Cast 316 Stainless Steel

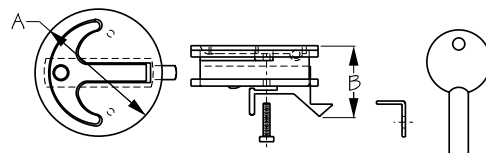

Bulk	Display	A	B	Cutout Hole Size	Locking	Fastener	Wt.(lb.)	Std. Pack
221972	n/a	2-3/8"	1-11/16"	2"	No	1/8" RH	.31	1 ea
221972L	n/a	2-3/8"	1-11/16"	2"	Yes	1/8" RH	.35	1 ea

These T-Handle Slam Latches feature push-to-close functionality. Activated by the shutting or slamming of a door, they are designed so that a spring inside automatically retracts the latch, engaging the keeper and retaining the cover against the frame. Fast and easy to use, this latch features a recessed, rattle-free, spring loaded T-handle for quick access. Constructed of corrosion resistant investment cast 316 stainless steel. Easy to install by simply inserting the latch body through a single round cutout and screwing on the back plate. Includes hardware to mount latch. Keeper hardware not included. Available in locking (pictured) and non-locking configurations.

**T-HANDLE LOCKING COMPRESSION LATCH**

Investment Cast 316 Stainless Steel

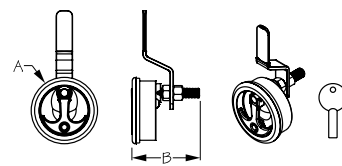

Bulk	Display	A	B	Locking	Cutout Hole Size	Max. Depth	Wt.(lb.)	Std. Pack
221982L	221982L-1	2-7/16"	2-1/2"	Yes	2"	2"	.96	1 ea
OP22110	n/a	Rubber Gasket					.01	10 ea

This T-Handle Locking Compression Latch features a T-handle to engage the offset locking arm. Handle is recessed for a flush, clean installation. Locking feature for secure hatches. Includes heavy duty stainless key. Constructed of corrosion resistant investment cast 316 stainless steel. Requires a 2" size cutout hole. Installs with a back mounted stainless cup. Rubber gasket optional (OP22110).

⚠ **WARNING:** Cancer and Reproductive Harm - www.P65Warnings.ca.gov

**PADLOCK**

Brass

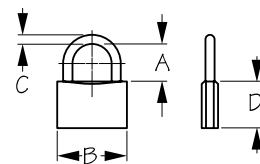

Bulk	Display	A	B	C	D	No. of Keys	Wt.(lb.)	Std. Pack
222004	222004-1	13/16"	1-1/2"	1/4"	1-3/16"	3	.23	12 ea / 10 ea

Padlock includes three keys. Brass construction.

⚠ **WARNING:** Cancer and Reproductive Harm - www.P65Warnings.ca.gov

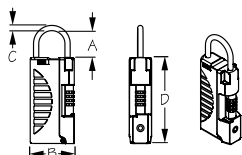
**COMBINATION KEY BOX LOCK**

Powder Coated Steel



Bulk	Display	A	B	C	D	Wt.(lb.)	Std. Pack
n/a	222009-1	1-3/4"	2-1/2"	5/16"	5-3/16"	1.34	1 ea



Combination Key Box Lock is great for dock boxes and entry doors. Large capacity lock box fits multiple keys. Interior dimensions: 4-1/2" L X 1-1/2" D X 7/8" W. Programmable combination is preset to open on 0-0-0-0. Thousands of personalized combination code options. Combination reset instructions included. Hinged side opening door is permanently attached to prevent loss. Hang the lock box on a door, fence, railing or anywhere it can securely lock. Constructed of powder coated steel with a hardened steel shackle for extra security.

⚠ **WARNING:** Cancer and Reproductive Harm - www.P65Warnings.ca.gov

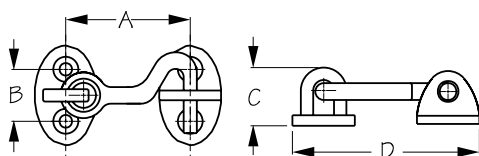
**DOOR HOOK**

Sand Cast Brass or Chrome Plated Brass

Bulk	Display	A	B	C	D	Finish	Fastener	Wt.(lb.)	Std. Pack
222050	222050-1	1-1/2"	5/8"	11/16"	2-1/4"	Chrome	#6 FH	.09	10 ea
222051	222051-1	1-1/2"	5/8"	11/16"	2-1/4"	Brass	#6 FH	.09	10 ea

These hook-and-eye style Door Hooks allow additional security for doors and cabinets to lock in closed or open positions. Ideal for use on doors, gates, cabinets, and shutters. Constructed of sand cast brass with a plain polished or chrome plated finish. Surface mounts with four #6 FH fasteners (not included).

⚠ **WARNING:** Cancer and Reproductive Harm - www.P65Warnings.ca.gov

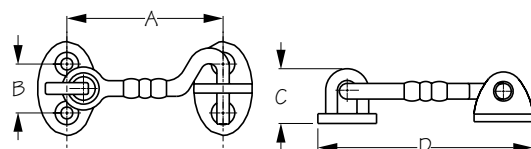
**DECORATIVE DOOR HOOK**

Sand Cast Brass or Chrome Plated Brass

Bulk	Display	A	B	C	D	Finish	Fastener	Wt.(lb.)	Std. Pack
222055	222055-1	1-3/4"	5/8"	11/16"	2-1/2"	Chrome	#6 FH	.09	10 ea
222056	222056-1	1-3/4"	5/8"	11/16"	2-1/2"	Brass	#6 FH	.09	10 ea
222065	222065-1	2-3/4"	5/8"	11/16"	3-1/2"	Chrome	#6 FH	.12	10 ea
222066	222066-1	2-3/4"	5/8"	11/16"	3-1/2"	Brass	#6 FH	.12	10 ea

These hook-and-eye style Decorative Door Hooks allow additional security for doors and cabinets to lock in closed or open positions. Ideal for use on doors, gates, cabinets, and shutters. Constructed of sand cast brass with a plain polished or chrome plated finish. Surface mounts with four #6 FH fasteners (not included).

⚠ **WARNING:** Cancer and Reproductive Harm - www.P65Warnings.ca.gov

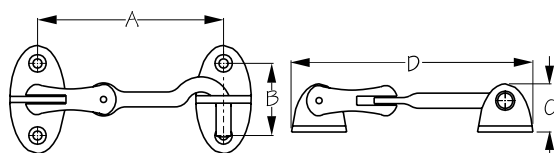
**DOOR HOOK WITH SWIVEL**

Precision Cast Brass or Chrome Plated Brass

Bulk	Display	A	B	C	D	Finish	Fastener	Wt.(lb.)	Std. Pack
222090	222090-1	5-1/16"	15/16"	3/4"	5-5/8"	Chrome	#6 FH	.26	10 ea
222091	222091-1	5-1/16"	15/16"	3/4"	5-5/8"	Brass	#6 FH	.26	10 ea

These cabin Door Hooks with Swivels feature a dual action hinge to eliminate rattle and ensures a secure fit. For use on any type of door to lock in closed or open positions. Constructed of precision cast brass with a plain polished or chrome plated finish. Surface mounts with four #6 FH fasteners (not included).

⚠ **WARNING:** Cancer and Reproductive Harm - www.P65Warnings.ca.gov





ANTI-RATTLE LATCH

Sand Cast Brass Chrome Plated

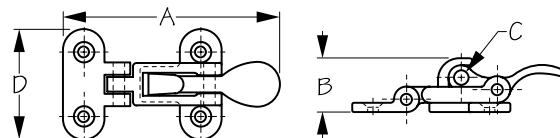

Bulk	Display	A	B	C	D	Fastener	Wt.(lb.)	Std. Pack
222110	222110-1	4"	15/16"	1/4"	2"	#10 FH	.27	10 ea

Anti-Rattle Latch features an open-mount, center-tensioning cam latch for a tight, no-rattle seal. Latch also features a locking hole that will accept a padlock with up to a 1/4" diameter shank. Ideal for cabinets, doors, and hatches. Constructed of chrome plated sand cast brass. Surface mounts with four #10 FH fasteners (not included).

⚠ WARNING: Cancer and Reproductive Harm - www.P65Warnings.ca.gov



DOOR HOOK

Cast Brass Chrome Plated

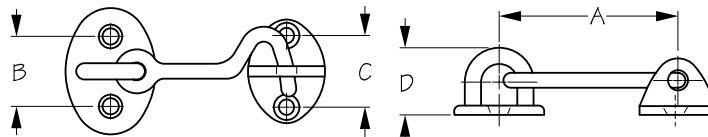

Bulk	Display	A	B	C	D	Fastener	Wt.(lb.)	Std. Pack
222112	222112-1	2-5/16"	13/16"	13/16"	3/4"	#6 FH	.07	10 ea
222113	222113-1	2-3/4"	13/16"	13/16"	3/4"	#6 FH	.08	10 ea

These hook-and-eye style cabin Door Hooks allow additional security for doors and cabinets to lock in closed or open positions. Ideal for use on doors, gates, cabinets, and shutters. Constructed of chrome plated cast brass. Surface mounts with four #6 FH fasteners (not included).

⚠ WARNING: Cancer and Reproductive Harm - www.P65Warnings.ca.gov



HASP

Sand Cast Brass or Chrome Plated Brass

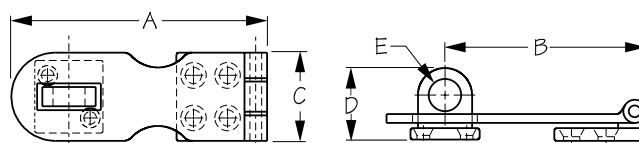

Bulk	Display	A	B	C	D	E	Finish	Fastener	Wt.(lb.)	Std. Pack
222120	222120-1	3"	2-5/16"	1"	3/4"	3/8"	Chrome	#6 FH	.17	10 ea
222121	222121-1	3"	2-5/16"	1"	3/4"	3/8"	Brass	#6 FH	.17	10 ea

These Hasps are designed with a slotted plate that fits over a fixed post. Prevents removal when used in conjunction with a padlock. For added security, all mounting screws are concealed when hasp is closed. Ideal for use on doors, cabinets, chests, and lockers. Constructed of sand cast brass with a plain polished or chrome plated finish. Installs with six #6 FH fasteners (not included).

⚠ WARNING: Cancer and Reproductive Harm - www.P65Warnings.ca.gov



SWIVEL HASP

Sand Cast Brass or Chrome Plated Brass

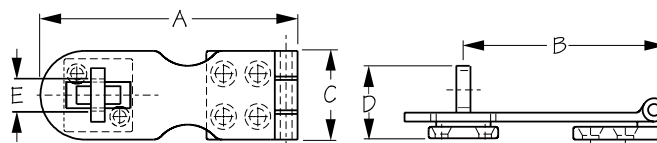

Bulk	Display	A	B	C	D	E	Finish	Fastener	Wt.(lb.)	Std. Pack
222130	222130-1	3"	2-3/8"	1"	1"	3/8"	Chrome	#6 FH	.17	10 ea
222135	222135-1	3"	2-3/8"	1"	1"	3/8"	Brass	#6 FH	.17	10 ea

These Swivel Hasps are designed with a slotted plate that fits over a swivel pad eye. The swivel eye rotates acting as a temporary lock, but can also be used in conjunction with a padlock for more permanent protection. For added security, all mounting screws are concealed when hasp is closed. Ideal for use on doors, cabinets, chests, and lockers. Constructed of sand cast brass with a plain polished or chrome plated finish. Installs with six #6 FH fasteners (not included).

⚠ WARNING: Cancer and Reproductive Harm - www.P65Warnings.ca.gov

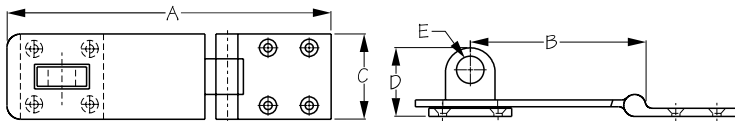
**HEAVY DUTY HASP**

Sand Cast Brass or Chrome Plated Brass



Bulk	Display	A	B	C	D	E	Finish	Fastener	Wt.(lb.)	Std. Pack
222150	222150-1	5-7/8"	3-1/4"	1-9/16"	1-1/4"	1/2"	Chrome	#8 FH	.59	10 ea
222155	222155-1	5-7/8"	3-1/4"	1-9/16"	1-1/4"	1/2"	Brass	#8 FH	.59	10 ea

These Heavy Duty Hasps are designed with a slotted plate that fits over a fixed post. Prevents removal when used in conjunction with a padlock. Ideal for use on doors, cabinets, chests, and lockers. Constructed of sand cast brass with a plain polished or chrome plated finish. Installs with eight #8 FH fasteners (not included).

⚠ WARNING: Cancer and Reproductive Harm - www.P65Warnings.ca.gov

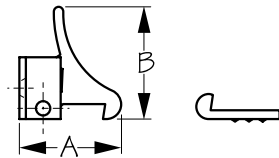
**ELBOW CATCH**

Extruded Brass or Chrome Plated Brass



Bulk	Display	A	B	Finish	Fastener	Wt.(lb.)	Std. Pack
222330	222330-1	1-1/8"	1-5/16"	Chrome	#6 FH	.06 / .12	10 ea / 10 pr
222335	222335-1	1-1/8"	1-5/16"	Brass	#6 FH	.06 / .12	10 ea / 10 pr

This spring-loaded Elbow Catch is ideal for the inactive side of a pair of cabinet doors. For use on wood or metal doors where no frame is present between doors. These catches are quick and simple to install, allowing for door to lock shut when pushed. Requires releasing the hook to open the door, making them very secure. Traditionally used in conjunction with a touch or magnetic latch on the primary door. Slotted hole in catch allows for adjustable installation. Constructed of extruded brass with a plain polished or chrome plated finish. Surface mounts with two #6 FH fasteners (not included).

⚠ WARNING: Cancer and Reproductive Harm - www.P65Warnings.ca.gov

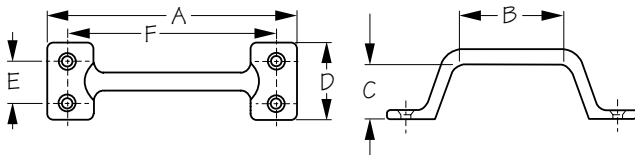
**LIFT HANDLE**

Sand Cast Brass Chrome Plated



Bulk	Display	A	B	C	D	E	F	Fastener	Wt.(lb.)	Std. Pack
222340	222340-1	4-3/4"	2-5/8"	13/16"	1-1/4"	5/8"	4-1/16"	#10 FH	.18	10 ea

This sturdy Lift Handle can be used in a multitude of applications including doors, drawers, and cabinets. Constructed of sand cast brass with a chrome plated finish for durability. Installs with four #10 FH fasteners (not included).

⚠ WARNING: Cancer and Reproductive Harm - www.P65Warnings.ca.gov

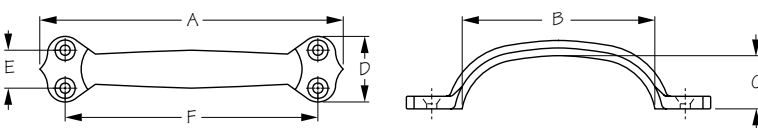
**DELUXE LIFT HANDLE**

Sand Cast Brass or Chrome Plated Brass



Bulk	Display	A	B	C	D	E	F	Fastener	Wt.(lb.)	Std. Pack
222345	222345-1	4"	2-11/16"	7/8"	1"	1/2"	3-3/8"	#8 FH	.19	10 ea
222346	222346-1	4"	2-11/16"	7/8"	1"	1/2"	3-3/8"	#8 FH	.19	10 ea
222348	222348-1	6"	3-13/16"	1-1/16"	1-5/16"	3/4"	5"	#10 FH	.35	10 ea
222349	222349-1	6"	3-13/16"	1-1/16"	1-5/16"	3/4"	5"	#10 FH	.35	10 ea

These Deluxe Lift Handles can be used in a multitude of applications including doors, drawers and cabinets. Constructed of sand cast brass with a plain polished or chrome plated finish. Installs with four FH fasteners (not included).

⚠ WARNING: Cancer and Reproductive Harm - www.P65Warnings.ca.gov



LIFT HANDLE

Sand Cast Brass Chrome Plated

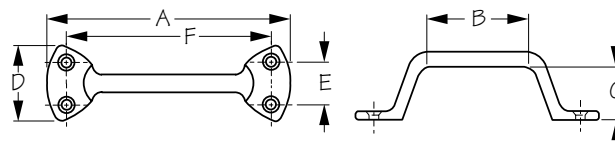

Bulk	Display	A	B	C	D	E	F	Fastener	Wt.(lb.)	Std. Pack
222350	222350-1	5-3/4"	2-5/8"	1-1/4"	1-3/4"	1"	4-3/4"	#8 FH	.41	10 ea

This heavy duty Lift Handle is ideal for cabinets and drawers. This durable handle provides ample hand clearance for maximum grip. Constructed of sand cast brass with a chrome plated finish. Installs with four #8 FH fasteners (not included).

⚠ WARNING: Cancer and Reproductive Harm - www.P65Warnings.ca.gov



LIFT HANDLE

Sand Cast Brass or Chrome Plated Brass

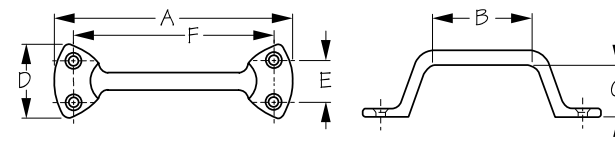

Bulk	Display	A	B	C	D	E	F	Fastener	Wt.(lb.)	Std. Pack
222355	222355-1	6"	2-1/2"	1-1/4"	1-7/8"	1-1/16"	5"	#8 FH	.41	10 ea
222356	222356-1	6"	2-1/2"	1-1/4"	1-7/8"	1-1/16"	5"	#8 FH	.41	10 ea

These decorative Lift Handles can be used in a multitude of applications including doors, drawers and cabinets. Constructed of sand cast brass with a plain polished or chrome plated finish. Installs with four #8 FH fasteners (not included).

⚠ WARNING: Cancer and Reproductive Harm - www.P65Warnings.ca.gov



DOOR STOP BUTTON

Cast Brass or Chrome Plated Brass

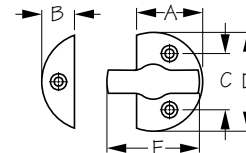

Bulk	Display	A	B	C	D	E	Finish	Fastener	Wt.(lb.)	Std. Pack
222360	222360-1	1-3/16"	1/2"	1"	1-3/4"	1-11/16"	Chrome	#6 FH	.13	10 ea
222365	222365-1	1-3/16"	1/2"	1"	1-3/4"	1-11/16"	Brass	#6 FH	.13	10 ea

These Door Stop Buttons are a sleek, simple, and effective hardware solution to keep doors closed. Constructed of cast brass with a plain polished or chrome plated finish. Surface mounts with three #6 FH fasteners (not included).

⚠ WARNING: Cancer and Reproductive Harm - www.P65Warnings.ca.gov



CUPBOARD BOLT

Extruded Brass Chrome Plated

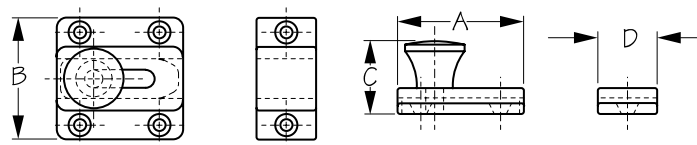

Bulk	Display	A	B	C	D	Fastener	Wt.(lb.)	Std. Pack
222380	222380-1	1-1/2"	1-1/2"	1"	3/4"	#6 FH	.14	10 ea

These Cupboard Bolts are used to secure cabinet doors while underway. Constructed of corrosion resistant chrome plated extruded brass. Surface mounts with six #6 FH fasteners (not included).

⚠ WARNING: Cancer and Reproductive Harm - www.P65Warnings.ca.gov



RING PULL

Cast Brass or Chrome Plated Brass

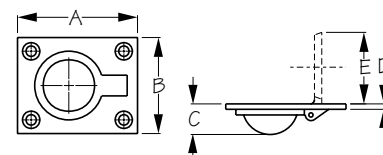

Bulk	Display	A	B	C	D	E	Finish	Fastener	Wt.(lb.)	Std. Pack
222400	222400-1	1-3/4"	1-1/2"	1/2"	1/8"	1-1/8"	Chrome	#6 FH	.10	10 ea
222410	222410-1	2-1/2"	2"	3/16"	1/8"	1-1/2"	Chrome	#8 FH	.22	10 ea
222415	222415-1	2-1/2"	2"	3/16"	1/8"	1-1/2"	Brass	#8 FH	.21	10 ea

These Ring Pulls feature a handles that pivots out to open hatches and lays flush when not in use for a clean appearance. Ideal for use on doors, cabinets, hatches, chests, and drawers. Constructed of sand cast brass with a plain polished or chrome plated finish. Installs with four FH fasteners (not included).

⚠ WARNING: Cancer and Reproductive Harm - www.P65Warnings.ca.gov

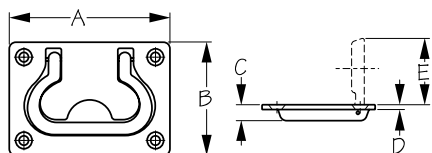
**HATCH PULL**

Sand Cast Brass Chrome Plated

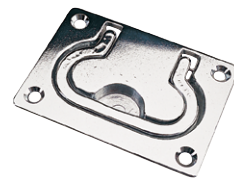

Bulk	Display	A	B	C	D	E	Fastener	Wt.(lb.)	Std. Pack
222420	222420-1	3"	2-1/8"	5/16"	1/16"	1-1/4"	#8 FH	.20	10 ea

This Hatch Pull features a handle that pivots out to open hatches and lays flush when not in use for a clean appearance. Ideal for use on doors, hatches, lazarettes, and dock boxes. Constructed of sand cast brass with a chrome plated finish. Installs with four #8 FH fasteners (not included).

⚠ WARNING: Cancer and Reproductive Harm - www.P65Warnings.ca.gov

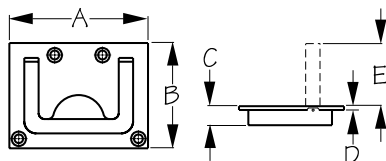
**HATCH HANDLE**

Sand Cast Brass or Chrome Plated Brass



Bulk	Display	A	B	C	D	E	Finish	Fastener	Wt.(lb.)	Std. Pack
222425	222425-1	2-15/16"	2-3/16"	3/8"	1/16"	1-3/16"	Chrome	#8 FH	.37	10 ea
222426	222426-1	2-15/16"	2-3/16"	3/8"	1/16"	1-3/16"	Brass	#8 FH	.37	10 ea

These Hatch Handles features a handle that pivots out to open hatches and lays flush when not in use for a clean appearance. Ideal for use on doors, hatches, lazarettes, and dock boxes. Constructed of sand cast brass with a plain polished or chrome plated finish. Installs with four #8 FH fasteners (not included).

⚠ WARNING: Cancer and Reproductive Harm - www.P65Warnings.ca.gov

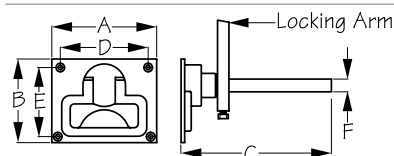
**HATCH HANDLE LATCH**

Chrome Plated Cast Brass

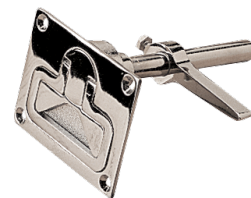

Bulk	Display	A	B	C	D	E	F	Finish	Wt.(lb.)	Std. Pack
222435	222435-1	3-1/8"	2-11/16"	4-5/16"	2-5/8"	2-1/16"	1/2"	Chrome	1.10	1 ea
222440	222440-1	3-3/4"	3"	4-5/16"	3-1/8"	2-7/8"	1/2"	Chrome	1.46	1 ea

These Hatch Handle Latches feature a handle that pivots out to open hatches and lays flush when not in use for a clean appearance. Ideal for use on doors, hatches, lazarettes, and dock boxes. Adjustable locking arm adds additional security. Once installed, the locking arm can be trimmed to length. Constructed of sand cast brass with a chrome plated finish. Installs with four #8 FH fasteners (not included).

⚠ WARNING: Cancer and Reproductive Harm - www.P65Warnings.ca.gov

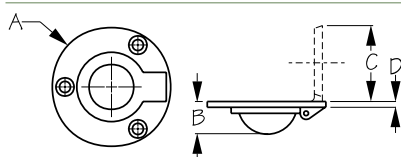
**ROUND RING PULL**

Sand Cast Brass or Chrome Plated Brass



Bulk	Display	A	B	C	D	Finish	Fastener	Wt.(lb.)	Std. Pack
222460	222460-1	1-5/8"	7/16"	1-1/16"	1/16"	Chrome	#8 FH	.07	10 ea
222461	222461-1	1-5/8"	7/16"	1-1/16"	1/16"	Brass	#8 FH	.07	10 ea
222465	222465-1	2"	7/16"	1-1/16"	1/16"	Chrome	#8 FH	.10	10 ea
222466	222466-1	2"	7/16"	1-1/16"	1/16"	Brass	#8 FH	.10	10 ea

These Round Ring Pulls feature a handle that pivots out to open hatches and lays flush when not in use for a clean appearance. Ideal for use on doors, cabinets, hatches, chests, and drawers. Constructed of sand cast brass with a plain polished or chrome plated finish. Installs with three #8 FH fasteners (not included).

⚠ WARNING: Cancer and Reproductive Harm - www.P65Warnings.ca.gov



BARREL BOLT

Extruded Brass Chrome Plated

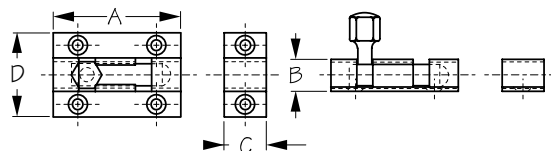

Bulk	Display	A (Less Striker)	B	C	D	Fastener	Wt.(lb.)	Std. Pack
222500	222500-1	1-1/2"	3/8"	1/2"	1"	#6 FH	.11	10 ea
222501	222501-1	2"	3/8"	1/2"	1"	#6 FH	.11	10 ea
222502	222502-1	2-1/2"	3/8"	1/2"	1"	#6 FH	.16	10 ea
222503	222503-1	3"	3/8"	1/2"	1"	#6 FH	.18	10 ea

These Barrel Bolts provide additional security as either a primary or back-up locking system. Ideal for use on doors, gates, and cabinets. Appropriate for vertical, horizontal, left, or right-hand applications. In vertical use, notch in barrel holds bolt in locked position. Constructed of extruded brass with a chrome plated finish. Surface mounts with six #6 FH fasteners (not included).

⚠ WARNING: Cancer and Reproductive Harm - www.P65Warnings.ca.gov



BARREL BOLT

Sand Cast Brass Chrome Plated

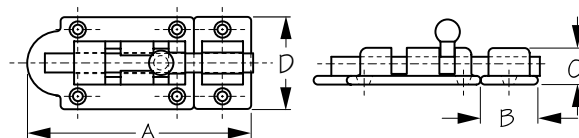

Bulk	Display	A	B	C	D	Fastener	Wt.(lb.)	Std. Pack
222522	222522-1	2-7/8"	3/4"	1/2"	1-3/16"	#6 FH	.13	10 ea

These Barrel Bolts provide additional security as either a primary or back-up locking system. Ideal for use on doors, gates, and cabinets. Appropriate for vertical, horizontal, left, or right-hand applications. In vertical use, notch in barrel holds bolt in locked position. Constructed of sand cast brass with a chrome plated finish. Surface mounts with six #6 FH fasteners (not included).

⚠ WARNING: Cancer and Reproductive Harm - www.P65Warnings.ca.gov



DOOR STOP AND CATCH

Sand Cast Brass or Chrome Plated Brass

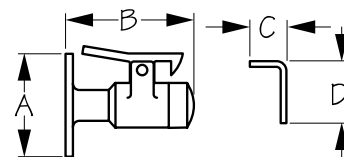

Bulk	Display	A	B	C	D	Finish	Fastener	Wt.(lb.)	Std. Pack
222710	222710-1	2"	2-1/2"	11/16"	1-3/16"	Chrome	#6 FH	.41	5 ea
222712	222712-1	2"	2-1/2"	11/16"	1-3/16"	Brass	#6 FH	.41	5 ea

These Door Stops and Catches are both decorative and functional. Designed to hold the door securely against the rubber stop, effectively reducing rattling common with most door hooks. The spring-loaded latch allows for quick and easy release. Constructed of sand cast brass with a plain polished or chrome plated finish. Installs with five #6 FH fasteners (not included).

⚠ WARNING: Cancer and Reproductive Harm - www.P65Warnings.ca.gov

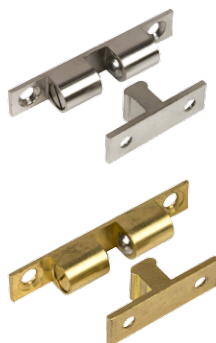

STUD CATCH

Sand Cast Brass or Chrome Plated Brass

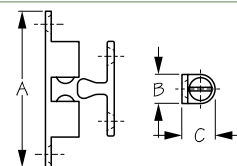

Bulk	Display	A	B	C	Finish	Fastener	Wt.(lb.)	Std. Pack
222821	222821-1	1-11/16"	5/16"	3/8"	Chrome	#4 FH	.03 / .06	10 ea / 10 pr
222822	222822-1	1-15/16"	3/8"	7/16"	Chrome	#4 FH	.05 / .10	10 ea / 10 pr
222823	222823-1	2-5/16"	7/16"	1/2"	Chrome	#6 FH	.09 / .18	10 ea / 10 pr
222841	222841-1	1-11/16"	5/16"	3/8"	Brass	#4 FH	.03 / .06	10 ea / 10 pr
222842	222842-1	1-15/16"	3/8"	7/16"	Brass	#4 FH	.05 / .10	10 ea / 10 pr
222843	222843-1	2-5/16"	7/16"	1/2"	Brass	#6 FH	.09 / .18	10 ea / 10 pr

These Stud Catches are ideal for applications that require repeated disengagement. The design affords no direct contact between the stud and panel surfaces, preventing damage and wear. Stud catches feature an adjustable, stainless steel, spring-loaded ball that allows for easy adjustment of the holding strength depending on door size. Strike plate can be positioned to enter in any of three ways, from the front or either side. Constructed of sand cast brass with a plain polished or chrome plated finish. Installs with four FH fasteners (not included).

⚠ WARNING: Cancer and Reproductive Harm - www.P65Warnings.ca.gov

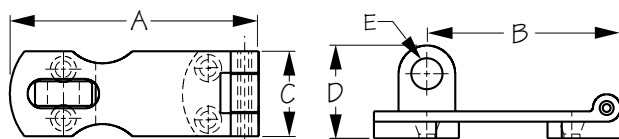
**SWIVEL HASP**

Die Cast Zinc Chrome Plated



Bulk	Display	A	B	C	D	E	Style	Fastener	Wt.(lb.)	Std. Pack
224130	224130-1	3"	2-3/8"	1"	1-1/8"	3/8"	Flush	#8 FH	.16	10 ea

These Swivel Hasps are designed with a slotted plate that fits over a swivel pad eye. The swivel eye rotates acting as a temporary lock, but will also accept most padlocks for more permanent protection. For added security all mounting screws are concealed when hasp is closed. Ideal for use on doors, cabinets, chests, and lockers. Constructed of chrome plated die cast zinc. Installs with four #8 FH fasteners (not included). Recommended for freshwater use.

⚠ WARNING: Cancer and Reproductive Harm - www.P65Warnings.ca.gov

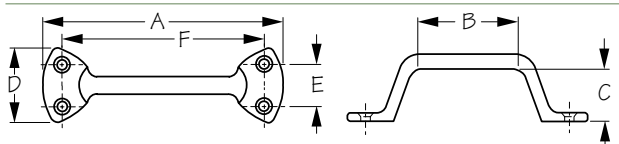
**LIFT HANDLE**

Die Cast Zinc Chrome Plated



Bulk	Display	A	B	C	D	E	F	Fastener	Wt.(lb.)	Std. Pack
224260	224260-1	5-7/8"	2-3/4"	1-3/8"	2"	1-1/8"	4-15/16"	#10 FH	.36	10 ea

This Lift Handle is great for use on cabinets and drawers. It provides ample hand clearance for maximum grip. Constructed of chrome plated die cast zinc. Installs with four #10 FH fasteners (not included). Recommended for fresh water use.

⚠ WARNING: Cancer and Reproductive Harm - www.P65Warnings.ca.gov

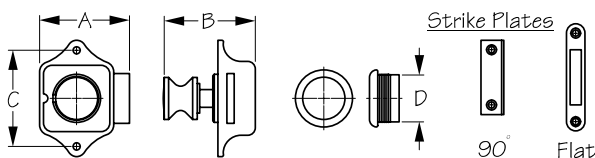
**PUSH BUTTON RIM LATCH**

Brushed Brass or Chrome Plated Brass/Plastic Housing



Bulk	Display	A	B	C	D	Max. Door Thickness	Finish on Brass	Fastener	Wt.(lb.)	Std. Pack
224300	224300-1	1-15/16"	1-7/8"	2-1/16"	1"	1"	Polished Chrome	#6 RH	.20	5 ea
224301	224301-1	1-15/16"	1-7/8"	2-1/16"	1"	1"	Polished Brass	#6 RH	.20	5 ea
224303	224303-1	1-15/16"	1-7/8"	2-1/16"	1"	1"	Brushed Brass	#6 RH	.20	5 ea
224320	n/a	Replacement Strike Plate-Flat							.01	10 ea
224321	n/a	Replacement Strike Plate-90°							.01	10 ea

Push Button Rim Latch housings feature a streamlined, positive action closure, ensuring cabinets and drawers stay closed until the button is deliberately pushed. Suitable for left-side or right-side use. Mortise mount for a sleek, finished appearance. Constructed of sturdy plastic with a chrome plated or polished brass knob. Latch installs with two #6 RH fasteners, strike plates require two #4 FH fasteners (fasteners not included). Display version comes with both flat and 90° strike plates for inset or overlay mounting. When ordering bulk, please order strike plates (224320 flat, or 224321 90°) separately. Hole spacing on flat strike plate (224320) is 1-7/8". Hole spacing on 90° strike plate (224321) is 1-3/16". For OEM applications, varying combinations of rosette/button material are available.

⚠ WARNING: Cancer and Reproductive Harm - www.P65Warnings.ca.gov

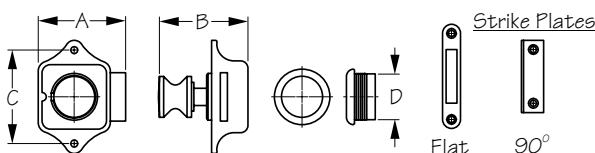
**PUSH BUTTON RIM LATCH**

Plastic/Plastic Housing



Bulk	Display	A	B	C	D	Max. Door Thickness	Finish on Plastic	Fastener	Wt.(lb.)	Std. Pack
224312	224312-1	1-15/16"	1-7/8"	2-1/16"	1"	1"	Polished Chrome	#6 RH	.20	5 ea
224314	224314-1	1-15/16"	1-7/8"	2-1/16"	1"	1"	Gold Plated	#6 RH	.20	5 ea
224320	n/a	Replacement Strike Plate-Flat							.01	10 ea
224321	n/a	Replacement Strike Plate-90°							.01	10 ea

Push Button Rim Latch housings feature a streamlined, positive action closure, ensuring cabinets and drawers stay closed until the button is deliberately pushed. Suitable for left-side or right-side use. Mortise mount for a sleek, finished appearance. Constructed of sturdy plastic housing and knob. Latch installs with two #6 RH fasteners, strike plates require two #4 FH fasteners (fasteners not included). Display version comes with both flat and 90° strike plates for inset or overlay mounting. When ordering bulk, please order strike plates (224320 flat, or 224321 90°) separately. Hole spacing on flat strike plate (224320) is 1-7/8". Hole spacing on 90° strike plate (224321) is 1-3/16".

⚠ WARNING: Cancer and Reproductive Harm - www.P65Warnings.ca.gov



RIM LATCH KNOB

Chrome Plated Cast Brass

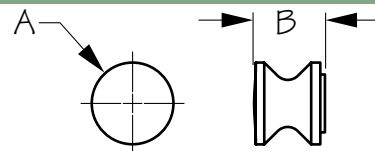

Bulk	Display	Thread	Finish	A	B	Wt.(lb.)	Std. Pack
224350	224350-1	M6 x 1.00	Chrome Plated	7/8"	3/4"	.08	10 ea

⚠ WARNING: Cancer and Reproductive Harm - www.P65Warnings.ca.gov



PUSH BUTTON RIM LATCH

Stainless Steel/Plastic Housing

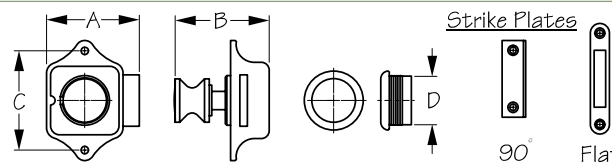

Bulk	Display	A	B	C	D	Max. Door Thickness	Finish	Fastener	Wt.(lb.)	Std. Pack
225300	225300-1	1-15/16"	1-7/8"	2-1/16"	1"	1"	Stainless	#6 RH	.20	5 ea
224320	n/a	Replacement Strike Plate-Flat							.01	10 ea
224321	n/a	Replacement Strike Plate-90°							.01	10 ea

Push Button Rim Latch housings feature a streamlined, positive action closure, ensuring cabinets and drawers stay closed until the button is deliberately pushed. Suitable for left-side or right-side use. Mortise mount for a sleek, finished appearance. Constructed of sturdy plastic with a corrosion resistant 304 stainless steel knob. Latch installs with two #6 RH fasteners, strike plates require two #4 FH fasteners (fasteners not included). Display version comes with both flat and 90° strike plates for inset or overlay mounting. When ordering bulk, please order strike plates (224320 flat, or 224321 90°) separately. Hole spacing on flat strike plate (224320) is 1-7/8". Hole spacing on 90° strike plate (224321) is 1-3/16". For OEM applications, varying combinations of rosette/button material are available.



PUSH BUTTON RIM LATCH - SQUARE

Stainless Steel/Plastic Housing

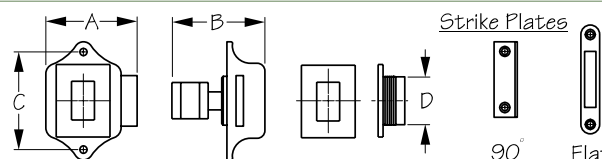

Bulk	Display	A	B	C	D	Max. Door Thickness	Finish	Fastener	Wt.(lb.)	Std. Pack
225310	225310-1	1-15/16"	1-7/8"	2-1/16"	1"	1"	Stainless	#6 RH	.22	5 ea
224320	n/a	Replacement Strike Plate-Flat							.01	10 ea
224321	n/a	Replacement Strike Plate-90°							.01	10 ea

Push Button Rim Latch housings feature a streamlined, positive action closure, ensuring cabinets and drawers stay closed until the button is deliberately pushed. Suitable for left-side or right-side use. Mortise mount for a sleek, finished appearance. Constructed of sturdy plastic with a corrosion resistant 304 stainless steel knob. Latch installs with two #6 RH fasteners, strike plates require two #4 FH fasteners (fasteners not included). Display version comes with both flat and 90° strike plates for inset or overlay mounting. When ordering bulk, please order strike plates (224320 flat, or 224321 90°) separately. Hole spacing on flat strike plate (224320) is 1-7/8". Hole spacing on 90° strike plate (224321) is 1-3/16". For OEM applications, varying combinations of rosette/button material are available.



PUSH BUTTON RIM LATCH - SQUARE/ROUND

Stainless Steel/Plastic Housing

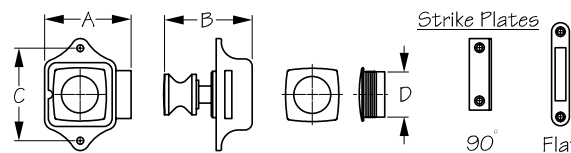

Bulk	Display	A	B	C	D	Max. Door Thickness	Finish	Fastener	Wt.(lb.)	Std. Pack
225320	225320-1	1-15/16"	1-7/8"	2-1/16"	1"	1"	Stainless	#6 RH	.20	5 ea
224320	n/a	Replacement Strike Plate-Flat							.01	10 ea
224321	n/a	Replacement Strike Plate-90°							.01	10 ea

Push Button Rim Latch housings feature a streamlined, positive action closure, ensuring cabinets and drawers stay closed until the button is deliberately pushed. Suitable for left-side or right-side use. Mortise mount for a sleek, finished appearance. Constructed of sturdy plastic with a corrosion resistant 304 stainless steel knob. Latch installs with two #6 RH fasteners, strike plates require two #4 FH fasteners (fasteners not included). Display version comes with both flat and 90° strike plates for inset or overlay mounting. When ordering bulk, please order strike plates (224320 flat, or 224321 90°) separately. Hole spacing on flat strike plate (224320) is 1-7/8". Hole spacing on 90° strike plate (224321) is 1-3/16". For OEM applications, varying combinations of rosette/button material are available.

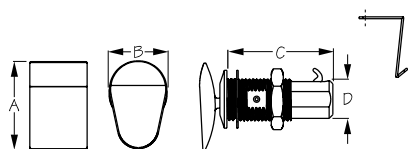
**PUSH BUTTON CABINET LATCH**

Investment Cast 316 Stainless Steel/Chrome Plated Brass



Bulk	Display	Style	A	B	C	D	Wt.(lb.)	Std. Pack
225400	225400-1	Oval	1-7/16"	15/16"	1-11/16"	3/4"	.20	5 ea
225420	225420-1	Rectangular	1-7/16"	15/16"	1-11/16"	3/4"	.21	5 ea

These Push Button Cabinet Latches function as both a latch and handle. Push button operation activates and secures the latch with a simple, deliberate motion. Positive action locking function prevents cabinets from opening while in motion. Sleek, low-profile design makes them convenient in tight spaces. Great for glove compartments. Suitable for left or right-hand side uses. Constructed of corrosion resistant investment cast 316 stainless steel. Installs by boring a single 3/4" hole. Includes catch.

⚠ **WARNING:** Cancer and Reproductive Harm - www.P65Warnings.ca.gov

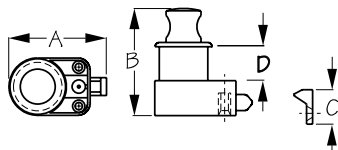
**PUSH BUTTON CABINET LATCH**

Chrome Plated Brass/Plastic Housing



Bulk	Display	A	B	C	D	Max. Door Thickness	Finish	Fastener	Wt.(lb.)	Std. Pack
226312	226312-1	2"	2-3/16"	11/16"	11/16"	11/16"	Chrome	#6 RH	.16	5 ea

This Push Button Cabinet Latch function as both a latch and handle. Push button operation activates and secures the latch with a simple, deliberate motion. Positive action locking function prevents cabinets from opening while in motion. Sleek, low-profile design makes them convenient in tight spaces. Great for glove compartments. Suitable for left or right-hand side uses. Easy to install by boring a single 1" hole. Includes catch. Constructed of sturdy plastic with a chrome plated brass knob. Installs with four #6 RH fasteners (not included).

⚠ **WARNING:** Cancer and Reproductive Harm - www.P65Warnings.ca.gov

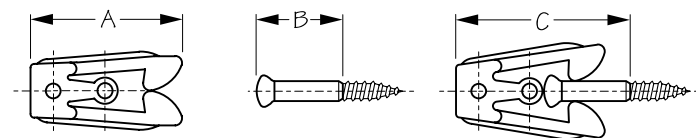
**FLEXIBLE DOOR CATCH**

Injection Molded Nylon/304 Stainless Steel



Bulk	Display	A	B	C	Fastener	Wt.(lb.)	Std. Pack
227023	227023-1	1-1/4"	3/4"	1-7/16"	#4 RH	.02 / .04	10 ea / 10 pr

These Flexible Door Catches guarantee ease of alignment and durability in use. Constructed of sturdy UV resistant injection molded nylon with a stainless steel spring clip and 304 stainless adjustable door strike (included). Installs with two #4 RH fasteners (not included).

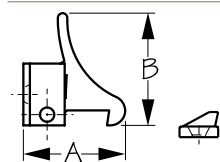
**ELBOW CATCH**

Injection Molded Nylon



Bulk	Display	A	B	Color	Fastener	Wt.(lb.)	Std. Pack
227030	227030-1	1-1/8"	1-5/16"	Black	#6 FH	.01 / .02	10 ea / 10 pr

This spring-loaded Elbow Catch is ideal for the inactive side of a pair of cabinet doors. For use on wood or metal doors where no frame is present between doors. Quick and simple to install, allowing for door to lock shut when pushed. Requires releasing the hook to open the door, making them very secure. Traditionally used in conjunction with a touch or magnetic latch on the primary door. Constructed of UV resistant injection molded nylon. Surface mounts with four #6 FH fasteners (not included).

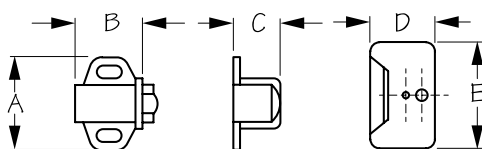
**ROLLER CATCH - SURFACE MOUNT**

Injection Molded Nylon



Bulk	Display	A	B	C	D	E	Fastener	Wt.(lb.)	Std. Pack
227108	227108-1	1-3/8"	1-3/16"	7/8"	13/16"	1-3/8"	#8 RH	.03	10 ea

These Surface Mount Roller Catches feature stainless steel springs and provide secure closure for cabinet doors. Constructed of sturdy injection molded nylon. Installs with four #8 RH fasteners (not included).

DOOR CATCH

Injection Molded Nylon

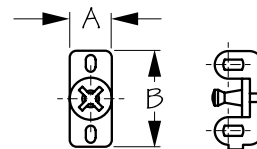

Bulk	Display	A	B	Fastener	Wt.(lb.)	Std. Pack
227135	227135-1	1/2"	1-3/16"	#6 RH	.01 / .04	20 ea / 10 sets

These Door Catches provide secure closure for cabinet doors. Constructed of sturdy injection molded nylon. Installs with four #6 RH fasteners (not included). Display packaging are packed in sets of 4 each.

TWIN ROLLER DOOR CATCH

Injection Molded Nylon

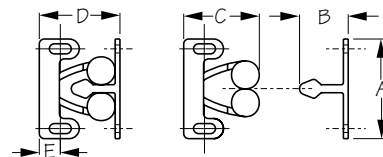

Bulk	Display	A	B	C	D	E	Color	Fastener	Wt.(lb.)	Std. Pack
227141	227141-1	1-1/4"	5/8"	15/16"	1"	1/4"	White	#6 RH	.01 / .04	20 ea / 10 sets

These Twin Roller Door Catches will upgrade your cabinet or wardrobe by providing secure door closure. Constructed of sturdy injection molded nylon. Installs with four #6 RH fasteners (not included). Display packaging are packed in sets of 4 each.

LED MOTION ACTIVATED CABINET LIGHT

Injection Molded Nylon

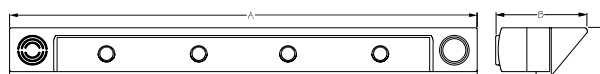

Bulk	Display	A	B	C	LED Color	Fastener	Wt.(lb.)	Std. Pack
227154	227154-1	6-7/8"	1-5/16"	3/4"	White	#10 FH	.16	5 ea

This LED Motion Activated Cabinet Light will turn on when the cabinet door is opened and remain on as long as the light sensor detects light, turning off when the door is shut or the outside light is extinguished. Features 4 super bright white LEDs. The two center bulbs have a 60° beam angle for directed lighting while the two outside bulbs have a 120° beam angle for wider angle lighting. No wiring necessary. Uses 3 AAA batteries (included). Constructed of injection molded nylon. Easily mounted in any enclosed area using the provided strip of two-sided tape or two #10 FH fasteners (not included).

⚠ WARNING: Cancer and Reproductive Harm - www.P65Warnings.ca.gov

LED SWITCH ACTIVATED CABINET LIGHT

Injection Molded Nylon

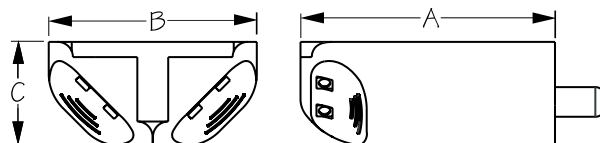

Bulk	Display	A	B	C	LED Color	Fastener	Wt.(lb.)	Std. Pack
227162	227162-1	2"	1-5/8"	13/16"	White	#10 FH	.17	5 ea

The LED Switch Activated Cabinet Light can be mounted in any cabinet, locker, or other location where short access lighting is needed. Features 4 super bright white LEDs. No wiring necessary. Uses 6 LR44 batteries (included). Constructed of UV resistant injection molded nylon. Installs with four #10 FH fasteners (included).

⚠ WARNING: Cancer and Reproductive Harm - www.P65Warnings.ca.gov

SPRING LOADED HORIZONTAL MOUNT DOOR CATCH

Injection Molded Nylon

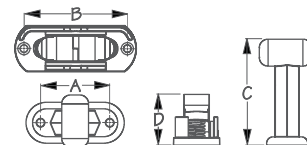

Bulk	Display	A	B	C	D	Fastener	Wt.(lb.)	Std. Pack
227181	227181-1	1-9/16"	2-3/8"	2-3/8"	1-5/16"	#8 RH	.07	10 ea

These Spring Loaded Horizontal Mount Door Catches feature heavy duty stainless steel springs that provide an extremely strong catch mechanism to securely hold doors and hatches. Constructed of sturdy UV resistant injection molded nylon. Installs with four #8 RH mounting screws (included in display packaging).

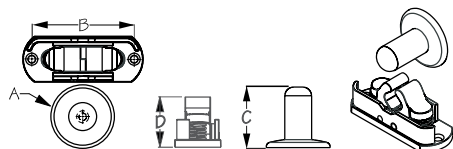
**SPRING LOADED VERTICAL MOUNT DOOR CATCH**

Injection Molded Nylon



Bulk	Display	A	B	C	D	Fastener	Wt.(lb.)	Std. Pack
227186	227186-1	1-7/16"	2-3/8"	1-7/16"	1-5/16"	#8 RH	.06	10 ea

These Spring Loaded Vertical Mount Door Catches feature heavy duty stainless steel springs that provide an extremely strong catch mechanism to securely hold doors and hatches. Constructed of sturdy UV resistant injection molded nylon. Installs with three #8 RH fasteners (included in display packaging).

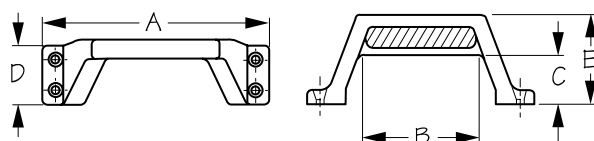
**STEP HANDLE**

Injection Molded Nylon



Bulk	Display	A	B	C	D	E	Color	Fastener	Wt.(lb.)	Std. Pack
227260	227260-1	6-3/8"	3-1/4"	1-3/8"	1-5/8"	2-1/2"	Black	1/4" RH	.22	10 ea

This Step Handle is designed for use as a lift handle on small boat transoms. Molded with a contoured handle grip, the textured upper surface also allows these handles to be used as a step. Constructed of UV resistant injection molded nylon. Installs with four 1/4" RH fasteners (not included).

- Special Order Requirements May Apply
- Custom Colors Available With Large Order

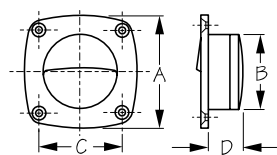
**FINGER PULL - SMALL**

Injection Molded Acetal



Bulk	Display	A	B	C	D	Color	Fastener	Wt.(lb.)	Std. Pack
227310	227310-1	2-3/16"	1-3/4"	1-9/16"	11/16"	Black	#6 FH	.04	10 ea

These Small Finger Pulls allow you to open a drawer or cabinet using just one finger. Flush mounted for a more inconspicuous look. Constructed of UV resistant injection molded acetal. Installs with four #6 FH fasteners (not included).

⚠ WARNING: Cancer and Reproductive Harm - www.P65Warnings.ca.gov

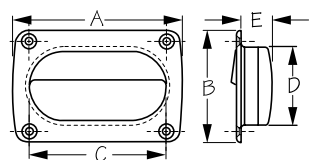
**FINGER PULL**

Injection Molded Acetal



Bulk	Display	A	B	C	D	E	Color	Fastener	Wt.(lb.)	Std. Pack
227320	227320-1	3-5/8"	2-3/8"	2-15/16"	1-3/4"	11/16"	Black	#6 FH	.07	10 ea
227321	227321-1	3-5/8"	2-3/8"	2-15/16"	1-3/4"	11/16"	White	#6 FH	.07	10 ea
227322	227322-1	3-5/8"	2-3/8"	2-15/16"	1-3/4"	11/16"	Gray	#6 FH	.07	10 ea

These Finger Pulls allow you to open a drawer or cabinet using just one finger. Flush mounted for a more inconspicuous look. Constructed of UV resistant injection molded acetal. Installs with four #6 FH fasteners (not included).

⚠ WARNING: Cancer and Reproductive Harm - www.P65Warnings.ca.gov

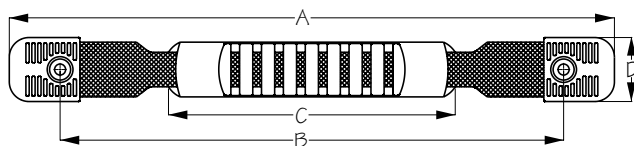
**WEBBING HANDLE WITH CAPS**

Injection Molded Nylon/Webbing



Bulk	Display	A	B	C	D	Fastener	Wt.(lb.)	Std. Pack
227462	227462-1	11-1/2"	10"	5"	1"	#10 RH	.11	10 ea

Webbing Lift Handle is easy to hold even when wet. Ideal for replacement of worn or torn handles or to add another handle to make it easier to carry your kayak, paddle board, or canoe. Works for both end and side carry handles. Includes nylon end caps. Constructed of nylon webbing with an injection molded nylon handle. Installs with two #10 RH fasteners (not included) or on an inflatable boat with use of the proper adhesive.



GRAB HANDLE

Injection Molded Nylon/PVC Coated

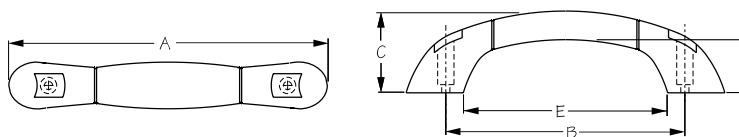

Bulk	Display	A	B	C	D	E	Color	Fastener	Wt.(lb.)	Std. Pack
227560	227560-1	9-3/4"	7-1/4"	2-1/2"	1-3/4"	6-1/4"	Black	#10 FH	.40	5 ea
227561	227561-1	9-3/4"	7-1/4"	2-1/2"	1-3/4"	6-1/4"	White	#10 FH	.40	5 ea

Soft Grip Handle with concealed fasteners. Constructed of injection molded nylon with PVC coating. Installs with two #10 FH fasteners (included).

⚠ WARNING: Cancer and Reproductive Harm - www.P65Warnings.ca.gov



SLAM LATCH

Injection Molded Nylon / Stainless Steel

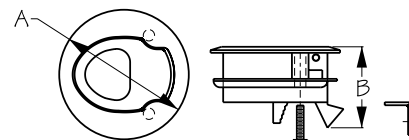

Bulk	Display	A	B	Cutout Hole	Color	Fastener	Wt.(lb.)	Std. Pack
228120	228120-1	2-7/16"	1-1/2"	2"	White	#12 RH	.11	5 ea
228125	228125-1	2-7/16"	1-1/2"	2"	Black	#12 RH	.11	5 ea

Slam Latches feature push-to-close functionality. Activated by the shutting or slamming of a door, they are designed so that a spring inside automatically retracts the latch, engaging the keeper and retaining the cover against the frame. Fast and easy to use, this latch features a recessed, rattle-free, spring loaded handle for quick access. Constructed of UV resistant injection molded nylon. Easy to install by simply inserting the latch body through a single round 2" cutout and screwing on the back plate. Includes hardware to mount latch. Keeper plate installs with two #12 RH fasteners (not included). Available in black or white.



STEERING WHEEL MANEUVERING KNOB

Investment Cast 316 Stainless Steel

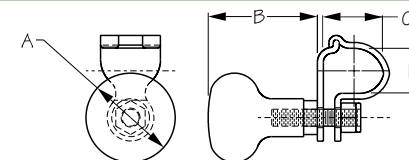

Bulk	Display	A	B	C	D	Wt.(lb.)	Std. Pack
n/a	230106-1	1-1/2"	1-7/8"	1"	3/4"	.39	1 ea

Steering Wheel Maneuvering Knob fits our Sea-Dog® Steering Wheels (230111, 230212, 230115, 230211, 230215, 230313, and 230315). Attaches to the wheel for use in situations where maneuvering is excessive, allowing the driver to turn the steering wheel more quickly. Constructed of corrosion resistant investment cast 316 stainless steel. Fits 1" x 3/4" oval tubing.



STEERING WHEEL MANEUVERING KNOB

Investment Cast 316 Stainless Steel

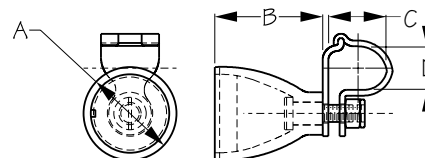

Bulk	Display	A	B	C	D	Wt.(lb.)	Std. Pack
n/a	230107-1	1-5/8"	1-7/8"	1"	3/4"	.45	1 ea

Steering Wheel Maneuvering Knob fits our Sea-Dog® Steering Wheels (230111, 230212, 230115, 230211, 230215, 230313, and 230315). Attaches to the wheel for use in situations where maneuvering is excessive, allowing the driver to turn the steering wheel more quickly. Direct replacement for knobs installed on 230323 and 230325 wheels. Constructed of corrosion resistant investment cast 316 stainless steel. Fits 1" x 3/4" oval tubing.



STEERING WHEEL

Formed 304 Stainless Steel

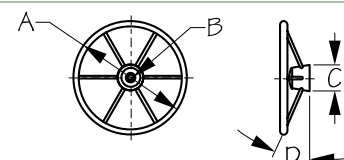

Bulk	Display	No. of Spokes	Cap	A	B	C	D	NMMA Type Accepted #	Wt.(lb.)	Std. Pack
230111	n/a	5	Teak	15-1/8"	3/4"	3-1/2"	10°	2456120	3.69	5 ea
230115	n/a	6	Plastic	15-1/8"	3/4"	3-1/2"	10°	2456121	3.69	5 ea
230211	n/a	5	Plastic	11"	3/4"	3-1/2"	25°	2456122	2.89	5 ea
230215	n/a	6	Plastic	15-1/8"	3/4"	3-1/2"	25°	2456123	3.69	5 ea
230101	230101-1	Black plastic replacement cap							.10	5 ea
230102	230102-1	Teak replacement cap							.09	5 ea

These Steering Wheels feature either a 5-spoke or 6-spoke design with a 10° or 25° dish and a decorative cap. All wheels fit a standard 3/4" tapered shaft. Constructed of corrosion resistant formed 304 stainless steel.

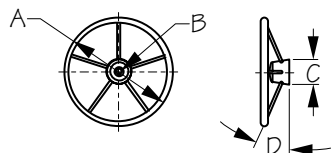
**STEERING WHEEL**

Formed 304 Stainless Steel



Bulk	Display	No. of Spokes	Cap	A	B	C	D	NMMA Type Accepted #	Wt.(lb.)	Std. Pack
230212	n/a	5	Plastic	12"	3/4"	3-1/2"	25°	2539244	2.95	5 ea
230101	230101-1	Black plastic replacement cap							.10	5 ea
230102	230102-1	Teak replacement cap							.09	5 ea

This Steering Wheel features a 5-spoke design and 25° dish. Fits standard 3/4" tapered shafts. Constructed of corrosion resistant formed 304 stainless steel.

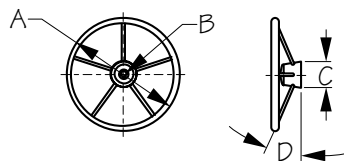
**STEERING WHEEL**

Formed 304 Stainless Steel With Foam Covering



Bulk	Display	No. of Spokes	Cap	A	B	C	D	NMMA Type Accepted #	Wt.(lb.)	Std. Pack
230212G	n/a	5	Plastic	11"	3/4"	3-1/2"	25°	n/a	2.89	5 ea
230213G	n/a	5	Plastic	13-1/2"	3/4"	3-1/2"	25°	2601616	3.00	5 ea
230101	230101-1	Black plastic replacement cap							.10	5 ea
230102	230102-1	Teak replacement cap							.09	5 ea

These Steering Wheels feature a 5-spoke design with a 25° dish. Fits standard 3/4" tapered shafts. Constructed of corrosion resistant formed 304 stainless steel with foam covering.

⚠ WARNING: Cancer and Reproductive Harm - www.P65Warnings.ca.gov

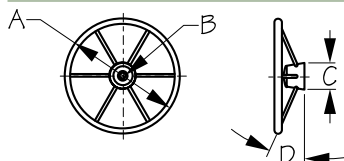
**STEERING WHEEL**

Formed 304 Stainless Steel With Foam Covering



Bulk	Display	No. of Spokes	Cap	A	B	C	D	NMMA Type Accepted #	Wt.(lb.)	Std. Pack
230216	n/a	6	Plastic	15"	3/4"	3-1/2"	25°	2456124	3.69	5 ea
230217	n/a	5	Plastic	15"	3/4"	3-1/2"	25°	2456125	3.69	5 ea
230101	230101-1	Black plastic replacement cap							.10	5 ea
230102	230102-1	Teak replacement cap							.09	5 ea

These Steering Wheels feature a 5-spoke or 6-spoke design with a 25° dish. Fits standard 3/4" tapered shafts. Constructed of corrosion resistant formed 304 stainless steel with foam covering.

⚠ WARNING: Cancer and Reproductive Harm - www.P65Warnings.ca.gov

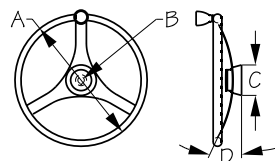
**STEERING WHEEL WITH INTEGRAL KNOB**

Formed 304 Stainless Steel



Bulk	Display	No. of Spokes	Cap	A	B	C	D	Wt.(lb.)	Std. Pack
230323	n/a	3	Stainless	13-1/2"	3/4"	3-1/2"	25°	3.65	5 ea
230325	n/a	3	Stainless	15-1/2"	3/4"	3-1/2"	25°	3.88	5 ea
230303	n/a	Stainless replacement cap						.36	5 ea

These Steering Wheels feature a 3-spoke design with a 25° dish angle, and an integral knob. A steering knob attaches to the wheel for use in situations where maneuvering is excessive, allowing the driver to turn the steering wheel more quickly. Fits standard 3/4" tapered shafts. Constructed of corrosion resistant formed 304 stainless steel.



SINGLE FUNCTION ENGINE CONTROL

Sand Cast Brass Chrome Plated

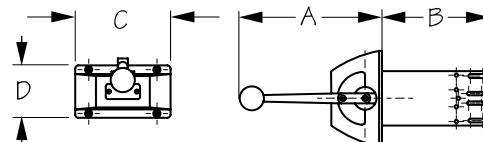

Bulk	Display	A	B	C	D	Fastener	Wt.(lb.)	Std. Pack
232300	n/a	8-1/2"	6-5/16"	5-5/16"	3-1/8"	#10 FH	4.48	1 ea
n/a	232318-1	Replacement Knob (Red)					.06	5 ea
n/a	232319-1	Replacement Knob (Black)					.06	5 ea

This classic Single Function Engine Control is ideal for inboard, stern drive, and outboard engines. One lever controls either throttle or shift functions. Constructed of chrome plated sand cast brass. Top mount with four #10 FH fasteners (not included).

⚠ WARNING: Cancer and Reproductive Harm - www.P65Warnings.ca.gov



DUAL FUNCTION ENGINE CONTROL

Sand Cast Brass Chrome Plated

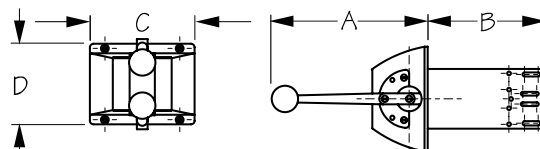

Bulk	Display	A	B	C	D	Fastener	Wt.(lb.)	Std. Pack
232310	n/a	8-1/2"	6-3/8"	5-1/2"	4-1/4"	#10 FH	7.33	1 ea
232320	n/a	2nd Control Kit					.26	1 ea
n/a	232318-1	Replacement Knob (Red)					.06	5 ea
n/a	232319-1	Replacement Knob (Black)					.06	5 ea

This Dual Function Engine Control works in both single and dual helm station applications. Ideal for inboard, stern drive, and outboard engines. The twin levers allow one handle to control the shift and the other to control the throttle. Requires 2nd Control Kit 232320 (pictured below) for use in dual station applications. Constructed of chrome plated sand cast brass. Top mount with four #10 FH fasteners (not included).



⚠ WARNING: Cancer and Reproductive Harm - www.P65Warnings.ca.gov



SINGLE FUNCTION ENGINE CONTROL

Investment Cast 316 Stainless Steel

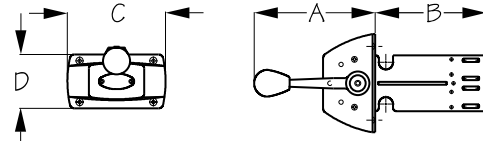

Bulk	Display	A	B	C	D	Fastener	Wt.(lb.)	Std. Pack
232350	n/a	7"	6-1/2"	5-1/4"	3-1/4"	#10 FH	3.30	1 ea
n/a	232378-1	Replacement Knob (Red)					.08	5 ea
n/a	232379-1	Replacement Knob (Black)					.09	5 ea

This Single Function Engine Control is ideal for inboard, stern drive, and outboard engines. One lever controls either throttle or shift functions. Meets ABYC Engine control Standards P-14. Constructed of corrosion resistant investment cast 316 stainless steel. Top mount with four #10 FH fasteners (not included).



DUAL FUNCTION ENGINE CONTROL

Investment Cast 316 Stainless Steel

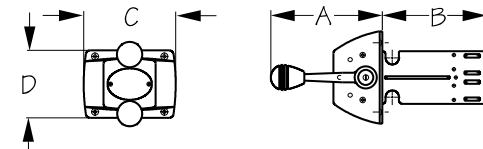

Bulk	Display	A	B	C	D	Fastener	Wt.(lb.)	Std. Pack
232360	n/a	7"	6-1/2"	5-1/4"	4-1/4"	#10 FH	5.00	1 ea
232320	n/a	2nd Control Kit					.26	1 ea
n/a	232378-1	Replacement Knob (Red)					.08	5 ea
n/a	232379-1	Replacement Knob (Black)					.09	5 ea

This Dual Function Engine Control works in both single and dual helm station applications. Ideal for inboard, stern drive, and outboard engines. The twin levers allow one handle to control the shift and the other to control the throttle. Requires 2nd Control Kit 232320 (pictured below) for use in dual station applications. Meets ABYC Engine control Standards P-14. Constructed of corrosion resistant investment cast 316 stainless steel. Top mount with four #10 FH fasteners (not included).



⚠ WARNING: Cancer and Reproductive Harm - www.P65Warnings.ca.gov